

3-5-7

Lyngberg 7. Hafnarfirði.  
Stökkunn.

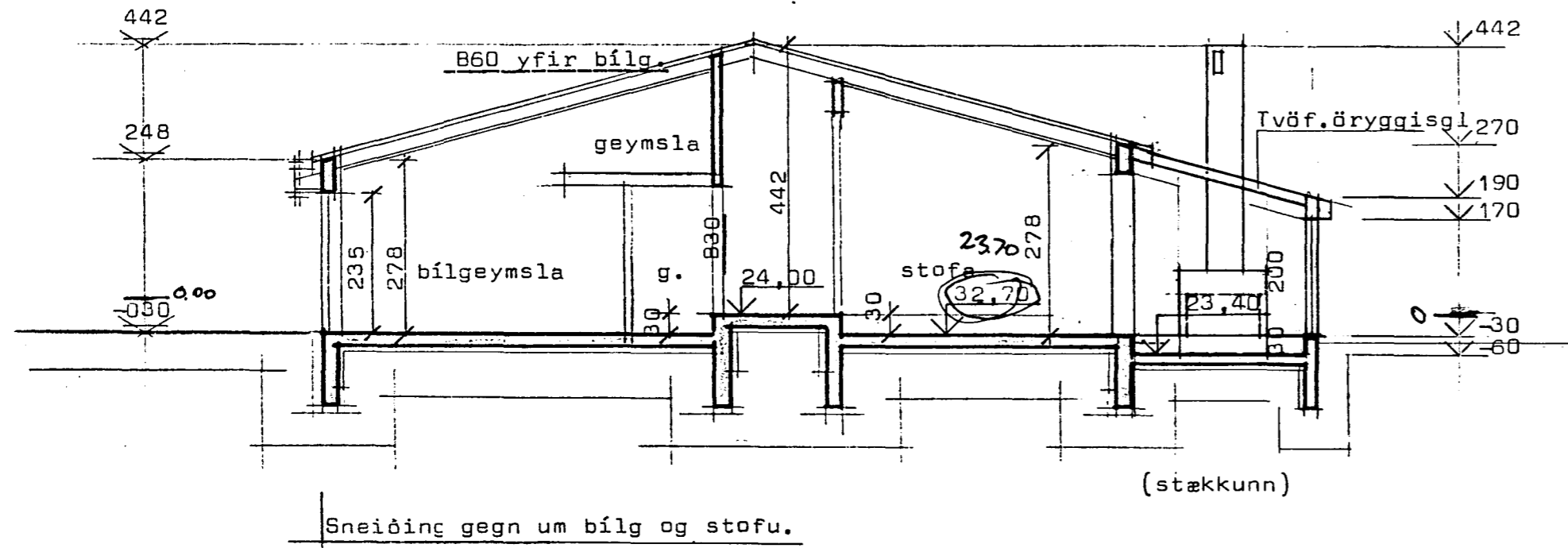
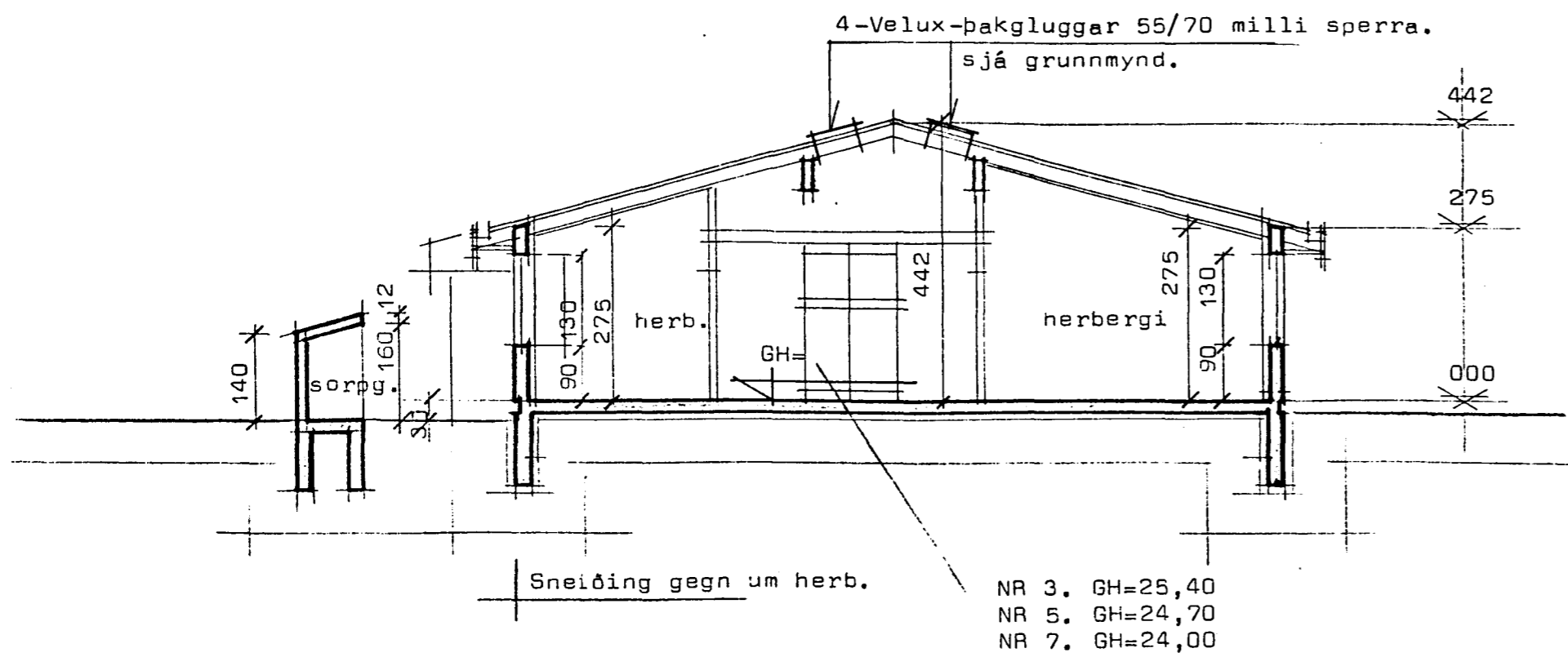

Hús nr 3.	Flatarmál húss + bílgeymslu .....	186,86 m <sup>2</sup>	
	Rúmmál húss + bílgeymslu .....	651,50 m <sup>3</sup>	
	Nýtingarhlutfall .....	0,33	
Hús nr 5.	Flatarmál húss + bílgeymslu .....	163,90 m <sup>2</sup>	
	Rúmmál húss + bílgeymslu .....	606,00 m <sup>3</sup>	
	Nýtingarhlutfall .....	0,33	
Hús nr 7.	Hús + bílgeymsla. (upphafll.stærð)	170,35 m <sup>2</sup>	626,0 m <sup>3</sup>
	Stökkunn. ....	14,40 m <sup>2</sup>	41,6 m <sup>3</sup>
	Samtals.....	184,75 m <sup>2</sup>	467,6 m <sup>3</sup>
	Lóð....	533,10 m <sup>2</sup>	
	Nýting..	34,60 %	

45m<sup>3</sup>

Kólnunartölur K  
Pak ..... 0,20 w/m<sup>2</sup>C<sup>0</sup>  
Gólf ..... 0,30 w/m<sup>2</sup>C<sup>0</sup>  
Útveggir ..... 0,80 w/m<sup>2</sup>C<sup>0</sup> vegið meðaltal.

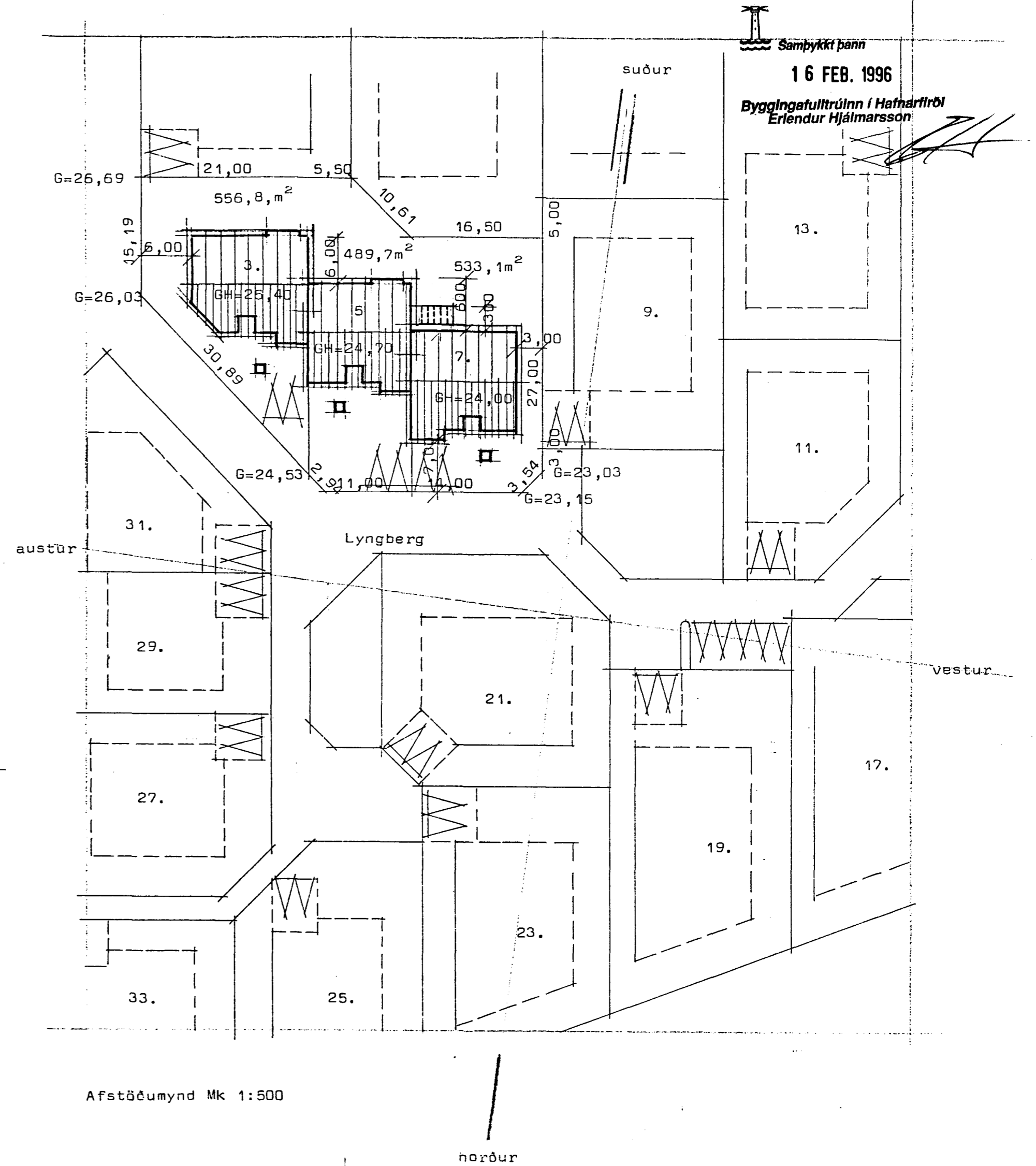

Stökkunn: Blómastofa feb. 1996. *Sigurður P. Kristjánsson*



**STAÐALHÚS** S F

TEIKNISTOFA SÍÐUMÚLA 31 SÍMI 83141

VERKEFNI	DAGS.	1985	VERK NR
Sneiðingar og afstöðumynd	MKV.	1:100 1:500	
3-5-7	BR.	feb 1996./spk.	
Lyngberg 7. Hafnarfirði.	BLAD NR	1,03	96-2.

*Sigurður Guðmundsson* *Sigurður P. Kristjánsson*  
SIGURÐUR GUÐMUNDSSON SIGURÐUR P. KRISTJÁNSSON FTFÍ