









MÁVAHRAUN 11.

HAFANRFIRÐI.

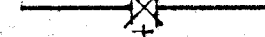
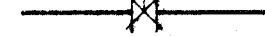
SKÝRINGAR:

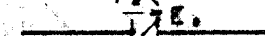
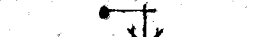
-  KALT VATN.
-  HEITT VATN.
-  TÖPPUNARSTAÐUR KALT VATN.
-  TÖPPUNARSTAÐUR HEITT VATN.
-  RENNILOKI.
-  RENNILOKI MÆÐ SPINDIL UPP ÚR JÖRD.
-  TÆMINGARVENTILL.
-  EINSTREYMISSLOKI.
-  ÖRYGGISLOKI.
-  FLOTKRANI.
-  LOFTPÚÐI.
-  MÆLIR.

Efni og frágangur lagna sé í samræmi við reglugerðir um heitar og kaldar vatnslagnir.

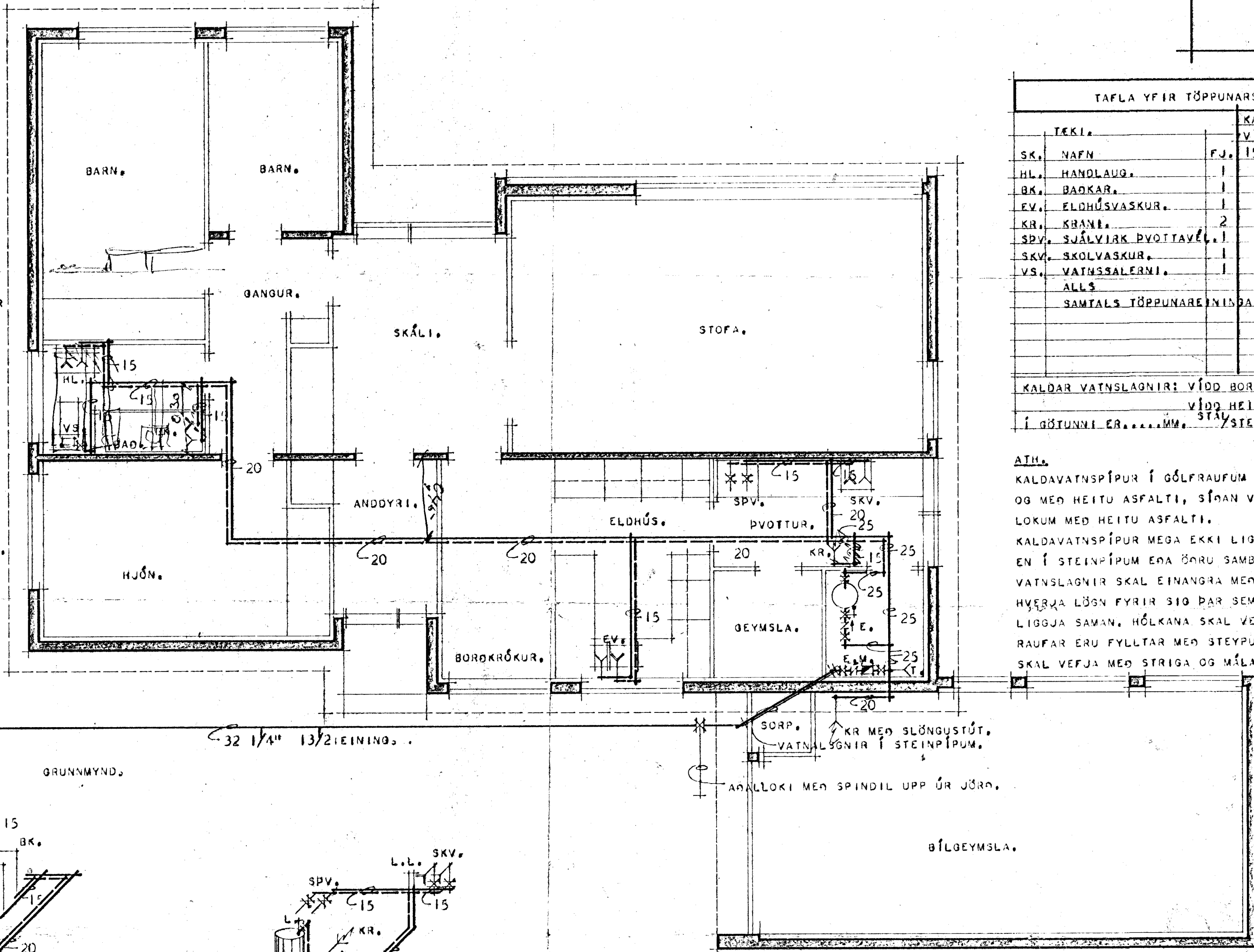

TAFLA YFIR TÖPPUNARSTAÐI.						
TEKI.	NAFN	FJ.	KALDIR KR.		HEITIR KR.	
			VIDD MM.	EIN.	VIDD MM.	EIN.
SK.	HANDLAUG.	1	1	1	1	1
BK.	BAÐKAR.	1	1	1	1	1
EV.	ELDHÚSVASKUR.	1	1	1	1	1
KR.	KRANI.	2	1	1	3	1
SPV.	SJÁLVVIRK PVÖTTAVEL.	1	1	1	1	1
SKV.	SKOLVASKUR.	1	1	1	1	1
VS.	VATNSSALERNI.	1	1			
ALLS			8 1/2		5	
SAMTALS TÖPPUNAREININGAR.					13 1/2	

KALDAR VATNSLAGNIR: VIDD BORHANA ER..... 32 MM.
 VIDD HEIMEDAR ER..... 32 MM.
 Í GÖTUNNI ER..... MM. STÁLSTEYPUJÄRNS-PIPA.

ATH.
 KALDAVATNSPIPUR Í GÓLFRAUFUM SKAL BIKA MÆÐ ASFALT PRIMER OG MÆÐ HEITU ASFALTI, SIÐAN VEFJA MÆÐ STRIGA OG BIKA AÐ LOKUM MÆÐ HEITU ASFALTI.
 KALDAVATNSPIPUR MEGA EKKI LIGGJA UNDIR GÓLFPLÖTU ÖRUVÍSI EN Í STEINPIPUM EÐA ÖRUR SAMBERILEGU.
 VATNSLAGNIR SKAL EINANGRA MÆÐ GLERULLARHÓLKUM 2 CM ÞYKKUM, HVERJA LÖSN FYRIR SIÐAR SEM HEITAB OG KALDAR VATNSLAGNIR LIGGJA SAMAN. HÓLKANA SKAL VEFJA MÆÐ PLASTDÚK ÍÐUR EN RAUFAR ERU FYLLTAR MÆÐ STEYPU. SEU VATNSLAGNIR SÝNILEGAR SKAL VEFJA MÆÐ STRIGA OG MÆLA.

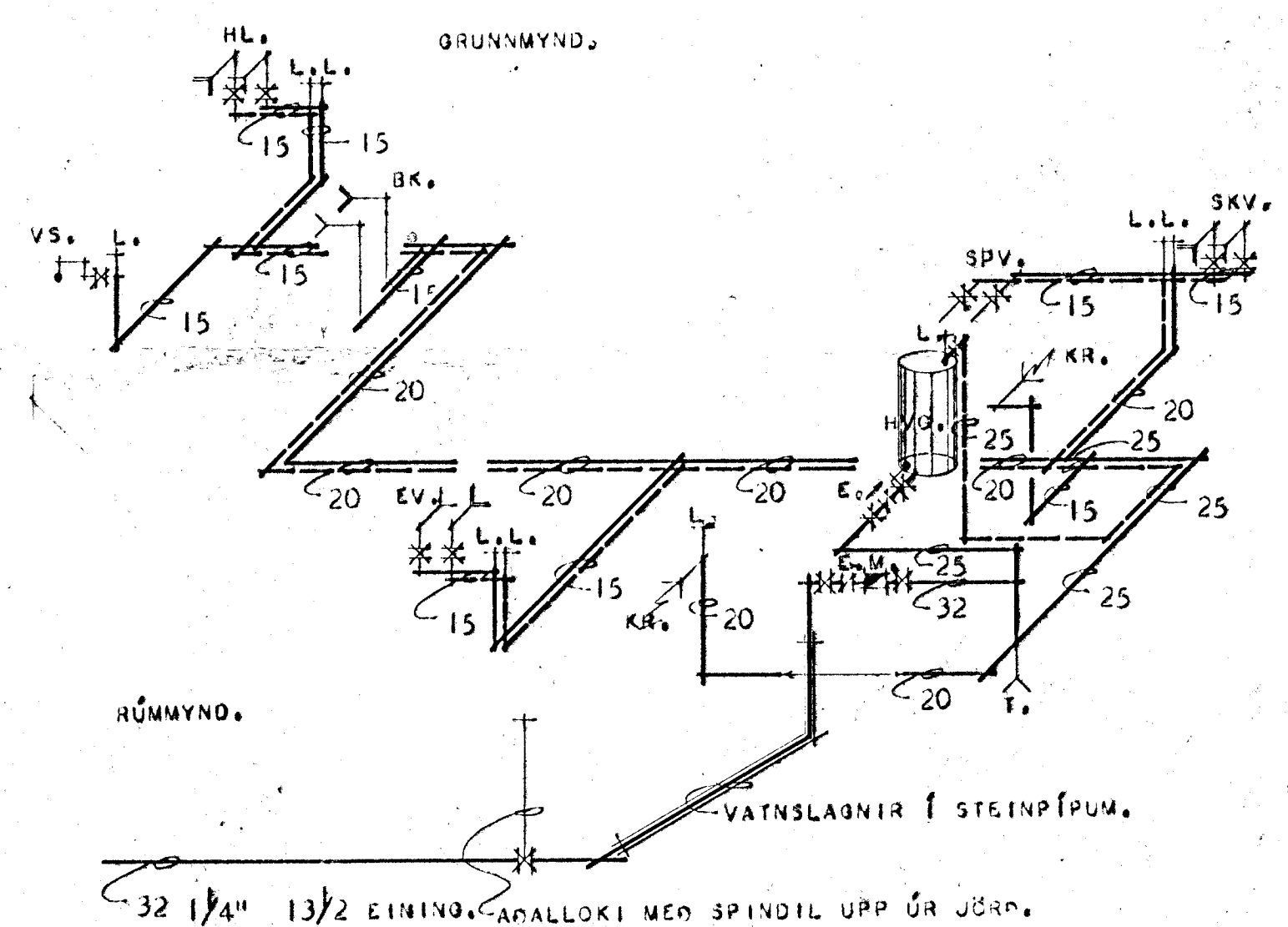

32 1/4" 13 1/2 EINING.
 SORP. KR MÆÐ SLÖNGUSTÚT. VATNSLAGNIR Í STEINPIPUM.
 AÐALLOKI MÆÐ SPINDIL UPP ÚR JÖRD.

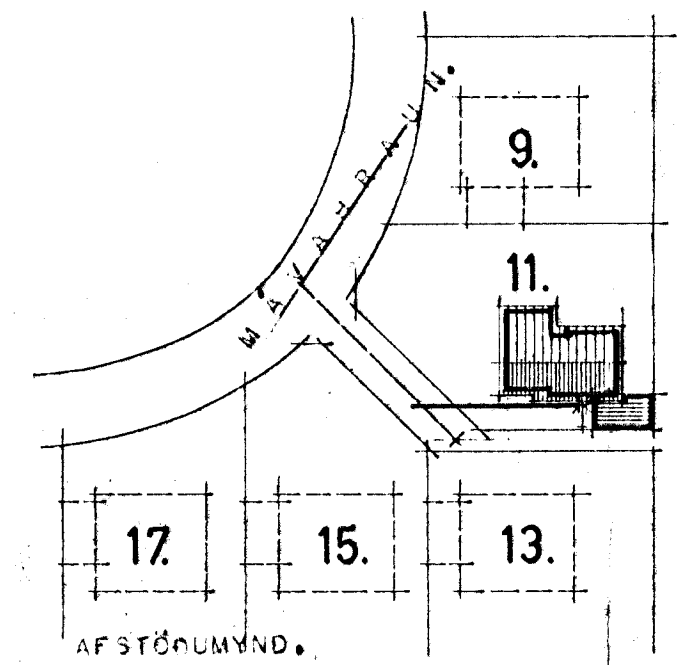

HÚSNÆÐISMÁLASTOFNUN RÍKISINS.

VATNSLAGNIR: EINHÝLISHÚS.

GRUNNMYND OG RÚMMYND. MÁL 1:50. **80.**

AFSTÖÐUMYND. MÁL 1:1000. BLAÐ NR. 1 AF 1. JÚLÍ 1970.

Pingvin P. Hjalmarsson