

A115-2
(140) BAM30610
XCL-W

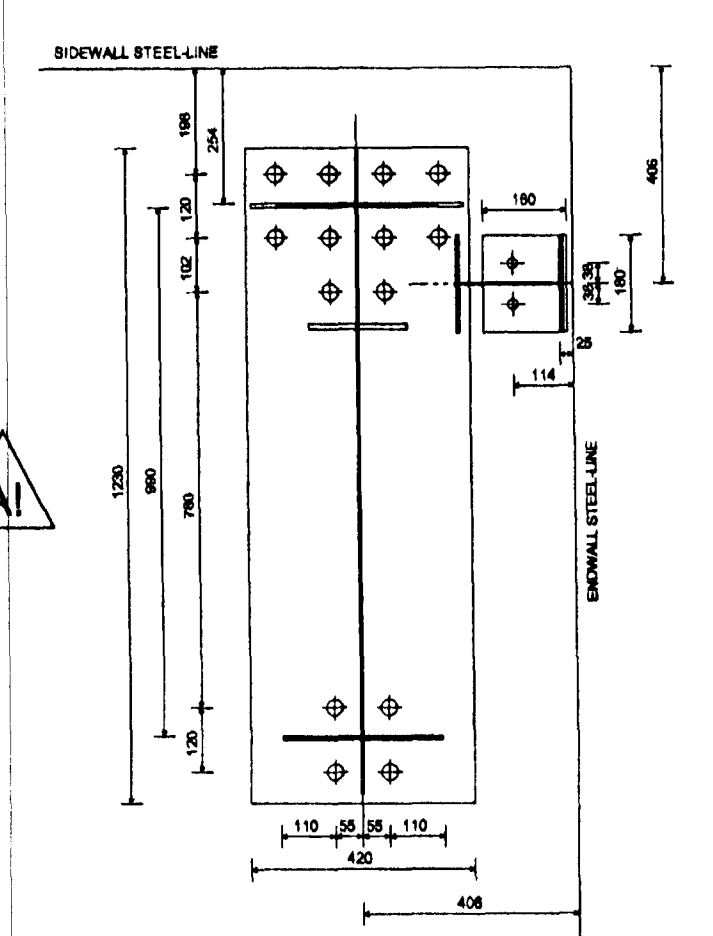

A115-2 + XR162-1
(140) BAM30610
XCL-W (130) BY 2001
CL-21807

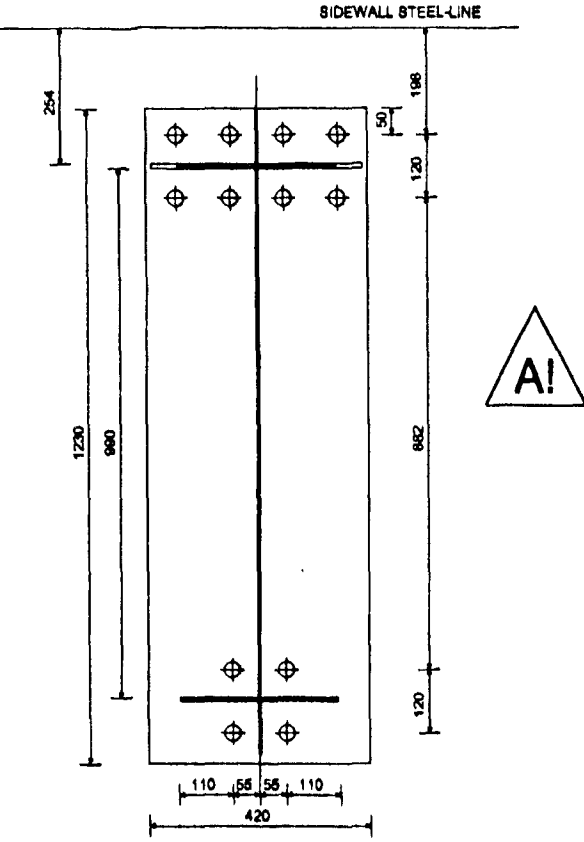

A115-1
(130) BAM30610
XCL-X

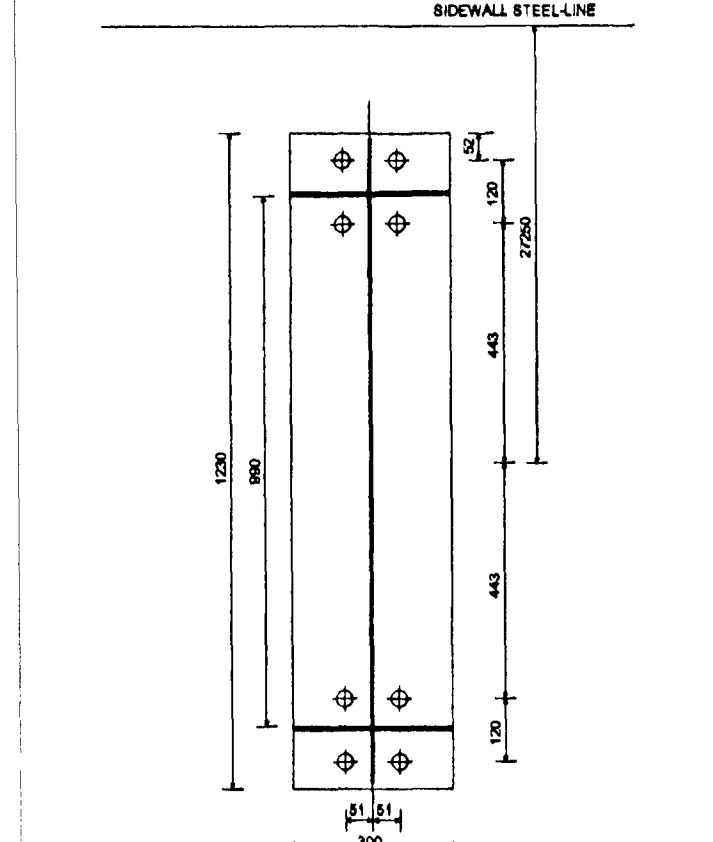

A132-1
(130) BAM30610
XCL-2

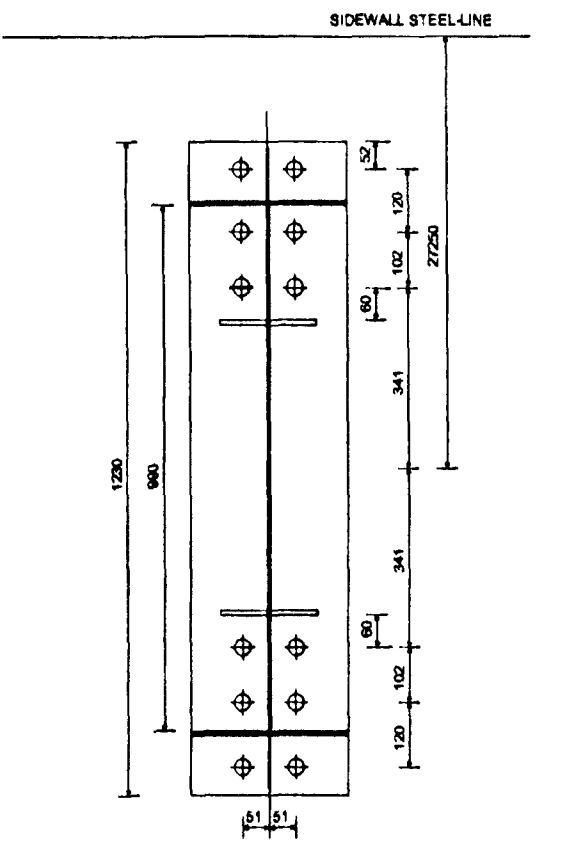

A132-2
(130) BAM30610
XCL-Y

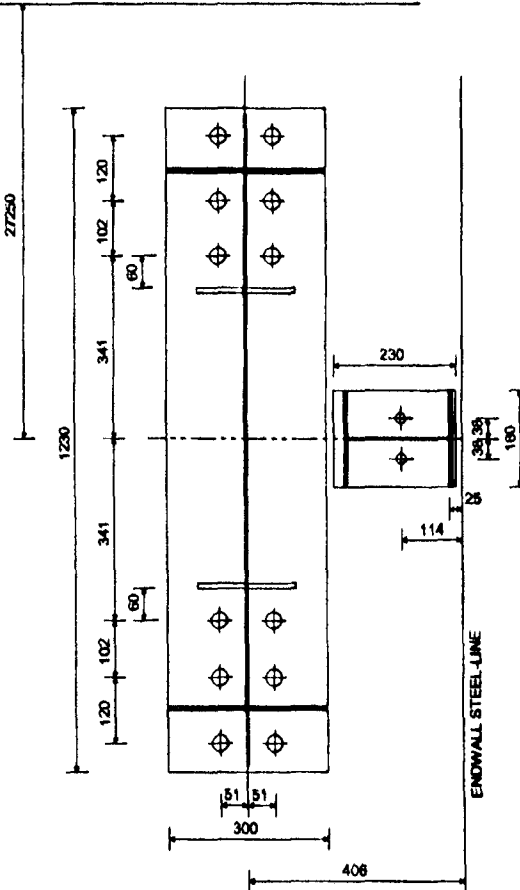

A132-2 + R121-1
(130) BAM30610
XCL-Y (130) BY 2001
CL-21807

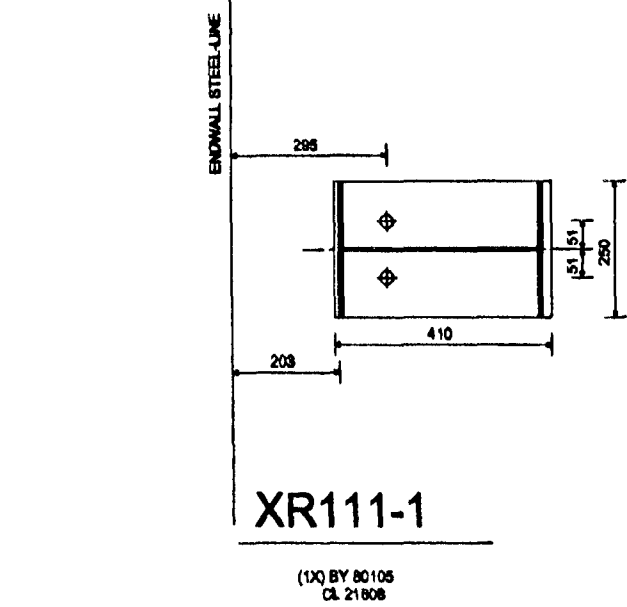

XR111-1
(130) BY 80105
CL-21808

HÚS OG RÁÐGJÖF ehf.
ARKITEKTUR- OG VERKFRÆÐISTOFA
Kl. 510393-2529 / Fax 37608
Skulagötu 6B - 105 Reykjavík
Sími 562-2420 - Fax 562-2430

Guðlaugur Þorsteinsson

SUMMARY (TO BE CHECKED)

Finish coat on primary framing	: F21
Finish of secondary framing	: GAL
Roof panels	: PRE AZA / PSE AZA (DSR 200mm)
Wall panels	: PSE AD1
Slit flashing	: not by Astron
Wall panels	: n.a.
Slit flashing	: AZA (RT21142)
Inside sheathing	: PIG AD1
Quilts + release	: AZA (RT21142)
Downpipes	: n.a.
Roof insulation	: 200mm WOLF (2x100mm) + Isobloc
Wall insulation	: only Isobloc
Cladding	: PRE AZA / PSE AZA

- TECHNICAL NOTES**
- Drawing to read in conjunction with ASTRON technical manual
 - All measures in millimeters
 - * = Field adapted
 - Design of foundations by local engineer
 - Applicable column reactions see chart "Foundation Reactions"
 - Beam reactions are rounded to mm and cannot be added
 - Flange bracing installation per standard detail W1 chapter
 - Field locate roof openings and accessories
 - Compensation of panel tolerance currency during installation
 - Unless noted differently:
 - 1) Purin claspings - A1 peak (see W316, W326, W327)
 - Double surface (see W311, W321)
 - Purin spacers (see chapter W2)
 - Roof stabilization if necessary: HSD, HSD, SEE W37 AND W38
 - Purin spacers (HSA, HSB, HSD, HSE, SEE W37 AND W38)
 - Sag rods (RSQ) - see W8 and cross section
 - The straps (PNC 250) see W7 chapter
 - Field cut and adapt girts and panels shown in overlap with an accessory element

Sampykkt þann
10. JAN. 2002
Byggingafráttirinn / Hafnarfirði
Eh. Sigurbjartur Halldórsson

Móhella 1, Hafnarfirði.

DET:	20	14.08.2001	Sheet - section draw
	14	27.07.2001	Sheet (extra)
	3	22.07.2001	Sheet
	1	18.07.2001	Sheet
TRANSMITTALS			
PROJ:	DEKORATION 8 - HAFNARFIRÐIR	BD:	Stær
BUILDING:	AKR 17% SPANNSÓN 2003/04 LSH112m	CRANE:	100KN
LOADS:	LUM,AKK, 10/10 (DAMP)		
NORMS:		PRIM	ST
		SEC	DK
		MENU	1208
		ANCHORBOLT	
		REV. A. Detail A115 Gage changed from 102 to 110mm 23.07.2011 R.L.	
		REV. B. Summary of 08.2001 R.L.	
		REV. C.	
ASTRON			
COMMERCIAL INTERESTED S.A. - P.O. Box 12 - L-8222 DEKORH - LUXEMBOURG - W1920/2001			

STEEL QUALITY OF ANCHOR BOLTS IS FE510 (YIELD POINT 355 N/mm²)

ANCHOR BOLT DIMENSIONS				ANCHOR BOLT DIMENSIONS			
PN	DIAM	L	H	PN	DIAM	L	H
BAM18380	18	380	50	BY 00001	2x18	500	40
BAM24400	24	480	80	BY 80106	2x24	500	80
BAM30610	30	610	100				