

**STIGAHLAUP ST1 1:20 - 2. STK.**  
ST1 ERU STIGAHLAUP FRÁ KJALLARA UPP Á STIGAPALL MILLI KJALLARA OG 1. HÆÐAR

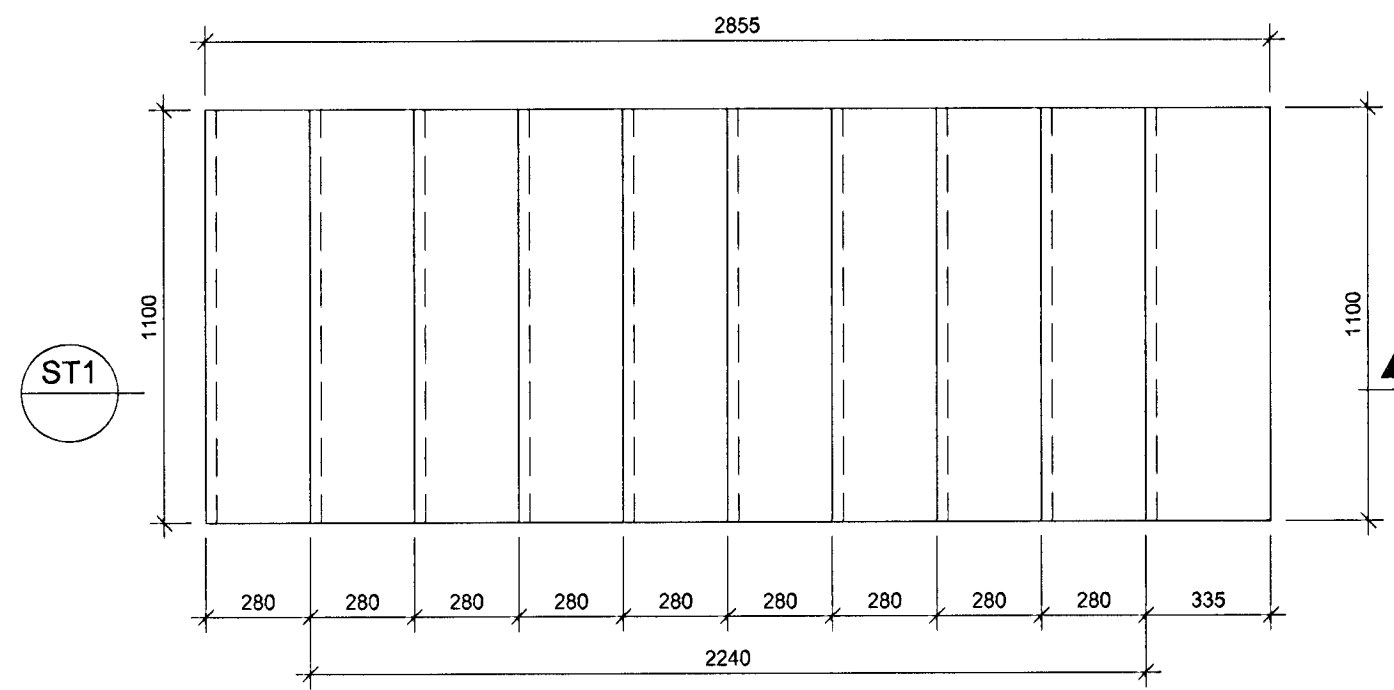

**ST1 SNID 1:20**

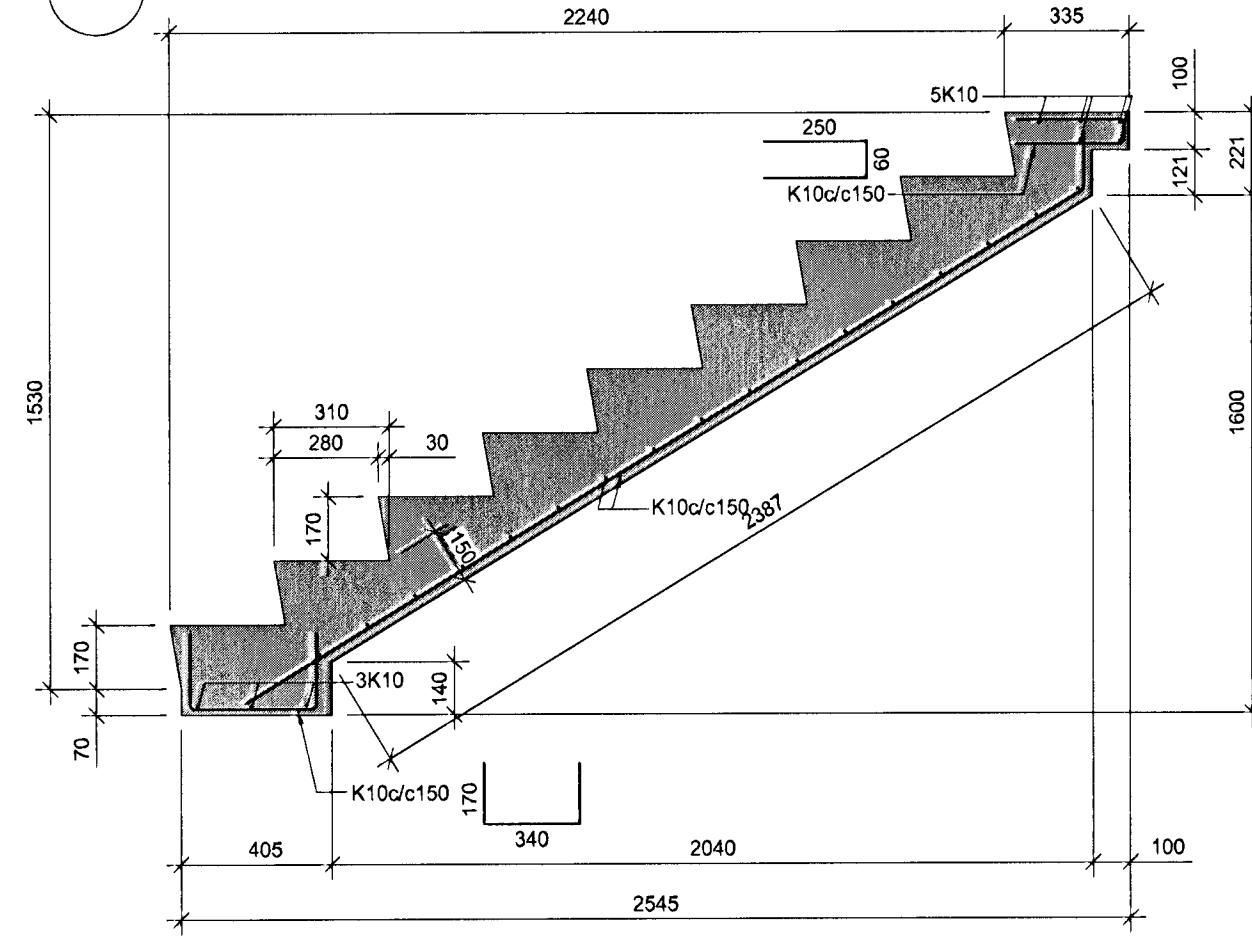

**STIGAHLAUP ST2 - 2 STK 1:20**  
ST2 ERU STIGAHLAUP FRÁ STIGAPALLI MILLI KJALLARA OG 1. HÆÐAR UPP Á 1. HÆÐ

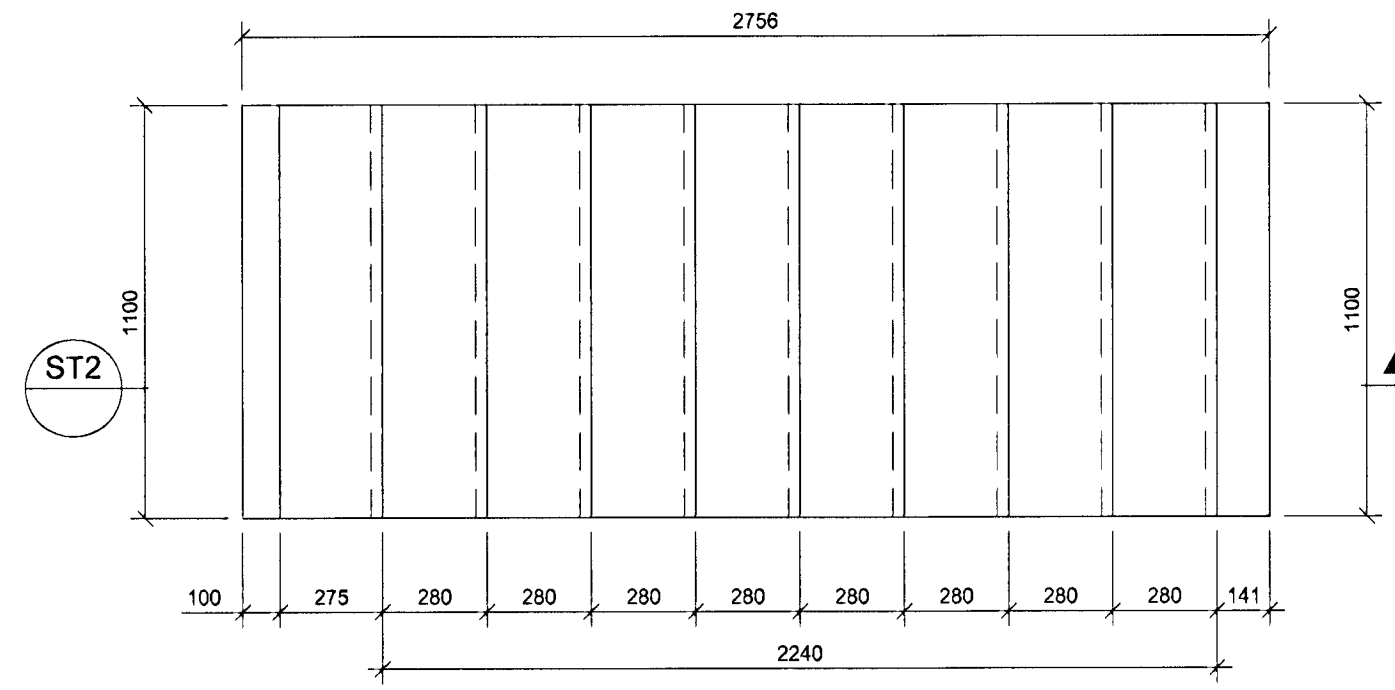

**ST2 SNID 1:20**

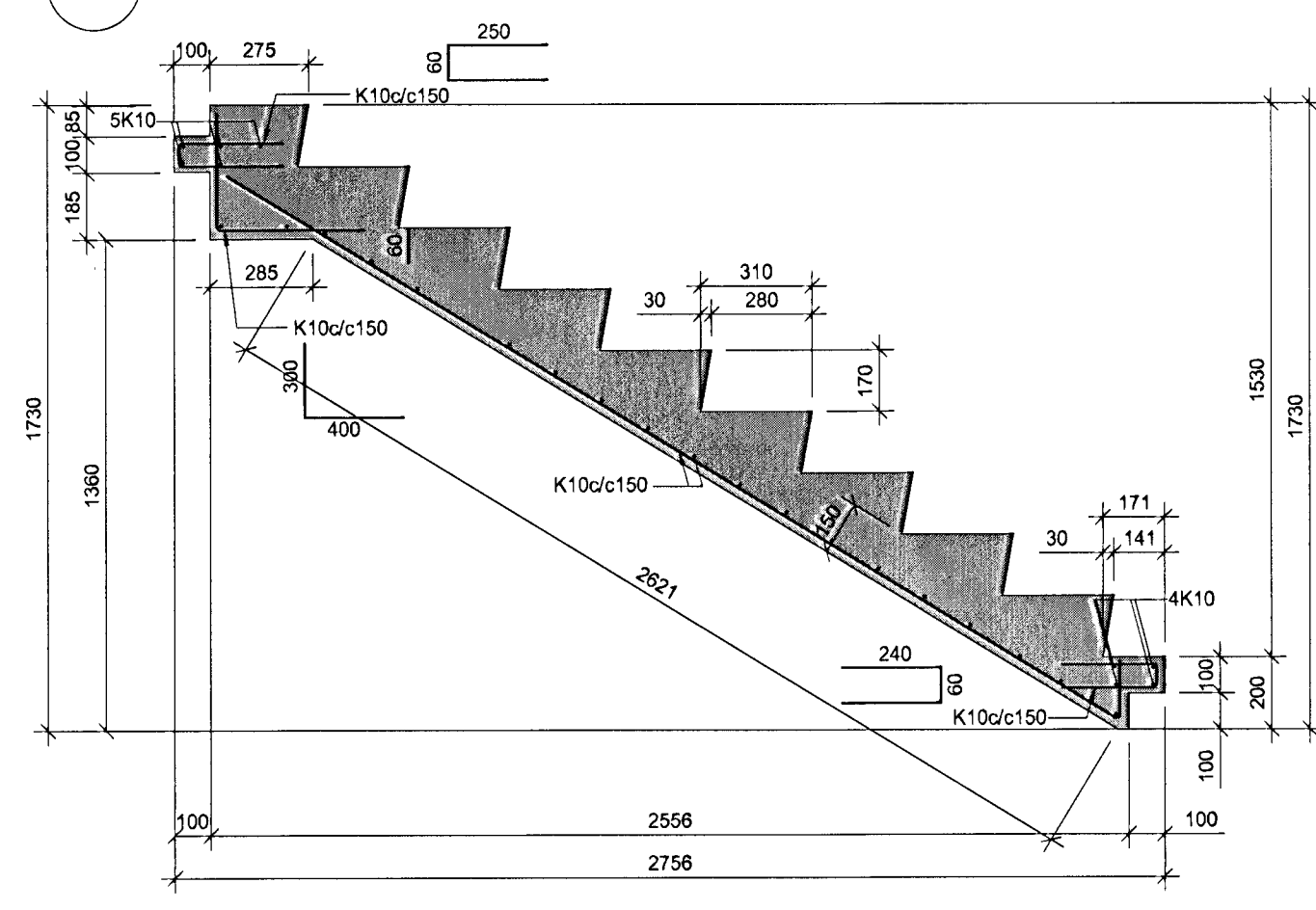

**STIGAHLAUP ST3 - 2 STK 1:20**  
ST3 ERU STIGAHLAUP FRÁ 1. HÆÐ UPP Á STIGAPALL MILLI 1.- OG 2. HÆÐAR

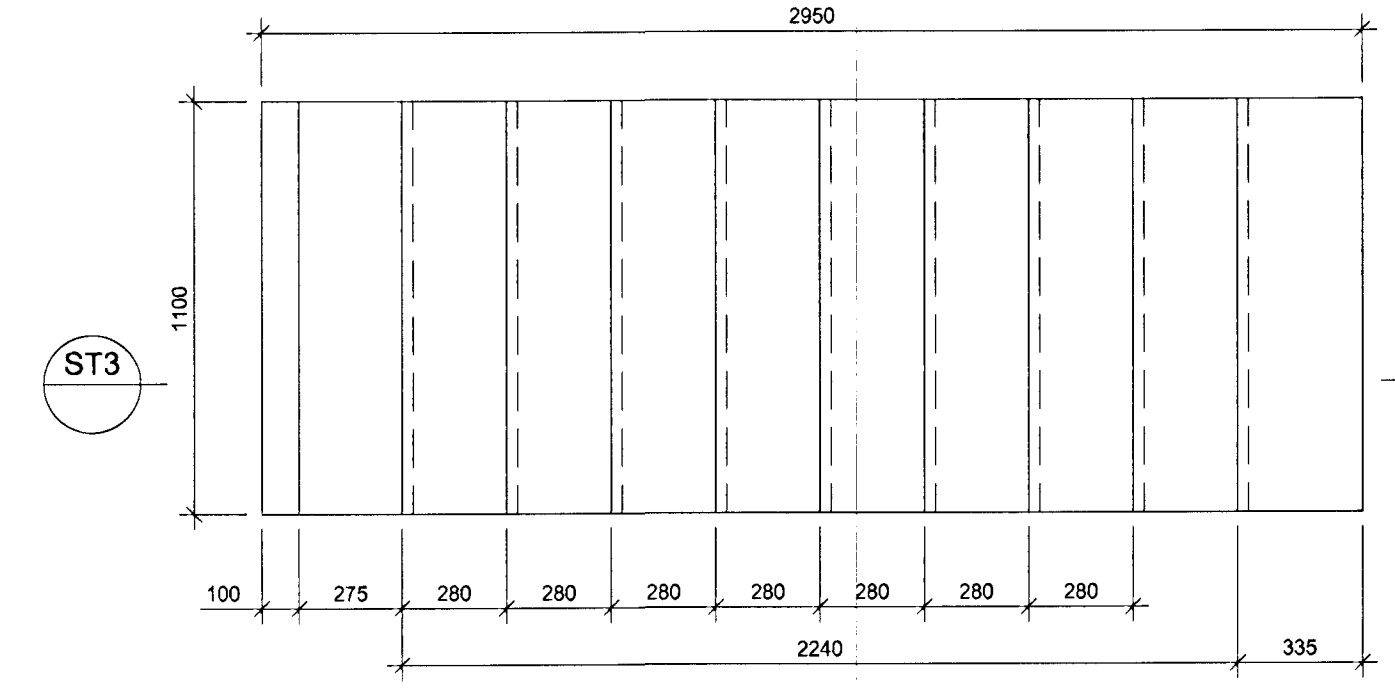

**ST3 SNID 1:20**

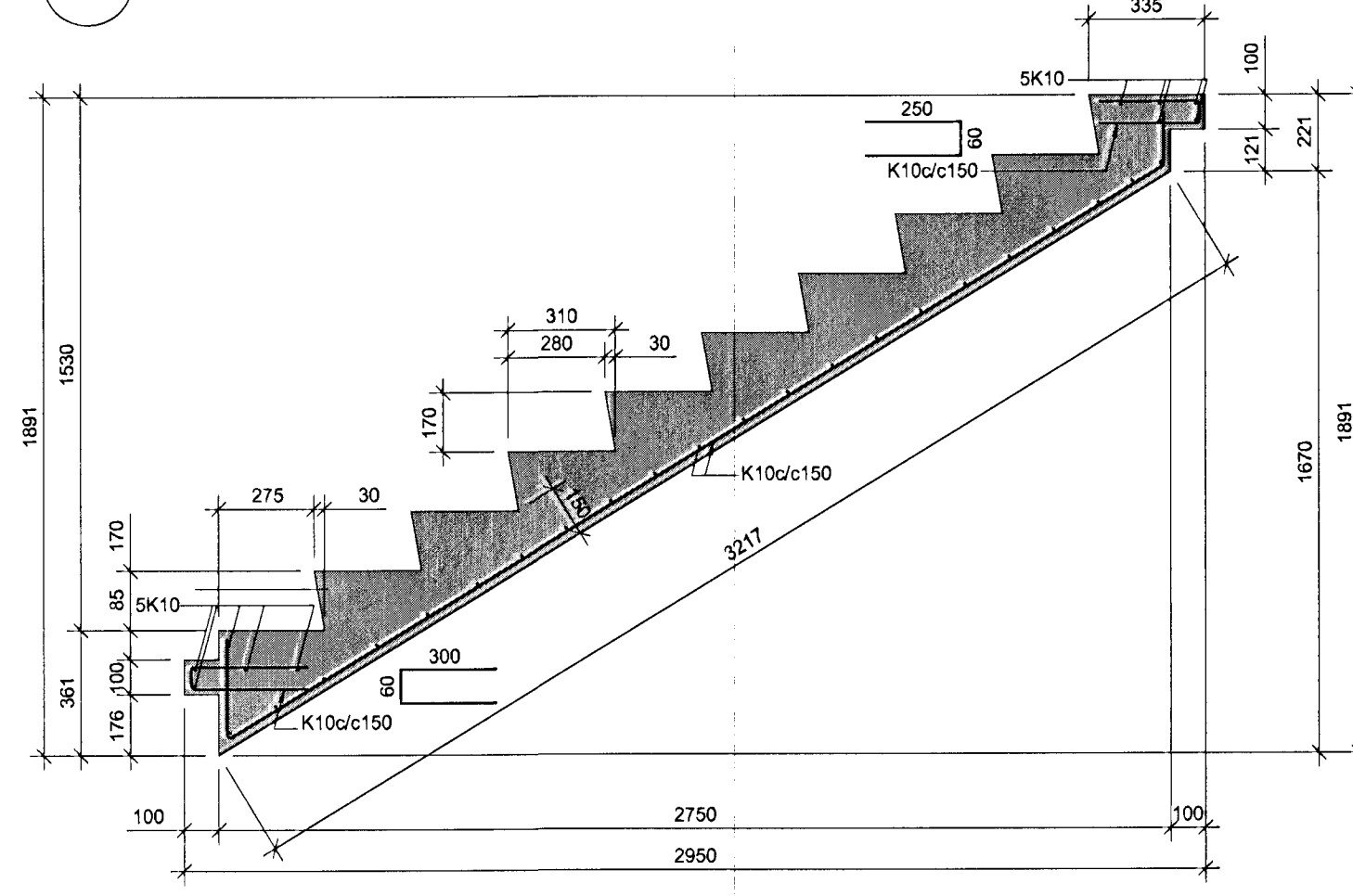

Samþykkt bann  
23. maí 2012  
Bygginguálfurinn í Hafnarfirði  
F.h. Heiður S. Gunnþugsson

ARTUN SAMRÆMINGARÞÖNNUBAR

**STIGAHLAUP ST4 - 8 STK 1:20**  
ST4 ERU STIGAHLAUP FRÁ STIGAPÖLLUM (MILLIPÖLLUM) UPP Á 2., 3., 4.- OG 5. HÆÐ

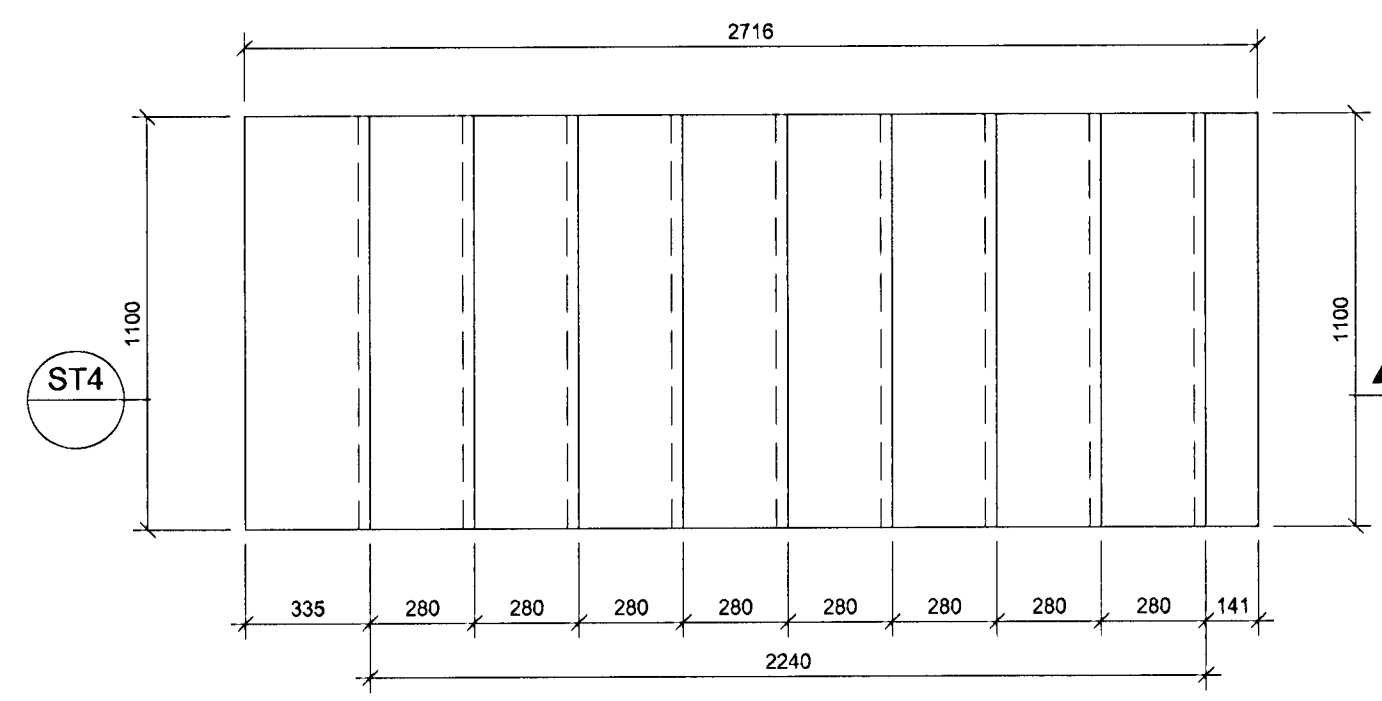

**ST4 SNID 1:20**

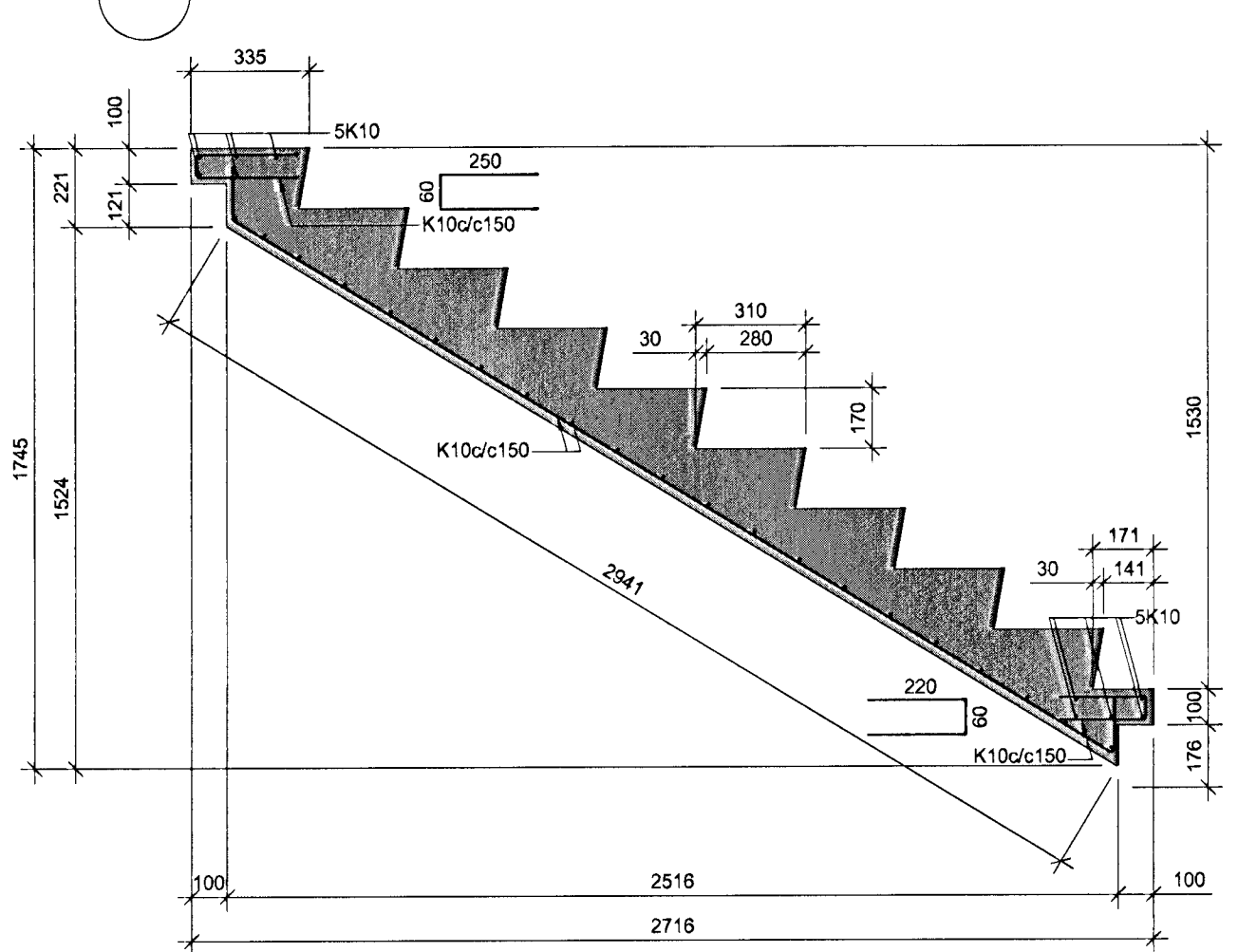

**STIGAHLAUP ST5 - 6 STK 1:20**  
ST5 ERU STIGAHLAUP FRÁ 2., 3.- OG 4. HÆÐ UPP Á STILAPALLA (MILLIPALLA)

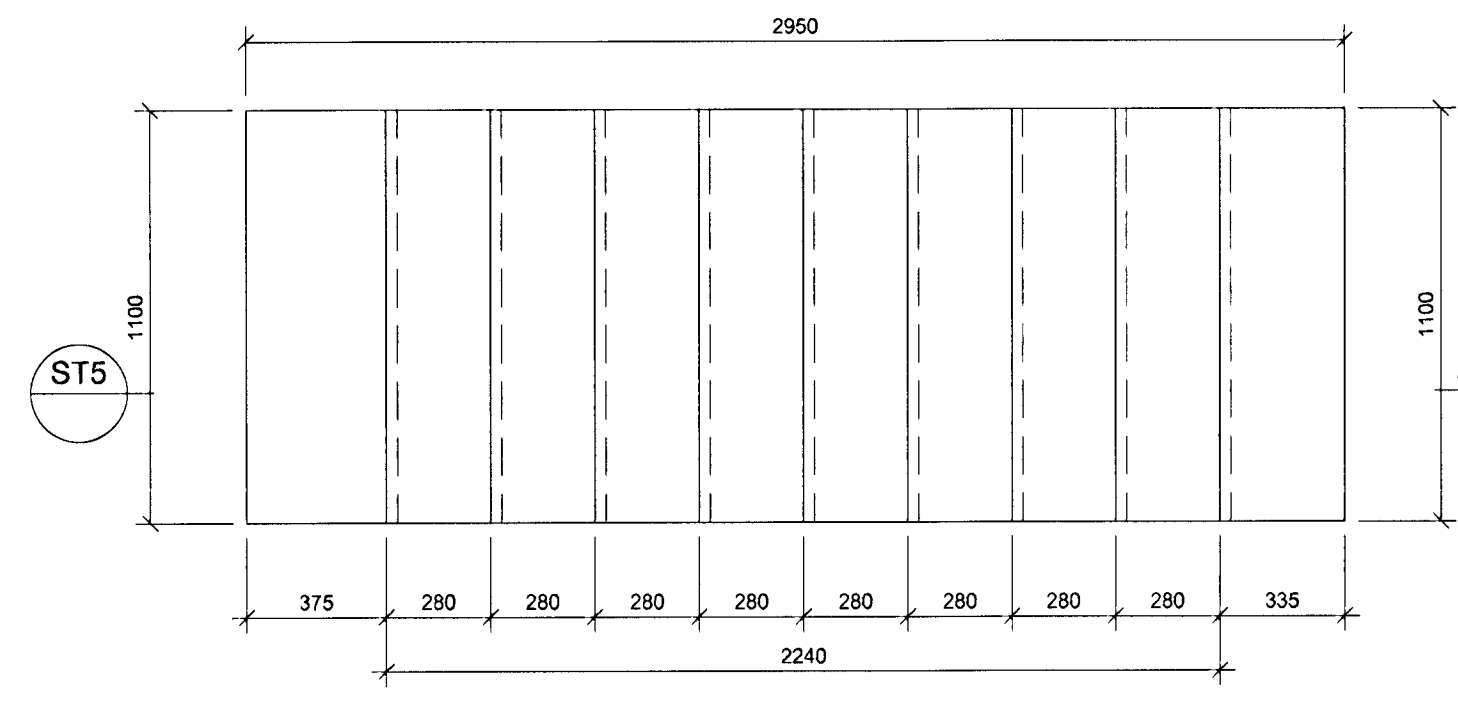

**ST5 SNID 1:20**

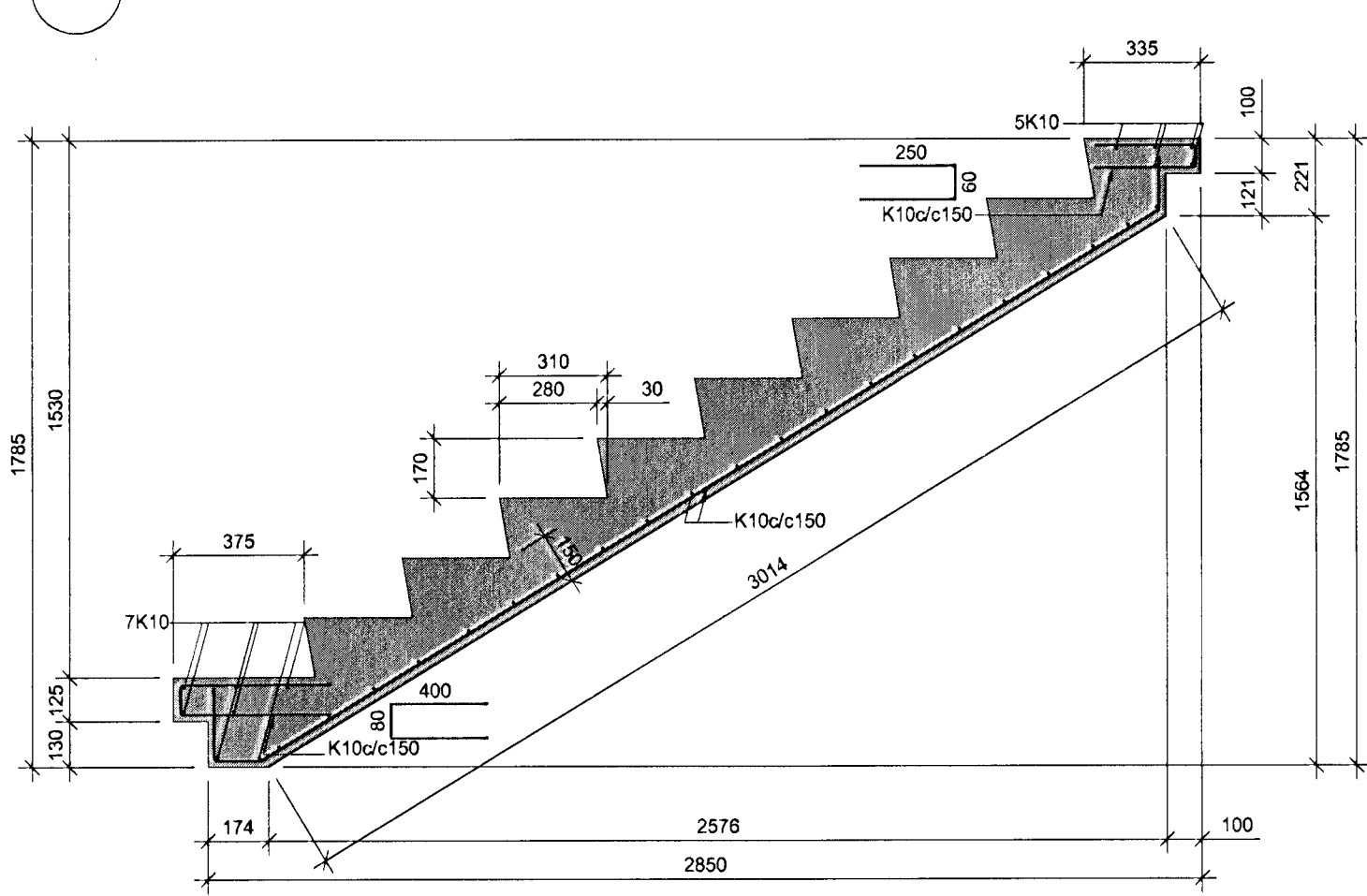

**STEYPA Í STIGAHLAUP:**

BROTÞOLSFLOKKUR:	C25/30
SEMENTSMAGN:	MINNST 320 kg/m³
VATNSSEMENTSTALA:	< 0,50
HÁMARKSSTEINASTÆRD:	25 mm
LOFTINNIHALD:	5 - 6%
FJÄRL-STUÐULL LOFTS:	< 0,25mm
LÁGMARKSHULA:	25 mm

**TILVÍSANIR:**

ALMENNAR SKÝRINGAR . . . . SJÁ BL. NR. B(15-21)\_001

**NORÐURBAKKI 21**

BURÐARVIRKI  
SÉRMYNDIR AF STIGAHLAUPUM

MKV:	1:20
DAGS:	14.05.2012
HANNAÐTEIKN:	JB/SG
VEIKNÚL:	05/04

