

T1

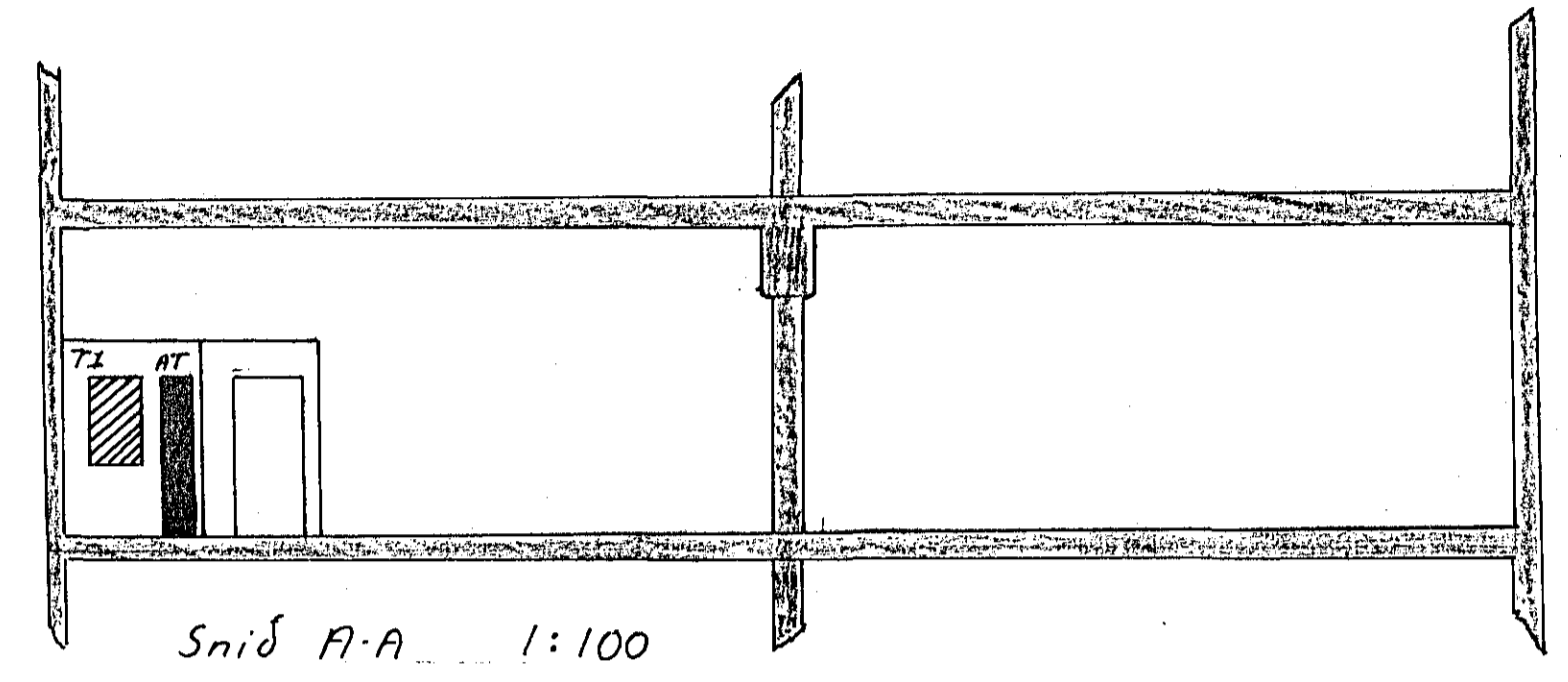

lagnir eru kapalagnir NYM 3x1.5g  
 Lagðar í kapalstiga, plastrennur,  
 eða dregnar í hlífðarrör. Hæð á  
 rofum og tenglum sé 110cm. Málstraumur  
 rofa sé 10A, en tengla 16A.  
 F: Bajarsimi  
 Nema annars  
 sé getið.

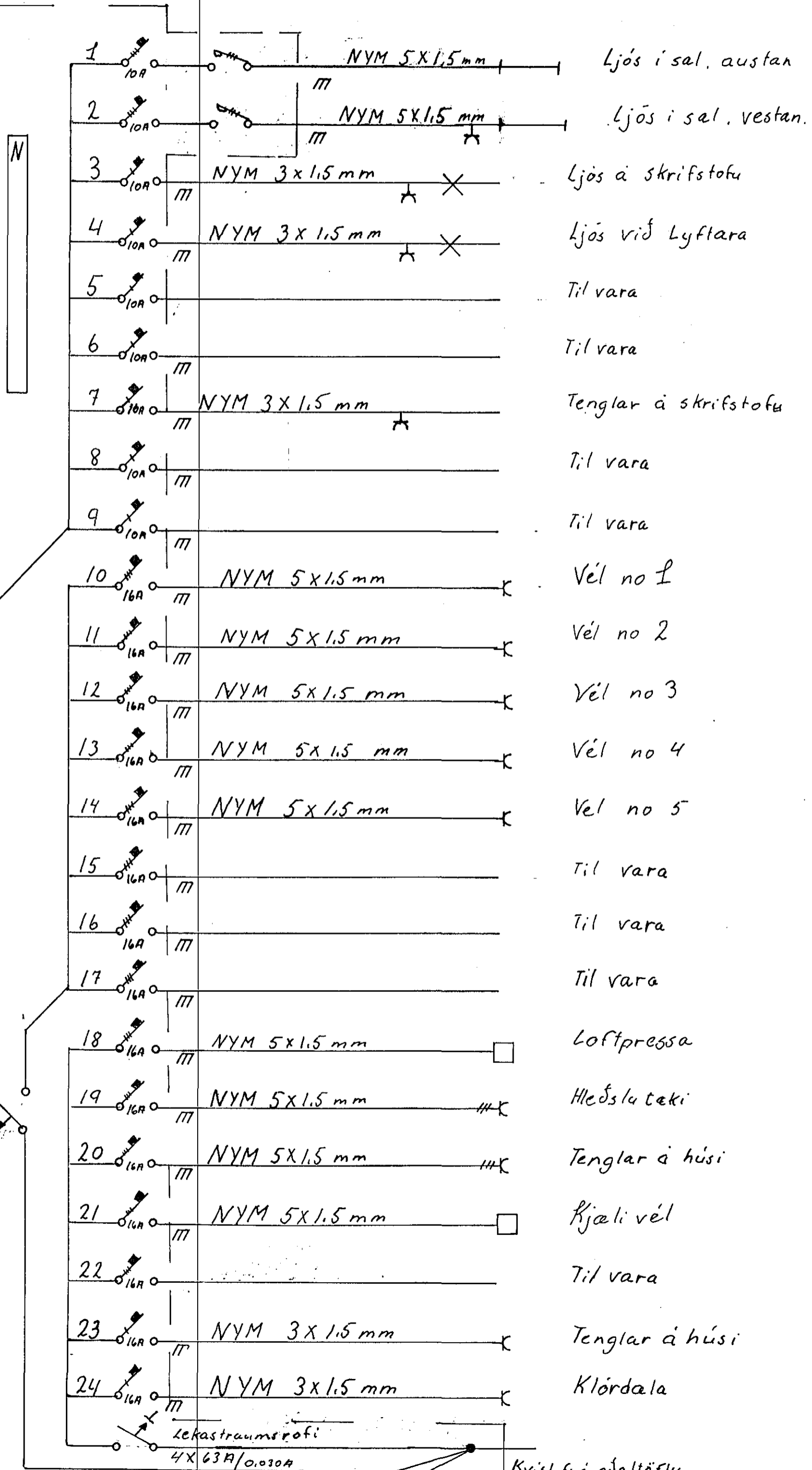
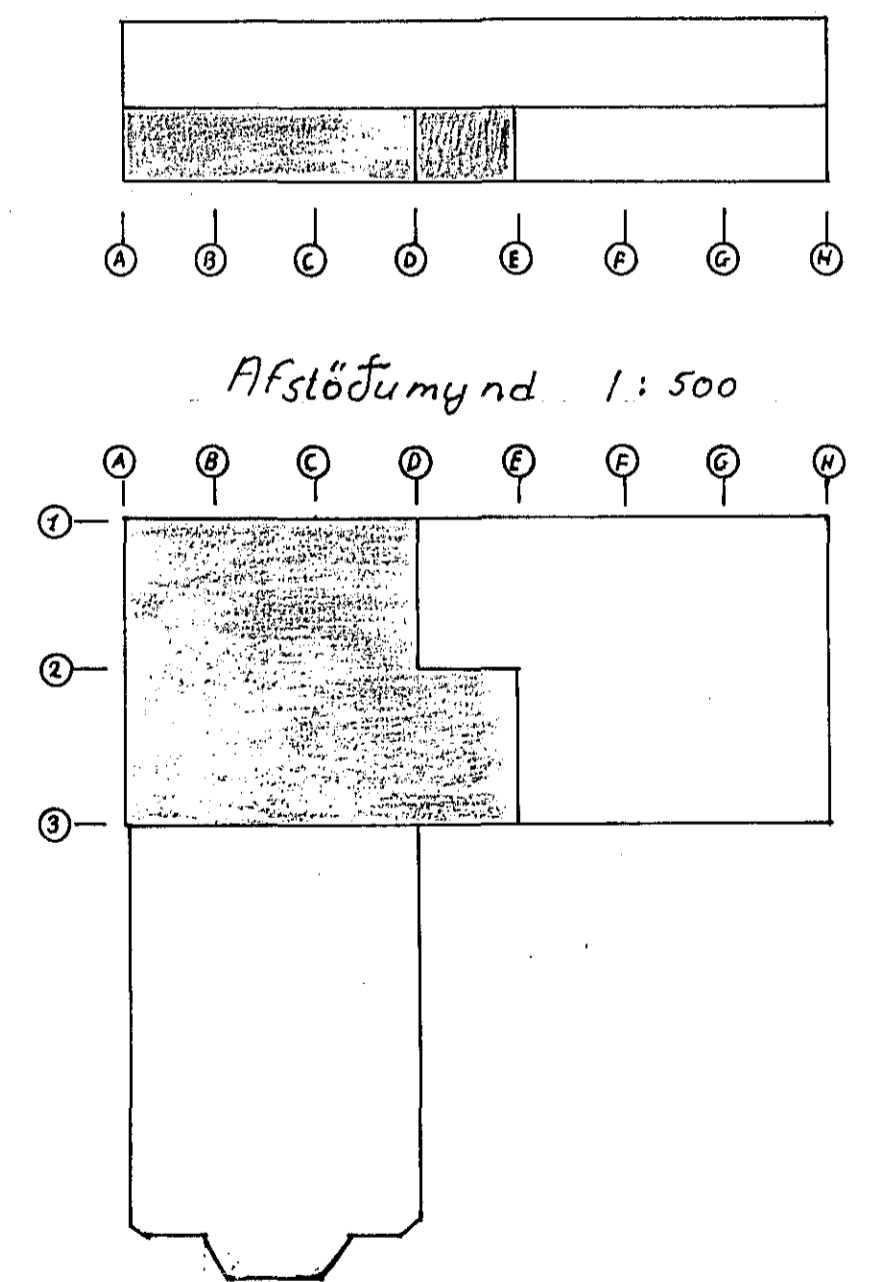

Töfluteikning, afstöðumynd, Snid	
Feb 1992	Guðm. R. Leharsson S: 54451
T: GE	Fiskverkun Vilhjálm Sveinss.