

Samþykkt þánn
06. jan. 2023
fr. byggingarfalltréans í Hafnarfirði
Róbert A. Róbertsson

Airun hönnunarstjóra:
Höfuð Msr. Halldórsson
Dagsetning aðalþröðrta: 22.10.2022
Skýringar:

Knattsalur

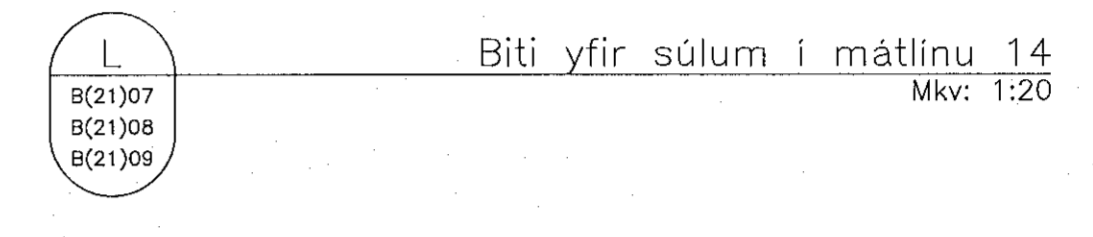
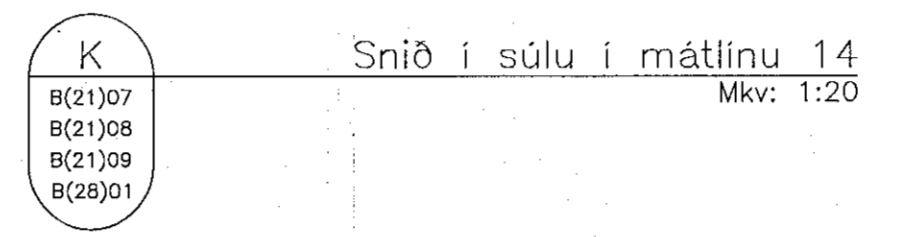
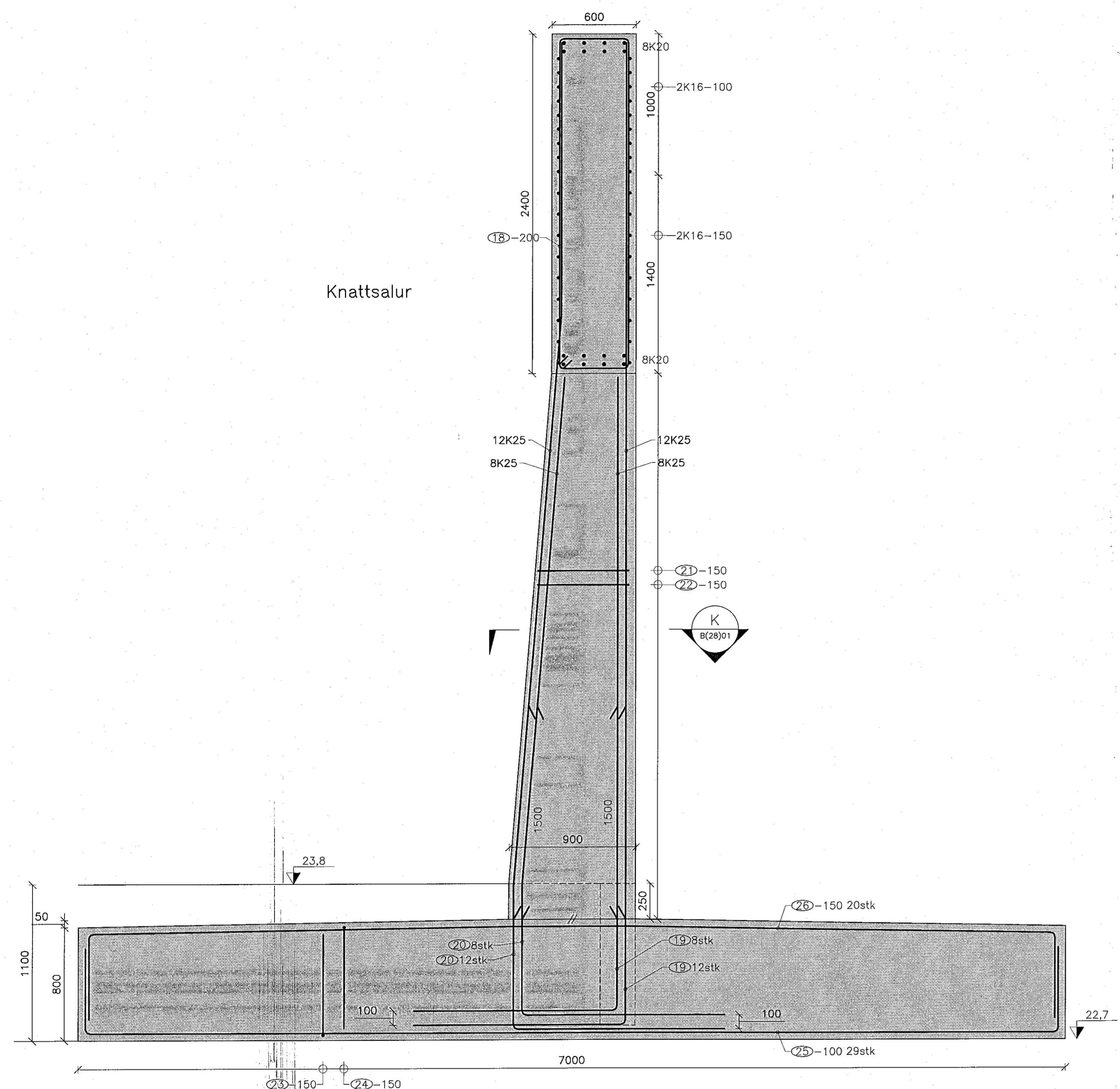

Súlu í mätlinu 14
Mkv: 1:20

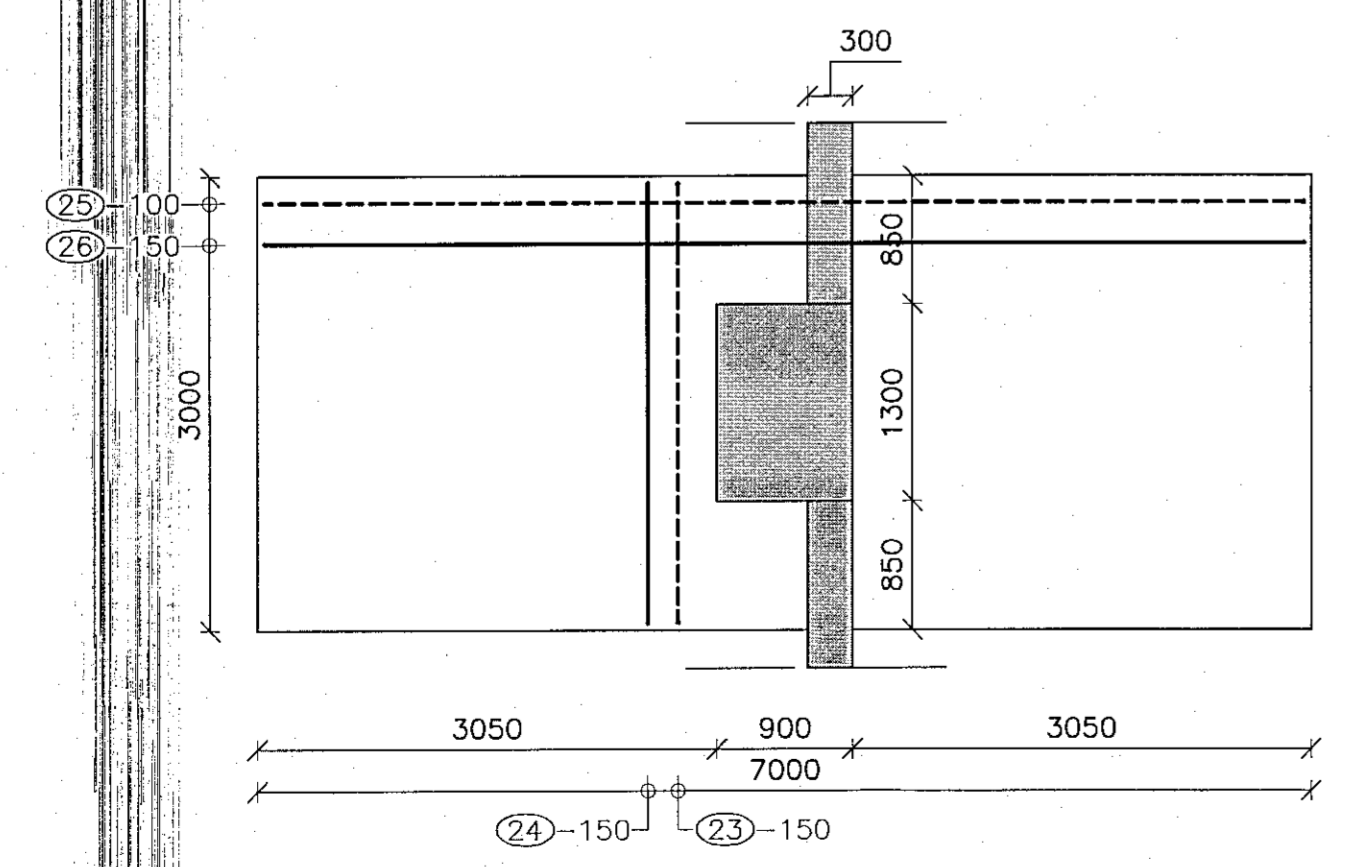

Sökkull undir súlum í mätlinu 14
Mkv: 1:50

18	K10-L= 5840 2330	23	K16-L= 4300 2900
19	K25-L= 3800 2300 1500	24	K16-L= 4300 2900
20	K25-L= 3800 800 1500	25	K20-L= 8100 6900
21	K10-L= 2460-3060 600 Breytilest 530-830	26	K16-L= 8100 3050 900 3050
22	K10-L= 3720-4320 1230 Breytilest 530-830		

J
B(21)07
B(21)08
B(21)09

J
B(21)07
B(21)08
B(21)09

1	Fræðingur	5.12.2022	HJE
△	Breytingar:	Dags:	HG:
		Háaleitibraut 58-60 108 Reykjavík Sími: 570-0500 Fax: 570-0503 www.ohnit.is	
Hanna: BMG	Tekna: JPG	Yfirfari: HJE	
Tölvaðskrá: B(28)01 SÚLUR Í MÁTLINU K.DWG			
Kl: 131167-5479		Dags: 5.12.2022	
Samþykkt: <i>Hanna Einarsson</i>			
Knattús Hauka			
Búrðarþol			
Súlu í mätlinu 14 og biti			
Verk nr.: 21237	frumst. blátt: A1	Tekn. nr.:	Útg.:
Mkv.: 1:20	1:50		B(28)01 1