

Samþykkt þann
13. MAÍ 2022

Byggingarfulltrúinn í Hafnarfirði
Sleður Þorvaldur

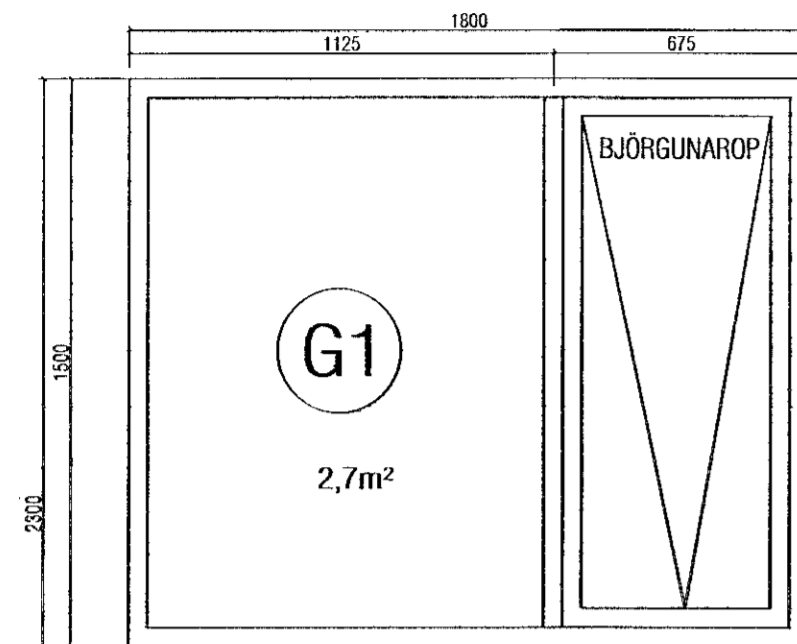

G 1 = 1 STK

FULLFRÁGENGID GÓLF

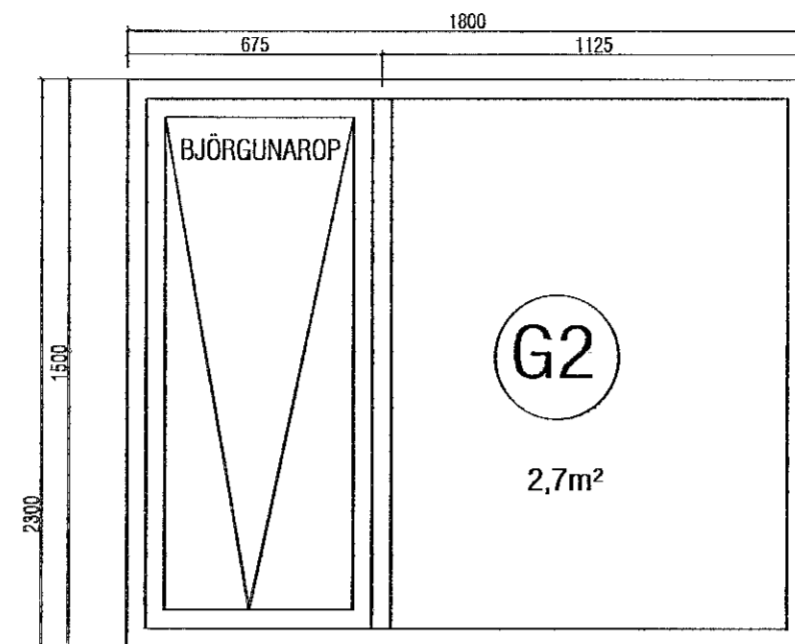

G 2 = 1 STK

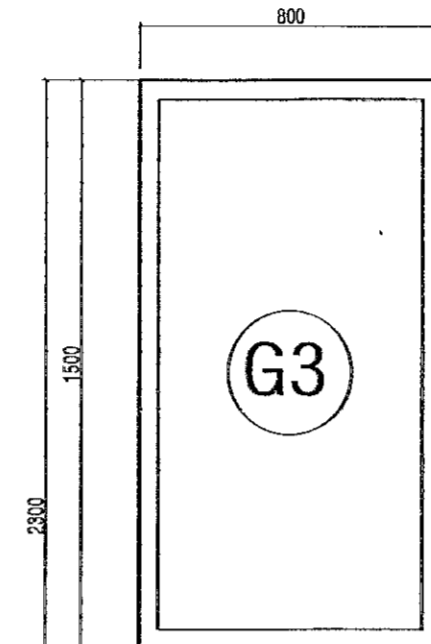

G 3 = 2 STK

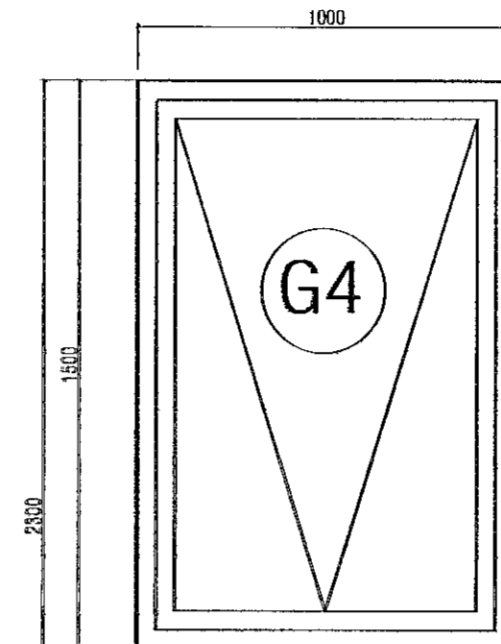

G 4 = 1 STK

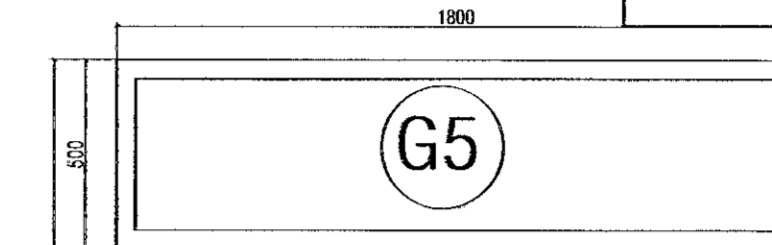

G 5 = 1 STK

Allar málsetningar miðast við ísteypta glugga og hurðir.
Mál skulu takast á staðnum ef um eftirá ísetta glugga eða hurðir er að ræða áður en smíði hefst.
Þröskuldar skulu uppfylla kröfur BR. um aðgengi fatlaðra.
Val glertegunda skal vera í samræmi við RB-blað 31.121.1
Stærð björgunaropa og hurða skulu uppfylla kröfur byggingareglugerðar.

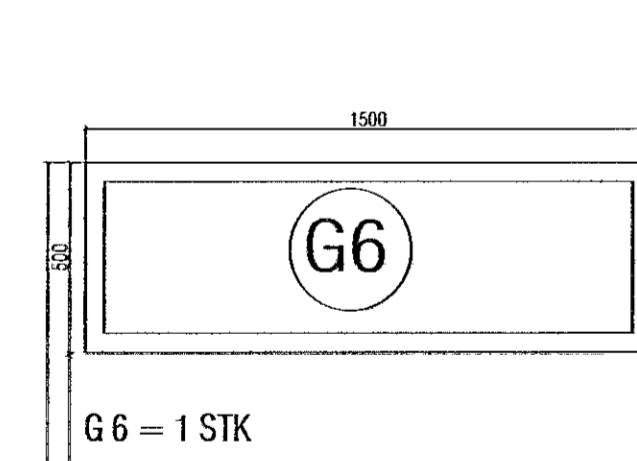

G 6 = 1 STK

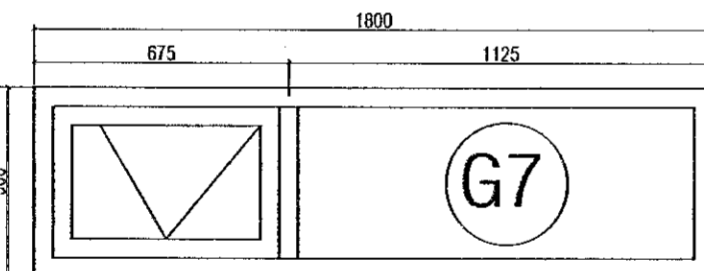

G 7 = 3 STK

FULLFRÁGENGID GÓLF

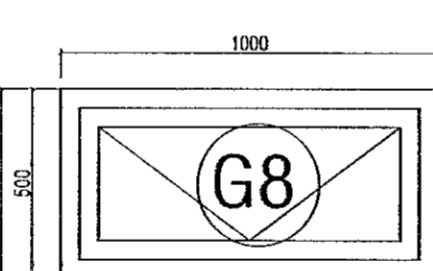

G 8 = 1 STK

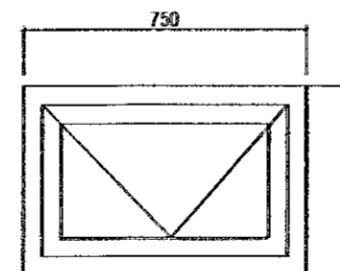

G9 HORNGLUGGI 1 STK.

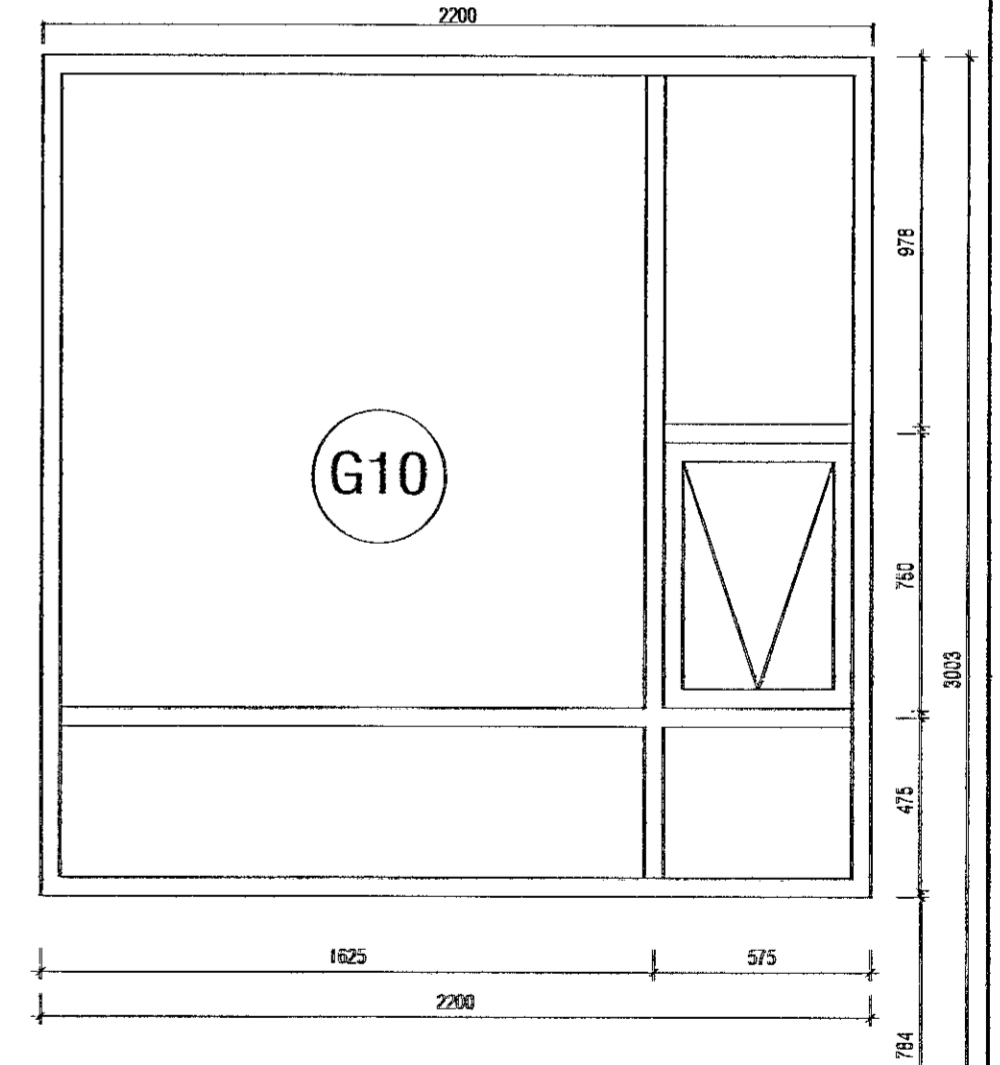
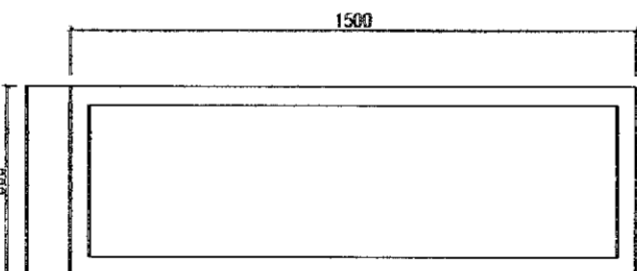

ERRO hönnun
Brattatunga 6, 200, Kópavogi.
Netfang: errohonnun@internet.is

Teikn. nr. _____
Sambýkt _____

Pákarður Oddsson
byggingarfræðingur
sími: 896-4065
f. 270261-5159

Br. _____
Dags. _____

HÁDEGISSKARÐ 8 HAFNARFIRÐI
GLUGGATEIKNING

Rönnud	RO	Teiknad	RO
Dagsetning	20-04-2022	Vark nr.	022021
Málkerfi	1/10	Teikn. nr.	S-07