

Deili 9 - A414a
1:10

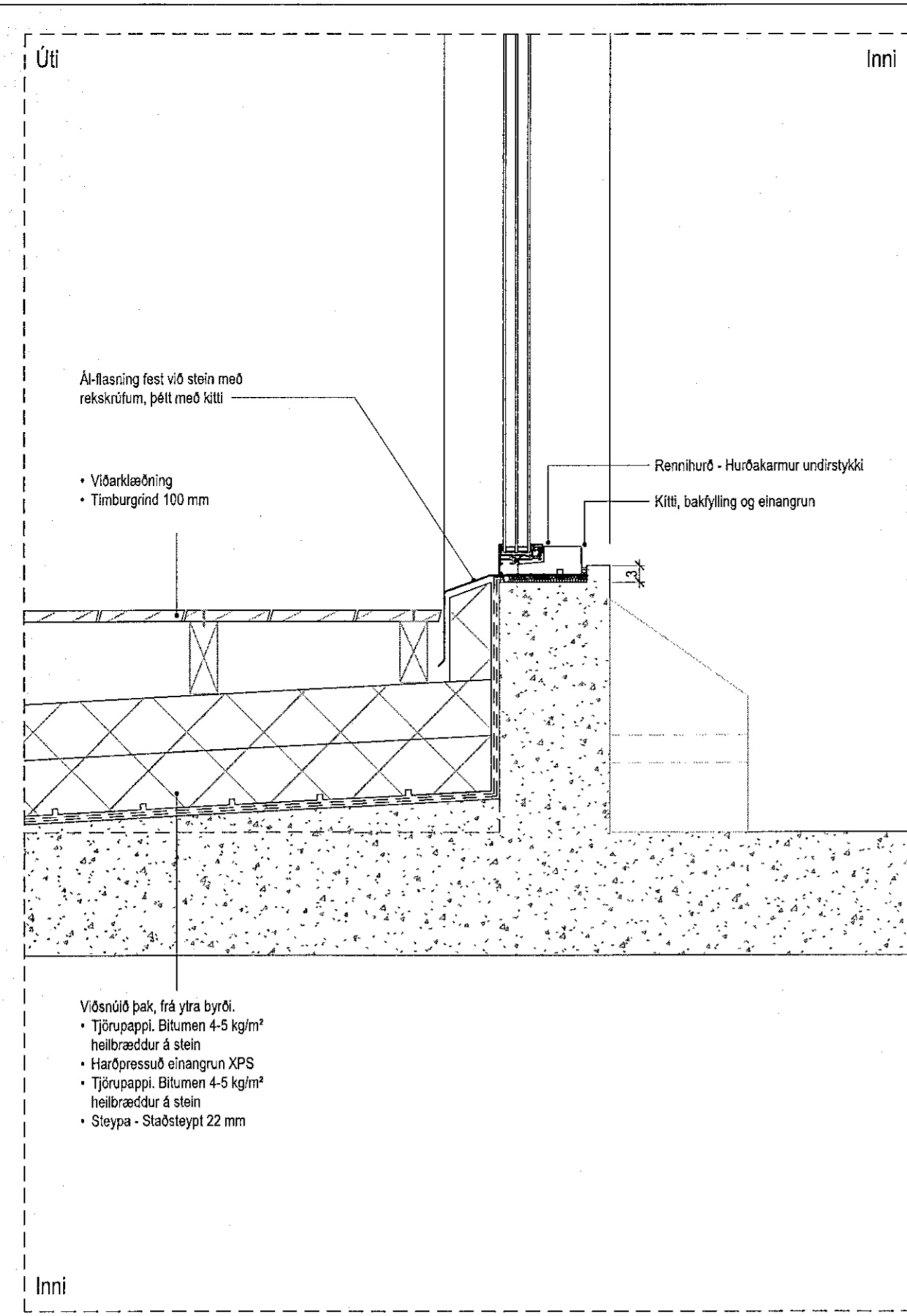

Deili 10 - A414a
1:10

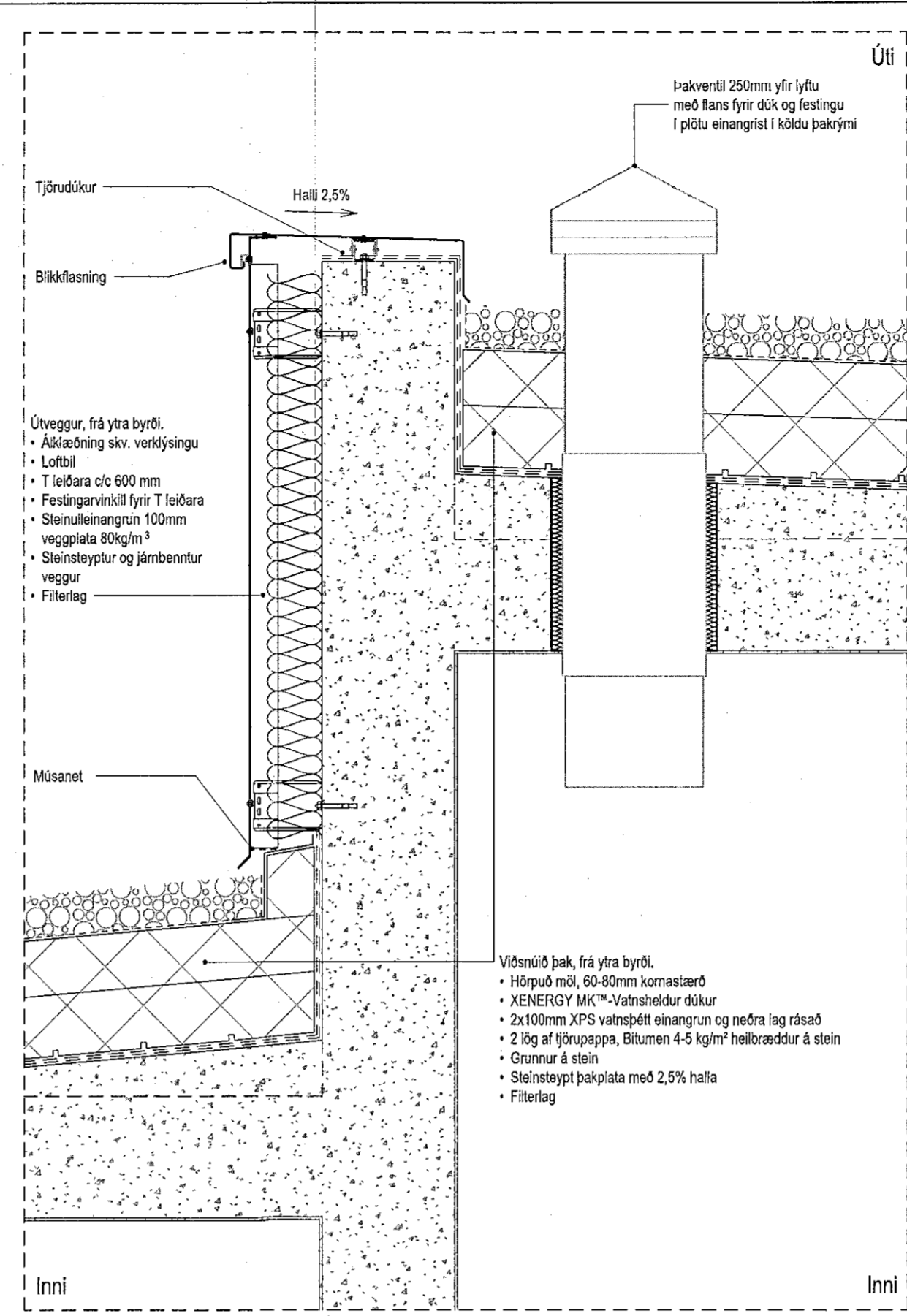

Deili 11 - A414a
1:10

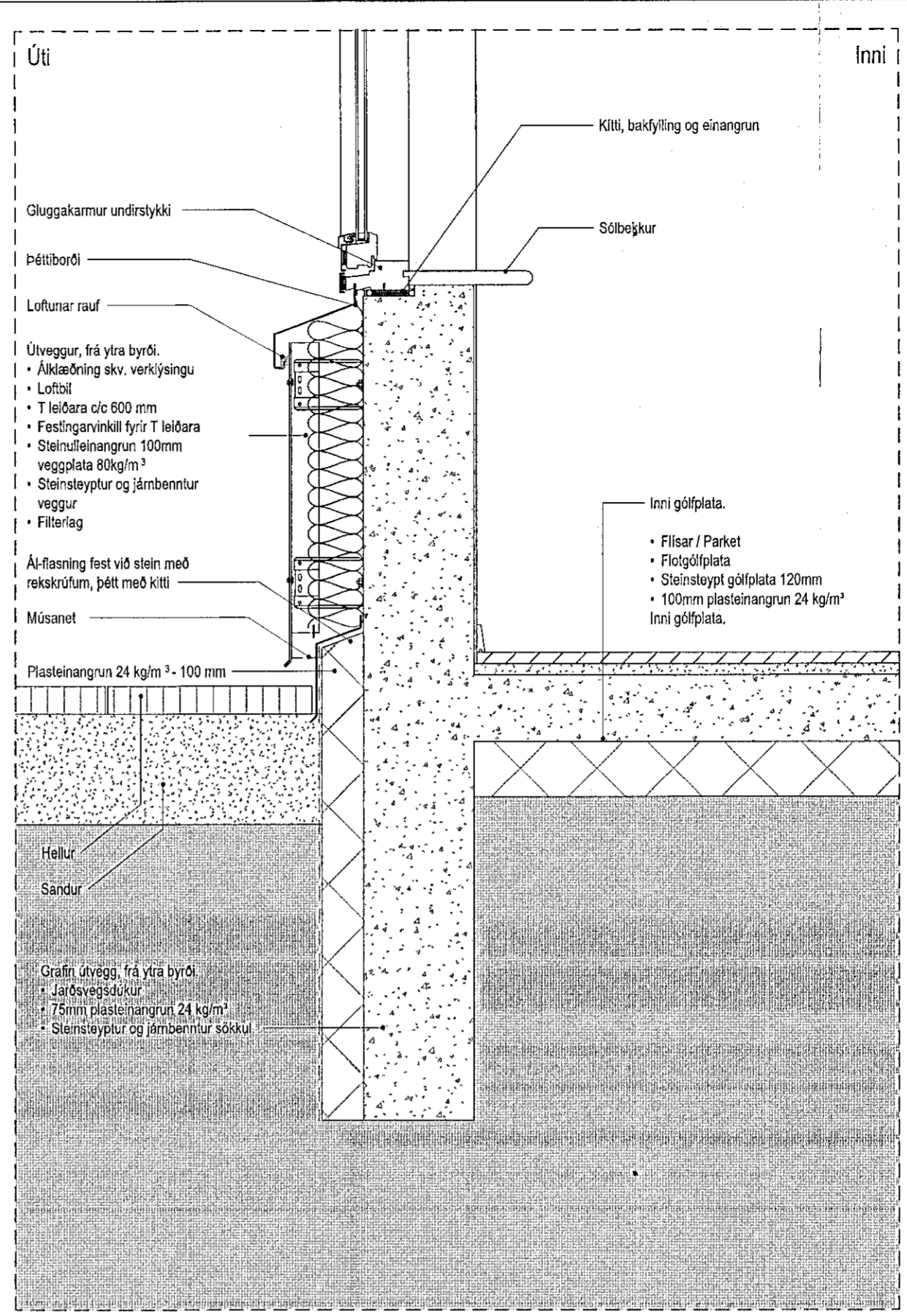

Deili 12 - A414a
1:10

Tákn

GN	= Gólfhurfall	Brunatákn
HN	= Þakhurfall	Veggir og hæðakill
SN	= Svavallhurfall	E190
LR	= Loftbrasing	A-E190
VLR	= Vöðmúð loftbrasing	A-E1120
PK	= Þróðassar	RE190
NL	= Neyðarljós	RE1120
BO	= Björgunarpop	A-REMI120
R	= Reykskyggir	Hurtr
HSL	= Hæðskilvæðing	E30/CS
ÚT	= Merkur útgangur	E190-CS
HV	= Hítavél	E190-CS
VV	= Vöðmúð	Gluggar
RR	= Ráðsgravelta	E30
ÚK	= Útkrani	
DS	= Dyraarmi	
BO	= Felstígi við björgunarpop	
BR	= Brunaslanga	
ST	= Stiglesta	
ST	= Stiglesta út	
ST	= Stiglesta brúnaðvörðunarkerfis	
IN	= Inntak	
BL	= Blástæði fyrir fallböda	

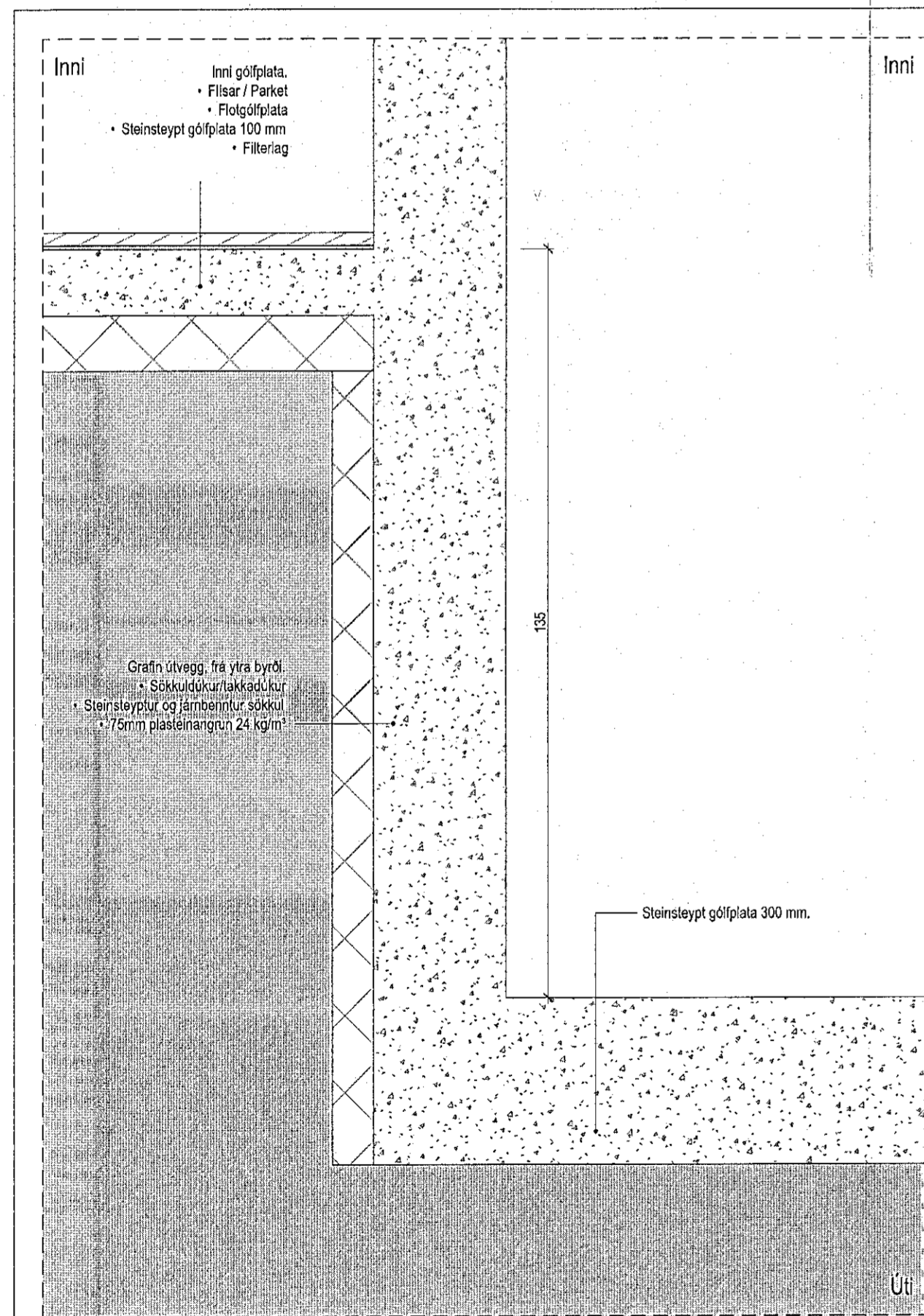

Deili 13 - A414a
1:10

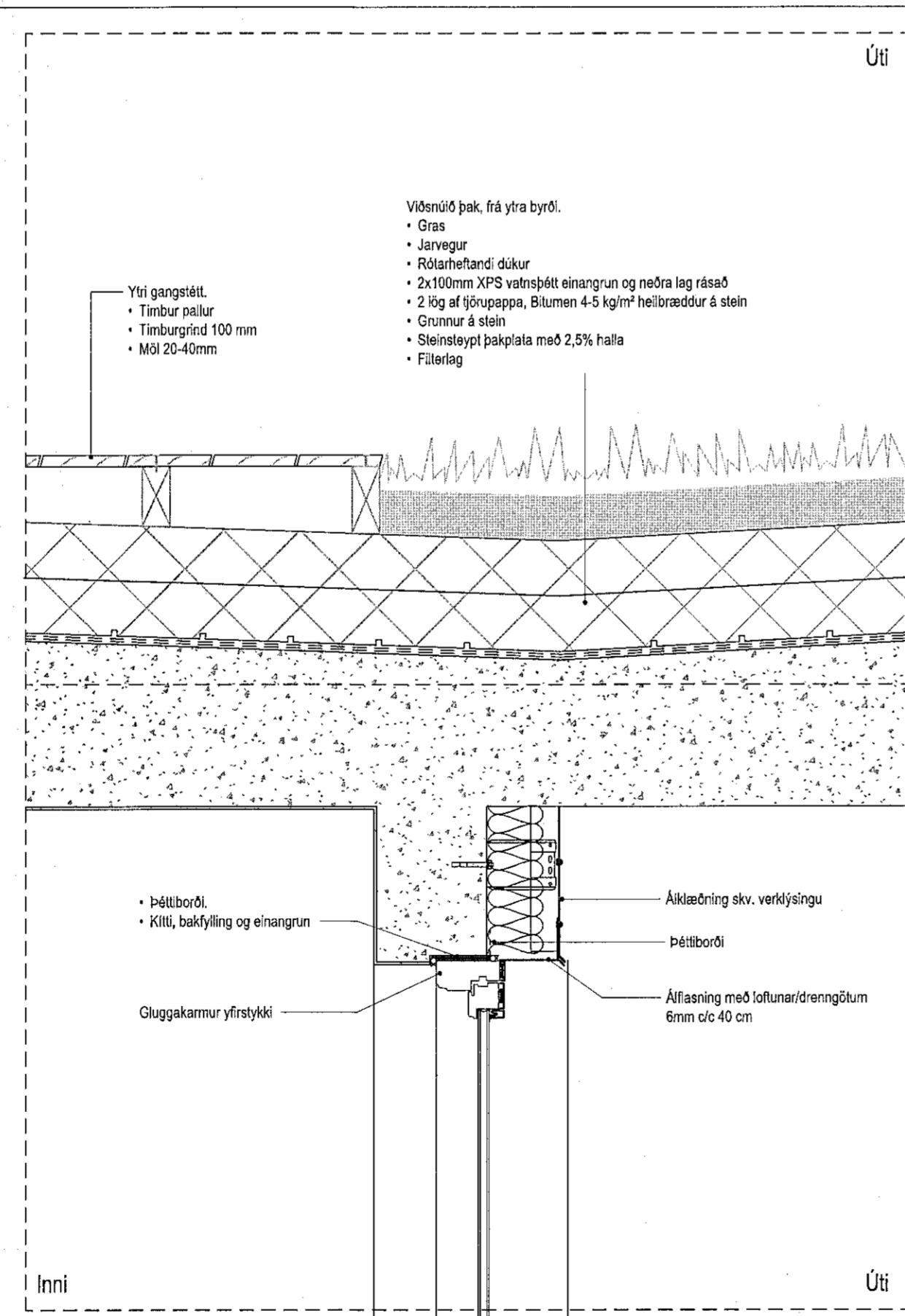

Deili 14 - A415a
1:10

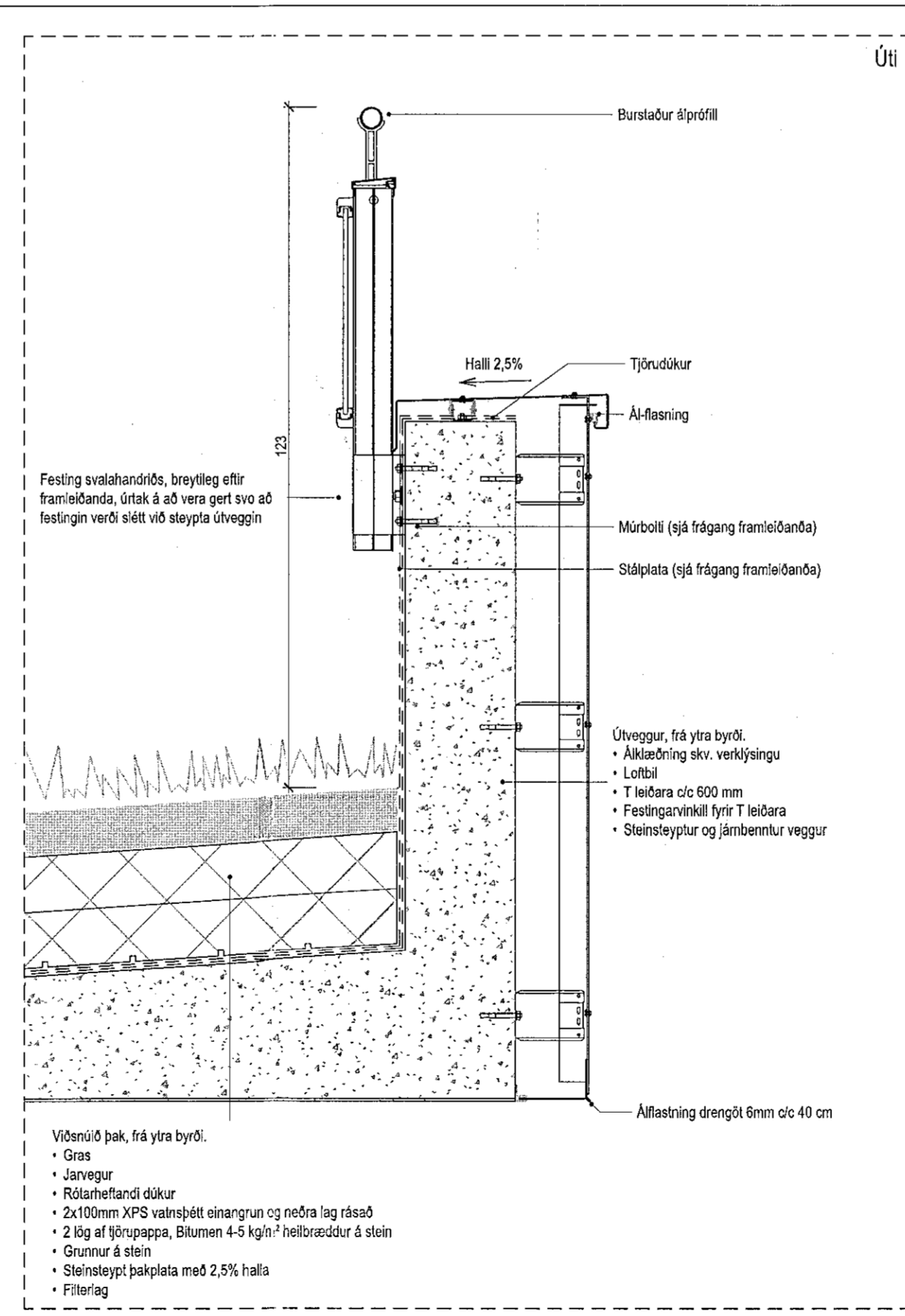

Deili 15 - A415a
1:10

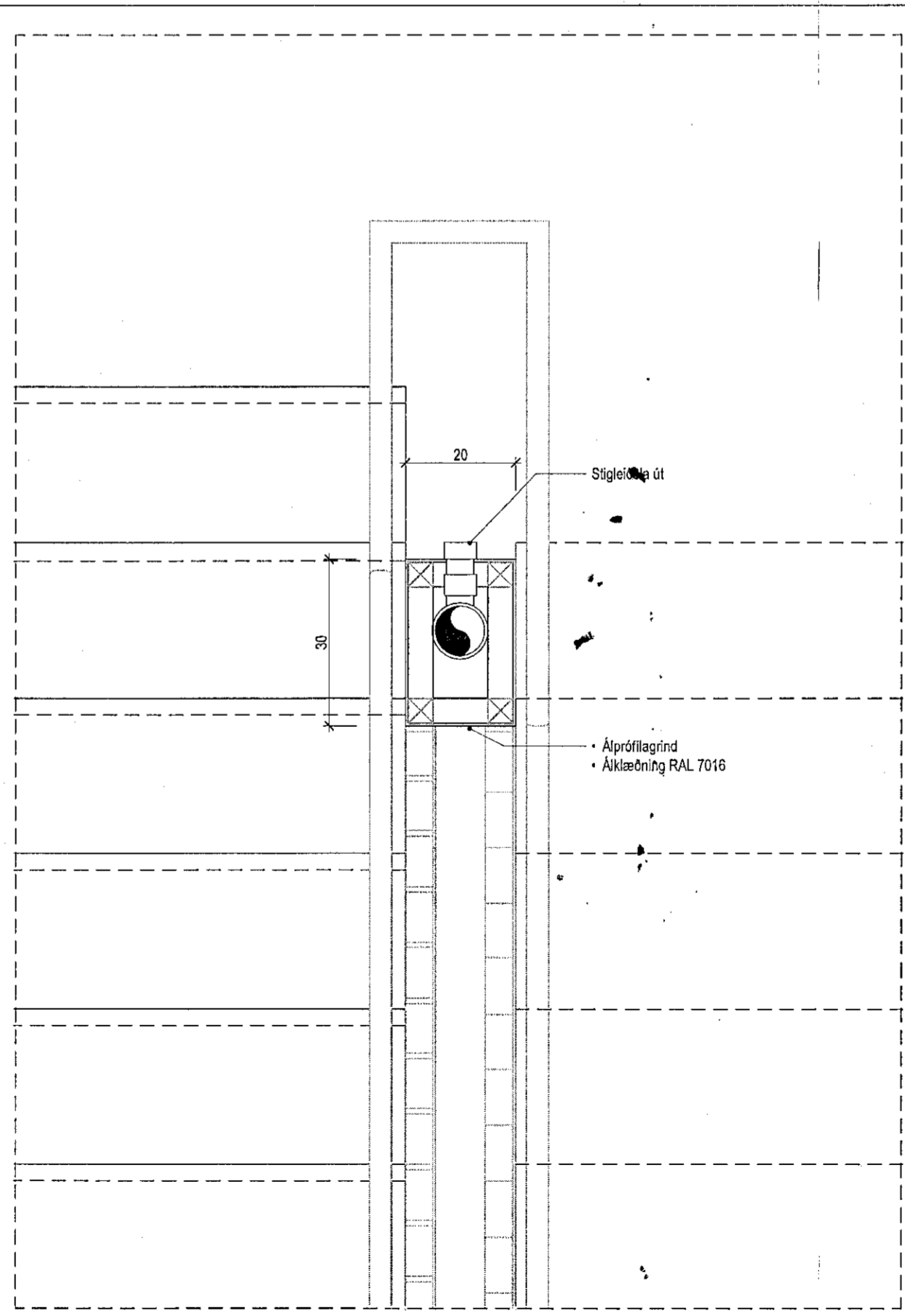

Deili 16 - A402a
1:10

Útg.	Dags.	Lýsing	Nafn
------	-------	--------	------

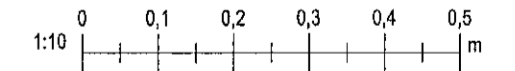

KRark Kristinn Regnarsson arkitekt ehf.
Hlíðsmári 19 - 2 hæð, 201 Kópavogur
S. 564.2295, krark@krark.is
Kt. 581298.3589, www.krark.is

Hringhamar 21
Hafnarfjörður

Landeignanúmer: L231561

Deili 9 - Deili 16. Mhl. 01

Fjálflystjórn	Sérstjórn
Verkefni: 21039BD	Aðalhönnuður: Kristinn Regnarsson
Málkvæði: 1:10	Kt. 581298.3589
Dagsetning: 05.04.2022	Hönnunartíðni: Kristinn Regnarsson
Hönnun: KR,RCM	1203/4/2022
Verkefnastjórn: RCM	Blá: Útgefna
Tekna: RLF,PTG	A502
Yfirfarir: RCM,LPM	