

| Ofnatafla 2.hæð 9-11 | | | | | |
|----------------------|--------|----------|------------|------------|---------|
| Númer | Gerð | Hæð [mm] | Lengd [mm] | Afköst [W] | Tenging |
| 1-201-01 | Handkl | 1300 | 590 | 300 W | E-F |
| 1-201-02 | 21 | 400 | 1000 | 537 W | A-B |
| 1-201-03 | 21 | 400 | 800 | 430 W | A-B |
| 1-201-04 | 22 | 400 | 1200 | 834 W | A-B |
| 1-202-01 | Handkl | 1300 | 590 | 300 W | E-F |
| 1-202-02 | 21 | 400 | 800 | 430 W | A-B |
| 1-202-03 | 22 | 400 | 1800 | 1251 W | A-D |
| 1-202-04 | 22 | 400 | 1800 | 1251 W | A-D |
| 1-202-05 | 21 | 400 | 800 | 430 W | A-B |
| 1-202-06 | 21 | 400 | 800 | 430 W | A-B |
| 1-203-01 | Handkl | 1300 | 590 | 300 W | E-F |
| 1-203-02 | 21 | 400 | 800 | 430 W | C-D |
| 1-203-03 | 22 | 400 | 1800 | 1251 W | B-C |
| 1-203-04 | 22 | 400 | 1800 | 1251 W | B-C |
| 1-203-05 | 21 | 400 | 800 | 430 W | C-D |
| 1-203-06 | 21 | 400 | 800 | 430 W | C-D |
| 1-204-01 | Handkl | 1300 | 590 | 300 W | E-F |
| 1-204-02 | 21 | 400 | 1000 | 537 W | C-D |
| 1-204-03 | 22 | 400 | 1200 | 834 W | C-D |
| 1-204-04 | 21 | 400 | 800 | 430 W | C-D |
| 1-205-01 | Handkl | 1300 | 590 | 300 W | E-F |
| 1-205-02 | 22 | 400 | 1800 | 1251 W | B-C |
| 1-205-03 | 22 | 400 | 1200 | 834 W | A-B |
| 1-205-04 | 21 | 400 | 1000 | 537 W | A-B |
| 1-206-01 | Handkl | 1300 | 590 | 300 W | E-F |
| 1-206-02 | Handkl | 1300 | 590 | 300 W | E-F |
| 1-206-03 | 22 | 400 | 1800 | 1251 W | A-D |
| 1-206-04 | 22 | 400 | 1800 | 1251 W | A-D |
| 1-206-05 | 21 | 400 | 1000 | 537 W | A-B |
| 1-206-06 | 21 | 400 | 1200 | 645 W | A-B |
| 1-206-07 | 21 | 400 | 1600 | 860 W | A-D |
| 1-207-01 | 21 | 400 | 1800 | 967 W | B-C |
| 1-207-03 | 22 | 400 | 1200 | 834 W | A-D |
| 1-207-04 | 21 | 400 | 1600 | 860 W | A-D |
| 1-207-05 | Handkl | 1300 | 590 | 300 W | E-F |
| 1-208-01 | Handkl | 1300 | 590 | 300 W | E-F |
| 1-208-02 | 22 | 400 | 1800 | 1251 W | A-D |
| 1-208-03 | 22 | 400 | 1200 | 834 W | A-B |
| 1-208-04 | 21 | 400 | 1200 | 645 W | A-B |
| 1-208-05 | 21 | 400 | 1200 | 645 W | A-B |
| 1-212-01 | 21 | 400 | 1200 | 537 W | A-B |

| Ofnatafla 3.hæð 9-11 | | | | | |
|----------------------|--------|----------|------------|------------|---------|
| Númer | Gerð | Hæð [mm] | Lengd [mm] | Afköst [W] | Tenging |
| 1-301-01 | 21 | 400 | 1000 | 537 W | A-B |
| 1-301-02 | Handkl | 1300 | 590 | 300 W | E-F |
| 1-301-03 | 21 | 400 | 800 | 430 W | A-B |
| 1-301-04 | 22 | 400 | 1200 | 834 W | A-B |
| 1-302-01 | Handkl | 1300 | 590 | 300 W | E-F |
| 1-302-02 | 21 | 400 | 800 | 430 W | A-B |
| 1-302-03 | 22 | 400 | 1800 | 1251 W | A-D |
| 1-302-04 | 22 | 400 | 1800 | 1251 W | A-D |
| 1-302-05 | 21 | 400 | 800 | 430 W | A-B |
| 1-302-06 | 21 | 400 | 800 | 430 W | A-B |
| 1-303-01 | Handkl | 1300 | 590 | 300 W | E-F |
| 1-303-02 | 21 | 400 | 800 | 430 W | C-D |
| 1-303-03 | 22 | 400 | 1800 | 1251 W | B-C |
| 1-303-04 | 22 | 400 | 1800 | 1251 W | B-C |
| 1-303-05 | 21 | 400 | 800 | 430 W | C-D |
| 1-303-06 | 21 | 400 | 800 | 430 W | C-D |
| 1-304-01 | 21 | 400 | 1000 | 537 W | C-D |
| 1-304-02 | Handkl | 1300 | 590 | 300 W | E-F |
| 1-304-03 | 21 | 400 | 800 | 430 W | C-D |
| 1-304-04 | 22 | 400 | 1200 | 834 W | C-D |
| 1-305-01 | Handkl | 1300 | 590 | 300 W | E-F |
| 1-305-02 | 22 | 400 | 1800 | 1251 W | B-C |
| 1-305-03 | 22 | 400 | 1200 | 834 W | A-B |
| 1-305-04 | 21 | 400 | 1000 | 537 W | A-B |
| 1-305-05 | 21 | 400 | 800 | 430 W | A-B |
| 1-306-01 | Handkl | 1300 | 590 | 300 W | E-F |
| 1-306-02 | Handkl | 1300 | 590 | 300 W | E-F |
| 1-306-03 | 22 | 400 | 1800 | 1251 W | A-D |
| 1-306-04 | 22 | 400 | 1800 | 1251 W | A-D |
| 1-306-05 | 21 | 400 | 1000 | 537 W | A-B |
| 1-306-06 | 21 | 400 | 1200 | 645 W | A-B |
| 1-306-07 | 21 | 400 | 1600 | 860 W | A-D |
| 1-307-01 | 21 | 400 | 1800 | 967 W | B-C |
| 1-307-02 | 21 | 400 | 1800 | 967 W | C-D |
| 1-307-03 | 22 | 400 | 1200 | 834 W | A-D |
| 1-307-04 | 21 | 400 | 1600 | 860 W | A-D |
| 1-307-05 | Handkl | 1300 | 590 | 300 W | E-F |
| 1-308-01 | Handkl | 1300 | 590 | 300 W | E-F |
| 1-308-02 | 22 | 400 | 1800 | 1251 W | A-D |
| 1-308-03 | 22 | 400 | 1200 | 834 W | A-B |
| 1-308-04 | 21 | 400 | 1200 | 645 W | A-B |
| 1-308-05 | 21 | 400 | 1200 | 645 W | A-B |
| 1-311-01 | 22 | 600 | 1200 | 1150 W | A-B |

| Ofnatafla 4.hæð 9-11 | | | | | |
|----------------------|--------|----------|------------|------------|---------|
| Númer | Gerð | Hæð [mm] | Lengd [mm] | Afköst [W] | Tenging |
| 1-401-01 | 21 | 400 | 1000 | 537 W | A-B |
| 1-401-02 | Handkl | 1300 | 590 | 300 W | E-F |
| 1-401-03 | 21 | 400 | 800 | 430 W | A-B |
| 1-401-04 | 22 | 400 | 1200 | 834 W | A-B |
| 1-401-05 | Handkl | 1300 | 590 | 300 W | E-F |
| 1-402-01 | Handkl | 1300 | 590 | 300 W | E-F |
| 1-402-02 | 21 | 400 | 800 | 430 W | A-B |
| 1-402-03 | 22 | 400 | 1800 | 1251 W | A-D |
| 1-402-04 | 22 | 400 | 1800 | 1251 W | A-D |
| 1-402-05 | 21 | 400 | 800 | 430 W | A-B |
| 1-402-06 | 21 | 400 | 800 | 430 W | A-B |
| 1-403-01 | Handkl | 1300 | 590 | 300 W | E-F |
| 1-403-02 | 21 | 400 | 800 | 430 W | C-D |
| 1-403-03 | 22 | 400 | 1800 | 1251 W | B-C |
| 1-403-04 | 22 | 400 | 1800 | 1251 W | B-C |
| 1-403-05 | 21 | 400 | 800 | 430 W | C-D |
| 1-403-06 | 21 | 400 | 800 | 430 W | C-D |
| 1-404-01 | 21 | 400 | 1000 | 537 W | C-D |
| 1-404-02 | Handkl | 1300 | 590 | 300 W | E-F |
| 1-404-03 | 21 | 400 | 800 | 430 W | C-D |
| 1-404-04 | 22 | 400 | 1200 | 834 W | C-D |
| 1-405-01 | Handkl | 1300 | 590 | 300 W | E-F |
| 1-405-02 | 22 | 400 | 1800 | 1251 W | B-C |
| 1-405-03 | 22 | 400 | 1200 | 834 W | A-B |
| 1-405-04 | 21 | 400 | 1000 | 537 W | A-B |
| 1-405-05 | 21 | 400 | 800 | 430 W | A-B |
| 1-406-01 | Handkl | 1300 | 590 | 300 W | E-F |
| 1-406-02 | Handkl | 1300 | 590 | 300 W | E-F |
| 1-406-03 | 22 | 400 | 1800 | 1251 W | A-D |
| 1-406-04 | 22 | 400 | 1800 | 1251 W | A-D |
| 1-406-05 | 21 | 400 | 1000 | 537 W | A-B |
| 1-406-06 | 21 | 400 | 1200 | 645 W | A-B |
| 1-406-07 | 21 | 400 | 1600 | 860 W | A-D |
| 1-407-01 | 21 | 400 | 1800 | 967 W | B-C |
| 1-407-02 | 21 | 400 | 1800 | 967 W | C-D |
| 1-407-03 | 22 | 400 | 1200 | 834 W | A-D |
| 1-407-04 | 21 | 400 | 1600 | 860 W | A-D |
| 1-408-01 | Handkl | 1300 | 590 | 300 W | E-F |
| 1-408-02 | 22 | 400 | 1800 | 1251 W | A-D |
| 1-408-03 | 22 | 400 | 1200 | 834 W | A-B |
| 1-408-04 | 21 | 400 | 1200 | 645 W | A-B |
| 1-408-05 | 21 | 400 | 1200 | 645 W | A-B |

| Ofnatafla 5.hæð 9-11 | | | | | |
|----------------------|--------|----------|------------|------------|---------|
| Númer | Gerð | Hæð [mm] | Lengd [mm] | Afköst [W] | Tenging |
| 1-501-01 | 21 | 400 | 800 | 430 W | A-B |
| 1-501-02 | 21 | 400 | 800 | 430 W | A-B |
| 1-501-03 | 22 | 400 | 1000 | 695 W | A-B |
| 1-501-04 | 22 | 400 | 1800 | 1251 W | A-D |
| 1-501-05 | Handkl | 1300 | 590 | 300 W | E-F |
| 1-502-01 | Handkl | 1300 | 590 | 300 W | E-F |
| 1-502-02 | Handkl | 1300 | 590 | 300 W | E-F |
| 1-502-03 | 21 | 400 | 1800 | 967 W | A-D |
| 1-502-04 | 21 | 400 | 1000 | 537 W | A-B |
| 1-502-05 | 21 | 400 | 1000 | 537 W | A-B |
| 1-502-06 | 21 | 400 | 1800 | 967 W | A-D |
| 1-502-07 | 21 | 400 | 1800 | 967 W | A-D |
| 1-503-01 | Handkl | 1300 | 590 | 300 W | E-F |
| 1-503-02 | Handkl | 1300 | 590 | 300 W | E-F |
| 1-503-03 | 21 | 400 | 800 | 430 W | A-B |
| 1-503-04 | 22 | 400 | 1000 | 695 W | A-B |
| 1-503-05 | 22 | 400 | 1800 | 1251 W | B-C |
| 1-503-06 | 21 | 400 | 1400 | 752 W | A-D |
| 1-503-07 | 22 | 400 | 1800 | 1251 W | A-D |
| 1-504-02 | 22 | 400 | 1800 | 1251 W | A-D |
| 1-504-03 | 22 | 400 | 1200 | 834 W | A-B |
| 1-504-04 | 21 | 400 | 800 | 430 W | A-B |
| 1-504-05 | 21 | 400 | 800 | 430 W | A-B |
| 1-506-01 | 22 | 600 | 1200 | 1150 W | A-B |

| Ofnatafla 6.hæð 9-11 | | | | | |
|----------------------|--------|----------|------------|------------|---------|
| Númer | Gerð | Hæð [mm] | Lengd [mm] | Afköst [W] | Tenging |
| 1-601-01 | 21 | 400 | 1000 | 537 W | A-B |
| 1-601-02 | 21 | 400 | 1000 | 537 W | A-B |
| 1-601-03 | 22 | 400 | 1200 | 834 W | A-B |
| 1-601-04 | Handkl | 1300 | 590 | 300 W | E-F |
| 1-601-05 | 21 | 400 | 1800 | 1251 W | A-D |
| 1-601-06 | 21 | 400 | 1800 | 1251 W | A-D |
| 1-601-07 | 21 | 400 | 1800 | 1251 W | A-D |
| 1-601-08 | 21 | 400 | 800 | 430 W | A-B |
| 1-601-09 | Handkl | 1300 | 590 | 300 W | E-F |
| 1-602-02 | Handkl | 1300 | 590 | 300 W | E-F |
| 1-602-03 | 21 | 400 | 1800 | 967 W | A-D |
| 1-602-04 | 21 | 400 | 800 | 430 W | A-B |
| 1-602-05 | 21 | 400 | 1800 | 1251 W | A-D |
| 1-602-06 | 21 | 400 | 1800 | 967 W | A-D |
| 1-602-07 | 22 | 400 | 1800 | 1251 W | A-D |
| 1-603-01 | Handkl | 1300 | 590 | 300 W | E-F |
| 1-603-02 | 22 | 400 | 1800 | 1251 W | A-D |
| 1-603-03 | 22 | 400 | 1200 | 834 W | A-B |
| 1-603-04 | 21 | 400 | 1000 | 537 W | A-B |
| 1-603-05 | 21 | 400 | 1000 | 537 W | A-B |

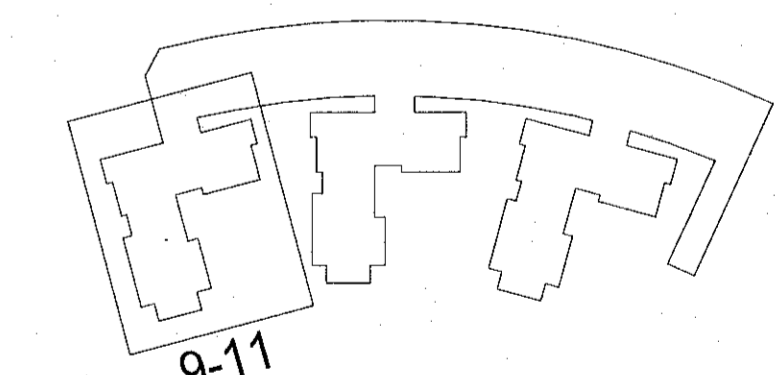

Hringhamar 9-11
221 Hafnarfjörður

Lagnir og loftrásikerfi
Hitakerfi
Ofnatöflur

| | | | |
|-------------|------------|----------|-----|
| TEKNIKNÚMUR | BLAÐSTYR | HANNAÐ | OIB |
| 9354-001 | A1 | TEKNAÐ | UBB |
| XX_2_46_01 | | YHRFARIR | KAB |
| DAGS | MELIKVARÐI | ÚTGÁFA | |
| 01.09.2022 | | A | |

Útgáfunúmer og dagsetning áblauspósts: Frumútgáfa 12.04.2022
Höfundur: Kári Brekason - kt. 071187-2099
Höfundarstjóri: Haraldur Ingvarsson kt. 030956-3389