

G-01

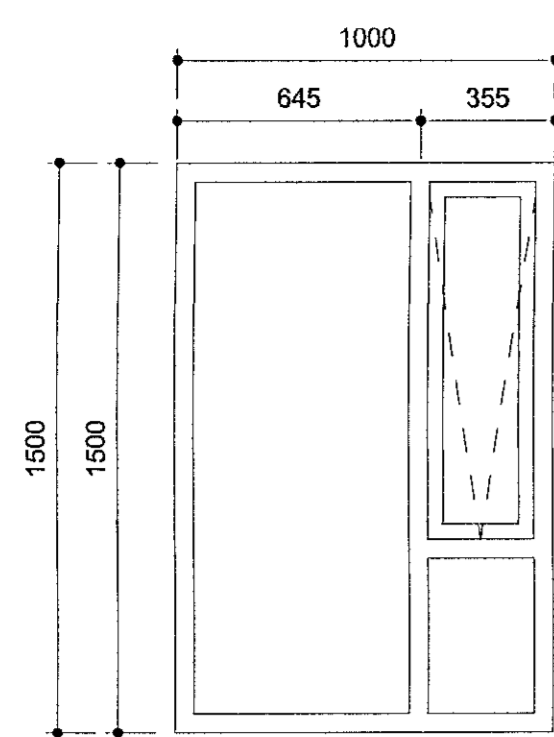

G-01a

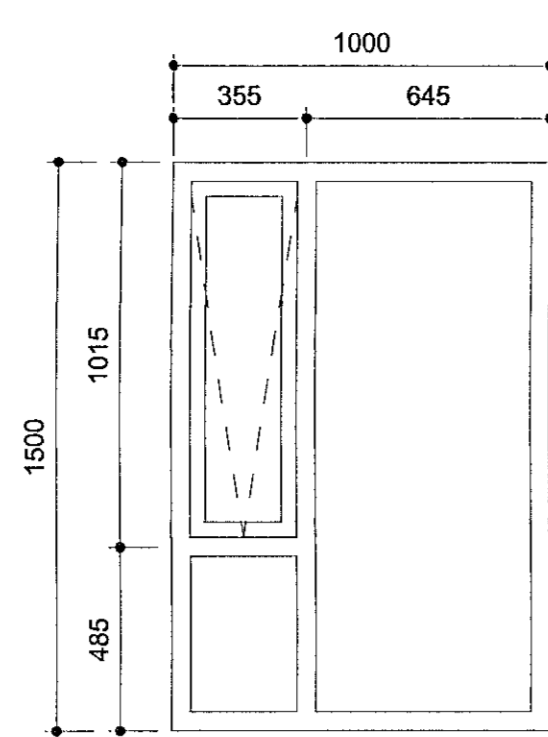

G-01b

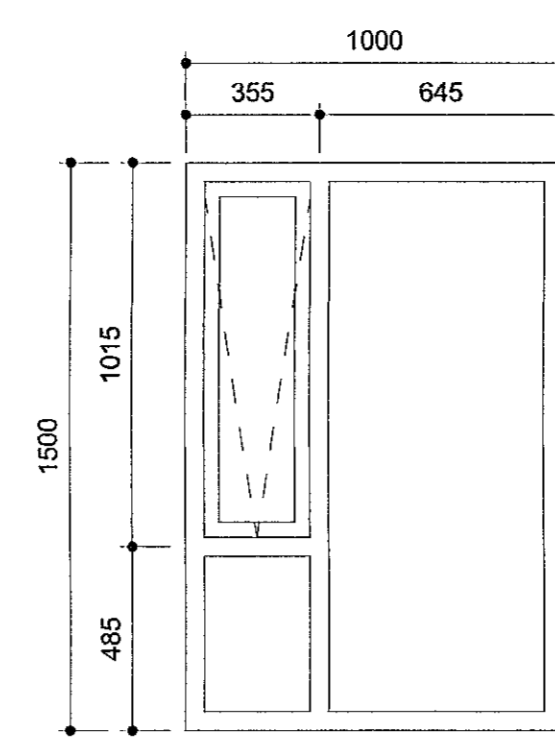

G-01c

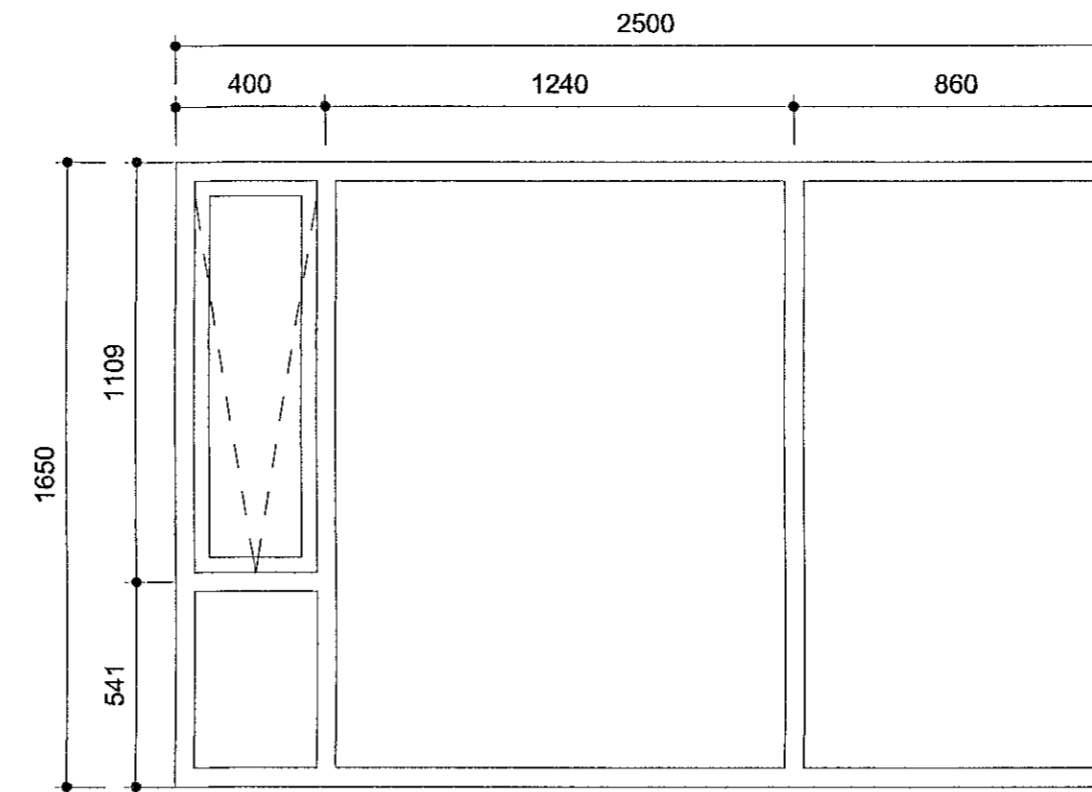

G-02

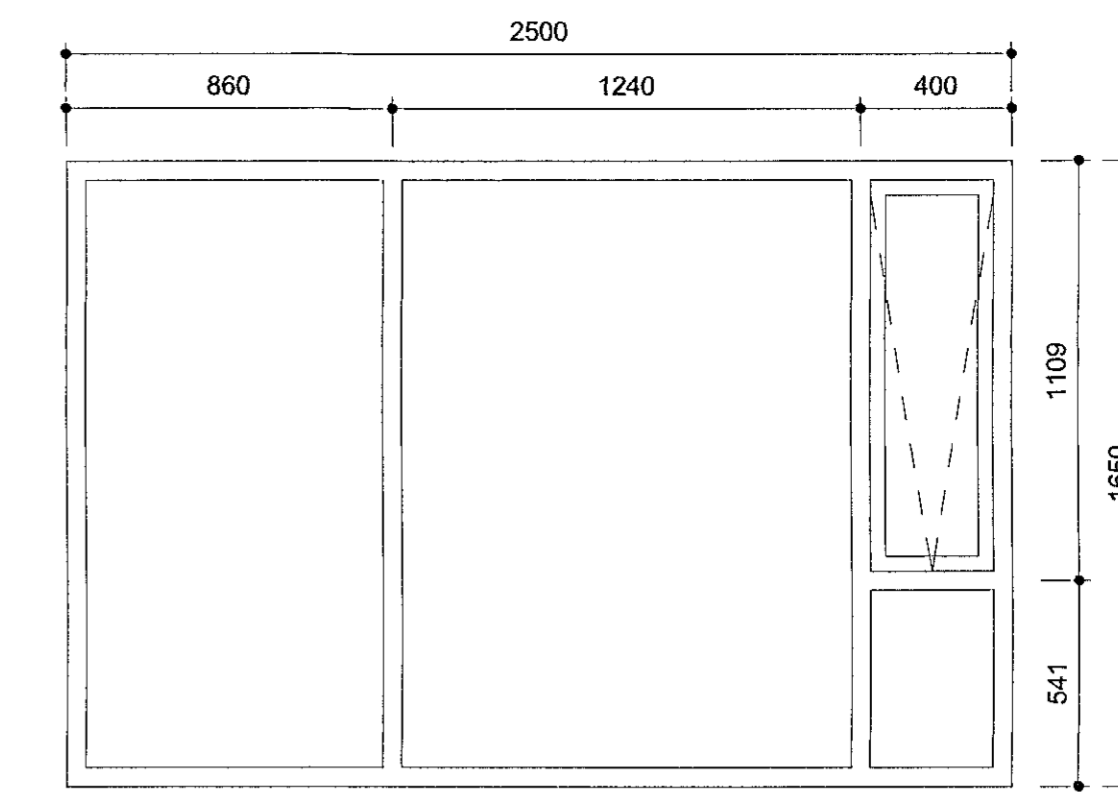

G-02a

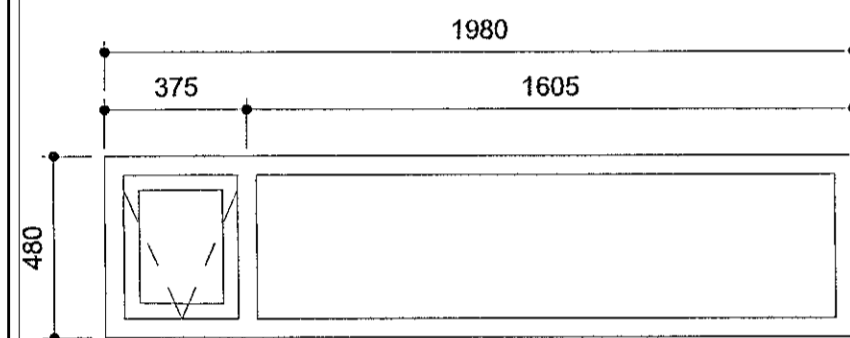

G-03

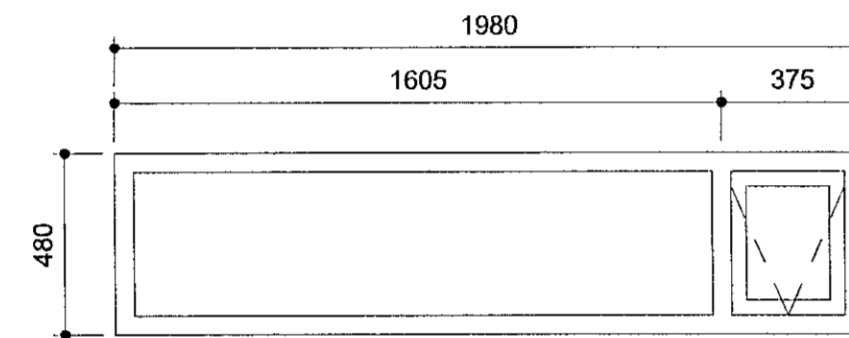

G-03a

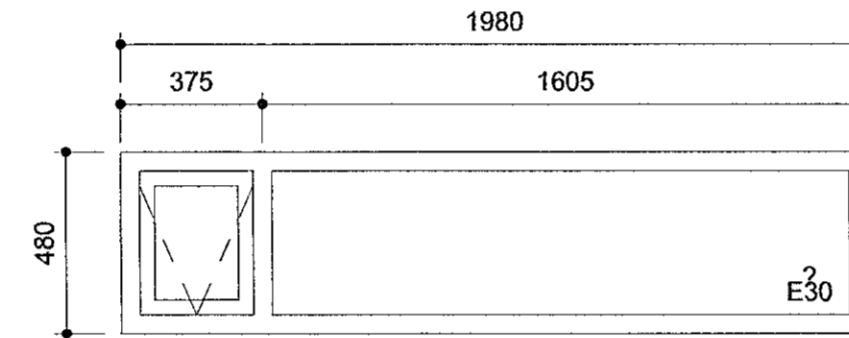

G-03c

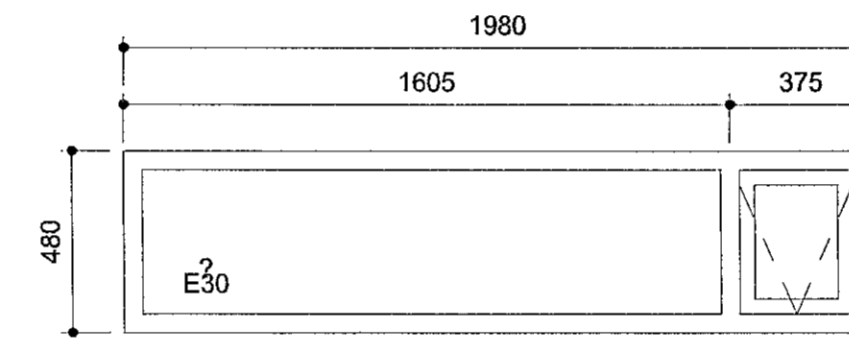

G-03d

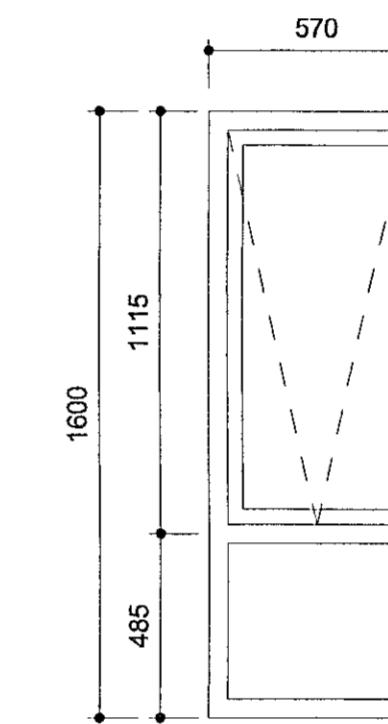

G-04

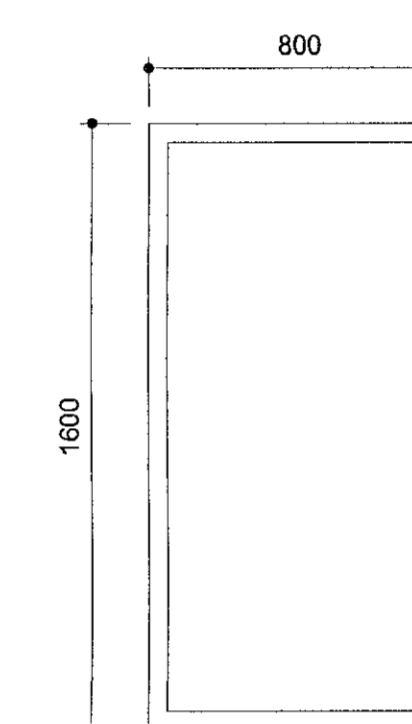

G-05

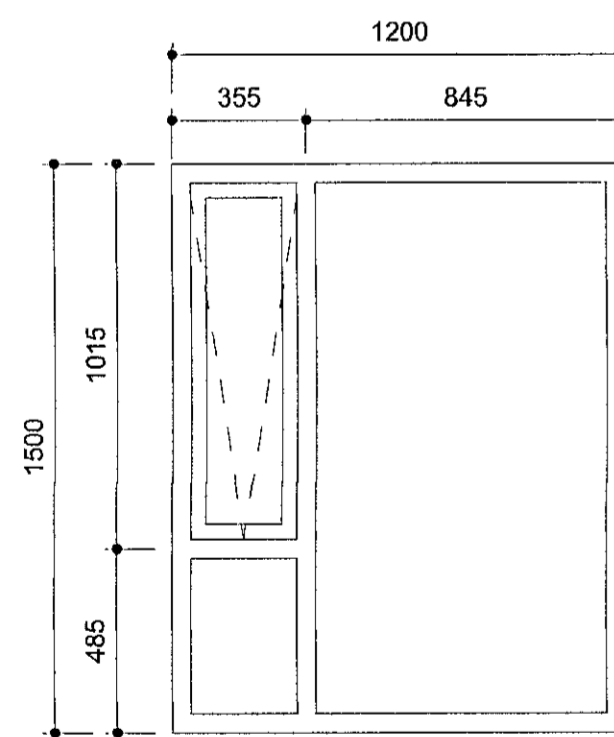

G-06

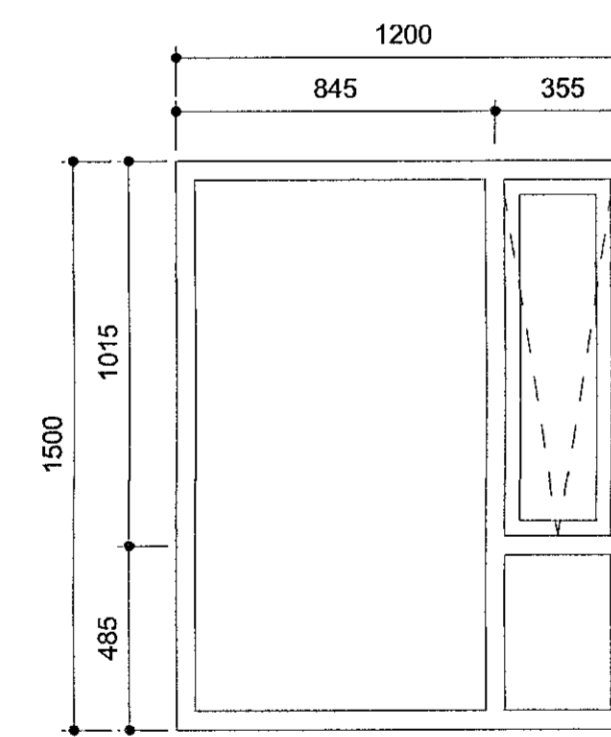

G-06a

Sambýkkt þann  
06. okt. 2021  
f.h. byggingarfulltrúans í Hafnarfirði  
Hjalmar A. Jónsson  
TARK

ATH:  
Uppgefin mál eru smíðamál á gluggum og hurðum.  
Gert er ráð fyrir 15mm fúgu við gluggakarma. Gert er ráð fyrir því að neðri brún bolnslykkja hurða nemi við efri brún á fullfrágengnu göfli.  
Hurðapróskuldar mega ekki ná hærra en 25mm upp fyrir fullfrágengin göfl.  
Hljóðkrafa á alla glugga og hurðir er að lágmarki  $R_w=30db$  nema annað sé sérstaklega tiltekið í glugga/hurða yfirliti.

VERKTEIKNING GERD Á GRUNNI  
ADALUPPDRATTA SEM VORU SAMBYKKTIR  
ÞANN: 22 JUL 2021

BREYTINGAR



VERKHEITI  
Nónhamar 1-3, 221 Hafnarfj.  
Fjölbýlishús, mhl.01  
Verkteikningar

VERK  
Gluggar og hurðir 1

MÁL: 1 : 20 / A1  
HANNAÐ: ÁÁ  
TEIKNAD: HVIL  
DAGS.: 01.10.2021  
VERKFRÁÐA: ISC  
VERKNGIEMER: FL TEIKNINGANÖMUR ÖTC

753-16 04 2.04-01  
SÁMÁR: ÁSSUR ÁSSONSSON ARKITEKTAR SAMARK KL.060161-5429

2 Úti Gluggar							
Gluggahelti	Magn	Opnunarátt hurða	Hljóðkrafa	Brunakrafa	Glergerð	Pumpa	Lásakerfi
G-01	22						
G-01a	10		$R_w=44db$				
G-01b	10						
G-01c	10		$R_w=44db$				
G-02	4						
G-02a	4						
G-03	4		$R_w=44db$				
G-03a	20		$R_w=44db$				
G-03c	4		$R_w=44db$	E30			
G-03d	4		$R_w=44db$	E30			
G-04	12						
G-05	4						
G-06	31						
G-06a	20						
G-07	12					Svalapumpa	Svalaskrá
G-07a	12					Svalapumpa	Svalaskrá
G-08	16	V				Svalapumpa	Svalaskrá
G-09	7						
G-09a	3						
G-10	6	H				Pumpa-Rafdrifin	??
G-11	3	V				Pumpa-Rafdrifin	??
G-12	4	V					
G-13	4						
G-14	4						
Grand total:	230						
	230						

Öll arnot og skilti teikninga, að hluta eða heild, er háð sambýkkt hlífum, skv. ákveðnum hlífumálum.