

Samþykkt bann

24. júlí 2015

Byggingufulltrúi / Hafnarfróð
F.H. Höllur S. Gunnlaugsson

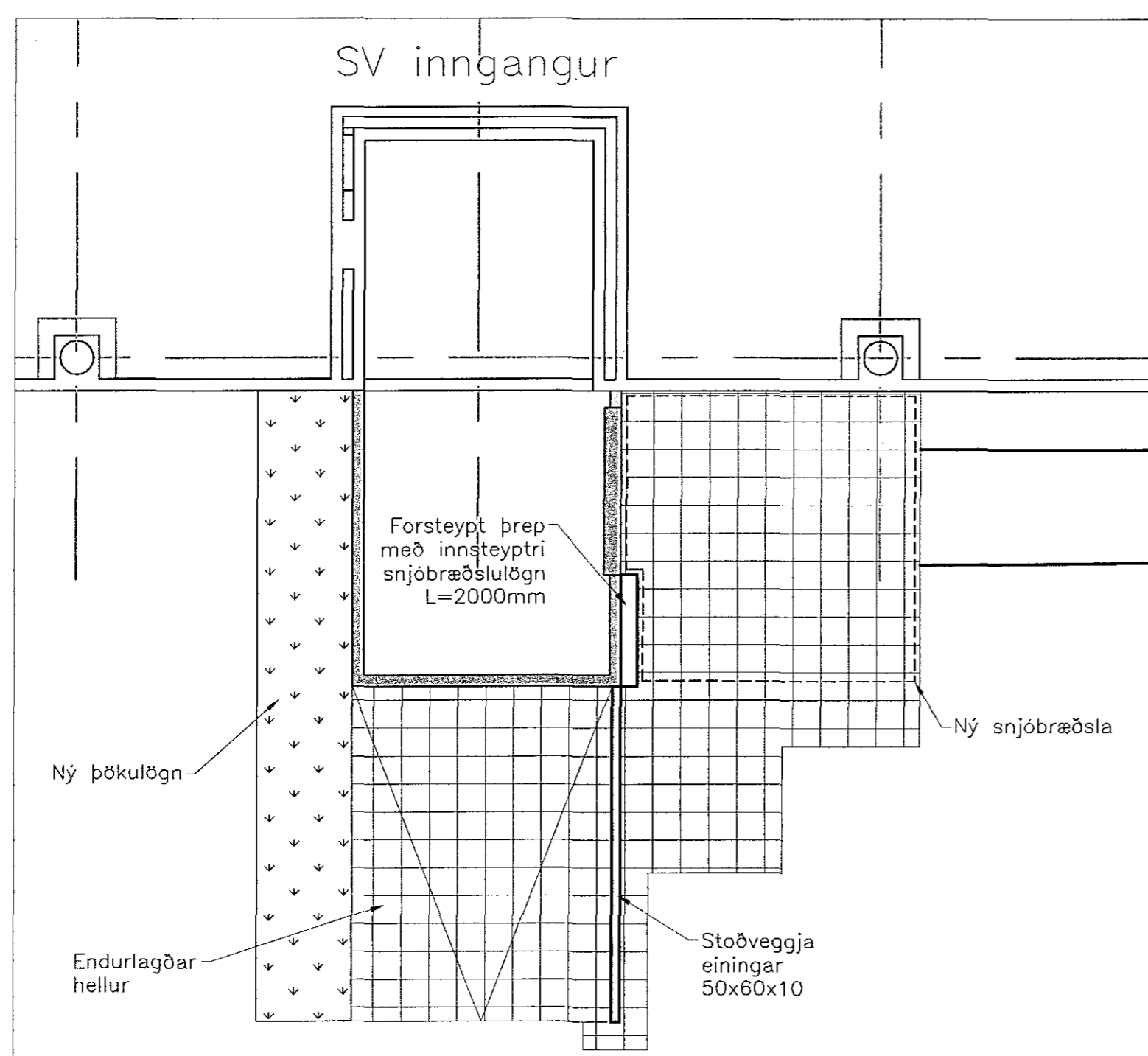
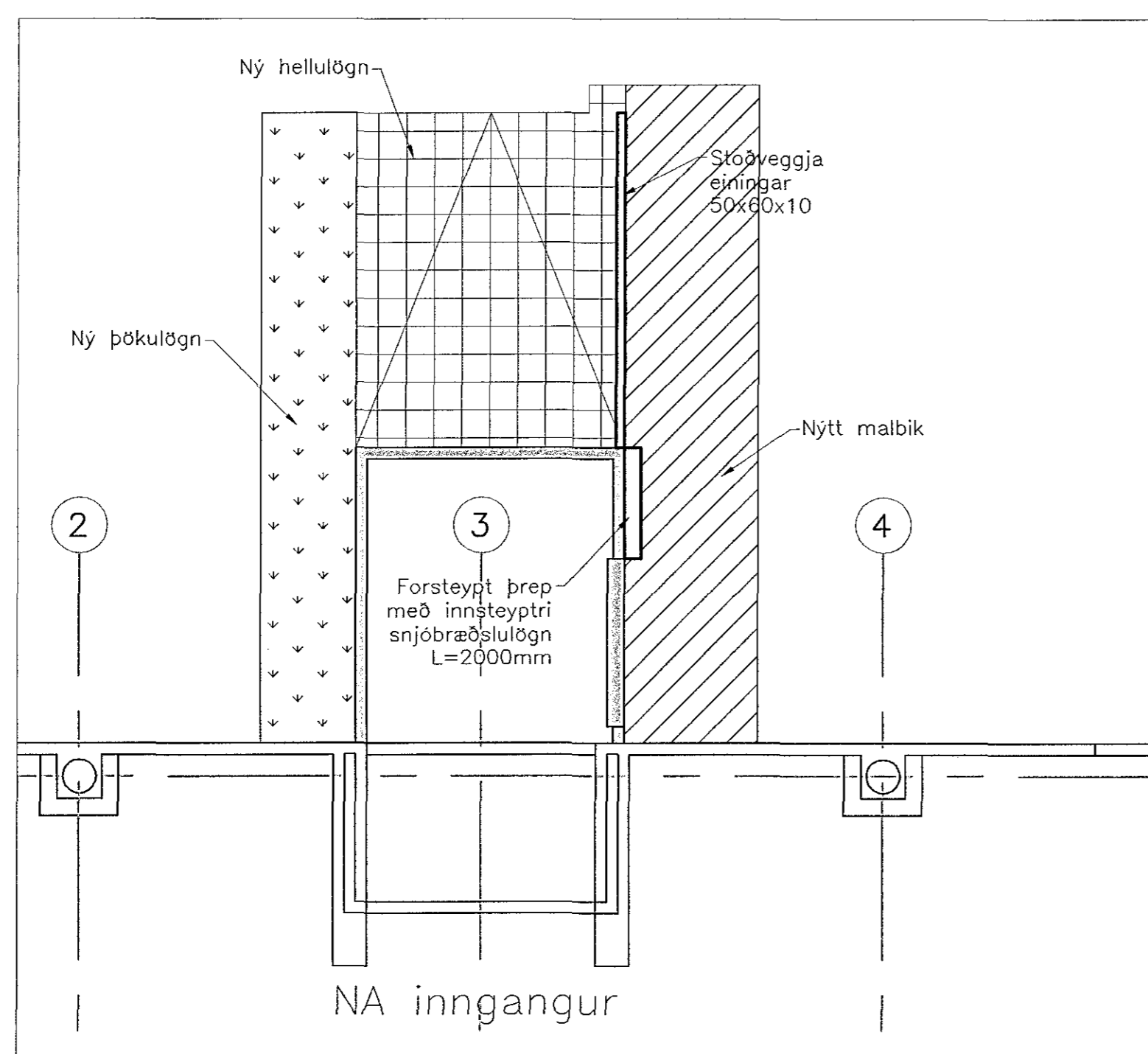

Formát A1 (594x841 mm) is 20 mm outside of this frame

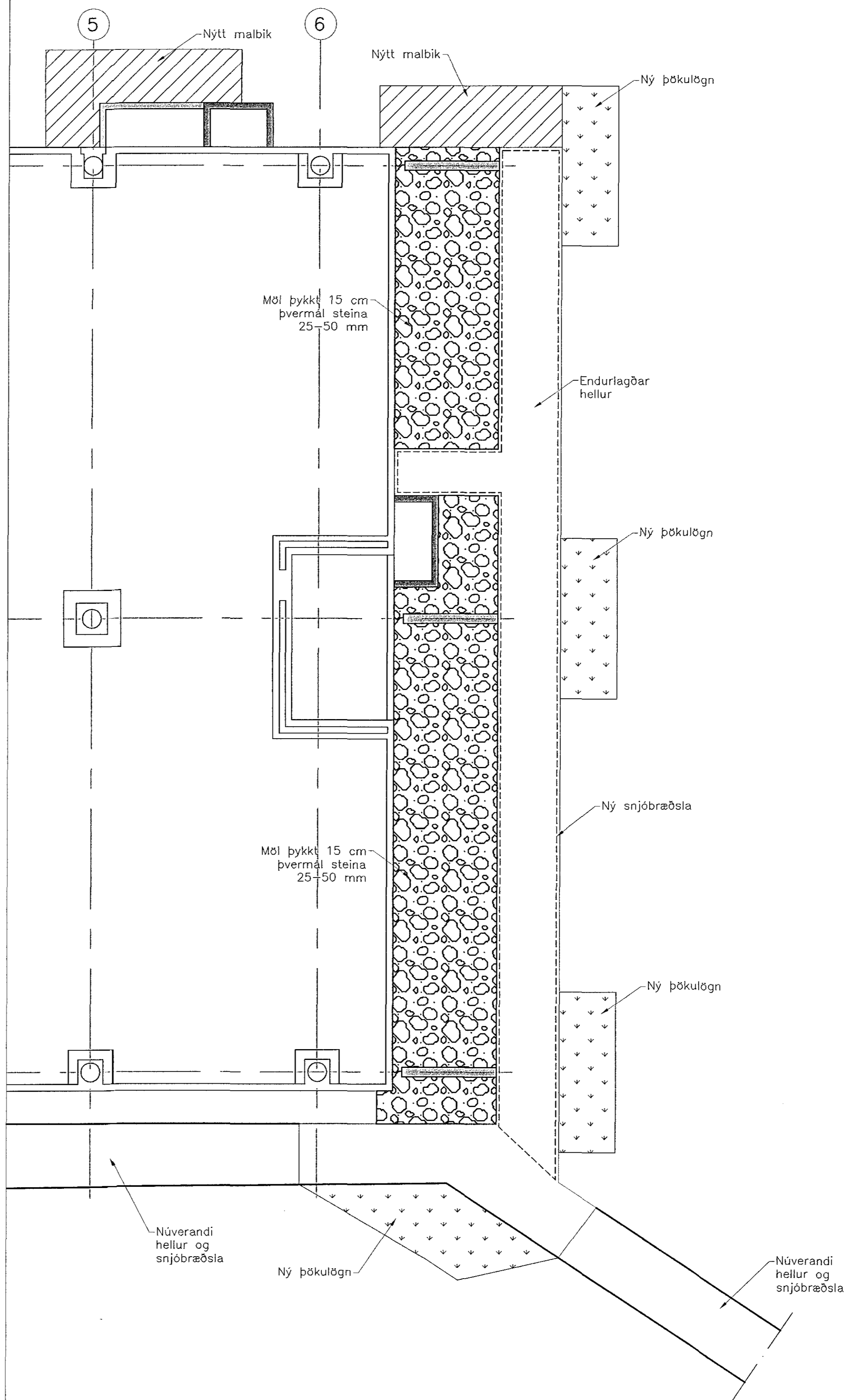

Hönnunarstjóri:

MM
Þorkell Magnússon, arkitekt
Kf. 090364-6939

Burðarþolihönnuður:

Flaukur J. Eiríksson
Flaukur J. Eiríksson
Kt. 131167-5479

Útskýringar:
Explanations:

Nr.:	1	Frámærdateikning	Dags.:	01.06.15	HJE
No.:			Breyting:		
			Revision:		
			Dags.:		
			Date:		
			Samþykkt:		
			Notk.heiml.:		
			Approved:		
			Released:		

This drawing is the property of Rio Tinto Alcan Iceland Ltd. and licensed out for personal use only. It may neither be copied nor made available to others without permission of Rio Tinto Alcan Iceland Ltd. The receiver is liable for any misuse.

HNIT
VERKFRÆÐISTOFA
Háaleitabrot 58-60
108 Reykjavík
Sími: 570-0500
Fax: 570-0503
www.hnit.is

Dagsetning: / Date: 01.06.2015
Hannað: / Designed: AMG/HJE
Teiknað: / Drawn: AMG
Yfirfarið/Checked: HJE
Töluur, verksta: / Supplier Dag. No.:
Hluti af: / Part of:

Mötuneytisbygging, styrking 1. áfangi
Yfirborðsfrágangur
Flokkur nr.: - Blað nr.: - Nasta bl. nr.: -
Kostn. nr.: - Acc. No.: - Búa. nr.: - Eq. No.: -
4130 02360
RKS nr.: UM20
Teg. teikningar: J(11)02
Dwg. type: 1
Rio Tinto Alcan ISAL
Alcan Iceland Ltd. IS-222 Hafnarfordur Ísland
Tölu nr. ISAL: / Dwg. no. of ISAL: J(11)02
Breyt./Rev: 1
ISAL Yfirfarið og síráð, dags: / ISAL Checked, date: ISAL Samþykkt, dags: / ISAL Approved, date: