

SNID 5-5 MKV. 1:10

ATH. ALLUR FRÁGANGUR, ÞAKBRÚNIR, EINANGRUN,
RAKAVÖRN, VINDVÖRN OG ÚTLOFTUN
SJA SERTEIKNINGAR ARKITEKTS

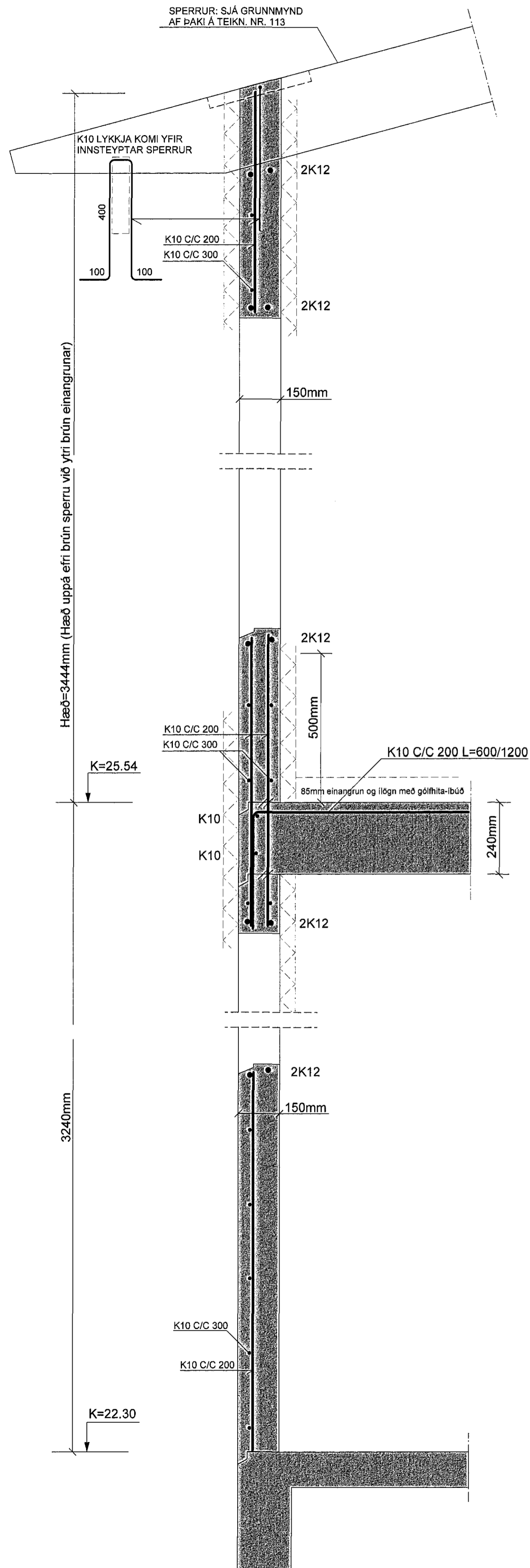

SNID 6-6 MKV. 1:10

ATH. ALLUR FRÁGANGUR, ÞAKBRÚNIR, EINANGRUN,
RAKAVÖRN, VINDVÖRN OG ÚTLOFTUN
SJA SERTEIKNINGAR ARKITEKTS

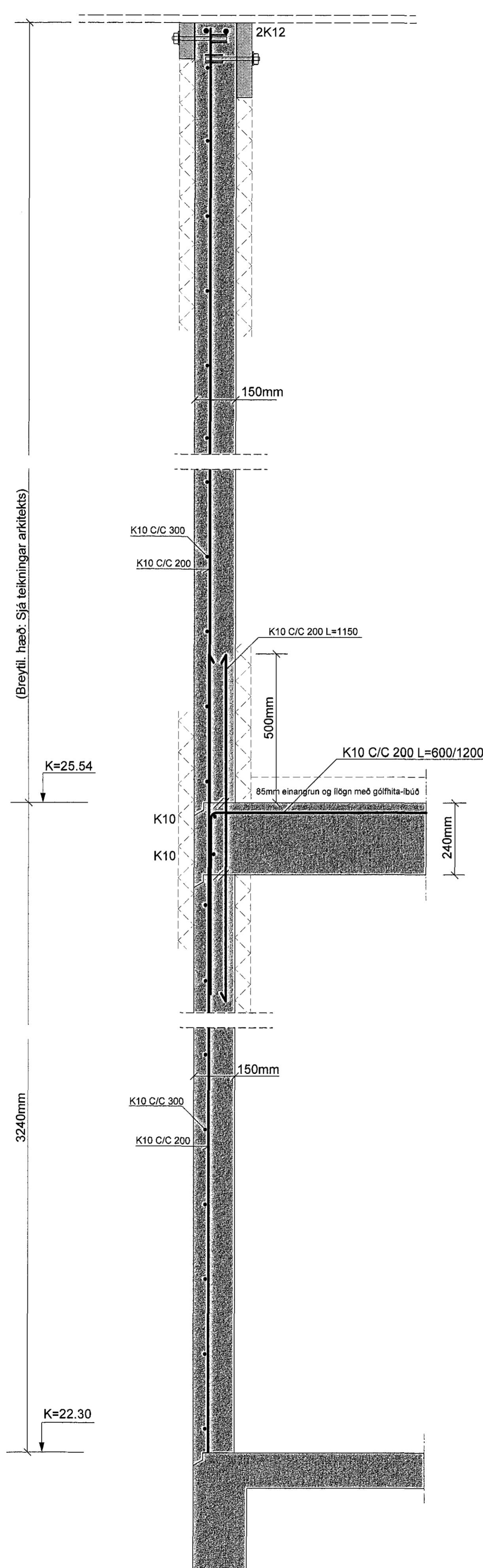

SNID 7-7 MKV. 1:10

ATH. ALLUR FRÁGANGUR, ÞAKBRÚNIR, EINANGRUN,
RAKAVÖRN, VINDVÖRN OG ÚTLOFTUN
SJA SERTEIKNINGAR ARKITEKTS

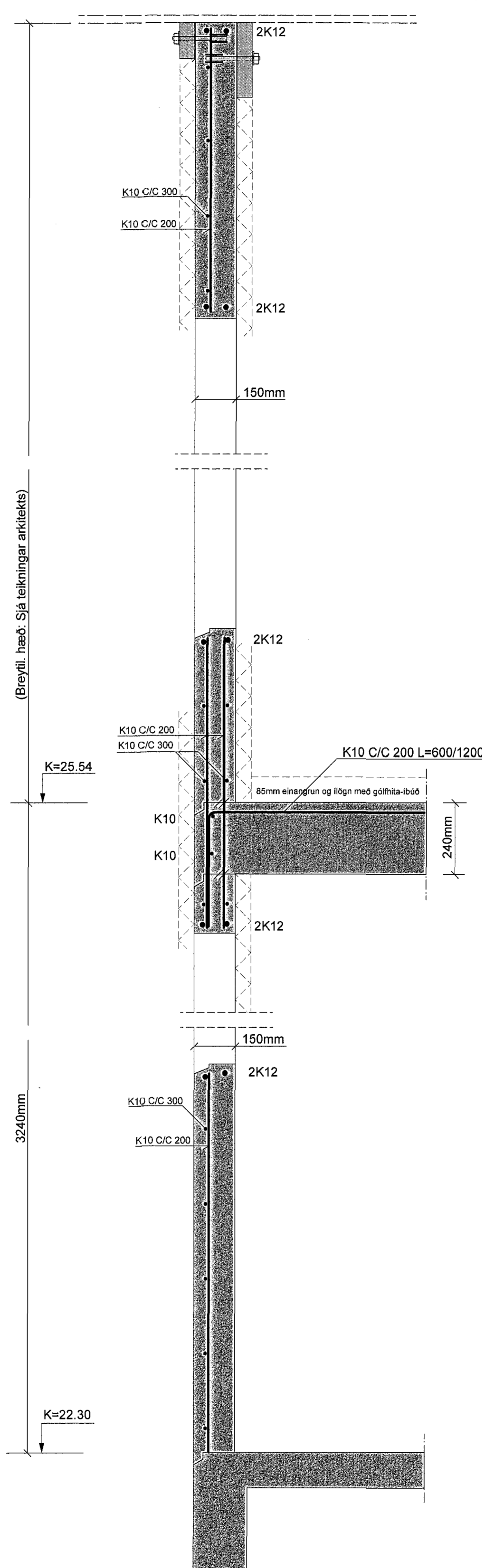

SNID 8-8 MKV. 1:10

ATH. ALLUR FRÁGANGUR, ÞAKBRÚNIR, EINANGRUN,
RAKAVÖRN, VINDVÖRN OG ÚTLOFTUN
SJA SERTEIKNINGAR ARKITEKTS

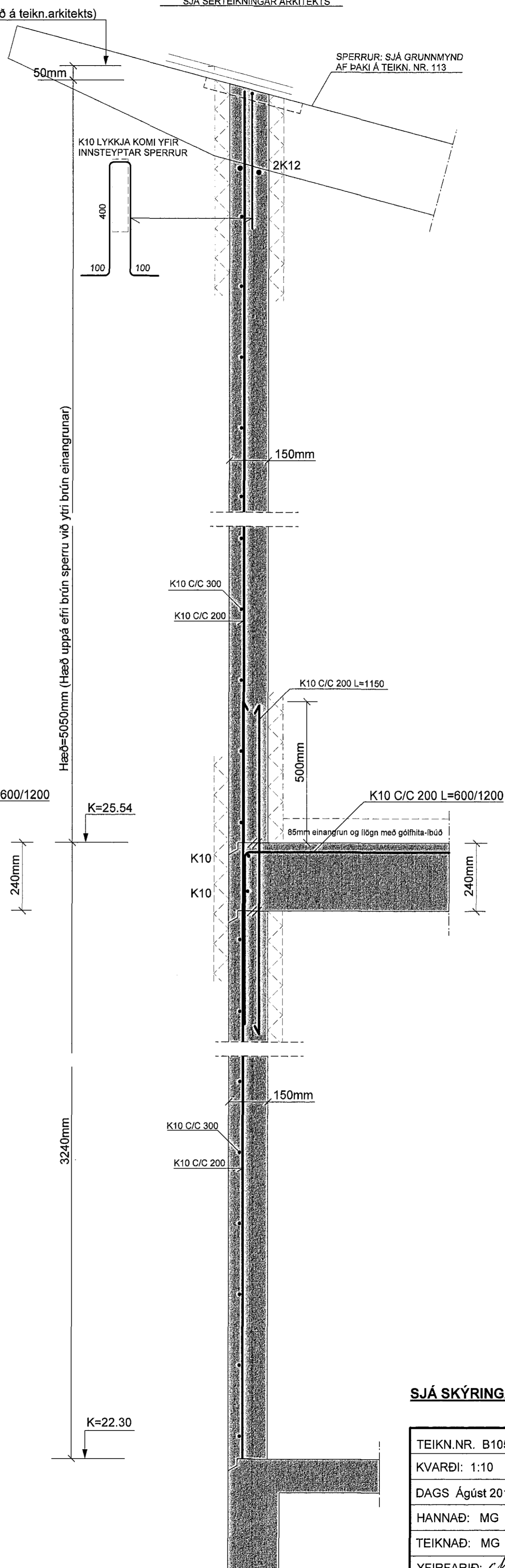

Sambykkt þann

27 AUG 2015

Þróun og hönnun í Hafnarfirði
L. Sigurður Steingrímsson

SJÁ SKÝRINGAR Á TEIKNINGU B103

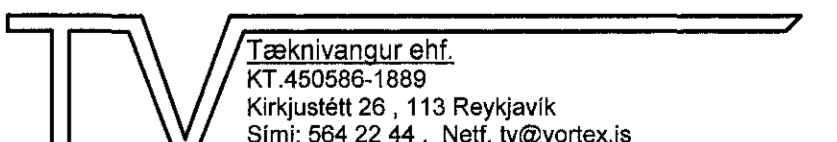
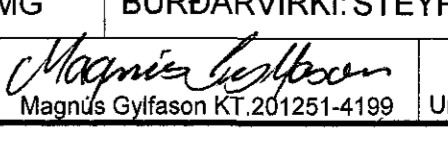
TEIKN.NR. B105	 Tæknivangur ehf. KT.450586-1889 Kirkjustétt 28, 113 Reykjavík Sími: 564 22 44 - Netf. tv@vortex.is
KVARDI: 1:10	
DAGS Ágúst 2015	
HANNAD: MG	VERKEFNI: FÍFUVELLIR 4 - HAFNARFIRÐI
TEIKNAD: MG	BURÐARVIRKI: STEYPTIR VEGGIR - SNID 5, 6, 7 OG 8
YFIRFARID: 	Undirskrift: 