

Samþykkt þann
21 SEP 2017
Byggingarfulltrúiinn í Hafnarfirði
F. N. Sigurðin Steinar Jónsson

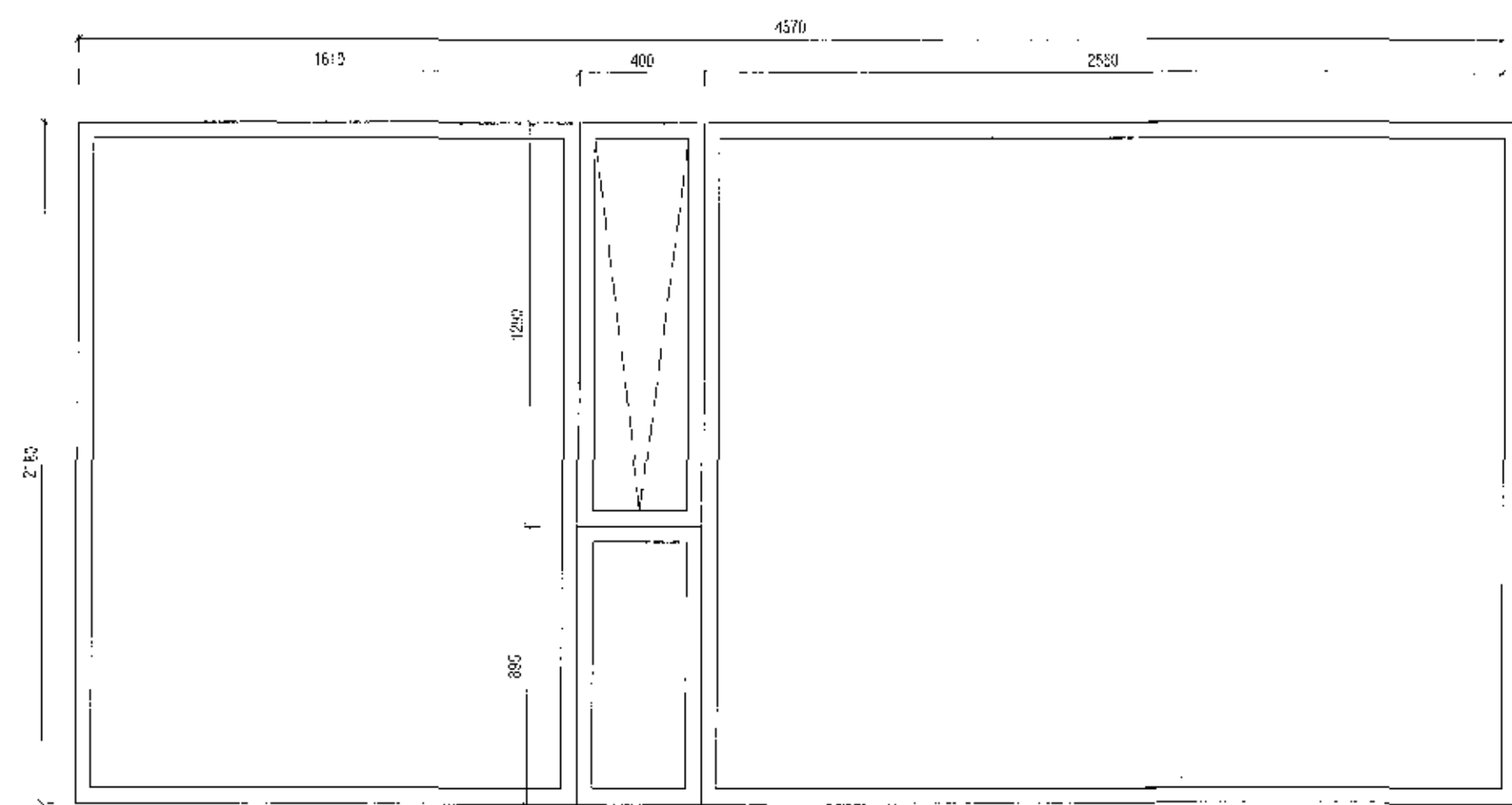

G1 1 STK.

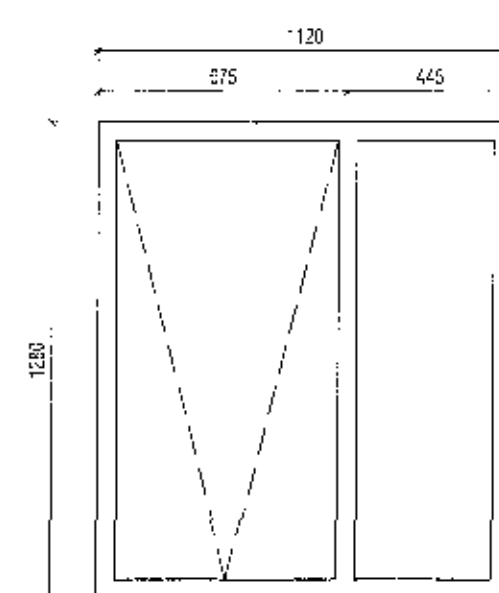

G2 5 STK.

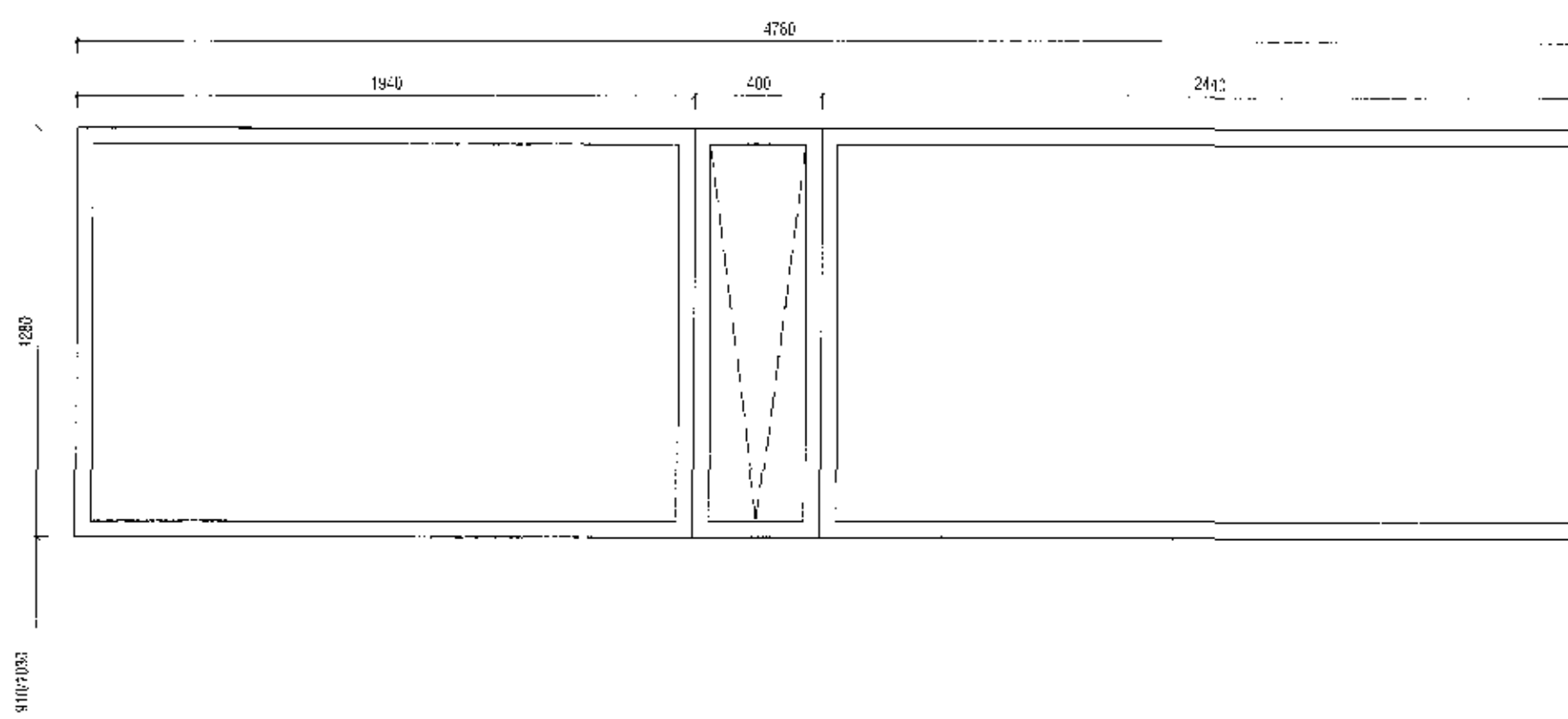

G3 2 STK.

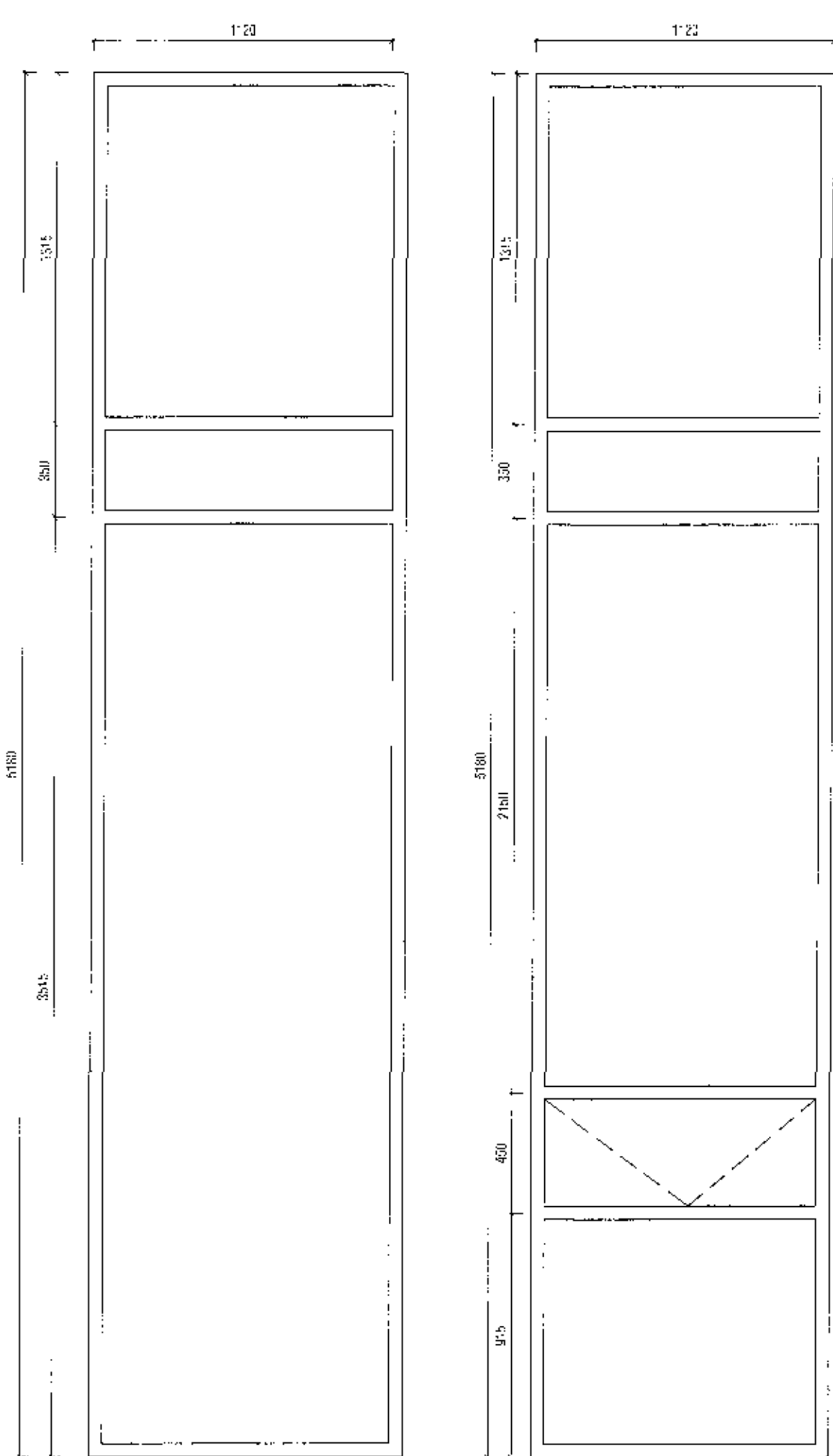
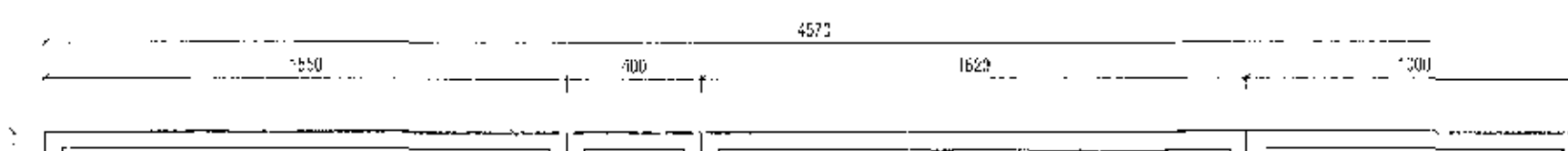

G4 4 STK.

G5 3 STK.

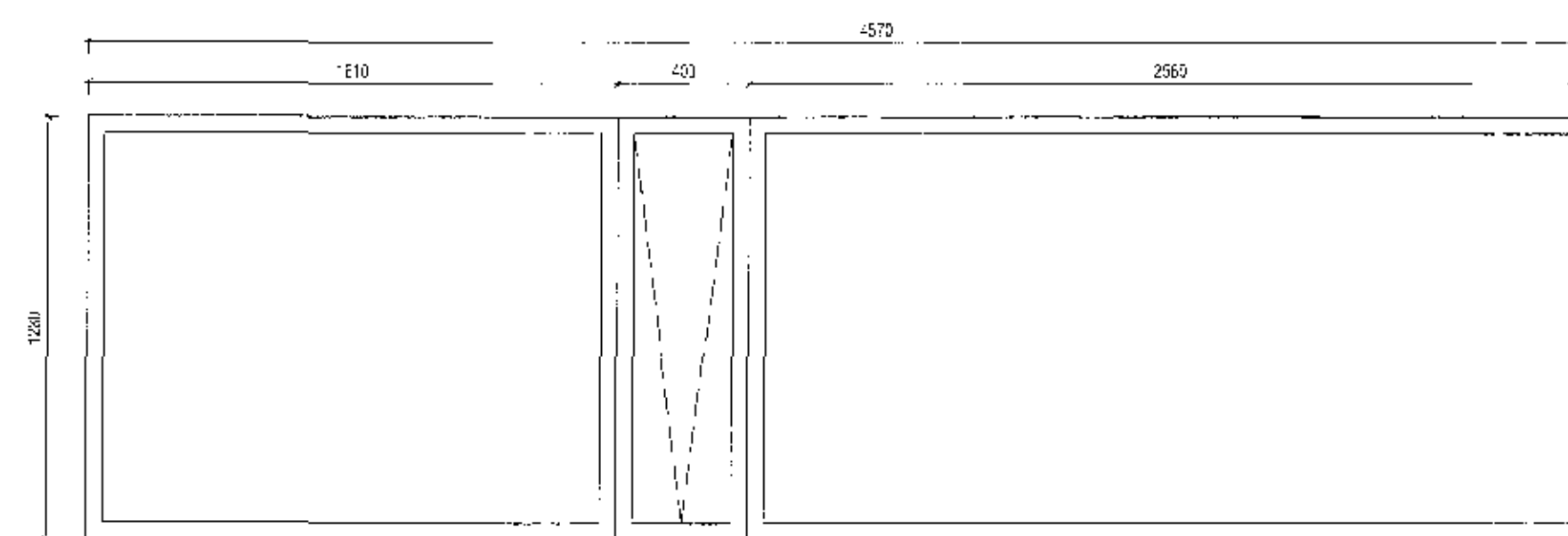

G6 5 STK.

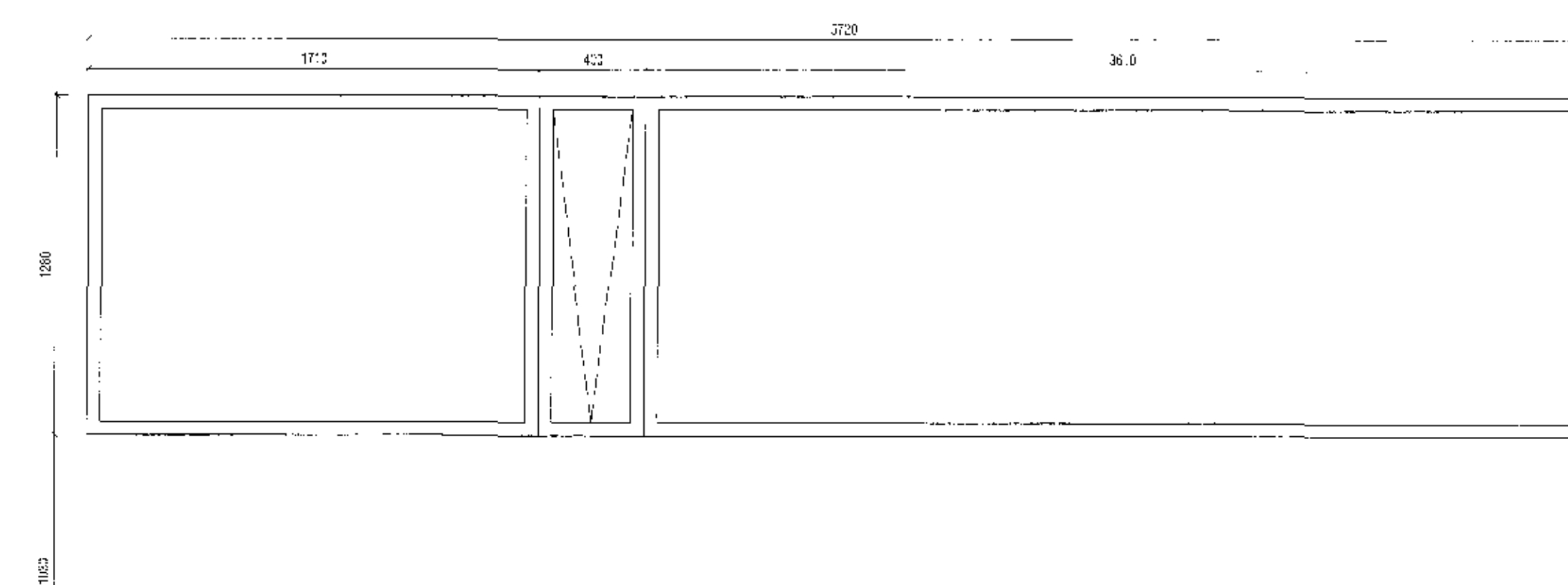

G7 1 STK.

ATH

ALLAR MÁLSETNINGAR GLUGGA OG HURÐA ERU 30 MM MINNI EN GATMÁL

Burðargeta glugga skal vera í samræmi við 128 gr. byggingarreglugerðar, það er að segja hámarks svignun sé minni en L/300 þó aldrei meiri en 8 mm. Mesti vindþrýstingur á glugga er $qv^*1,0$ og mesta sog á glugga er $qv^*1,1$. Grunnildri vindálags qv er uppgæfið á teikningu B-01.

VEKTOR - Ísönnun og ráðgjöf - Síðumúla 3, 108 Hvl., t. 554-8650 / 897-5363		Sigurður Halsteinnsson Byggingarkennsla NÚ 05689-710 smt. sigurdu@vektor.is	SELHELLA 6, HAFNARFJÖRDUR GLUGGATEIKNING
Teikn. númer: 1500-3-1000000 Skipti: SH	Daga: 20.05.2017 Útgáfa: 1:20	Tala: 5-07	Tala: 5-07