

Teikningaskrá - aðaltekningar Landnúmer - 203419

Nr.	Heiti	Zeppelin arkitektar	Kvartí	Útgáfud.
1.1.1	Aðaluppdráttir	Byggingerfulltrúinn	1:500	07.06.2018
1.1.2	Grundmyndir	Byggingerfulltrúinn	1:100	07.06.2018
1.1.3	Snið	Byggingerfulltrúinn	1:100	07.06.2018
1.1.4	Útlit	Byggingerfulltrúinn	1:100	07.06.2018

Áritun hönnunarstjóra: *[Signature]* Dags. áritunar

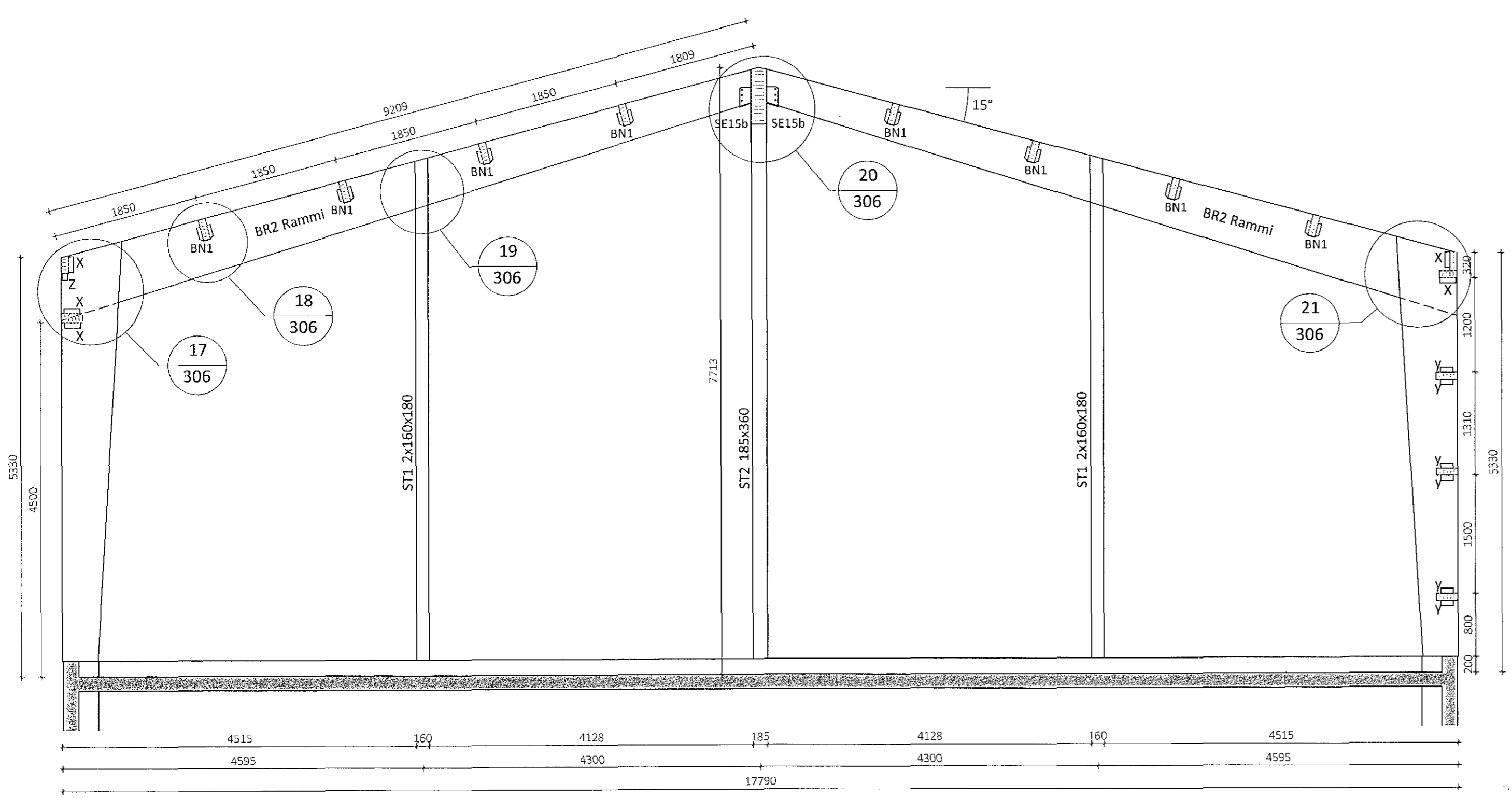

pversnið A-A Mkv. 1:50
301

Sérmynd 21 Mkv. 1:10
306

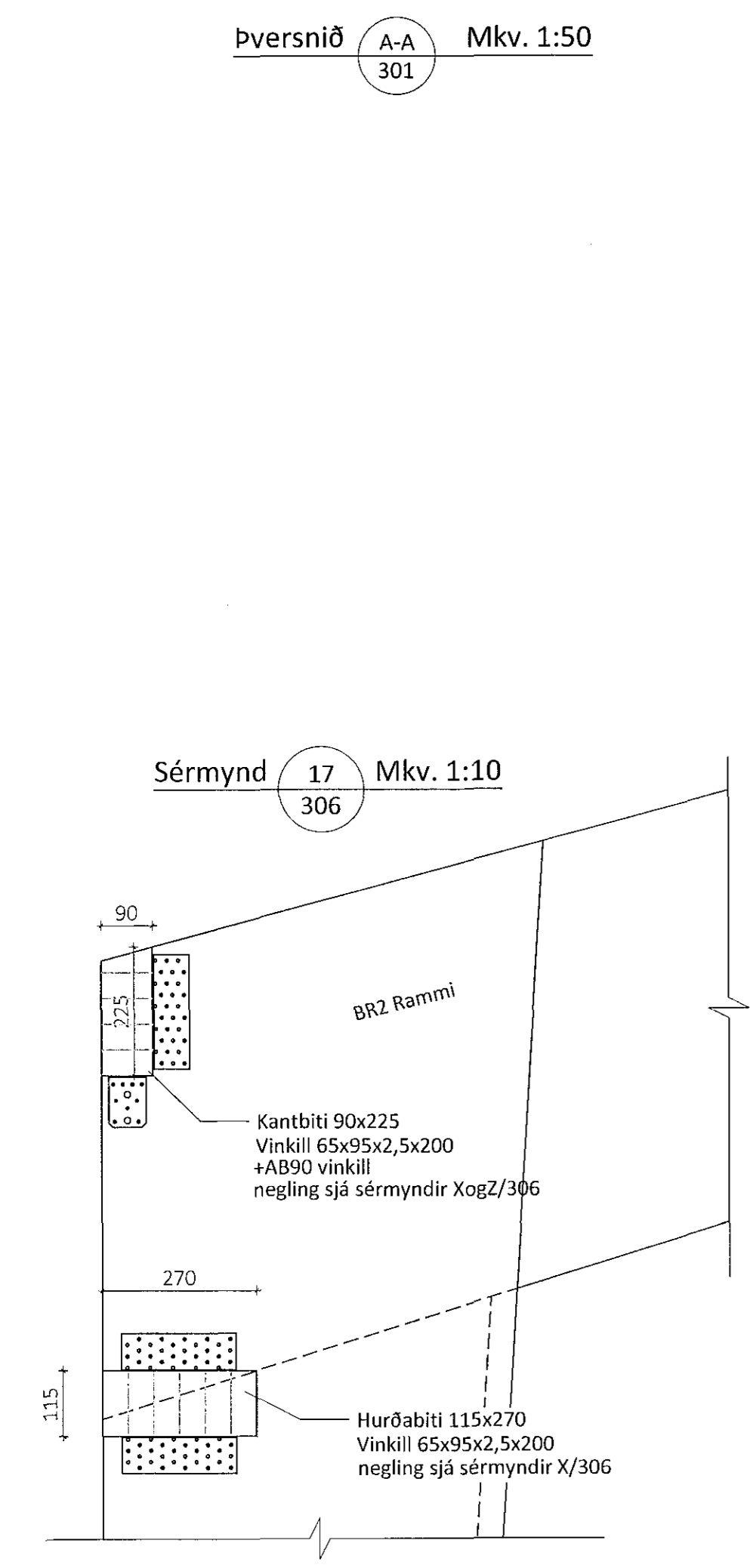
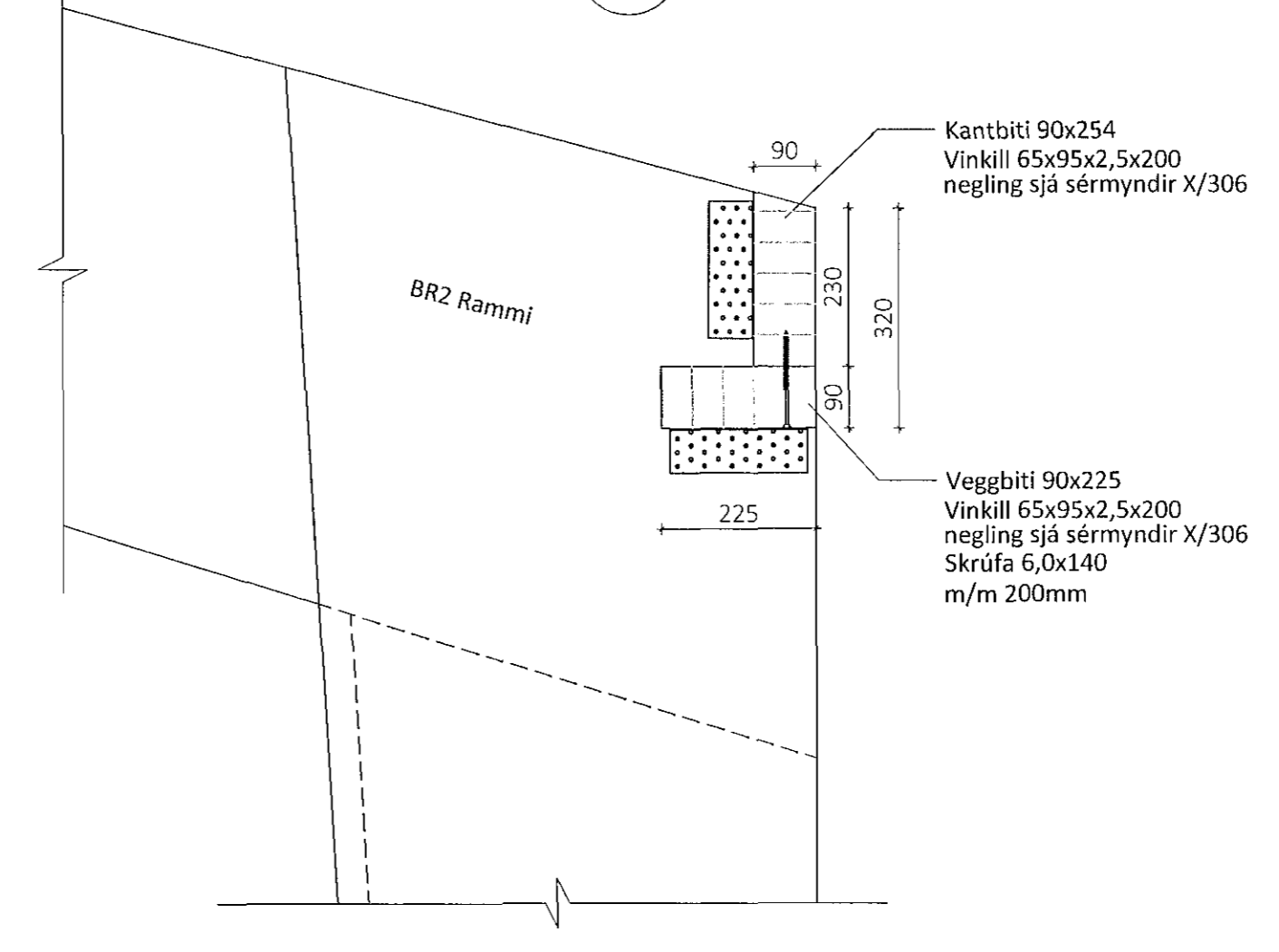

Sérmynd 17 Mkv. 1:10
306

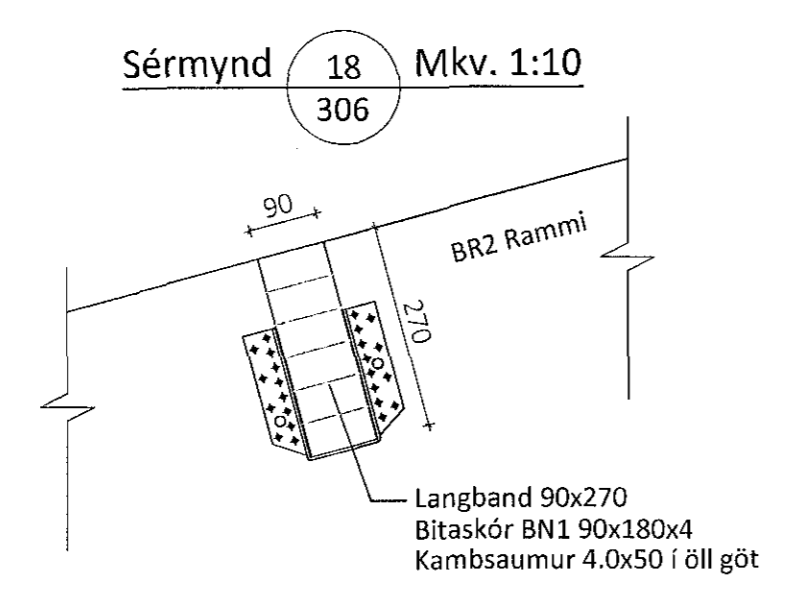

Sérmynd 18 Mkv. 1:10
306

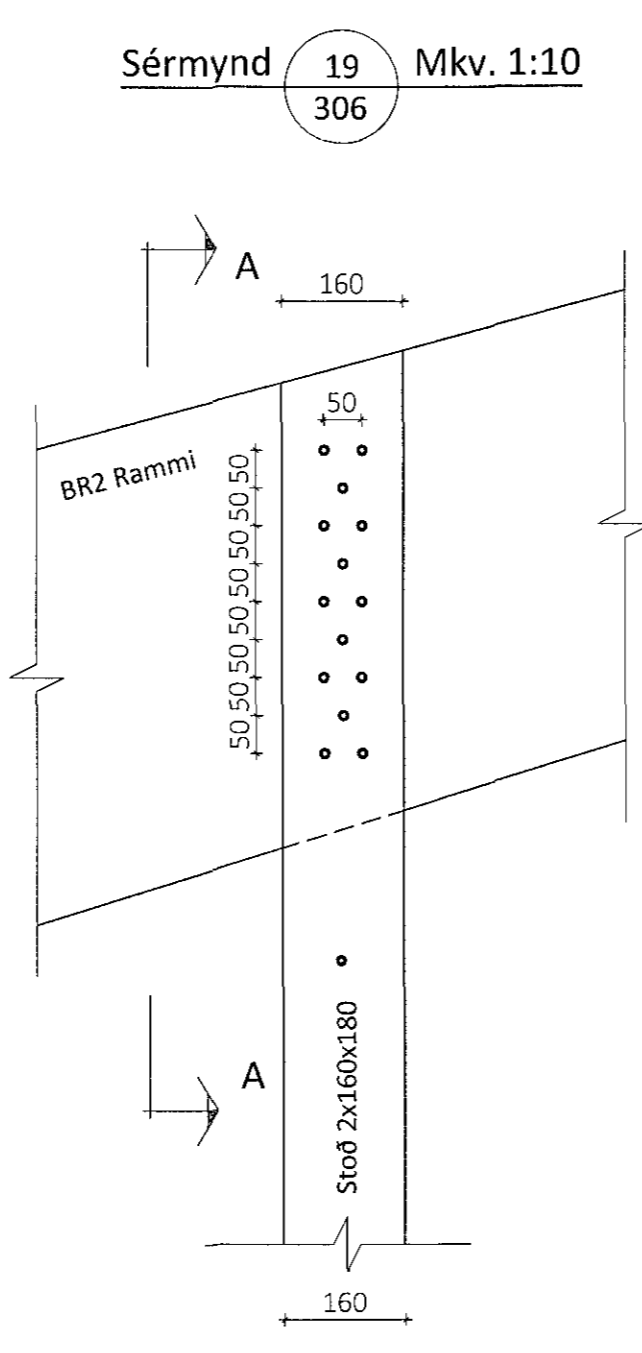

Sérmynd 19 Mkv. 1:10
306

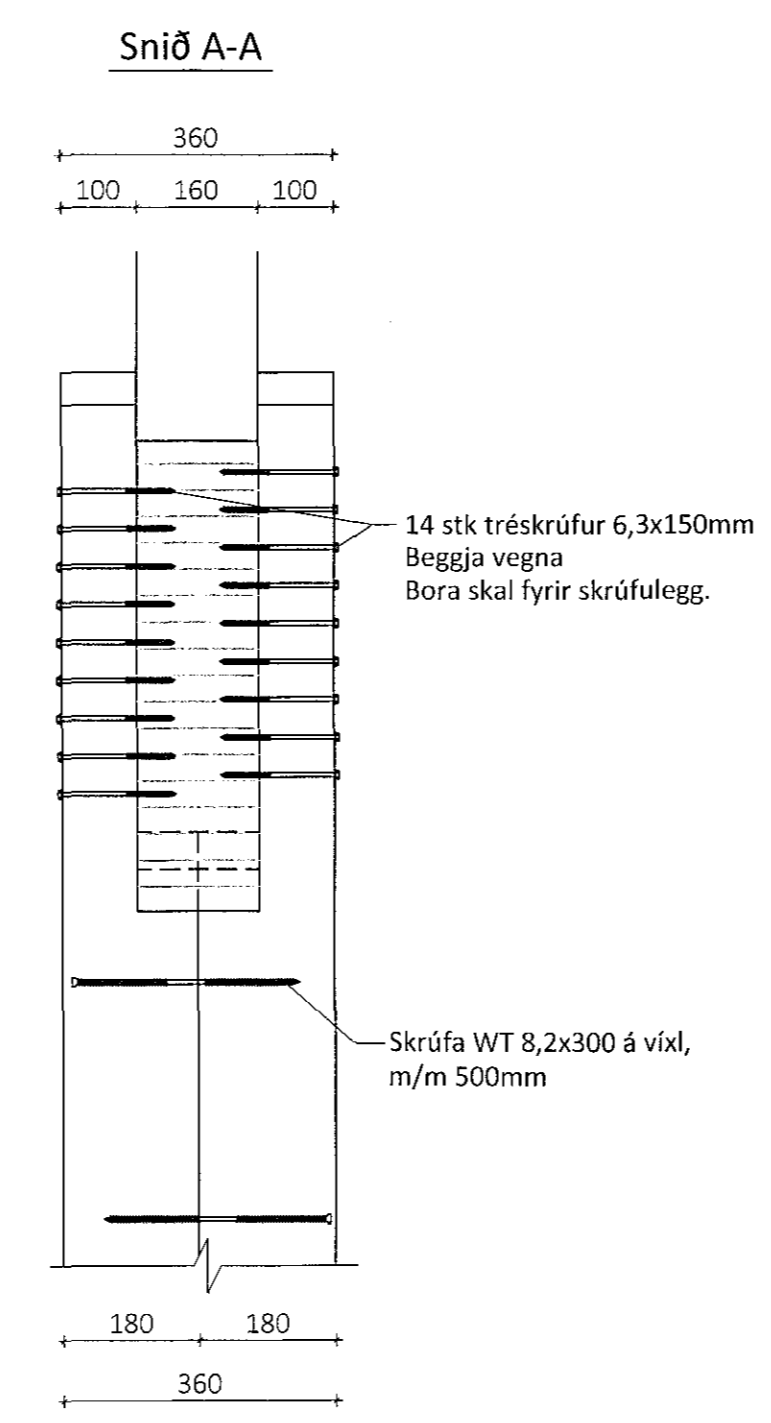

Snið A-A

Sérmynd 20 Mkv. 1:10
306

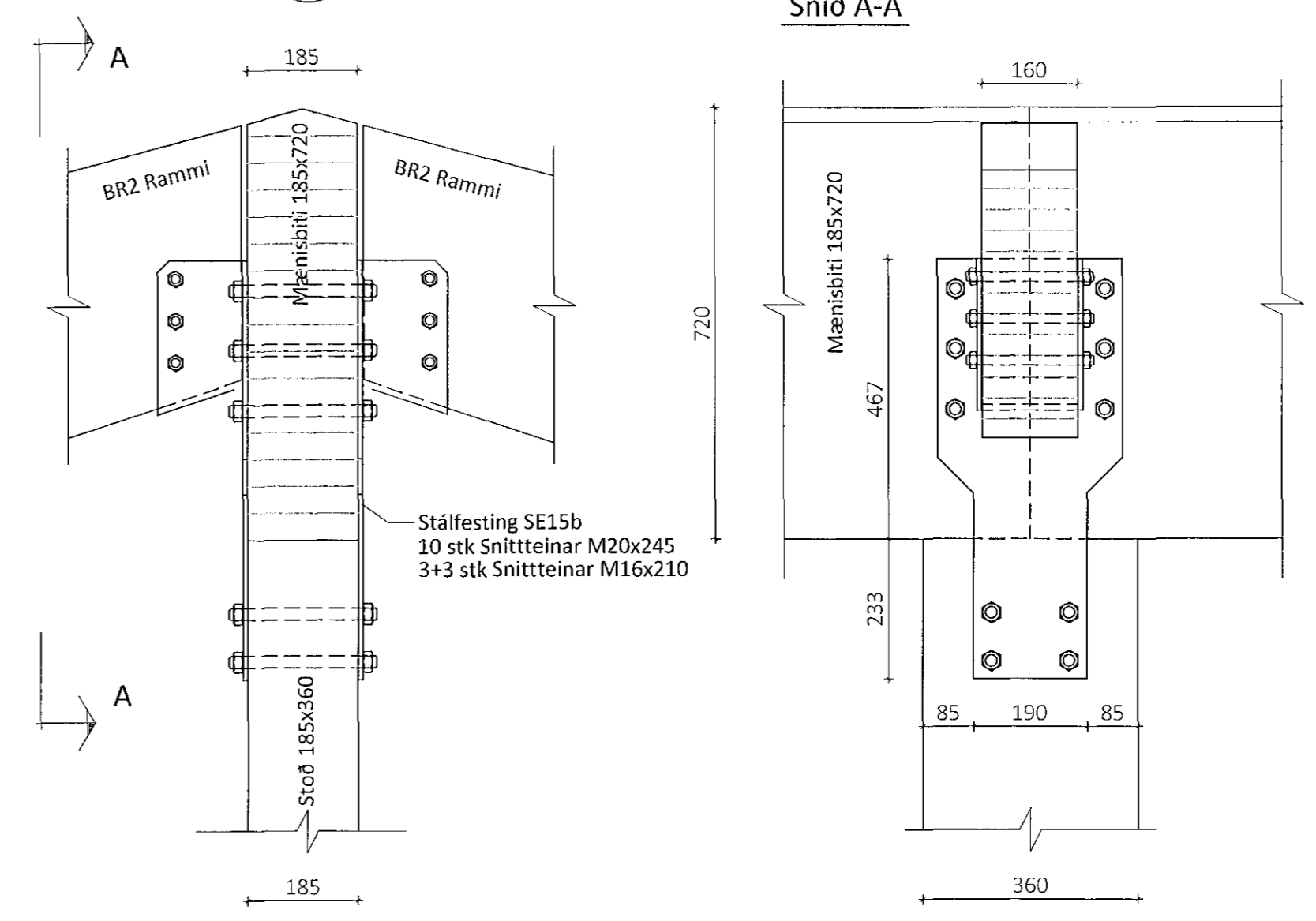

Snið A-A

Y - BMF-65x95x2.5x160 vinklar

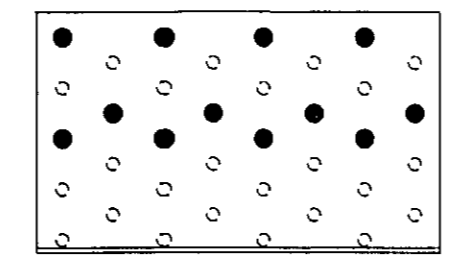

Negling í súlu/bita (nærri enda)
12 stk 40/50 kamsaumur

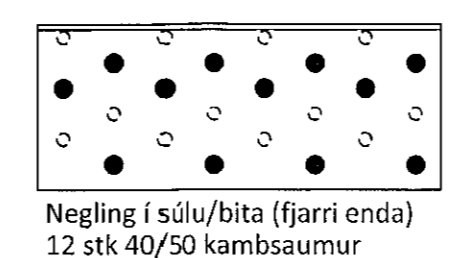

Negling í súlu/bita (fjarri enda)
12 stk 40/50 kamsaumur
Þar sem biti/stoð kemur að hurð eða glugga skal setja 3 stk tréskrúfur 6.0x140mm bora skal fyrir skrufulegg

X - BMF-65x95x2.5x200 vinklar

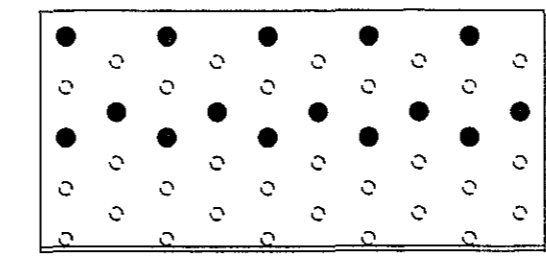

Negling í súlu/bita (nærri enda)
15 stk 4.0x50 kamsaumur

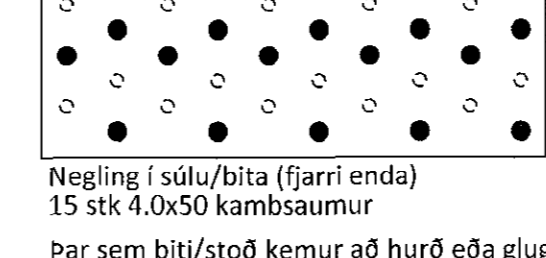

Negling í súlu/bita (fjarri enda)
15 stk 4.0x50 kamsaumur
Þar sem biti/stoð kemur að hurð eða glugga skal setja 3 stk tréskrúfur 6.0x140mm bora skal fyrir skrufulegg

Z - AB90 vinklar

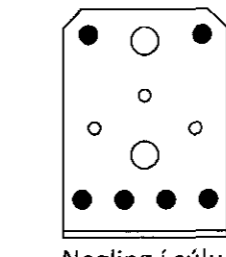

Negling í súlu/bita (fjarri enda)
6 stk 4.0x50 kamsaumur

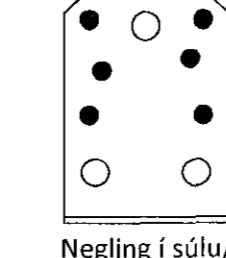

Negling í súlu/bita (nærri enda)
6 stk 4.0x50 kamsaumur

t - AB105 vinklar

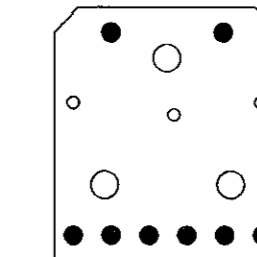

Negling í súlu/bita (fjarri enda)
8 stk 40/50 kamsaumur

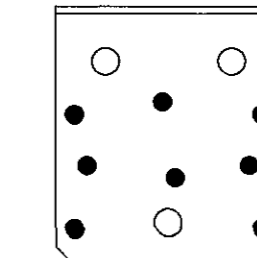

Negling í súlu/bita (nærri enda)
8 stk 40/50 kamsaumur
Þar sem biti/stoð kemur að hurð eða glugga skal setja 3 stk tréskrúfur 6.0x140mm bora skal fyrir skrufulegg

Öll afnot og afritun teikningar að hluta eða í heild er höð skriflegu leyfi LímtréVrnet ehf.

Útg.	Dags.	Breyting	Br. af

LímtréVrnet
Byggingadeild - Lynghöfði 2 - 110 Reykjavík
kt. 440510-1160 - Sími: 412 5300

Heiti vefs
Einhella 3, Hafnarfirði
Iðnaðarhús

Heiti teikningar
pversnið A-A og sérmyndir

Teiknað af: KB	Mælikvæði: 1:50, 1:10	Verknumer: DL18 041
Virfarið af: BI	Dagsetning: 13.11.2018	Útgáfa nr.: 1

Nafn hönnuðar
Bjarni Ingibergsson
Byggingatæknifræðingur
kt. 030861-2729

Áritun hönnuðar
[Signature]

Dags. áritunar
22/12/2018

306

301 Einhella 3