

Amarhraun-50 Ofnatafla
Staðsetning:
Flatarmál:
Rúmmál:

Amarhraun 50, hafnarfirði
ΔT: 35°C
Δp: 0,2 bar

Sem dæmi: O.S (Ofbasmíðja Suðurnesja)
A = Tegund 11
B = Tegund 22
C = Tegund 22
D = Tegund 33

| Ofn | Nr. | Hámarks- hæð [cm] | Hámarks- lengd [cm] | Tenging | | | | Lágmarks- afköst [W] | Vatns- rennsli [l/klst] | Skilyrði/Skýringar | Dæmi um ofn: | | Raun- [W] | Dæmi um ofn: | |
|--------------------------|-----|-------------------------|---------------------------|---------|---|---|-------|----------------------------|-------------------------------|--------------------|-----------------|----------|--------------|--------------|-------------|
| | | | | A | B | C | D | | | | OSS / Tengli | Vörueiti | | Framl. | Hitastillir |
| Amarhraun 50; 101 | | | | | | | | | | | | | | | |
| 01 - Svefnherb | 101 | 70 | 100 | CD | | | 678 | 19.5 | | | O.S 70 x 1000 A | 706 | Danfoss | RA 2900 | |
| 02 - Bað | 102 | 74 | 50 | BD | | | 269 | 7.7 | Handklæðaoafn | | O.S 74 x 500 | 270 | Danfoss | RA 2900 | |
| 03 - Gangur | 103 | 70 | 80 | CD | | | 569 | 16.3 | | | O.S 70 x 800 A | 565 | Danfoss | RA 2900 | |
| 04 - Alrými | 104 | 40 | 180 | AB | | | 1,251 | 35.9 | | | O.S 40 x 1800 A | 802 | Danfoss | RA 2900 | |
| | 105 | 60 | 80 | AB | | | | | | | O.S 60 x 800 A | 499 | Danfoss | RA 2900 | |
| Amarhraun 50; 102 | | | | | | | | | | | | | | | |
| 01 - Svefnherb | 106 | 70 | 100 | CD | | | 537 | 15.4 | | | O.S 70 x 1000 A | 706 | Danfoss | RA 2900 | |
| 02 - Bað | 107 | 74 | 50 | BD | | | 180 | 5.2 | Handklæðaoafn | | O.S 74 x 500 | 270 | Danfoss | RA 2900 | |
| 03 - Gangur | 108 | 70 | 80 | CD | | | 569 | 16.3 | | | O.S 70 x 800 A | 565 | Danfoss | RA 2900 | |
| 04 - Alrými | 109 | 40 | 180 | AB | | | 1,008 | 28.9 | | | O.S 40 x 1800 A | 802 | Danfoss | RA 2900 | |
| | 110 | 60 | 80 | AB | | | | | | | O.S 60 x 800 A | 499 | Danfoss | RA 2900 | |
| Amarhraun 50; 103 | | | | | | | | | | | | | | | |
| 01 - Svefnherb | 111 | 70 | 100 | CD | | | 678 | 19.5 | | | O.S 70 x 1000 A | 706 | Danfoss | RA 2900 | |
| 02 - Bað | 112 | 74 | 50 | BD | | | 269 | 7.7 | Handklæðaoafn | | O.S 74 x 500 | 270 | Danfoss | RA 2900 | |
| 03 - Gangur | 113 | 70 | 80 | CD | | | 569 | 16.3 | | | O.S 70 x 800 A | 565 | Danfoss | RA 2900 | |
| 04 - Alrými | 114 | 40 | 180 | AB | | | 1,217 | 34.9 | | | O.S 40 x 1800 A | 802 | Danfoss | RA 2900 | |
| | 115 | 60 | 80 | AB | | | | | | | O.S 60 x 800 A | 499 | Danfoss | RA 2900 | |
| Amarhraun 50; 201 | | | | | | | | | | | | | | | |
| 01 - Svefnherb | 201 | 70 | 110 | CD | | | 720 | 20.6 | | | O.S 70 x 1100 A | 777 | Danfoss | RA 2900 | |
| 02 - Bað | 202 | 94 | 50 | BD | | | 308 | 8.8 | Handklæðaoafn | | O.S 94 x 500 | 350 | Danfoss | RA 2900 | |
| 03 - Gangur | 203 | 70 | 80 | CD | | | 468 | 13.4 | | | O.S 70 x 800 A | 565 | Danfoss | RA 2900 | |
| 04 - Alrými | 204 | 40 | 180 | AB | | | 1,448 | 41.5 | | | O.S 40 x 1800 A | 802 | Danfoss | RA 2900 | |
| | 205 | 60 | 110 | AB | | | | | | | O.S 60 x 1100 A | 686 | Danfoss | RA 2900 | |
| Amarhraun 50; 202 | | | | | | | | | | | | | | | |
| 01 - Svefnherb | 206 | 70 | 100 | CD | | | 571 | 16.4 | | | O.S 70 x 1000 A | 706 | Danfoss | RA 2900 | |
| 02 - Bað | 207 | 74 | 50 | BD | | | 210 | 6.0 | Handklæðaoafn | | O.S 74 x 500 | 270 | Danfoss | RA 2900 | |
| 03 - Gangur | 208 | 70 | 80 | CD | | | 468 | 13.4 | | | O.S 70 x 800 A | 565 | Danfoss | RA 2900 | |
| 04 - Alrými | 209 | 40 | 180 | AB | | | 1,174 | 33.7 | | | O.S 40 x 1800 A | 802 | Danfoss | RA 2900 | |
| | 210 | 60 | 80 | AB | | | | | | | O.S 60 x 800 A | 499 | Danfoss | RA 2900 | |
| Amarhraun 50; 203 | | | | | | | | | | | | | | | |
| 01 - Svefnherb | 211 | 70 | 100 | CD | | | 571 | 16.4 | | | O.S 70 x 1000 A | 706 | Danfoss | RA 2900 | |
| 02 - Bað | 212 | 74 | 50 | BD | | | 210 | 6.0 | Handklæðaoafn | | O.S 74 x 500 | 270 | Danfoss | RA 2900 | |
| 03 - Gangur | 213 | 70 | 80 | AB | | | 468 | 13.4 | | | O.S 70 x 800 A | 565 | Danfoss | RA 2900 | |
| 04 - Alrými | 214 | 40 | 180 | AB | | | 1,174 | 33.7 | | | O.S 40 x 1800 A | 802 | Danfoss | RA 2900 | |
| | 215 | 60 | 80 | AB | | | | | | | O.S 60 x 800 A | 499 | Danfoss | RA 2900 | |
| Amarhraun 50; 204 | | | | | | | | | | | | | | | |
| 01 - Sameign/bíðstofa | 216 | 70 | 120 | CD | | | 1,625 | 46.6 | | | O.S 70 x 1200 A | 848 | Danfoss | RA 2900 | |
| | 217 | 70 | 120 | AB | | | | | | | O.S 70 x 1200 A | 848 | Danfoss | RA 2900 | |
| 02 - Skristofa | 218 | 50 | 160 | AB | | | 741 | 21.3 | | | O.S 50 x 1600 A | 859 | Danfoss | RA 2900 | |
| 03 - Eldhús | 219 | 50 | 160 | CD | | | 858 | 24.6 | | | O.S 50 x 1600 A | 859 | Danfoss | RA 2900 | |
| 04 - Snyrting | 220 | 134 | 50 | BD | | | 369 | 10.6 | Handklæðaoafn | | O.S 134 x 500 | 498 | Danfoss | RA 2900 | |

Samtal þörf: 19177.3

Samtal veitt: 21302.0

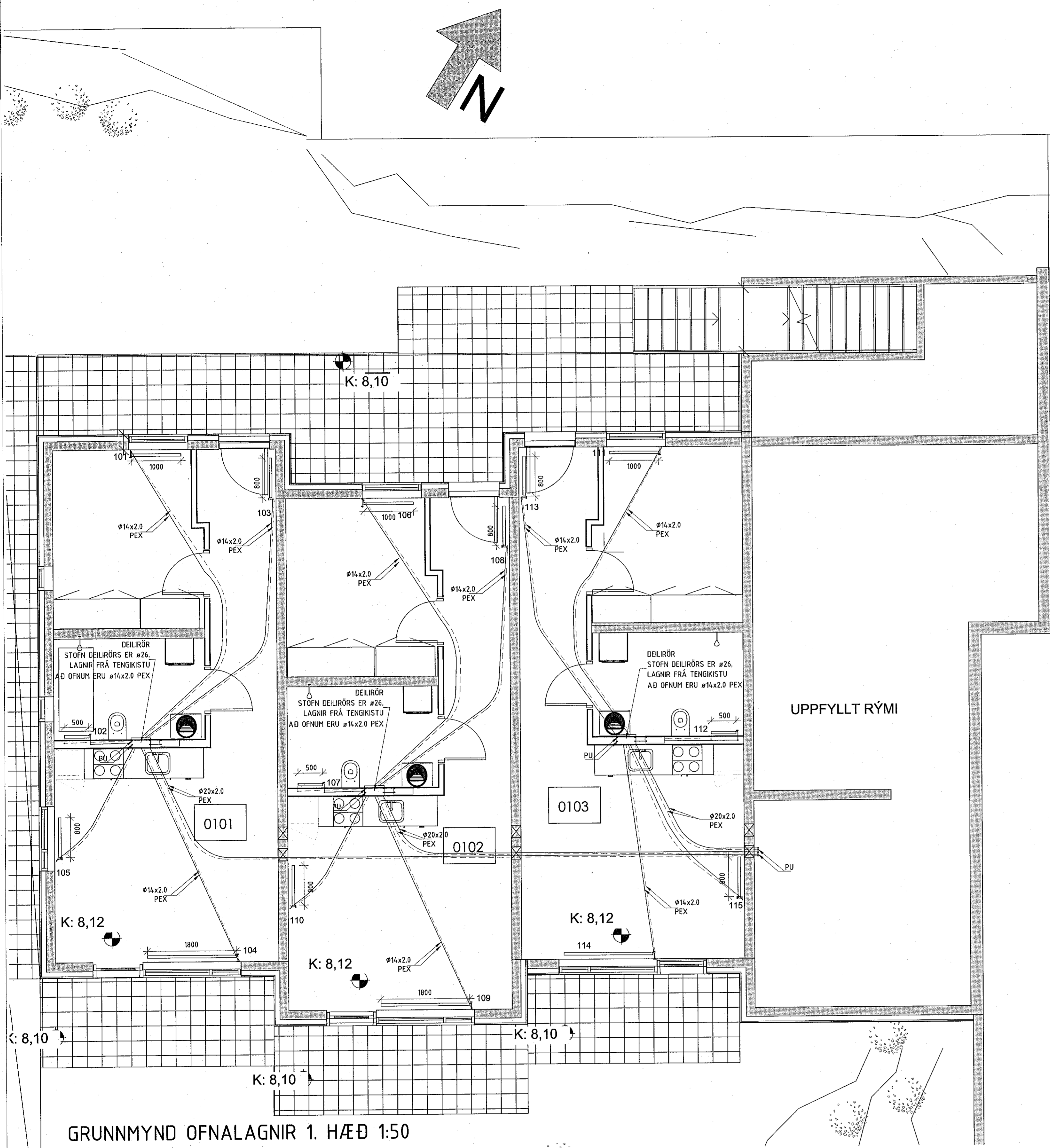

GRUNNMYND OFNALAGNIR 1. HÆÐ 1:50

Breyting: _____ Dags.: _____ Breytt af: _____ Hverju breytt: _____

Skýringar: _____

Verkefni: **Amarhraun 50**
Hafnarfirði

Verkhúsi: **GRUNNMYND HITLAGNA**
GRUNNMYND 1. HÆÐAR

Mv.: 150 Fv.: Lagfr

Tekningar skjalnám: P1802150VERK Undirskrift hönnuðar: _____

Dags.: 28.03.2019 Teiknað: HA Kennitala: 020561-4.759

Hannað: VJ Yfirfarið: VJ Undirskrift aðalhönnuðar: _____

Verk nr.: 1802150 Teikninga nr.: P06 Kennitala: 281278-2239

