

Samþykkt þann
30 SEPT. 2003

Byggingafræðingur / Hafnarfræðingur
F.h. Kristján Þorvaldsson

KJP

A-A. 1:250

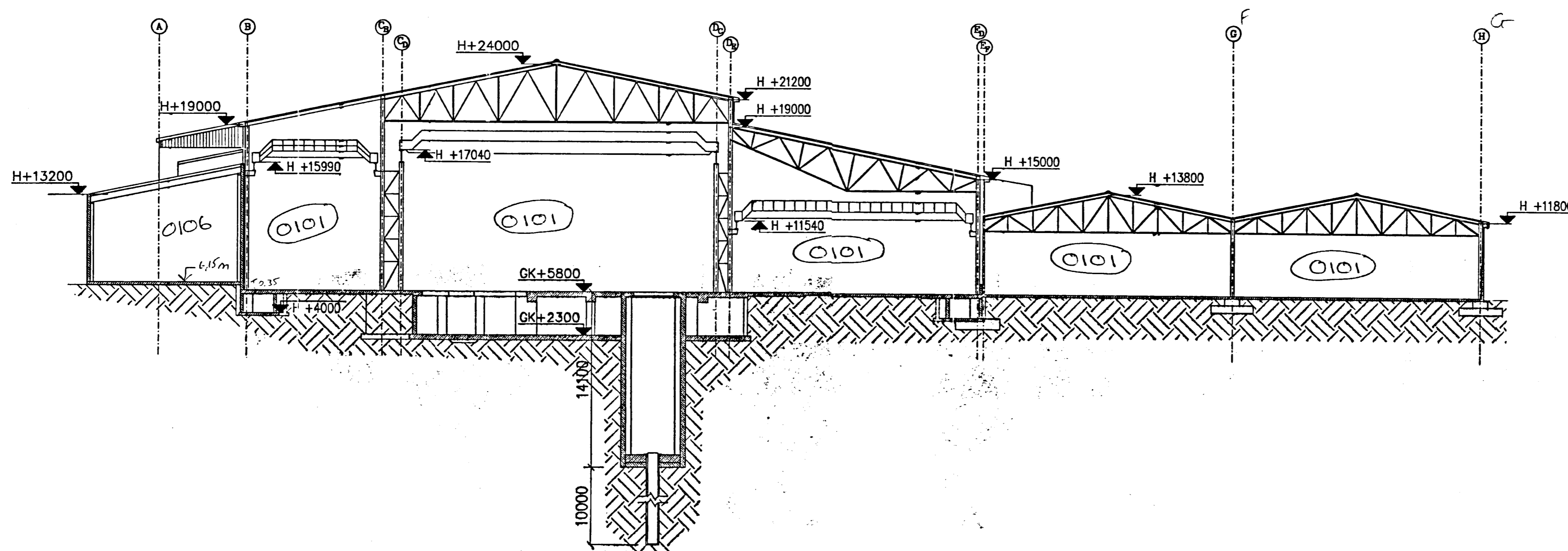

B-B. 1:250

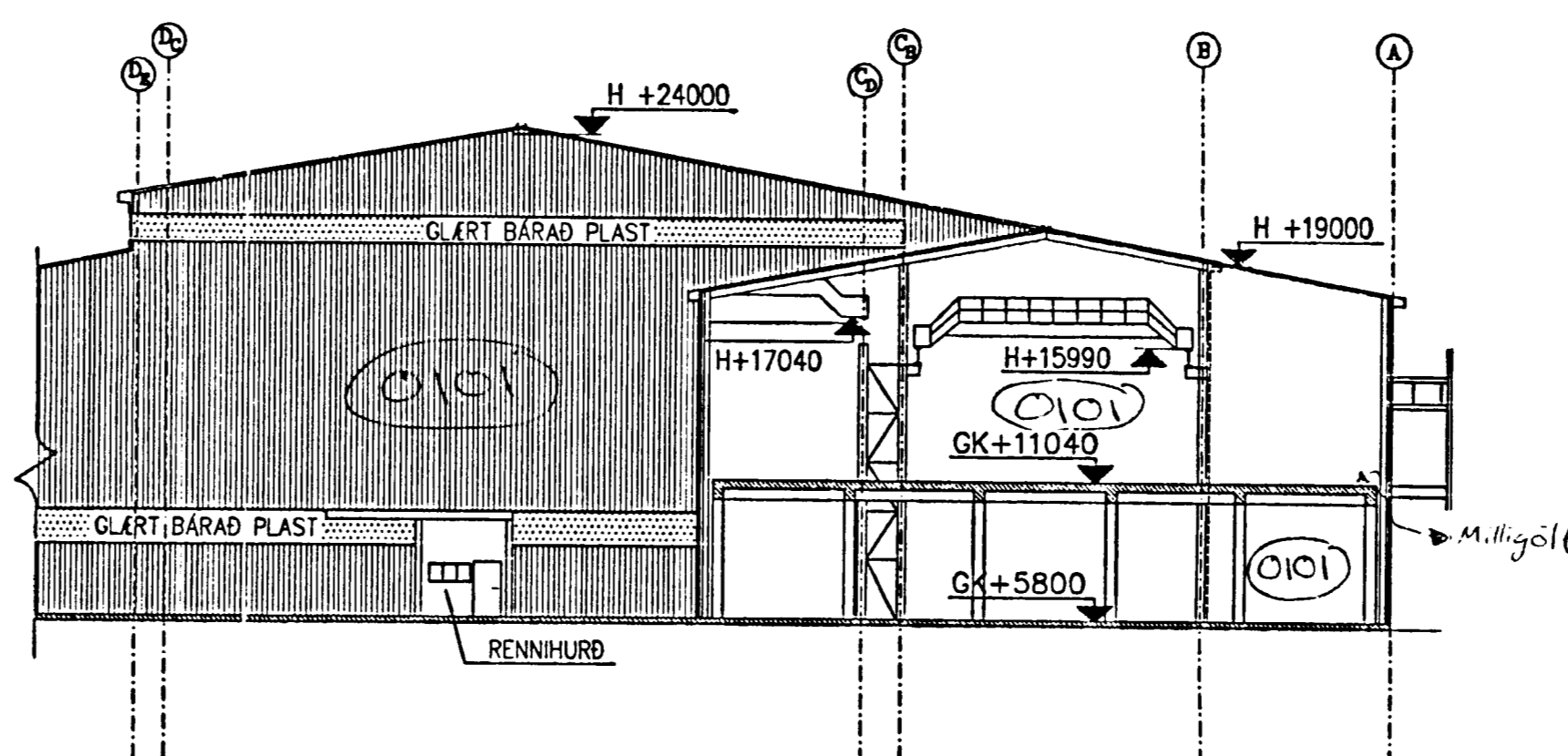

Alcan á Íslandi hf.



Skráning matshluta bygginga í Straumsvík

STEYPUSKÁLI	123154	12
<small>Heiti byggingar</small>	<small>Fastanúmer</small>	<small>Landnúmer</small>

VST Verkfæðistofa Sigurðar Thoroddsen hf. kt. 611276-0289

<i>Niels Indriðason</i>	2003-09-19
<small>Niels Indriðason kt. 181144-3949</small>	<small>Dagsetning</small>

ICELANDIC
ALUMINIUM
COMPANY LTD.

DRAWN	5.5.1996	HHH
APPROVED	5.5.1996	UH
PROCESS		
PROJECT		
SCALE	1:250	FORMAT A1

STÆKKUN STEYPUSKÁLA
SNÍÐ

ALUSUISSE
ALESA

79000-34405

VERKFRÆDISTOFAN ÖNN SF.
TAEKNITHJÓNUSTAN SF.

193605 6010BA1226

REVISJÓN

1

REV. NO.	DATE	REVISION	BY	APP.	REV. NO.	DATE	REVISION	BY	APP.	NOTES	REFERENCE DRAWING	DRAWING NUMBER
A	26.11.1997	AS BUILT		UH								
0												

This drawing is our property and given for personal use only. It may not be copied or made available to others without our permission. The receiver is responsible for any misuse.

