

ΔT = 50°C

OFN NR.	KCAL/H	STEYPUJÁRNS-OFNAR "NEO-CLASSIC"
1	640	17-2/30"
2	1930	27-4/30"
3	490	7-4/30"
4	930	13-4/30"
5	990	14-4/30"
6a	300	8-2/30"
6b	1990	53-4/18"
7a	1200	14-4/36"
7b	1200	14-4/36"
8a	300	8-2/30"
8b	1990	53-4/18"
9	990	14-4/30"
10	590	8-4/30"
11	230	6-2/30"
12	1860	26-4/30"
13	640	17-2/30"

OFN NR.	KCAL/H	STEYPUJÁRNS-OFNAR "NEO-CLASSIC"
14	640	17-2/30"
15	1860	26-4/30"
16	230	6-2/30"
17	590	8-4/30"
18	990	14-4/30"
19a	300	8-2/30"
19b	1990	53-4/18"
20a	1200	14-4/36"
20b	1200	14-4/36"
21a	300	8-2/30"
21b	1990	53-4/18"
22	990	14-4/30"
23	590	8-4/30"
24	230	6-2/30"
25	1860	26-4/30"
26	640	17-2/30"

OFN NR.	KCAL/H	STEYPUJÁRNS-OFNAR "NEO-CLASSIC"
27	640	17-2/30"
28	1860	26-4/30"
29	230	6-2/30"
30	590	8-4/30"
31	990	14-4/30"
32a	300	8-2/30"
32b	1990	53-4/18"
33a	1200	14-4/36"
33b	1200	14-4/36"
34a	300	8-2/30"
34b	1990	53-4/18"
35	990	14-4/30"
36	930	13-4/30"
37	490	7-4/30"
38	1930	27-4/30"
39	640	17-2/30"

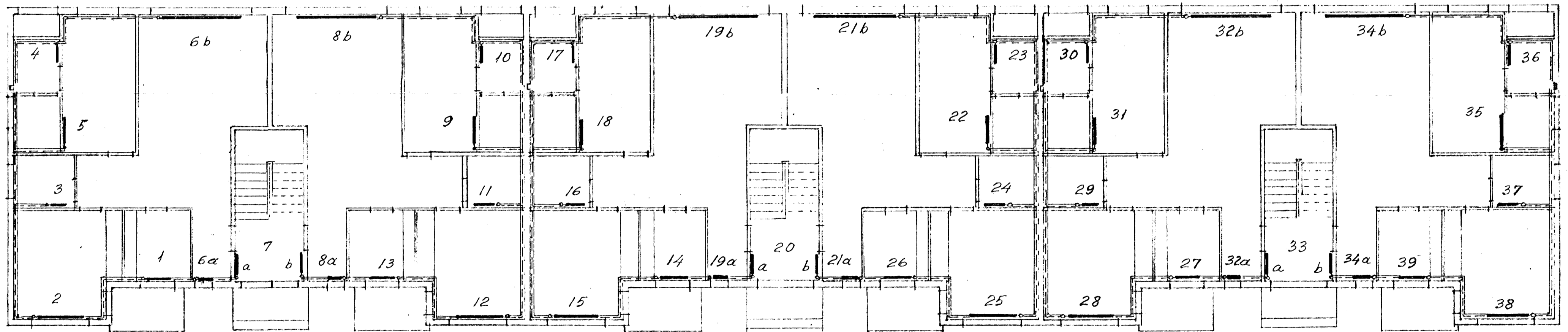

1. HÆÐ

GUNNAR TÓMASSON, VERKFR., M.V.F.I. BARMÁHLÍÐ 31, RVÍK., SÍMI 23932		
SMYRLAHRUN 43-45-47, HAFNARÉ HITAKERFI 1. HÆÐ		
MÁLKV.	1:100	HANNAÐ GT.
DAGS.	14 FEBR. 1966	TEIKNAD GT.
TEIKN. NR.	6601	
BLAÐ	1 AF 4	Gunnar Tomasson