

FOUNDATION F2
7 pcs

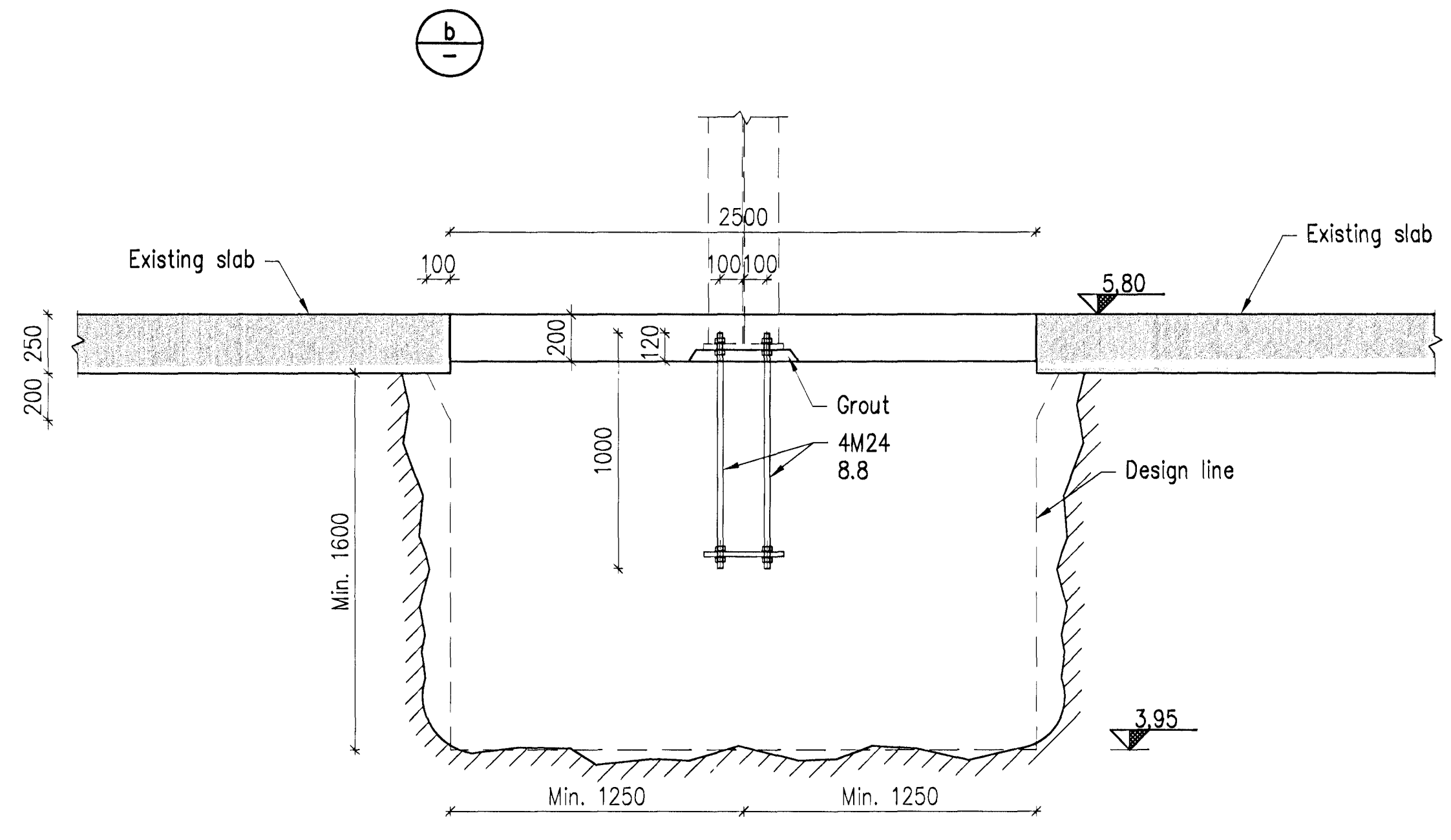
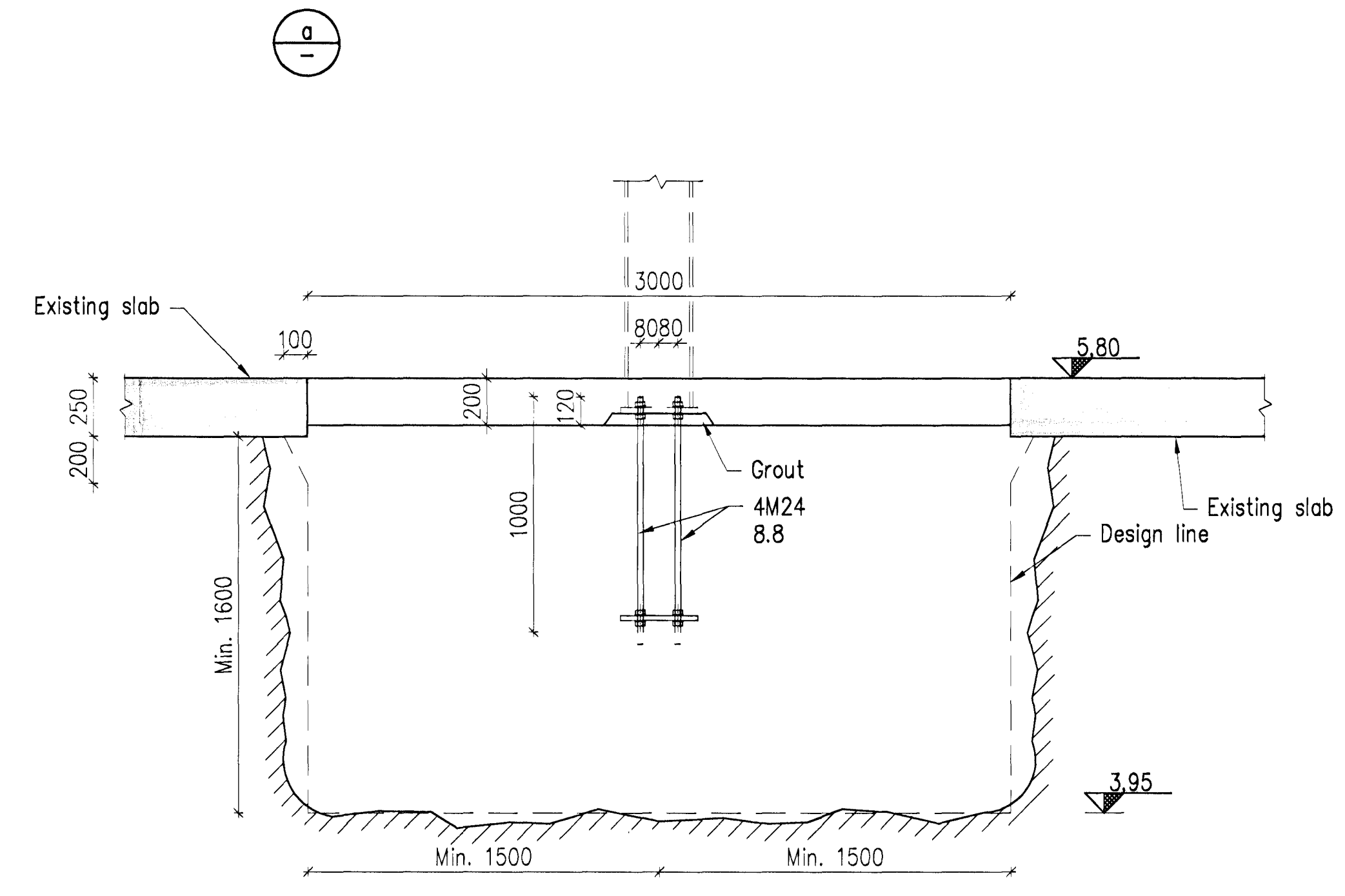
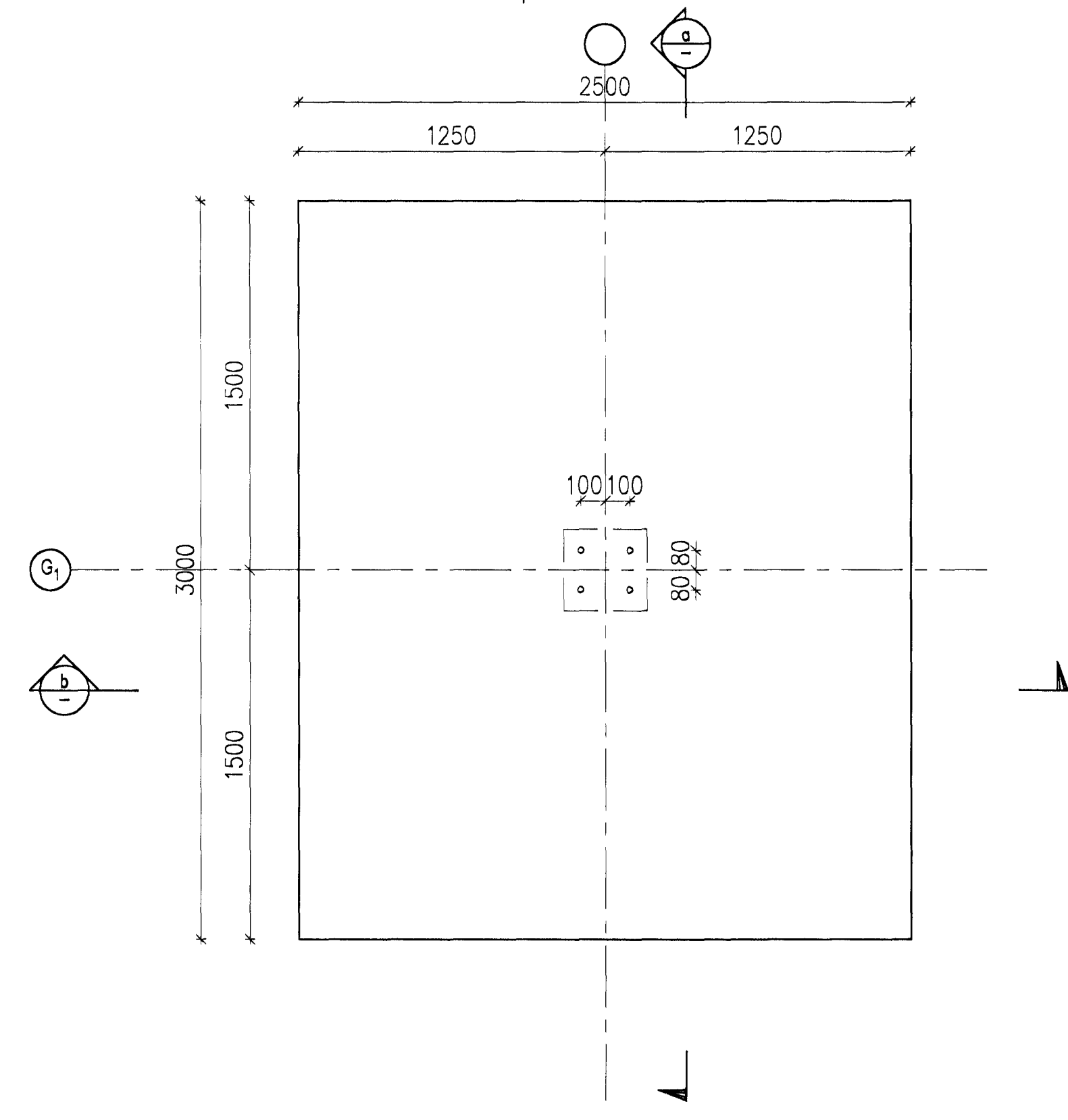

Samþykkt þann
19 JAN 2011
Byggingarverkefni: Vindur og hitafráhrif
F.h. Hrólfur S. Gunnlaugsson

Níel Indriðason
NI

CONCRETE: C30/37:XF3-38

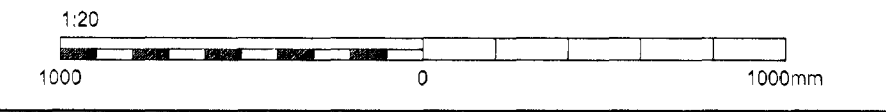

Skýringar:
Explanations:



This drawing is the property of the Rio Tinto Alcan Iceland Ltd and handed out for personal use only. It may neither be copied nor made available to others without permission of the Rio Tinto Alcan Iceland Ltd. The receiver is liable for any misuse.

Fjöldi stúkkja Number of pieces	Hlutur Object	Atriði Item	Efni Material	Eq.stk Weight (kg)	Ítalgi í heild Total in all	Athugasemdir Remarks
IV III II I	ICC CASTHOUSE EXTENSION BUILDINGS BUILDING 2, FORM WORK FOUNDATION F2					Stærð Formas Scale A1 Skv. Scale 1:20 Kostn.nr.-báttur / Útska.-Eg.no.
	versnir / Super	HRV				Teknir. vertið / Drns. of supp. Breyt./Rev. ACC-611-CA-518-203 C
	Teknað Drawn	HS/AFV 2010.11.01	Yfirfarið Checked	NI		Sambýkkt Approved NI
	RioTinto Alcan		ISAL Stjórnun Alcan Iceland Ltd IS-222 Hafnarþorur			Drns. of ISAL / Teknir. ISAL Breyt./Rev.
	Teknað Drawn	Yfirfarið og skráð Checked and filed				Nýttan heimur Release