

KJP

VÁRÐANDE EINIINGAR Í HÚSI:  
Einiingar skulu vatnaðar sbr. ákvaðið  
í byggingarreglugerð og skal sferlísing  
um það áseta fyrir þús byggingarfrum-  
túni áður en þeir komu á byggingarstað.  
Hus með einingun átt vattunar  
fá ekki foheldisvottorð.

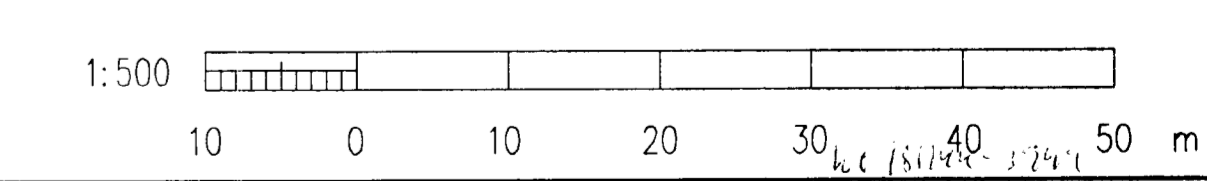
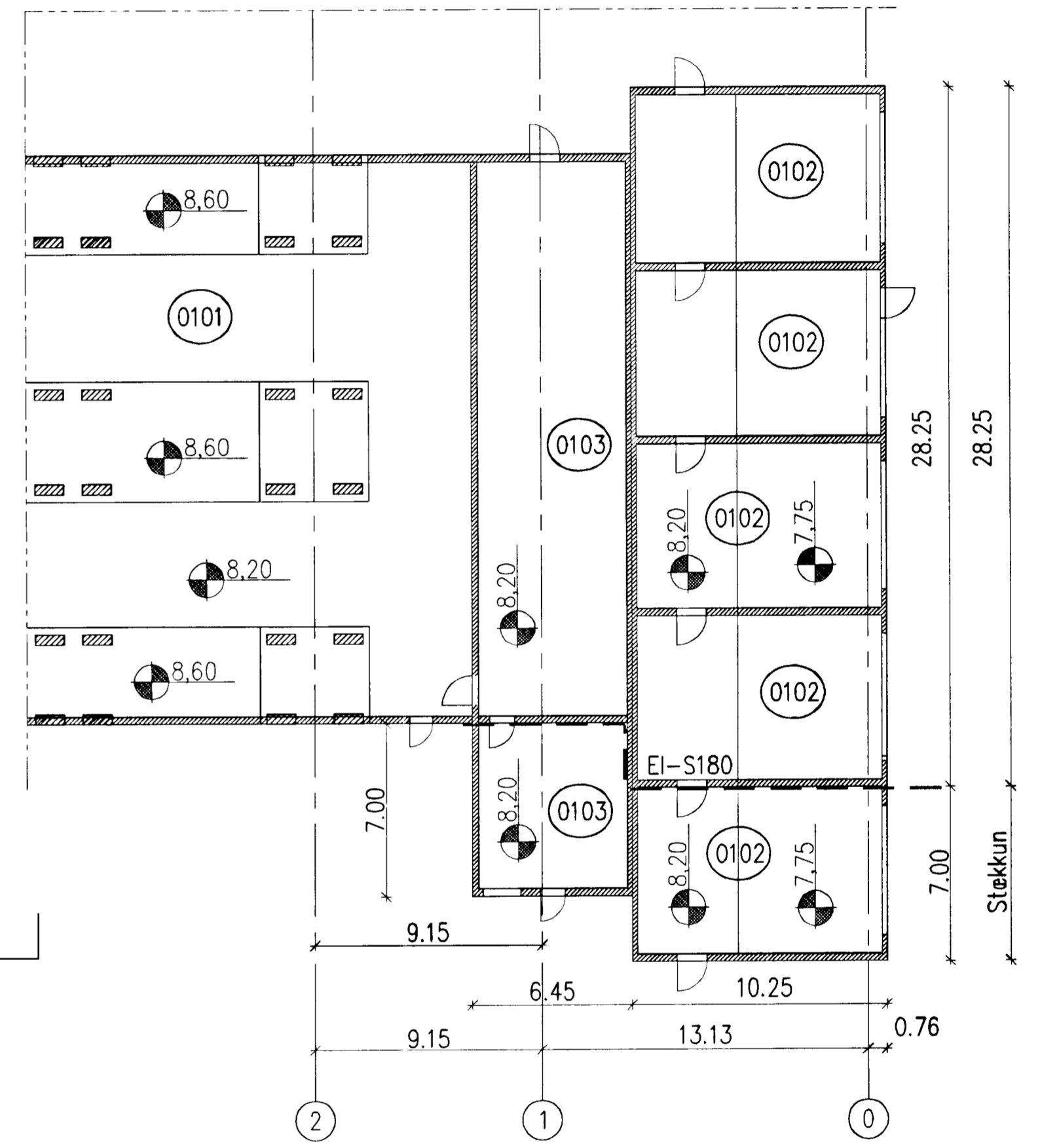
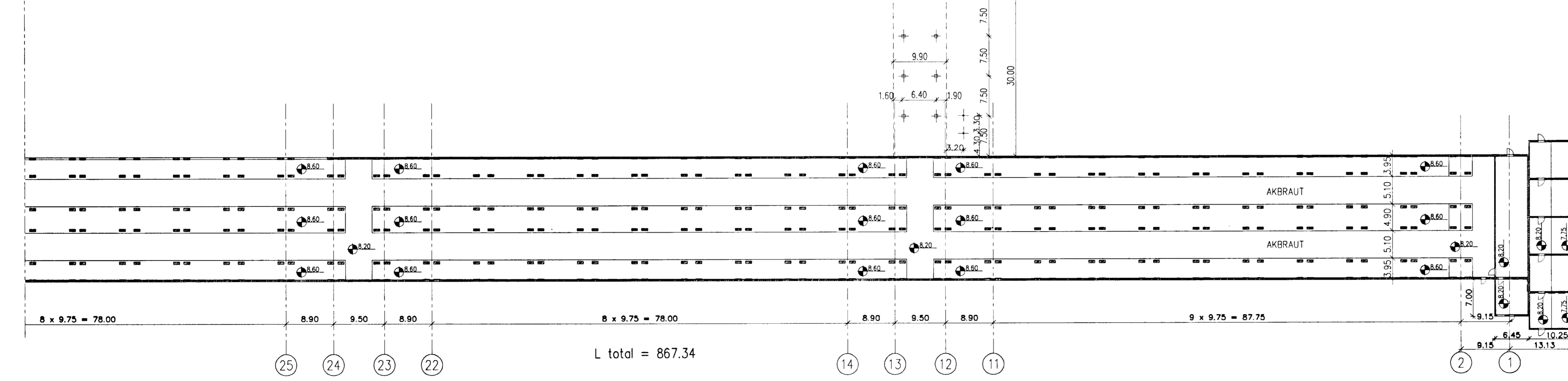
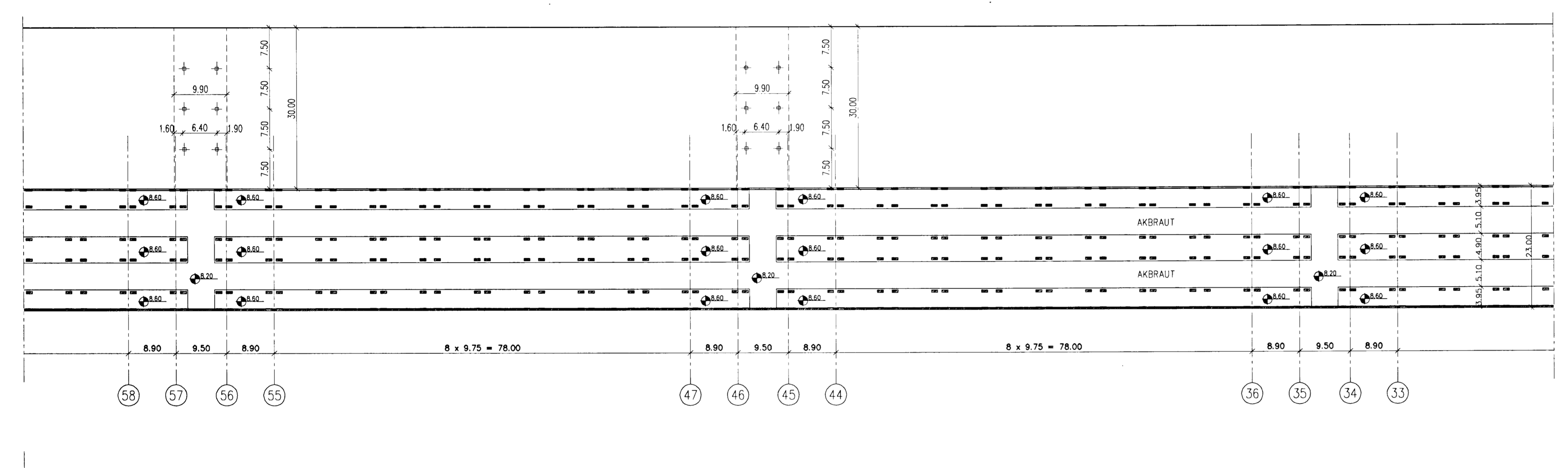
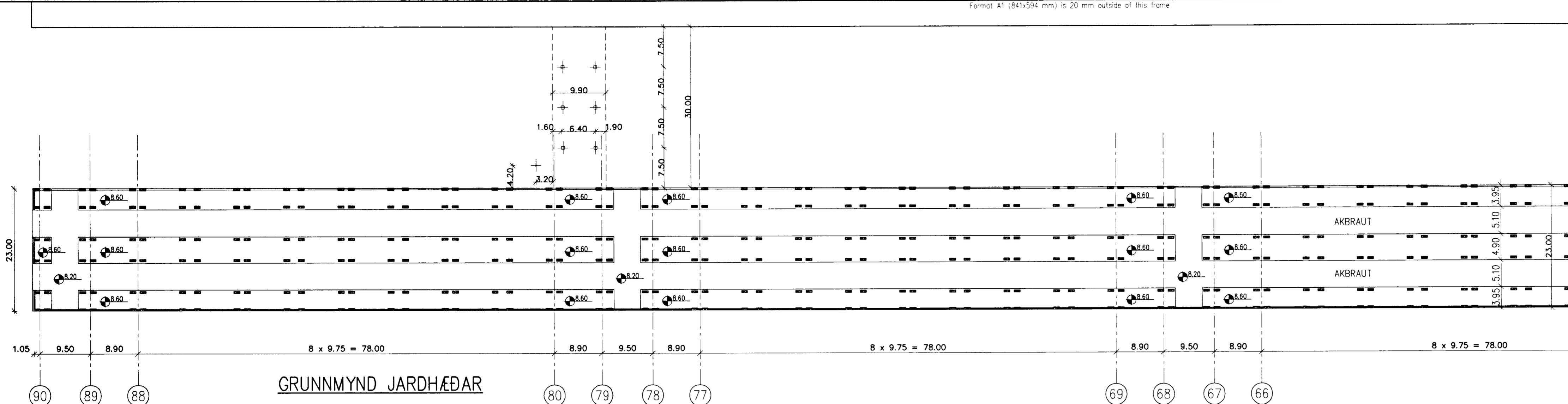

K:\2003.01\10\23-III-rec\Teikn\Adal\teikn\186702.dwg

Skýringar: Explanations:									
1	Útboðsteikning		04.09.03						
Breyt. Rev.		Breyling Revision	Dagur Date	Samb. Approved	Nafn heimil. Released				
Tilv. teikningar nr. ISAL Ref. drawing no. of ISAL		Samsætning. teikningar nr. ISAL Assembly drawing no. of ISAL							

**VST** Verkfæðistofa  
Sigurðar Thoroddsen hf.  
Ársmúli 4, 108 Reykjavík, Sími: 591 5000, Fax: 591 5010

This drawing is the property of the Alcan Iceland Ltd. and handed out for personal use only. It may neither be copied nor made available to others without permission of the Alcan Iceland Ltd. The receiver is liable for any misuse.		Fjöldi stúkja Number of pieces		Hlutur Object		Atriði Item		Efni Material		Eg. stk. Weight		Totalt í heild Total in all		Athugasemdir Remarks	
		IV III II I		KERSKÁLI 3 - ADALTEIKNING - Mhl. 97		Stærð Format		A1		Msk. 1:200/500		4011		1189	
				STECKUN AFRIDLASTÖÐVAR		AKS no.		UB 30		Tekn. vefur / Dr. no. of supp.		2003.0110		23.02	
				GRUNNMYND JARDHÆÐAR		Samb. / Supplier		VST		Tékn. / Drawn		NI		SGH	
						Yfirf. / Checked		NI		Samb. / Approved		KJP		KJP	
				ALCAN PRIMARY METAL EUROPE		Tékn. / Drawn		ISAL		Samb. / Approved		186702		1	
				Alcan Iceland Ltd		Tékn. / Drawn		SEPTEMBER 2004		Yfirf. / Checked		and f. / and f.		Notun heimil. Released	