

TUNNEL BETWEEN P2 AND P3, ROOF PLAN, 1:50

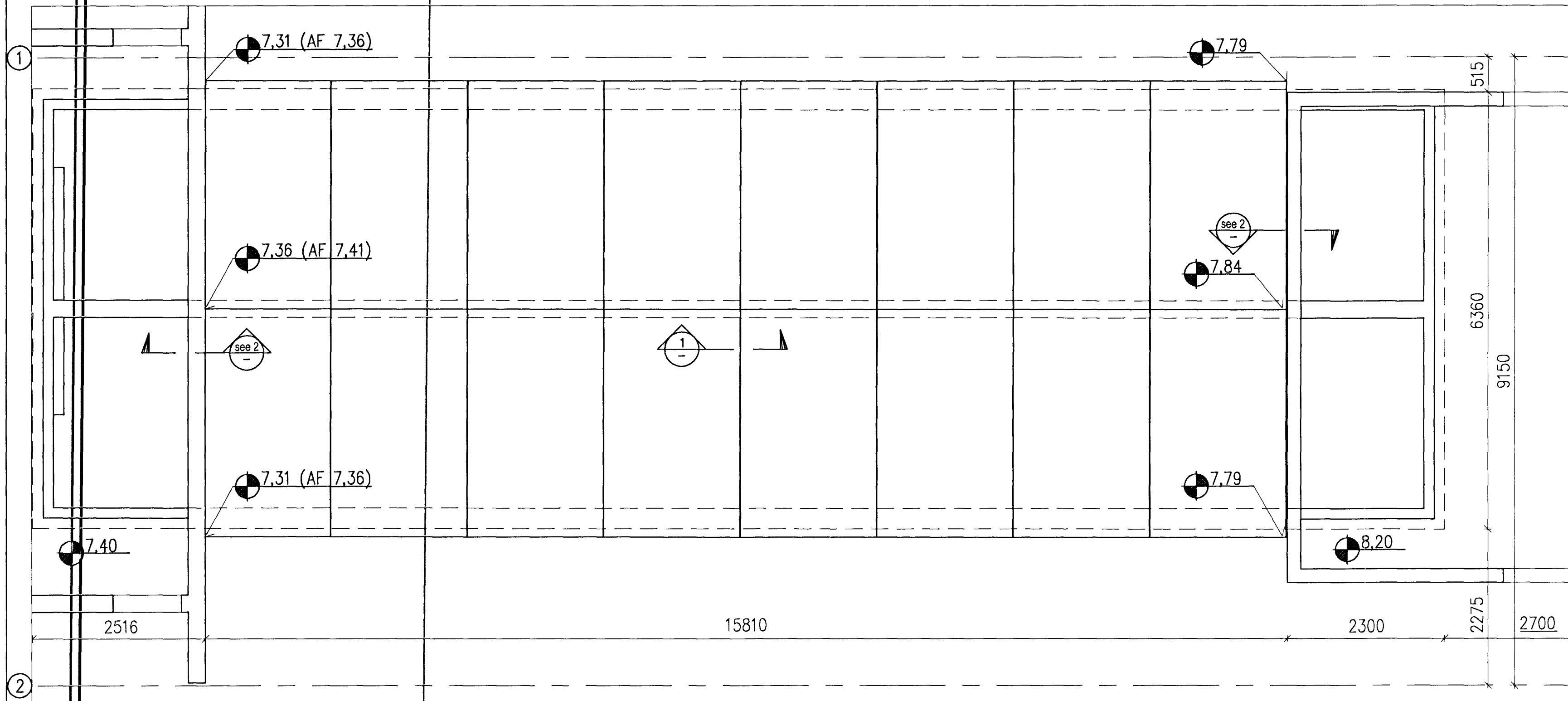

A ROOF ELEMENT, 12 pcs., 1:20

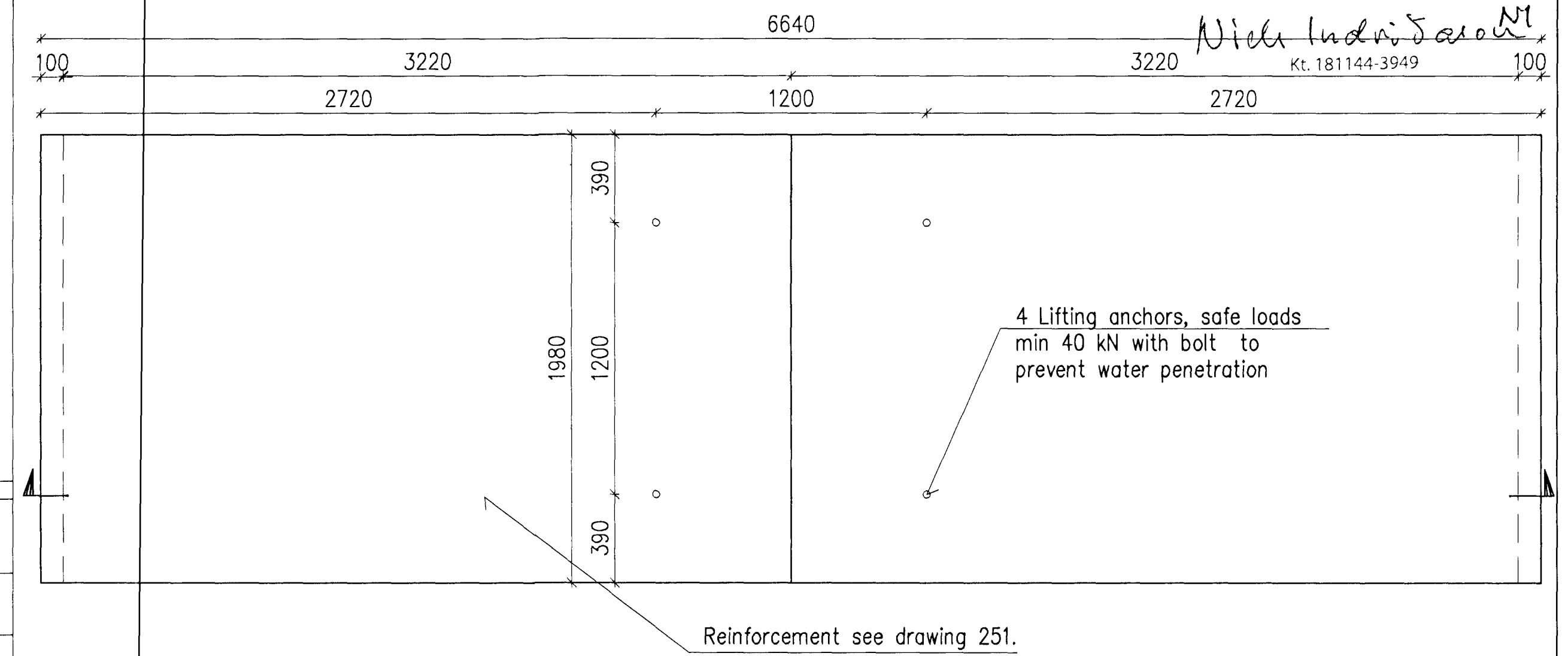

Samþykkt þann
 01 OCT 2012
 Byggingafulltrúiinn (Hafnarstí) /
 F.h. Sigurður Steinarsson

Nick Indriásson
 Kt. 181144-3949

TUNNEL BETWEEN P1 AND P2, ROOF PLAN, 1:50

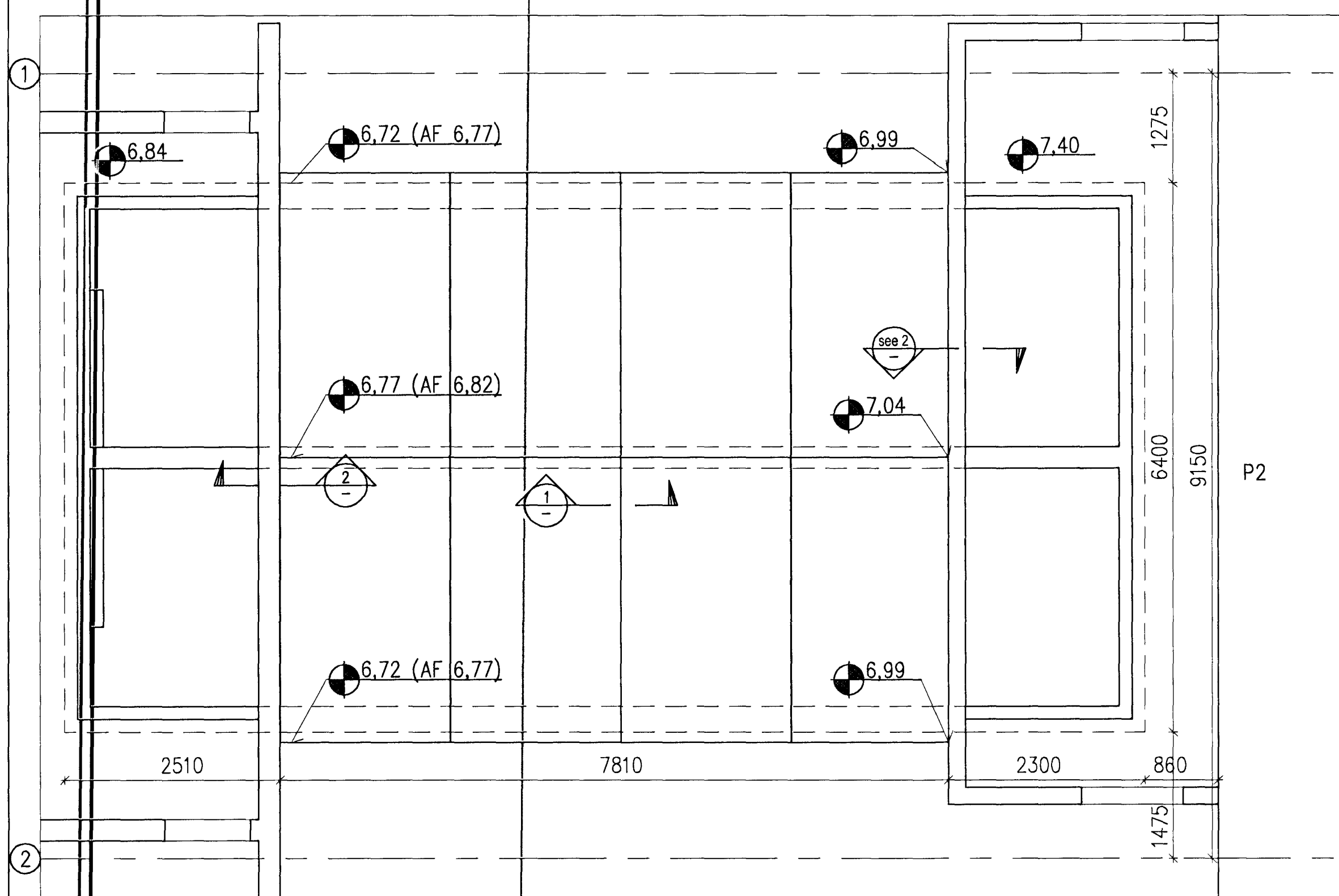

2 SECTION, 1:10

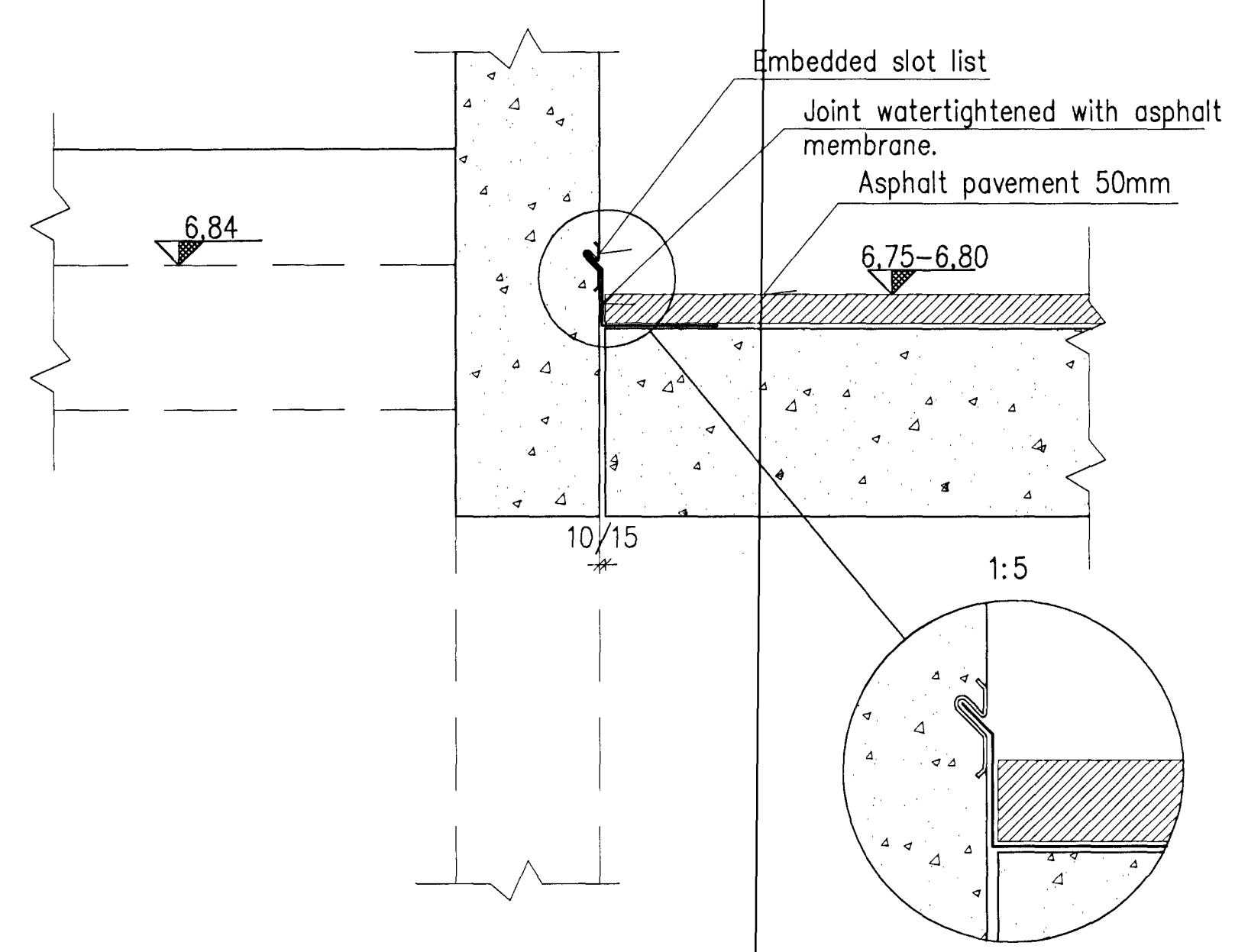

1 SECTION, 1:10

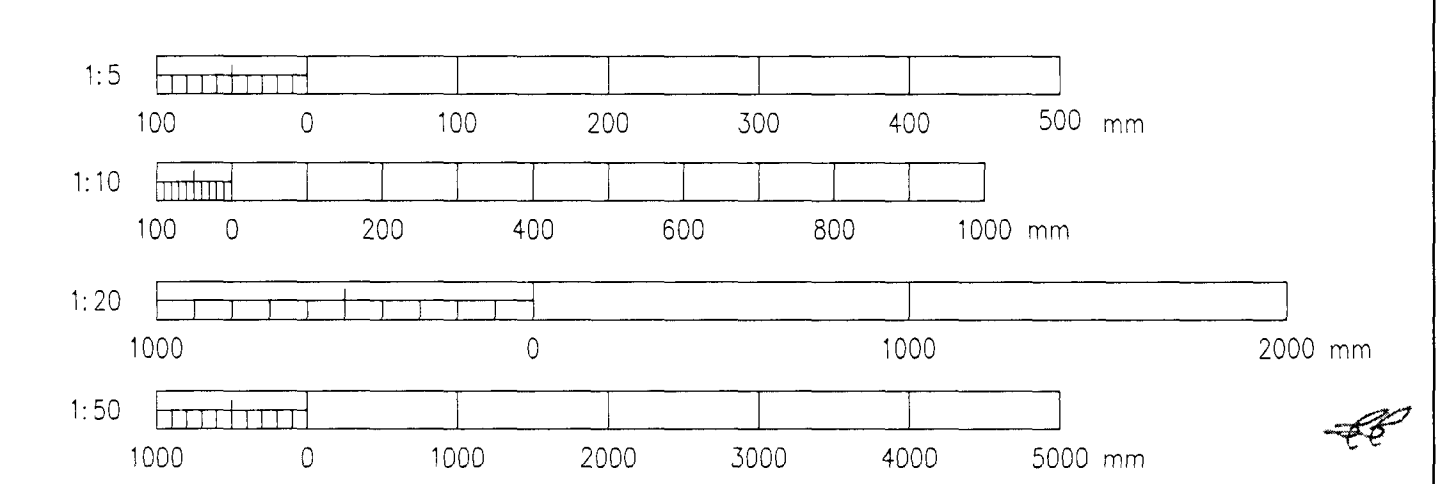

Skýringar:
 Legend:
 Concrete: C30/37:XF3-32
 AF = Asphalt pavement Finish
 Max axle load on roof element 240 kN c/c 1:2 m.

14	Record drawing	2012.09.12	GMG	NI	BG	RS
Eig nr	Rev no	Uppf. / Description	Dagsetning / Date	Navn / Name	Yfirl. / Supp. Ref	Stað. / ISAL Ref

This drawing is the property of Rio Tinto Alcan Iceland Ltd. and handed out for personal use only. It may neither be copied nor made available to others without permission of Rio Tinto Alcan Iceland Ltd. The receiver is liable for any misuse.

HRV HATCH
 REAL PRODUCTION OPERATOR

Dagsetning / Date: 2010.09.29
 Hlunnað / Designed: GMG
 Teikn / Drawn: GMG
 Verktaki / Supplier: HRV
 Tekni nr. verktaka / Supplier drawing: IDP-410-CA-015-252
 Samþykkt / Approved: NI
 Hluti af / Part of:

IPU410-RECTIFIER BUILDINGS A5/S1 AND B5/S2 ROOF PLAN, DETAILS		Flokkur nr.: 4011	Blað nr.: 16961
Teikningar / Dwg. type: BUSBAR TUNNELS		AKS UB21	
Rio Tinto Alcan Alcan Iceland Ltd Stámsvirk IS-222 Hafnarfordur Ísland		Tekni nr. ISAL / Drw.no. of ISAL: 251259	Breyt. / Rev. A