

Níels Indrísason  
Kr. 181144-3949  
NI

WELAND GRATING H6 40/3, BOTTOM PLAN VIEW, 1:50

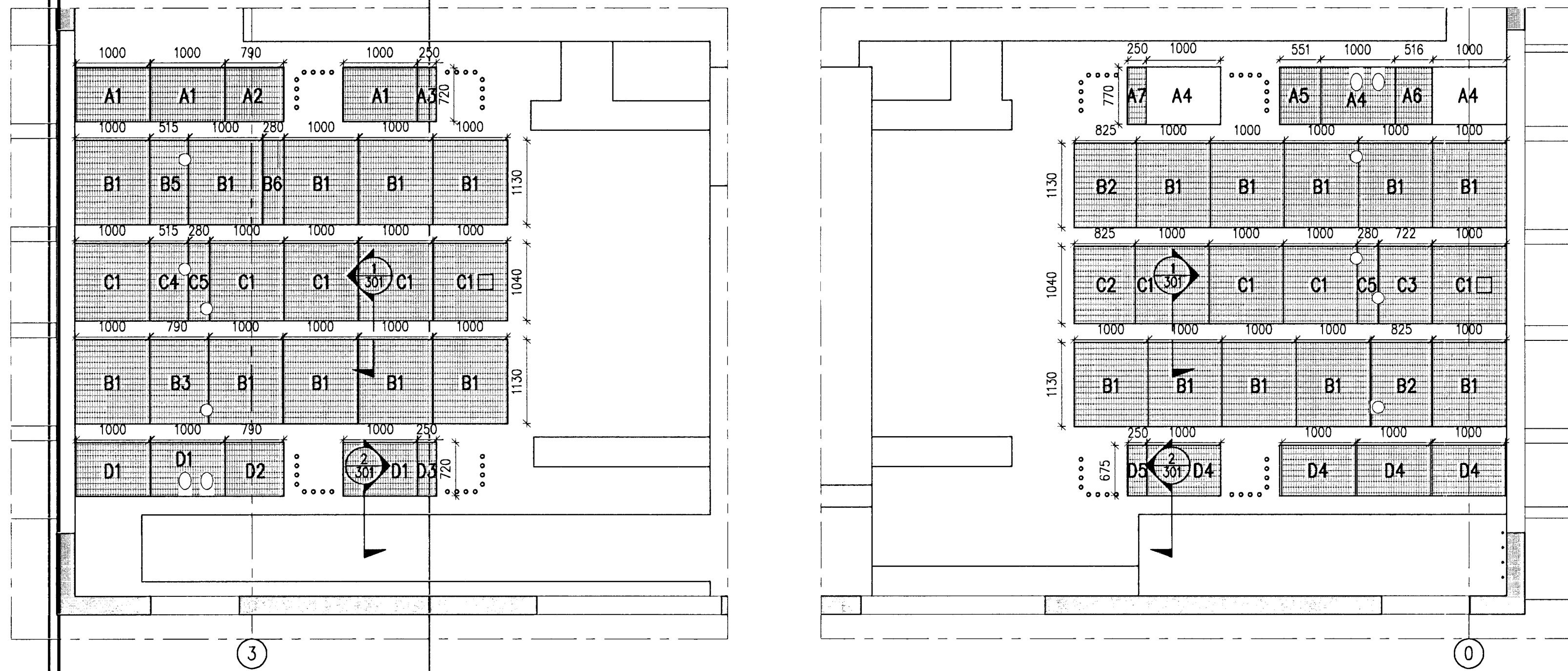

GRATING SIZES

Nr.	Length	Width	Pcs.	Note
A1	720	1000	5	
A2	720	790	2	
A3	720	250	1	
A4	770	1000	5	1 pcs with cutout
A5	770	551	2	
A6	770	516	2	
A7	770	250	1	
B1	1130	1000	29	10 pcs with cutout
B2	1130	825	2	1 pcs with cutout
B3	1130	790	2	2 pcs with cutout
B4	1130	722	1	2 pcs with cutout
B5	1130	515	2	2 pcs with cutout
B6	1130	280	3	
C1	1040	1000	13	4 pcs with cutout
C2	1040	825	1	
C3	1040	722	2	2 pcs with cutout
C4	1040	515	2	2 pcs with cutout
C5	1040	280	4	4 pcs with cutout
D1	720	1000	5	2 pcs with cutout
D2	720	790	2	
D3	720	250	1	
D4	675	1000	7	
D5	675	250	1	

WELAND GRATING H6 40/3 AND COVER PLATES, TOP PLAN VIEW, 1:50

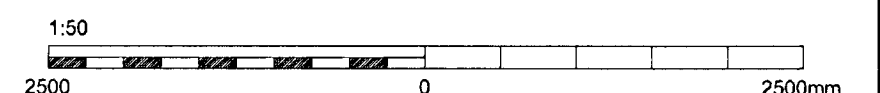
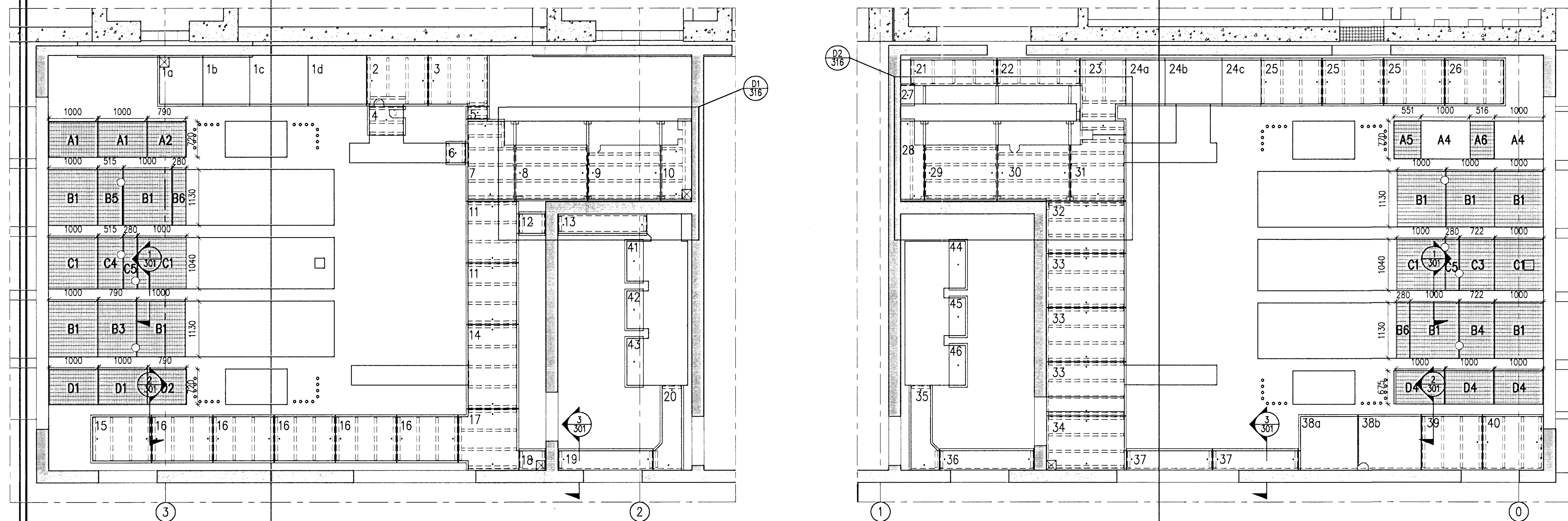

Skýringar Legend:

**GENERAL NOTES**  
Steel: S235  
Bolts: 8.8  
All grating, support angles, beams and anchorbolts to be hot dip galvanized, min 80µ.  
Grating: Weland H6 40/3 Mesh size 34x75 or similar.  
Dimensions shall be determined on site.

C:\DP\01\DP400 - Reduction\410 Substation\Drawings\Civil\DP-410-24-015-315.dwg

Ólg nr	Rev no	Lýsing	Dagsetning	Stað	Yfirl	Notk heim	Notk heim	Notk heim	Notk heim
Ólg nr	Rev no	Description	Date	Stn	Des/Drw	Yfirl	Notk heim	Notk heim	Notk heim
2		Record drawing	2012.09.12	HS	NI	BA	RS		

This drawing is the property of Rio Tinto Alcan Iceland Ltd. and is not to be copied or made available to others without permission of Rio Tinto Alcan Iceland Ltd. The receiver is liable for any misuse.

Scale: 1:50  
Dimensions without tolerances according to ISO 2768-1 medium.

HRV HATCH  
REAL PRODUCTION UPGRADE

Dagsetning / Date: 2011.09.14  
Hannað / Designed: HS  
Tökn / Drawn: LDB  
Verkfari / Supplier: HRV  
Tökn nr. verkfara / Supplier drw no: IDP-410-ZA-015-315  
Sambýkt / Approved: NI  
Hljúft af / Part of:

IPU410-RECTIFIER BUILDINGS  
B5/S2  
GRATING AND COVER PLATES, PLAN VIEWS  
STRUTURAL STEEL

Flakkur nr.: Blað nr.: Nasta blinnr.:  
Kostn.nr.-Egno. / BSN.nr.-Egno: 4011 13982  
AKS UB12  
251365 A

**RioTintoAlcan**  
ISAL Yfirráð og skráð, dags / ISAL Checked, date  
ISAL Sambýkt, dags / ISAL Approved, date