

**A SECTION**  
324

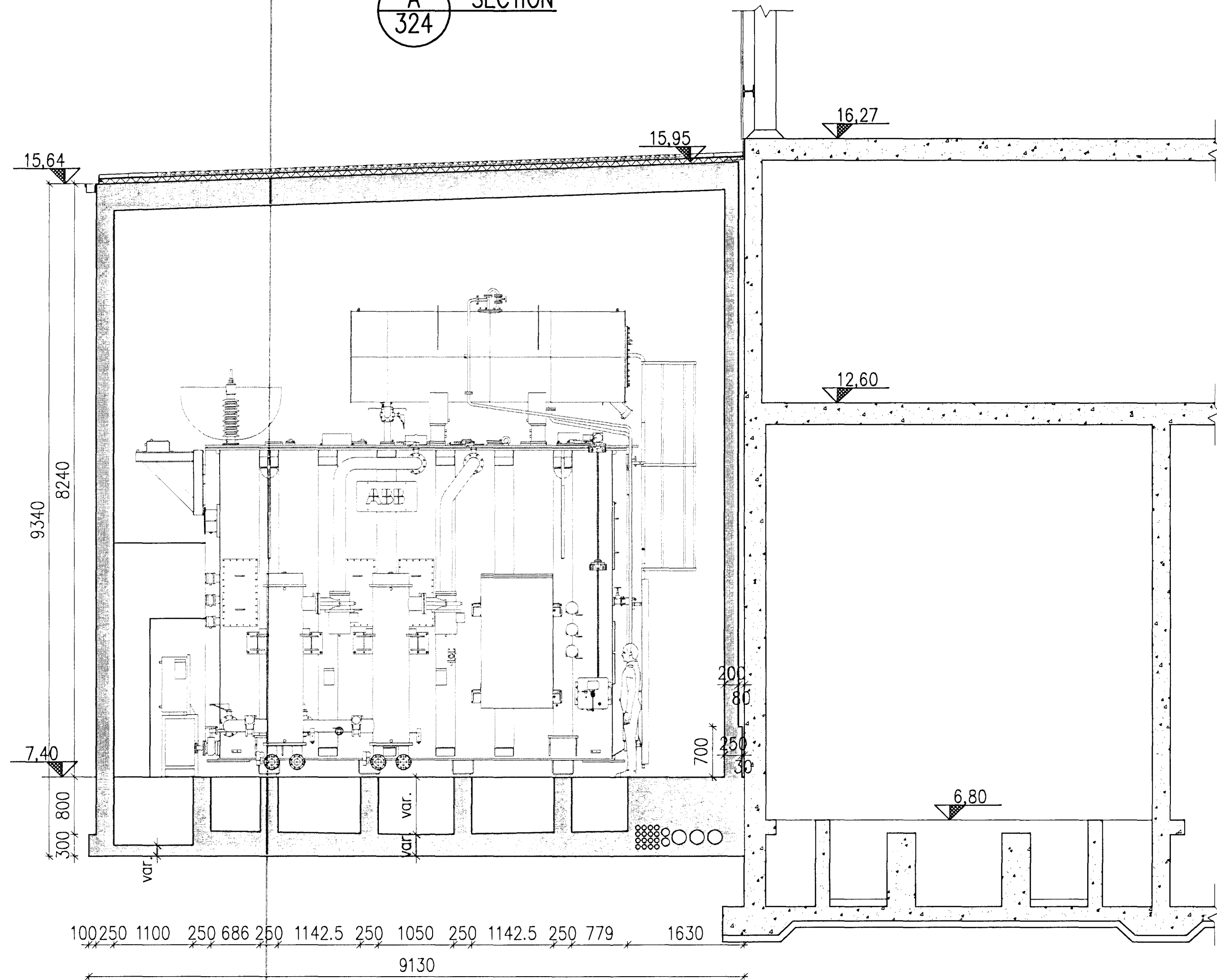

**B SECTION**  
324

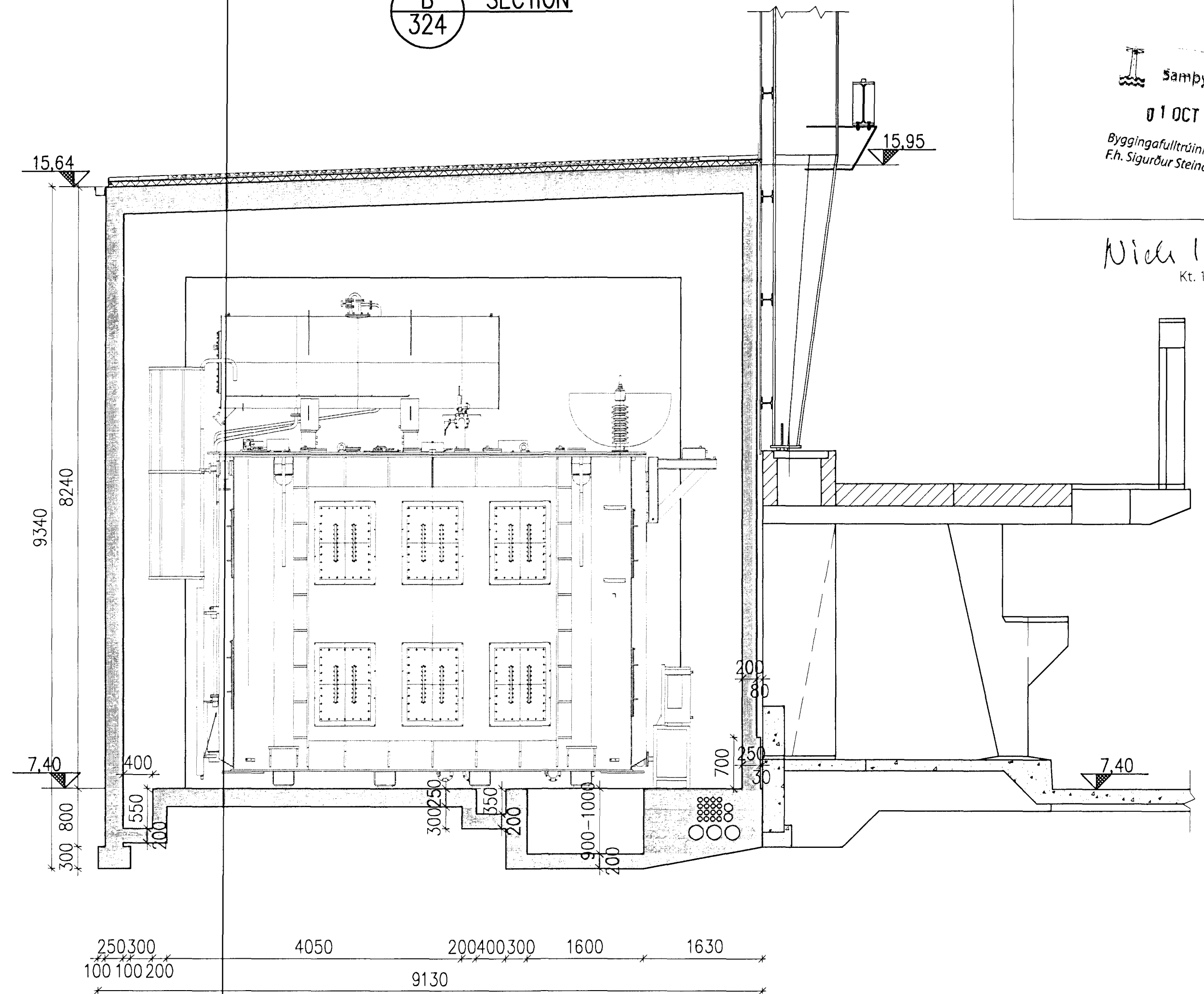

**E SECTION, 1:20**  
324

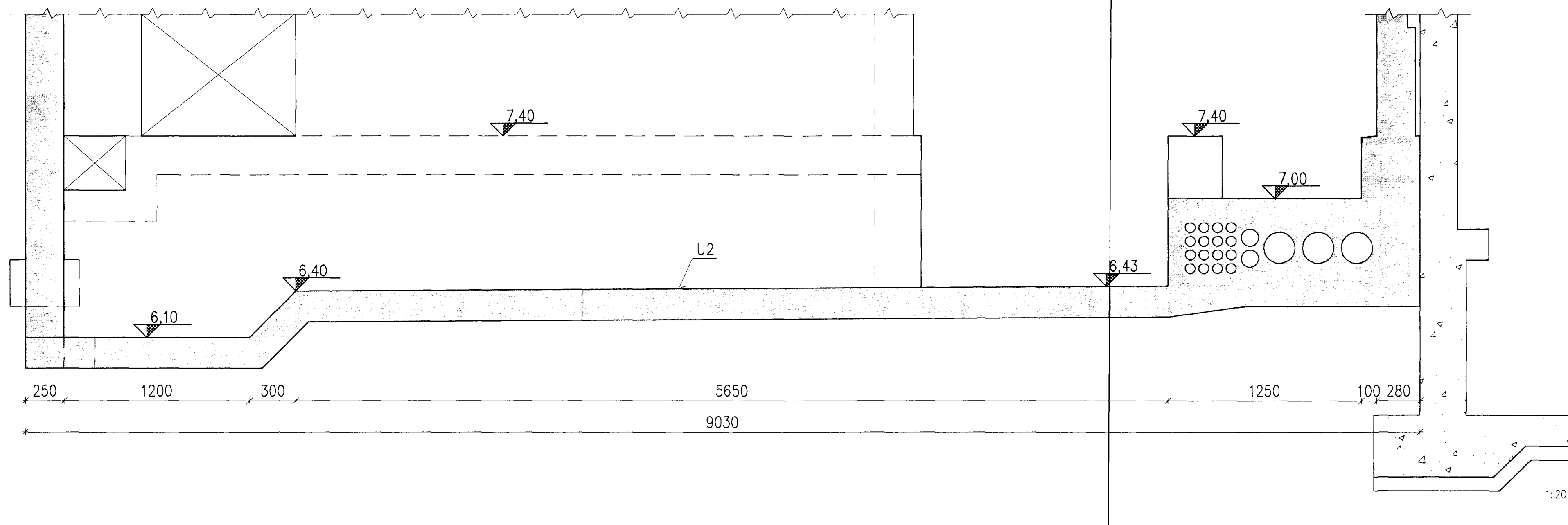

Samþykkt þann  
01 OCT 2012  
Byggingafræðingur í Hafnarfirði  
Fh. Sigurður Steinar Jónsson

Nick Indriðsson  
Kt. 181144-3949 NI

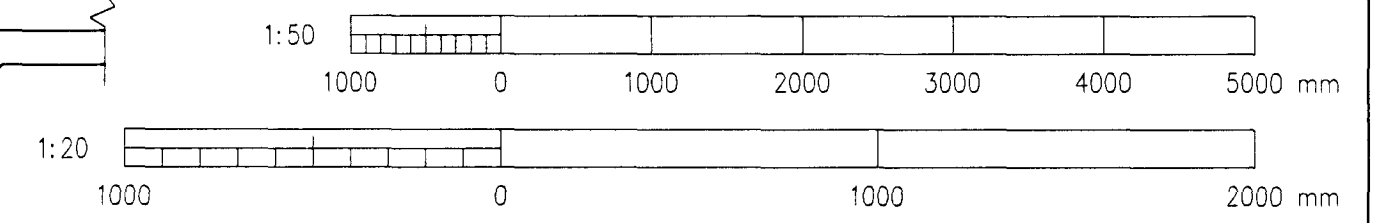

Skýringar:  
Legend:

Ólg. nr. Rev. no.	Lýsing Description	Dagsetning Date	Höf./Tö. Des./Drw.	Yfir Ckd.	Notk. heim Suppl. Rel.	Notk. heim ISAL Rel.
3	Record drawing	2012.09.12	HS	NI	BS	MS

This drawing is the property of Rio Tinto Alcan Iceland Ltd. and handed out for personal use only. It may neither be copied nor made available to others without permission of Rio Tinto Alcan Iceland Ltd. The receiver is liable for any misuse.  
Stærð: A1 Mkv.: 1:20/1:50  
Formát: A1 Mkv.: 1:20/1:50  
Dimensions without tolerances according to ISO 2768-1 medium.

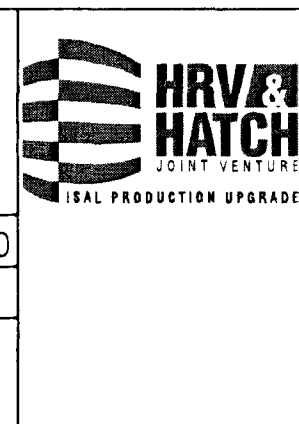

Dagsetning / Date: 2011.03.07  
Hannað / Designed: LDB  
Tækn. / Drawn: LDB  
Verktaki / Supplier: HRV  
Tækn.nr.verktaka / Supplier draw.no: IDP-410-CA-015-327  
Sinnbúikt / Approved: NI  
Yfir / Chkd: NI  
Hluti af: / Part of:

IPU410-RECTIFIER BUILDINGS  
B5/S2  
SECTIONS A, B AND E  
FORM WORK  
Flokkur nr.: Blað nr.: Nasta bl.nr.:  
4011 13982  
Kostn.nr.-Ceno. / Bón.nr.-Eq.no.  
AKS UB12  
Breyt./Rev.  
**RioTinto Alcan**  
ISAL  
Akan Iceland Ltd  
Stráumvirk  
IS-222 Hafnarfjörður  
Iceland  
Tækn.nr. ISAL / Draw.no. of ISAL: 251281  
ISAL Yfirleitt og skráð, dags / ISAL Checked, date  
ISAL Samþykkt, dags / ISAL Approval, date