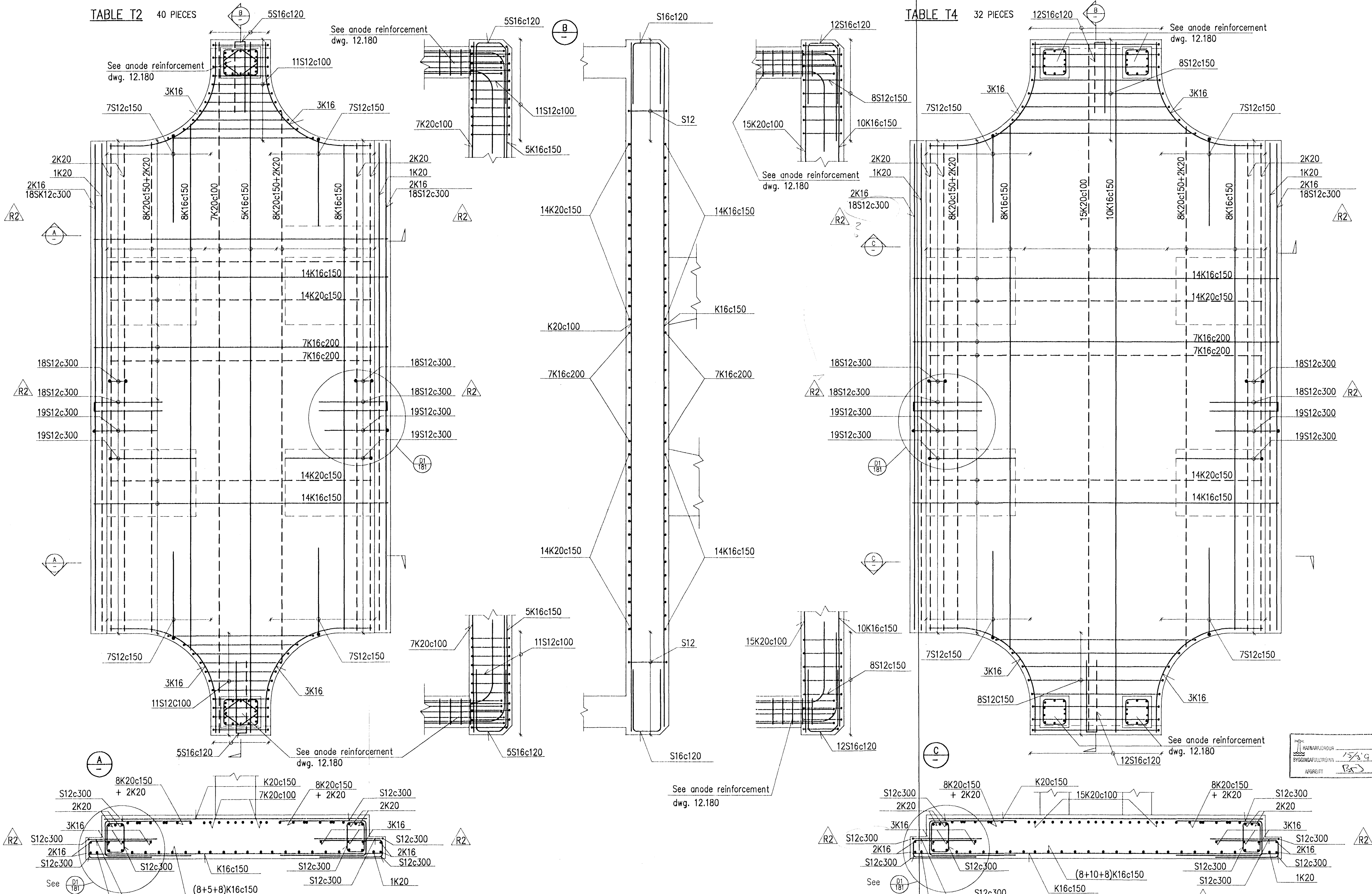

TABLE T2 40 PIECES

TABLE T4 32 PIECES



HANARAFJÖRÐUR
SVINGINGAFULLTRÚNN
AFGREITT
15/96
RS

VST CONSULTING ENGINEERS Ltd. Armúla 4 108 Reykjavík Ísland Tel: +354 569 5000 Fax: +354 569 5010		95.120 - 12.173
DRAWN 95.10.28 FGS APPROVED 95.10.28 KGS PROCESS 95.10.28 NI PROJECT 95.10.28 NI SCALE 1:20 FSRBAT A1	POTROOM NO. 3 CONCRETE WORK TABLE T2 & T4 REINFORCEMENT	
ALUSUISSE ALESA ALUSUISSE ENGINEERING LTD. ZÜRICH SWITZERLAND	79000-32373	2
ICELANDIC ALUMINIUM CO. LTD	186.673	

REV. NO.	DATE	REVISION	BY	APP.	REV. NO.	DATE	REVISION	BY	APP.	NOTES	REFERENCE DRAWING	DRAWING NUMBER
2	1996.03.15	REINFORCEMNET IN CORBEL	KGS	N.I.								
1	1996.01.02	APPROVED FOR CONSTRUCTION	FGS	N.I.								

This drawing is our property and given for personal use only. It may not be copied or made available to others without our permission. The receiver is responsible for any misuse.