

Samþykkt á fundi bygginga-
 nefndar þ. 23/6 '88 6.7.1989
 BYGGINGAFULLTRÚINN
 Í HAFNARFIRDI

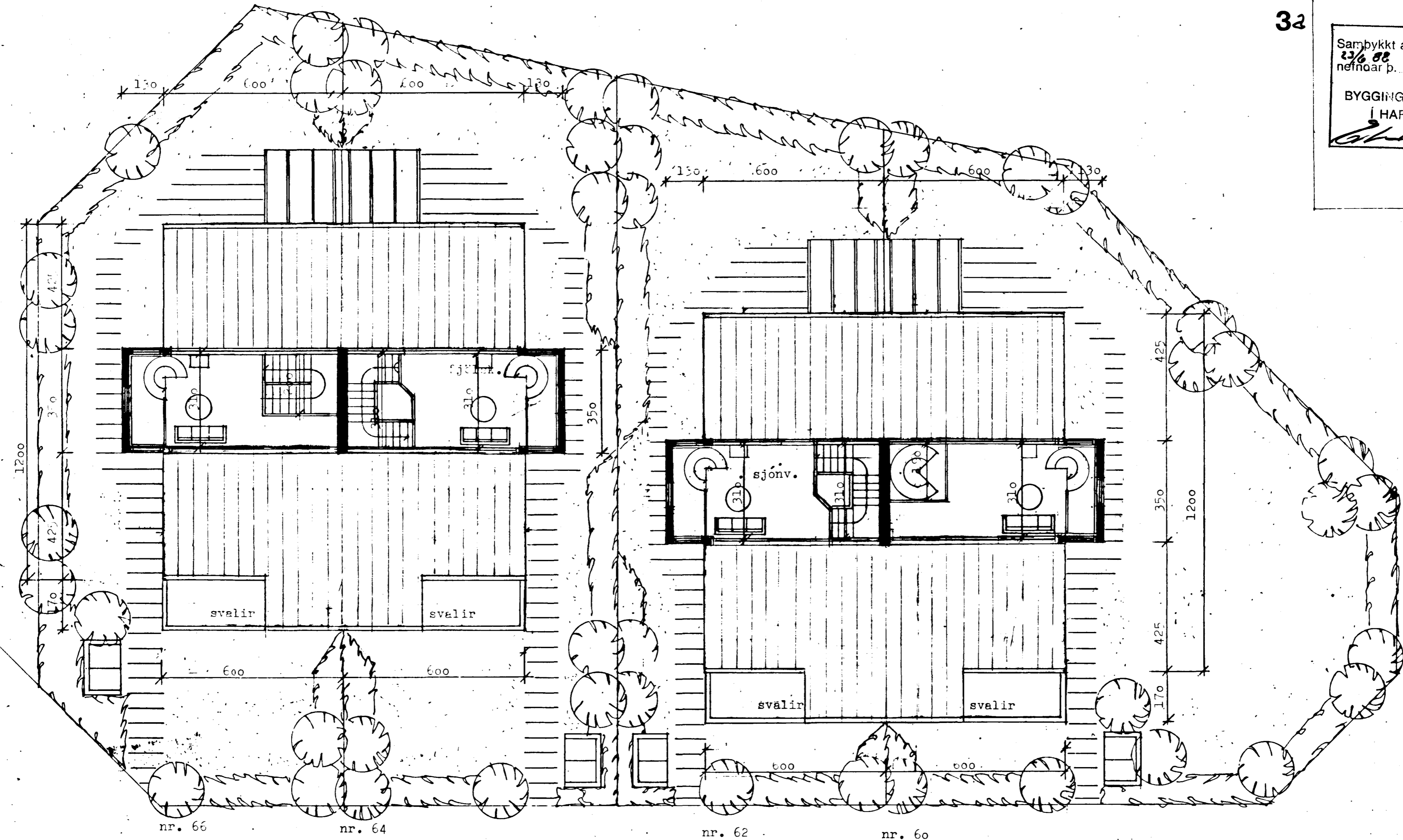

nr. 66

nr. 64

nr. 62

nr. 60

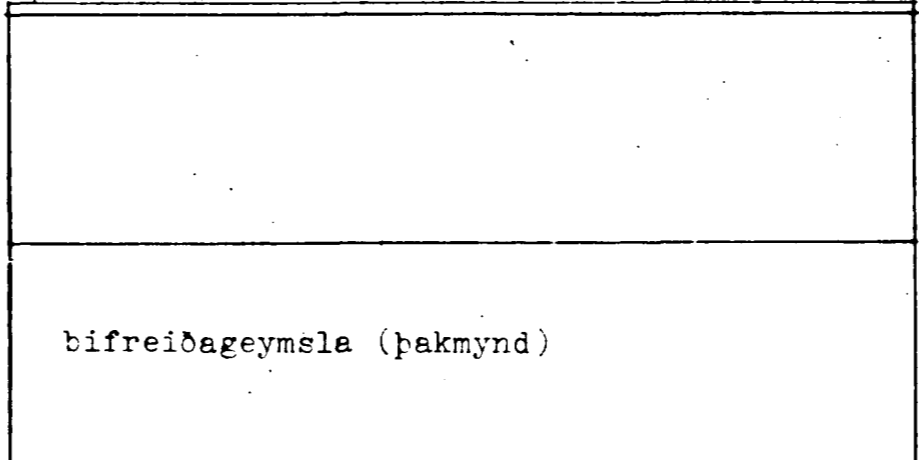
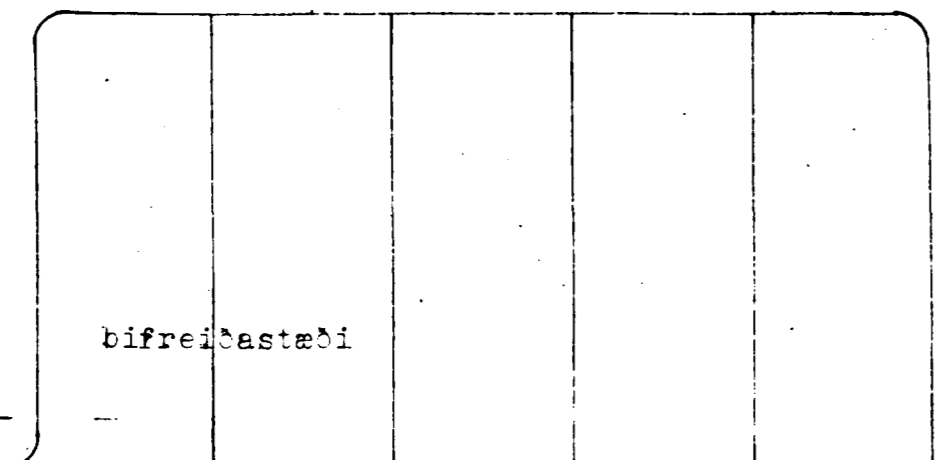

STUBBERG 66, 64, 62, 60, HAFNARFIRDI, lóðarmynd og grunnmynd 3 hæðar
 m. 1:100

Björn H. Jóhannesson arkitekt F.A.Í.
 Kjálsgötu 104 Rvík s. 10080
 maí '88 þr. 21.6.'88 þr. 3.7.'89
Björn H. Jóhannesson