

VEGGUR V1 1:50
SUDURHLID

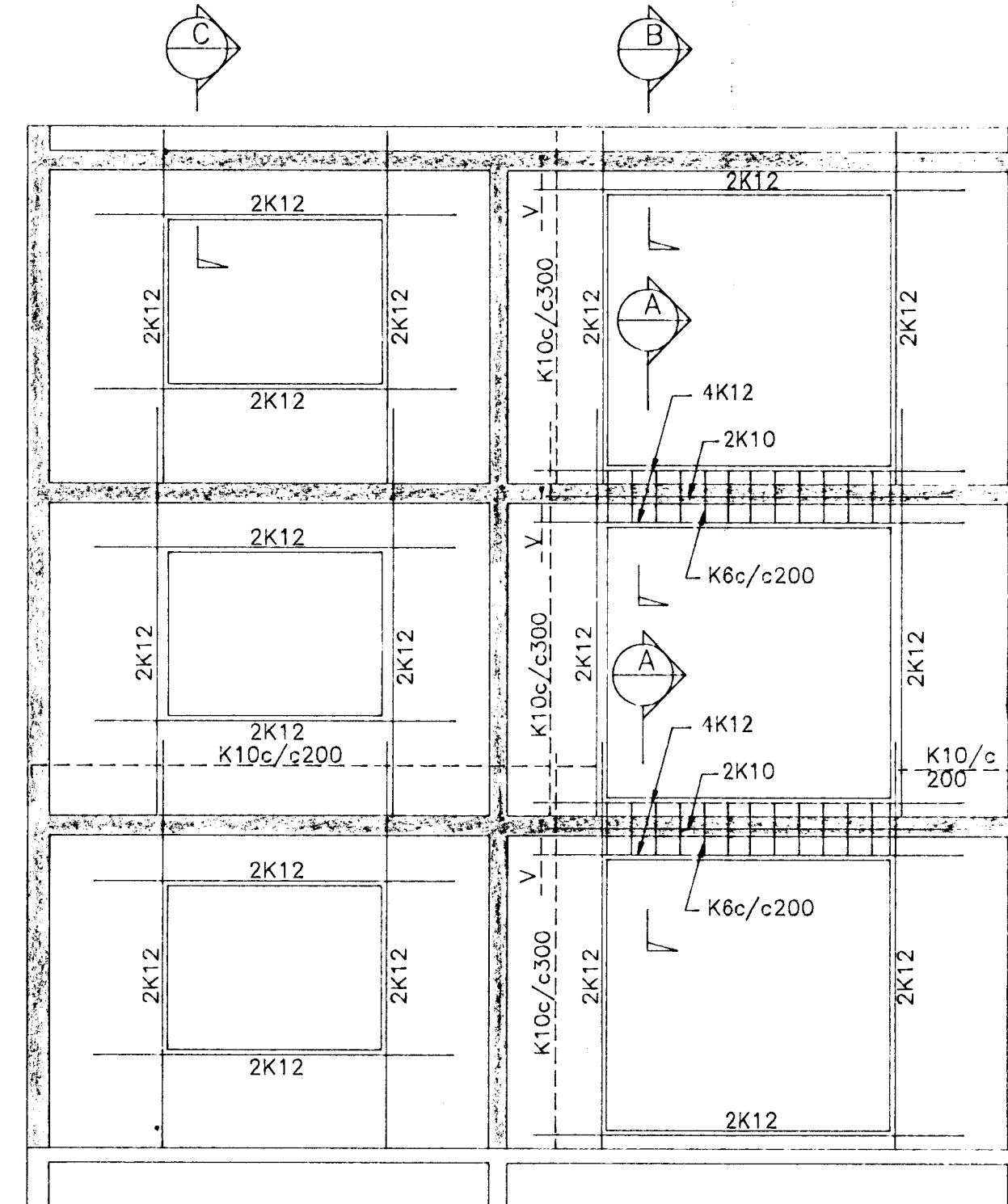

VEGGUR V2 1:50
VESTURGAFL

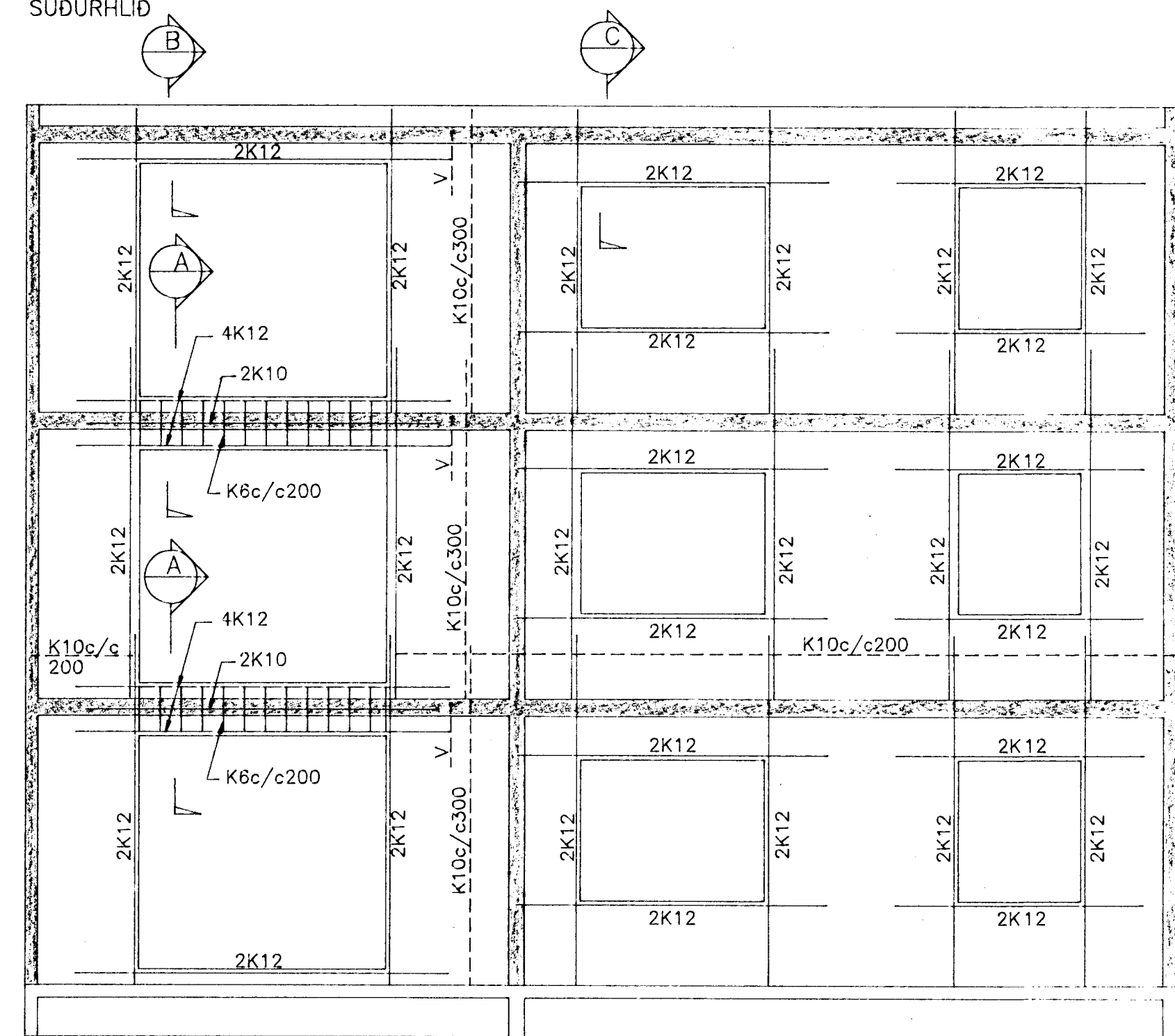
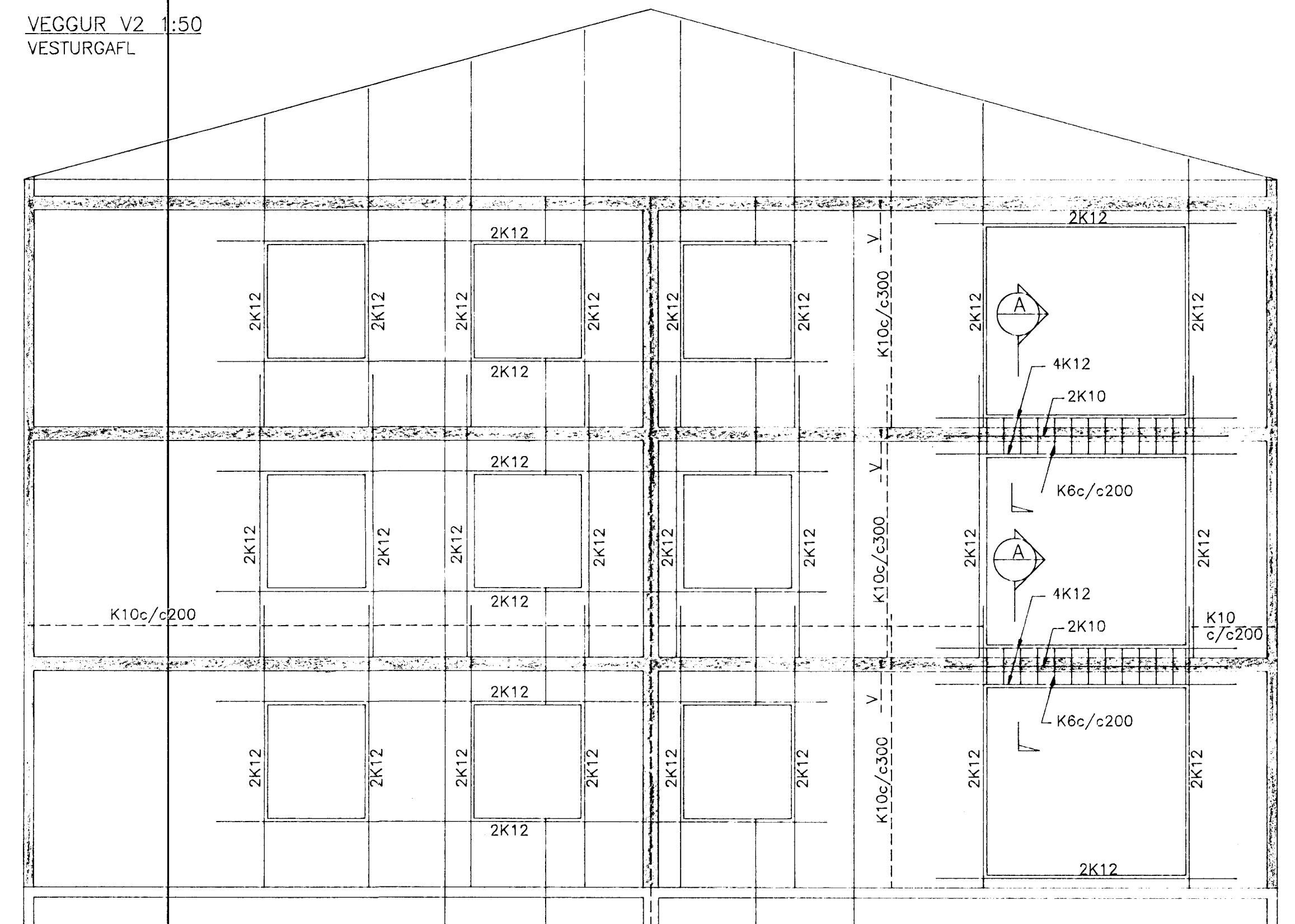

VEGGUR V3 1:50
NORDURHLID

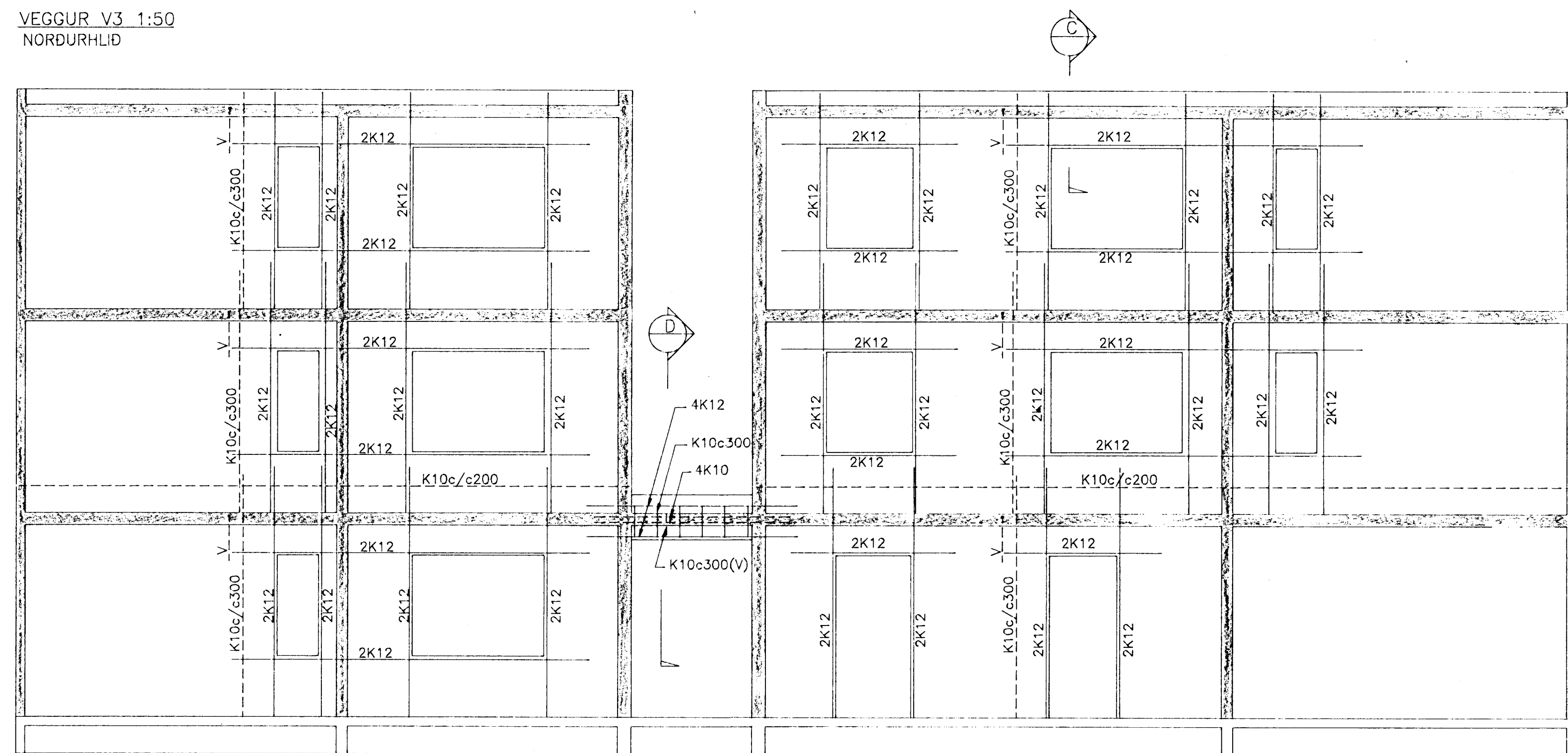

VEGGUR V4 1:50
AUSTURHLID

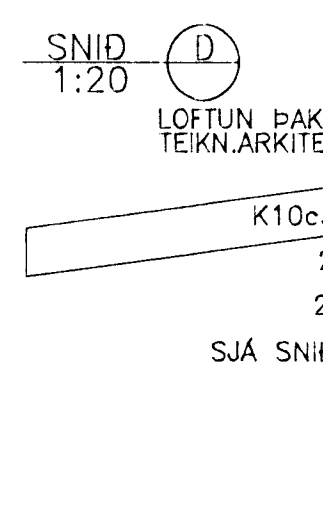
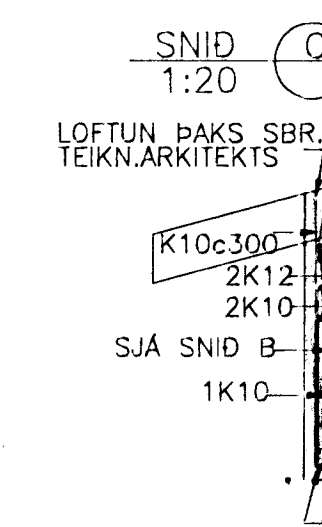
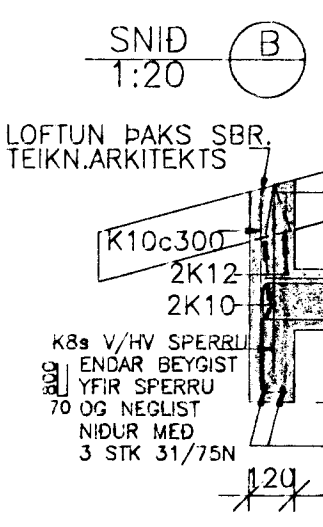
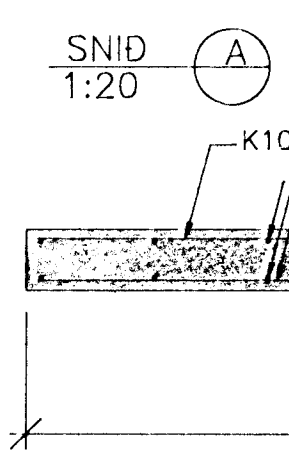
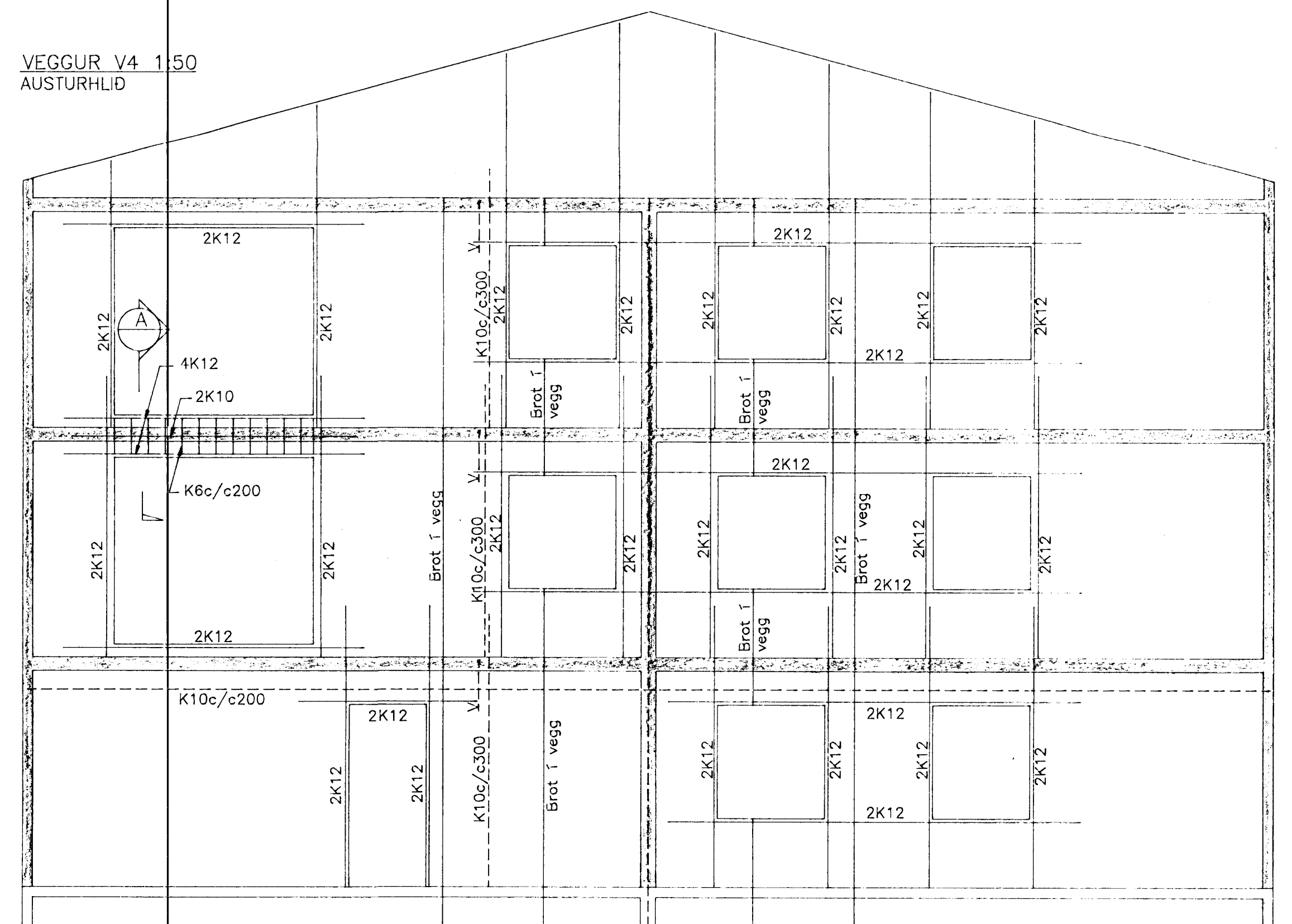

BENDING I VEGGI

ÚTVEGGIR: SBR, TEIKN. AF VEGGJUM V1,V2,V3 OG V4 HÉR AD OFAN. VEGGI AD STIGAHÚSI, SEM ERU ÚTVEGGIR AD HLUTA, SKAL BENDA SAMSVARANDI Þ.E. K10 c/c 200 LÁRETT OG K10 c/c 300 LÖDRÉTT, AUK ÞESS 2K12 UMHVERFIS OP ER NAÍ SKEYTILENGD ÚT FYRIR OPIN. Í ÚTVEGGJUM SKAL STAÐSETJA BEND.NET Í ÚTBRUN ÞANNIG AD STEYPUHULA SE 30 mm.

INNVEGGIR: ALLA INNVEGGI SKAL BENDA MED EINFÖLDU NETI K10c/c300 LÁRETT OG LÖDRÉTT. UMHVERFIS OP KOMI AUK ÞESS 2K12 ER NAÍ SKEYTILENGD ÚT FYRIR OPIN.

TILVÍSUN

ALMENNAR SKÝRINGAR. SJÁ BL.NR. 9437-800



SUDURBRAUT 2A, HAFNARFIRDI		ÚTVEGGIR HLIDARMYNDIR OG SNID	
VERKFRÆÐISTOFA STEFÁNS & BJÖRNS			
BEJARHVALANI 20 • 220 HAFNARFJÖRDUR SÍMI 91-651340 • FAX 91651341 KT: 610188-1419			
Hannað: BG	Teiknað: BG	Yfirforið:	
Mök: 1:50,1:20	Samþykkt: <i>Björn Björnsson</i>		
Dagss: 12.04.95	Nr: 9437-802-A		