

HLIDAR/YFIRSTYKKI (GLUGGA)

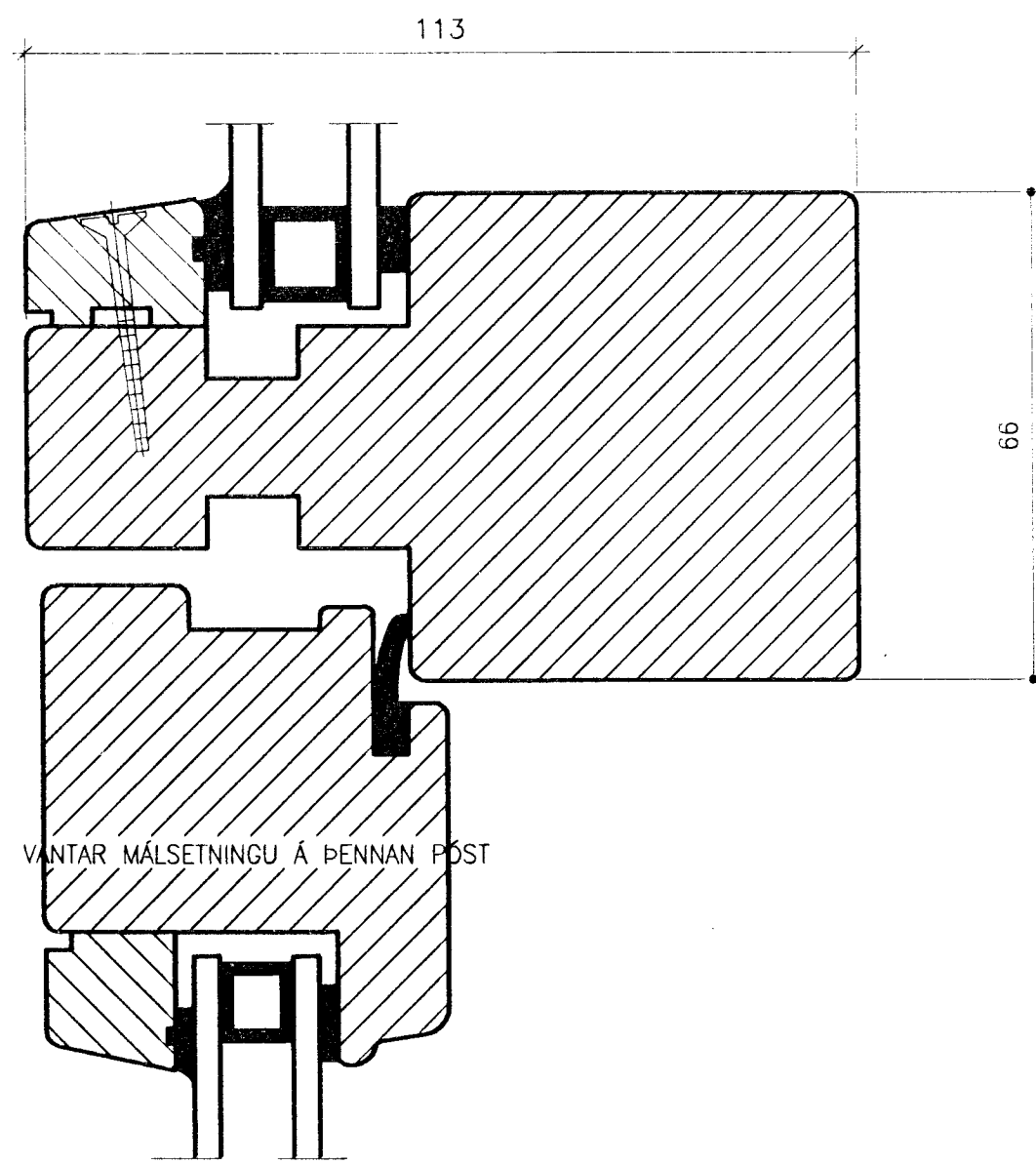

MILLIPÓSTUR LÓÐRÉTTUR (OPN. FAG)

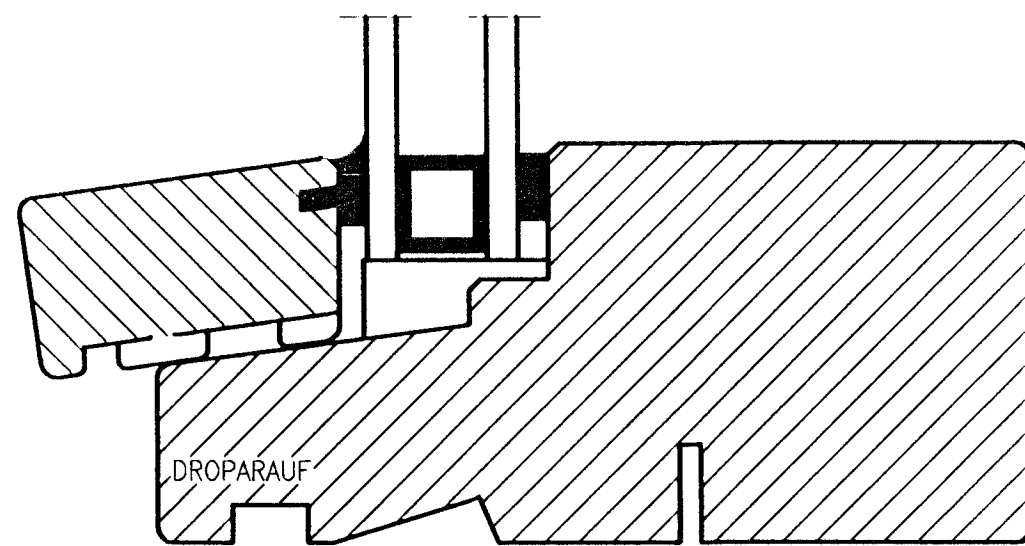

UNDIRSTYKKI (GLUGGA)

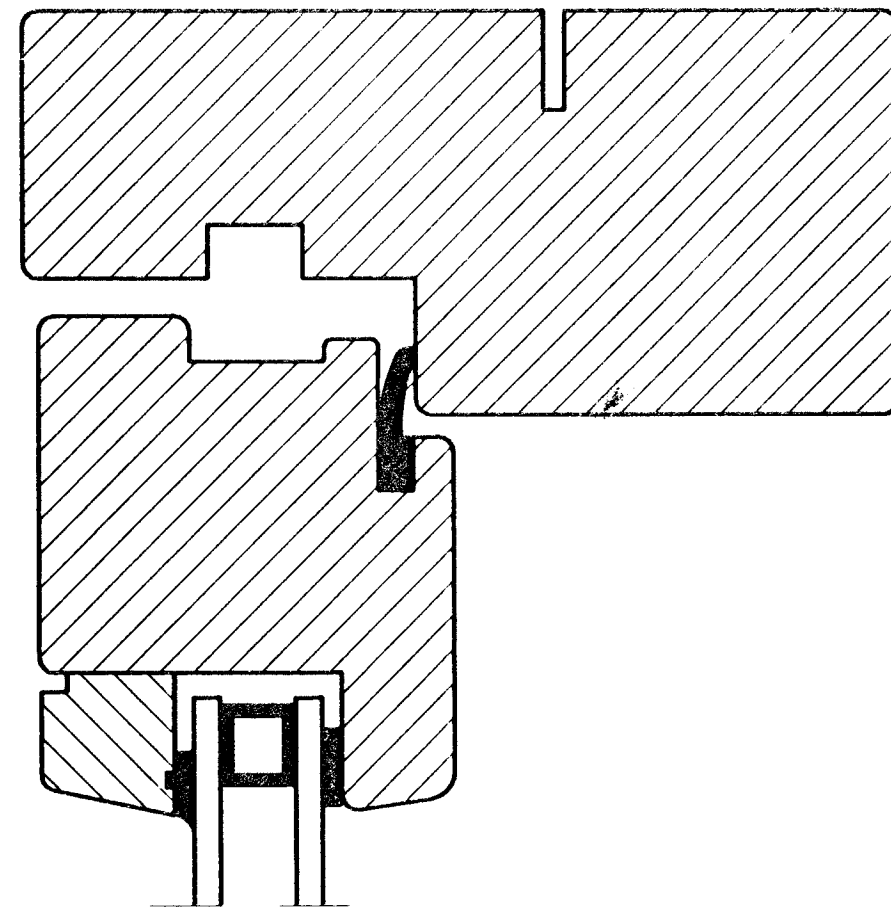

HLIDARSTYKKI YFIRST. (OPN. FAG GLUGGA)

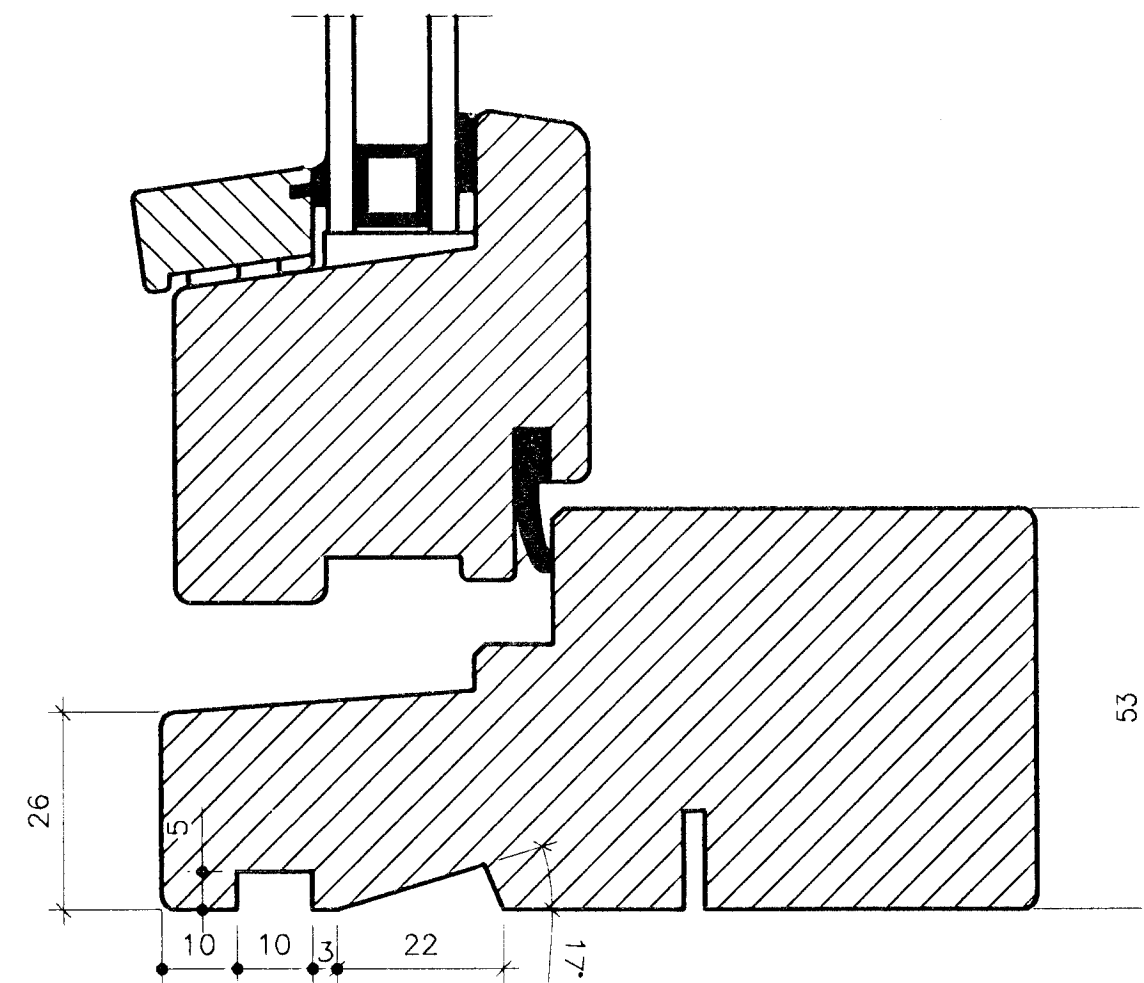

UNDIRSTYKKI (OPN. FAG GLUGGA)

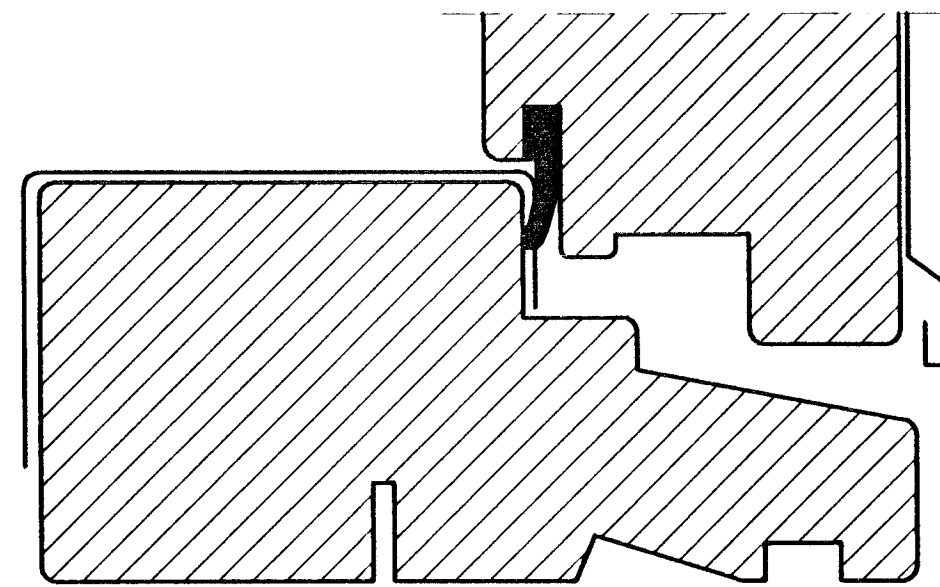

UNDIRSTYKKI (HURÐ ÚT)

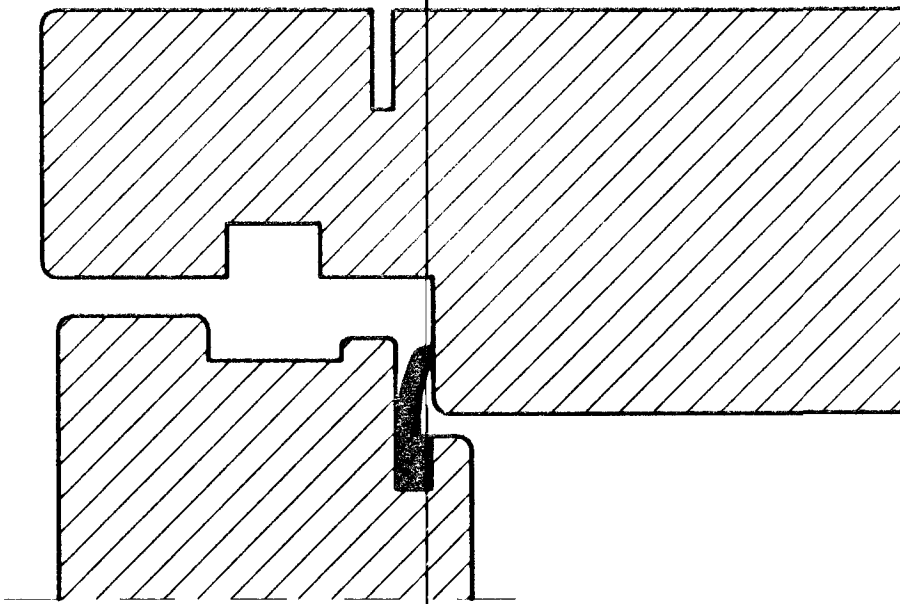

YFIR/HLIDARSTYKKI (HURÐ INN)

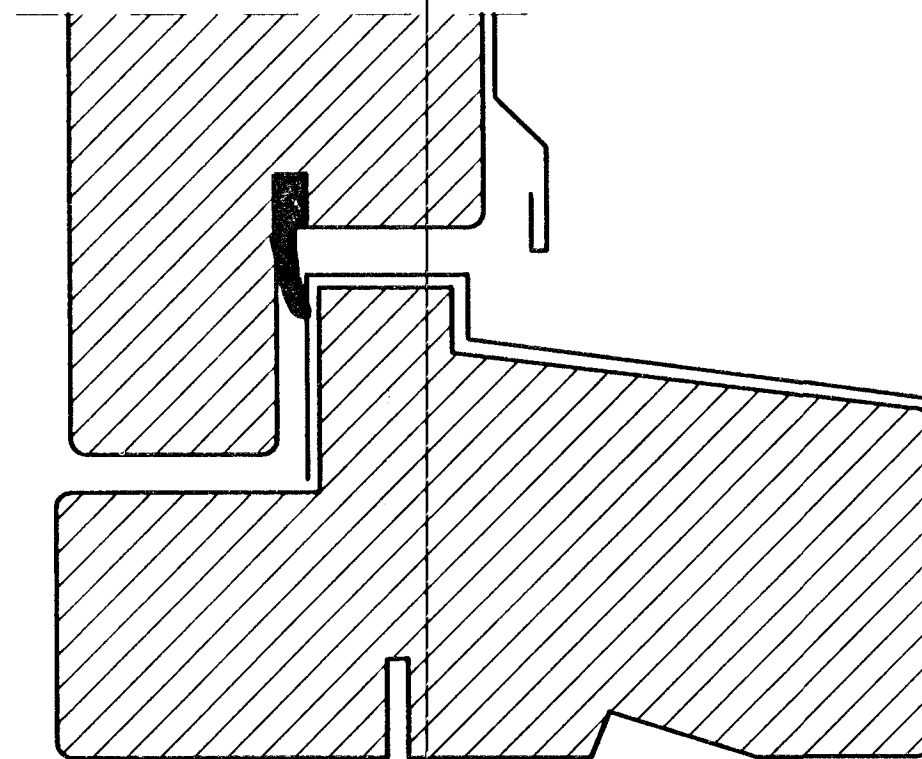

UNDIRSTYKKI (HURÐ INN)

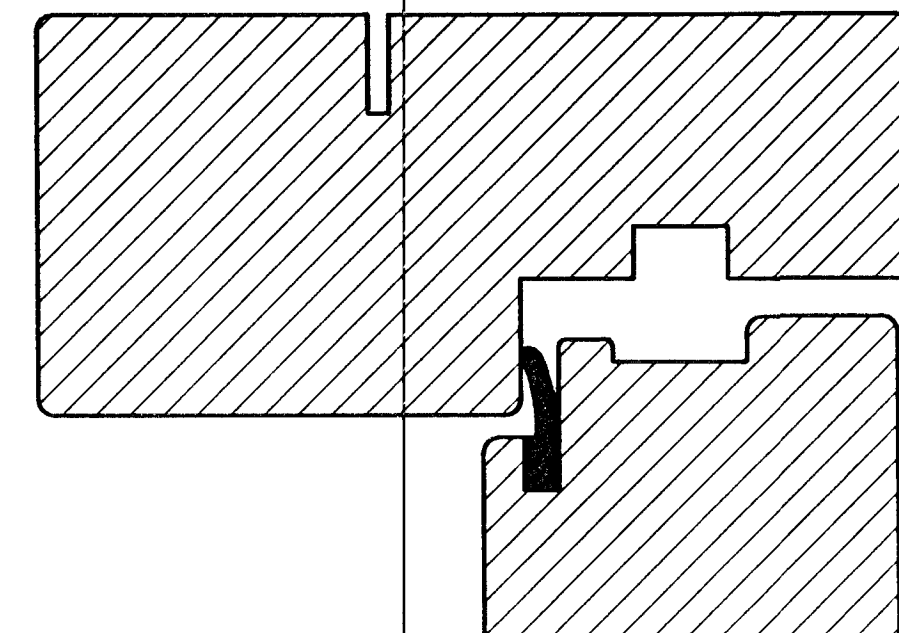

YFIR/HLIDARSTYKKI (HURÐ ÚT)

SKÝRINGAR:

GLUGGAEFNI SKAL FÓAVERJA MED VIDURKENDUM EFNUM, BADAD EDA ÞRJÁR UMFERDIR MED PENSLI.

ALLT KARMA OG PÓSTAefni SKAL VERA FURA, NEMA Í ANDDYRI OG OG OPNANLEGUM FÖGUM, ORIGON PINE.

ALLT efni SKAL VERA GæDAefni SAMKVæMT ÍSLENSKUM STADLI, ÍST 41. efni SKAL TEKID ÚR 65X127mm, PÓSTAR 76X127mm.

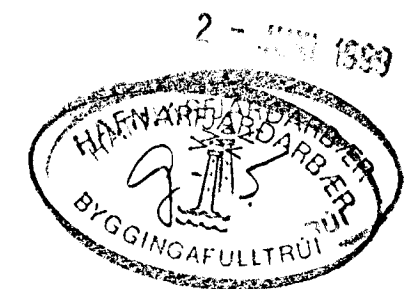

SUBURHOLT II HAFNARFIRDI.

GLUGGAR SNIDMYNDIR.

APRÍL, 1999.

20.05.1999

Jóhannes Pétursson 010448-3959 S - 567-5107

Sigurður Sigurðsson 021146-2349 S - 566-6913

ABS

teknistöfa S-566-6613, 567-5107.

Nr. 25