

GRUNNMYND 1:20

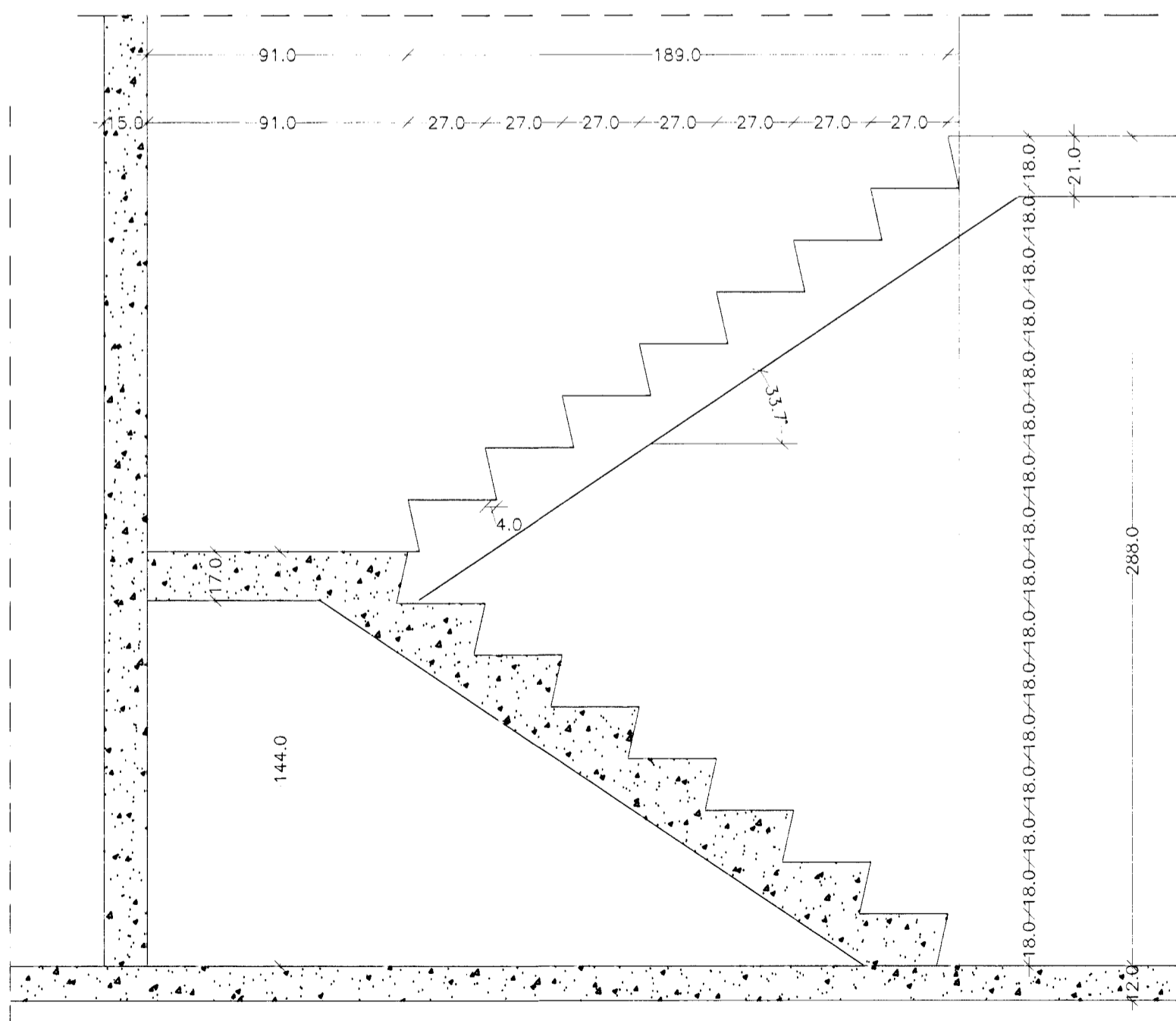

SNID A-A

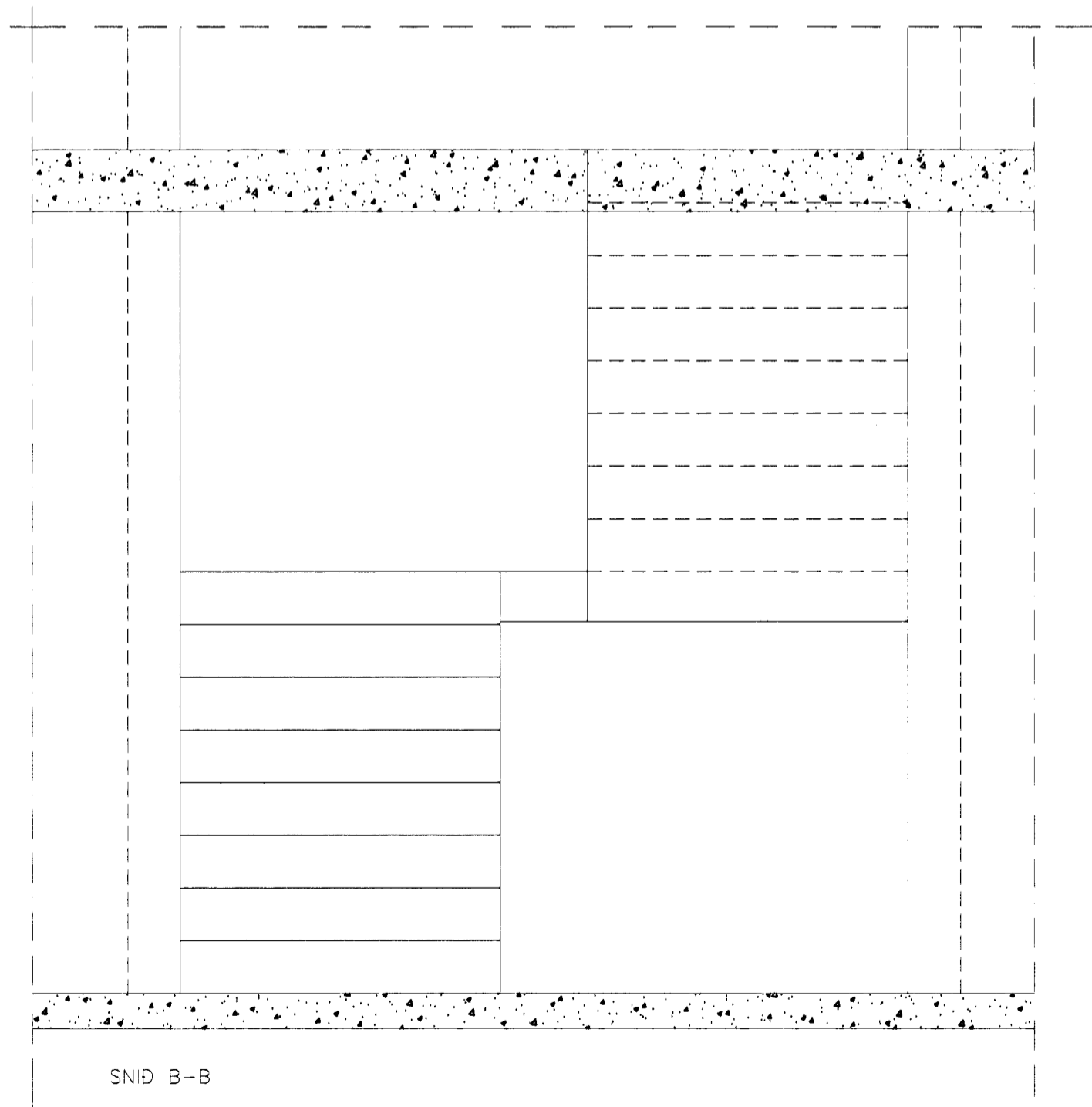

SNID B-B

STEYPTUR STIGI:

HALLI STIGA ER 33,7'
 UPPSTIG = 180 MM
 FRAMSTIG = 270 MM
 INNSKOT = 40 MM
 BREIDD = 1100 MM
 STIGAPALLUR = 910 MM

Sampykkt þann
 12 JUNI 2011
 Byggingafultrúinn Hafnarfirði
 F.h. Sigurbjartur Halldórsson

MÁL ERU Í CM

1) BREYTT		
ÞRASTARÁS 15, HAFNARFIRÐI		
VINNUTEIKNINGAR		
STEYPTUR STIGI STEYPUKUNING	KVARDI: 1:20	
DAGS.: 06-06-01	STADF. BURDARÞOL	
HANNAD: KÁ	TEIKNAD: DKK	YFIRF.: KÁ
LÁVOB EMIL LINDAL ARKITEKT FAI KT: 050957-3229 KRISTJAN ASGEIRSSON ARKITEKT FAI KT: 140955-4309		HAMRABORG 7 200 KÓPVAÐGI SMAR 554 1137 OG 554 5244 FAX: 554 4433 info@alark.com KT: 501193-2409 www.alark.com
ALARK arkitektur sf.		20