

GRUNNMYND EFRI HÆÐ
mkv. 1:50

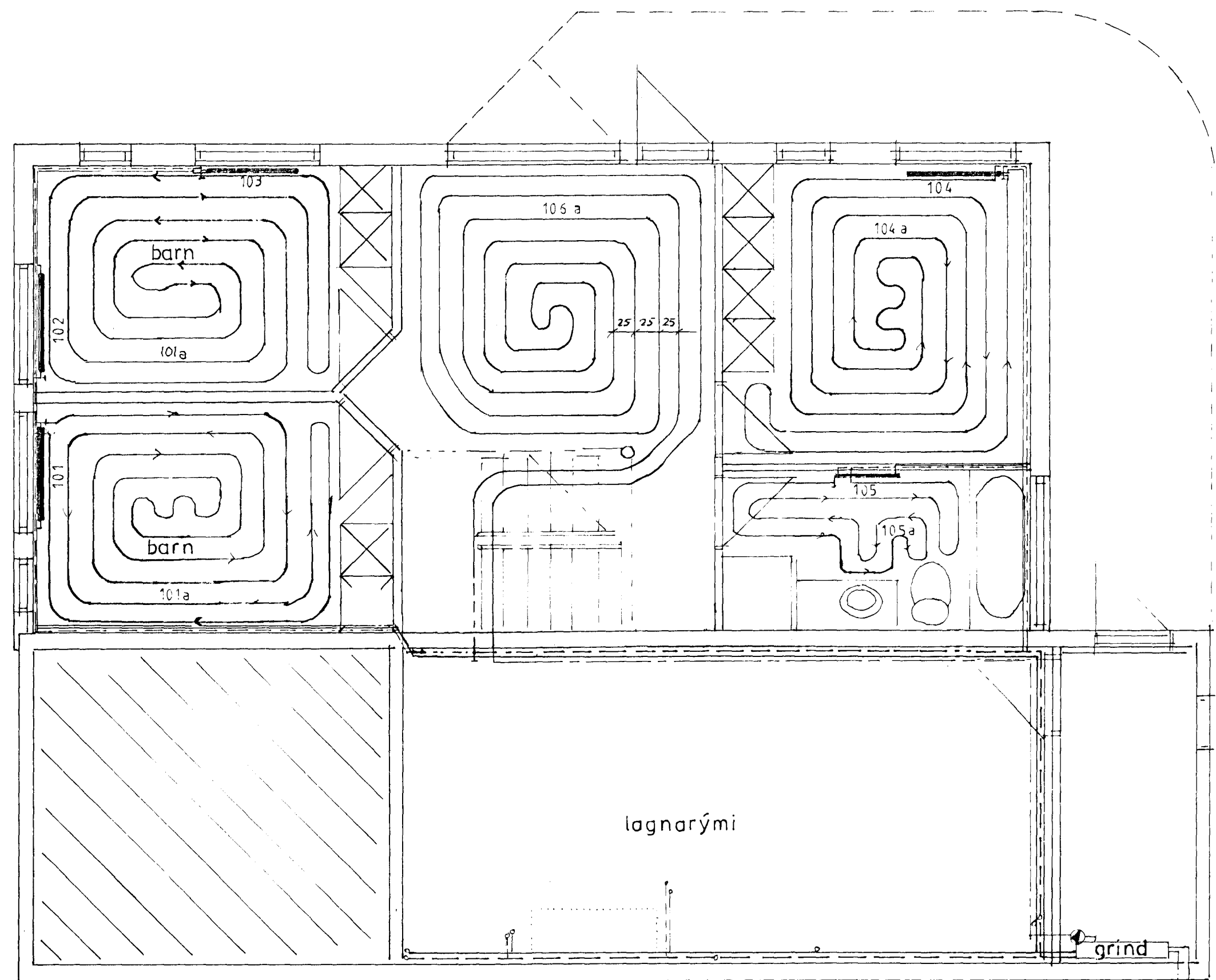

GRUNNMYND NEÐRI HÆÐ
mkv. 1:50

Tenging á gælu n.v. 96
- SÍÐBYGGINGARFRAMM. 03/01/96

| | | | |
|------|-----|----------|--------------|
| Tákn | Fj. | Breyting | Dags u. skr. |
| | | | |

AFSTÖÐUMYND
mkv. 1:500

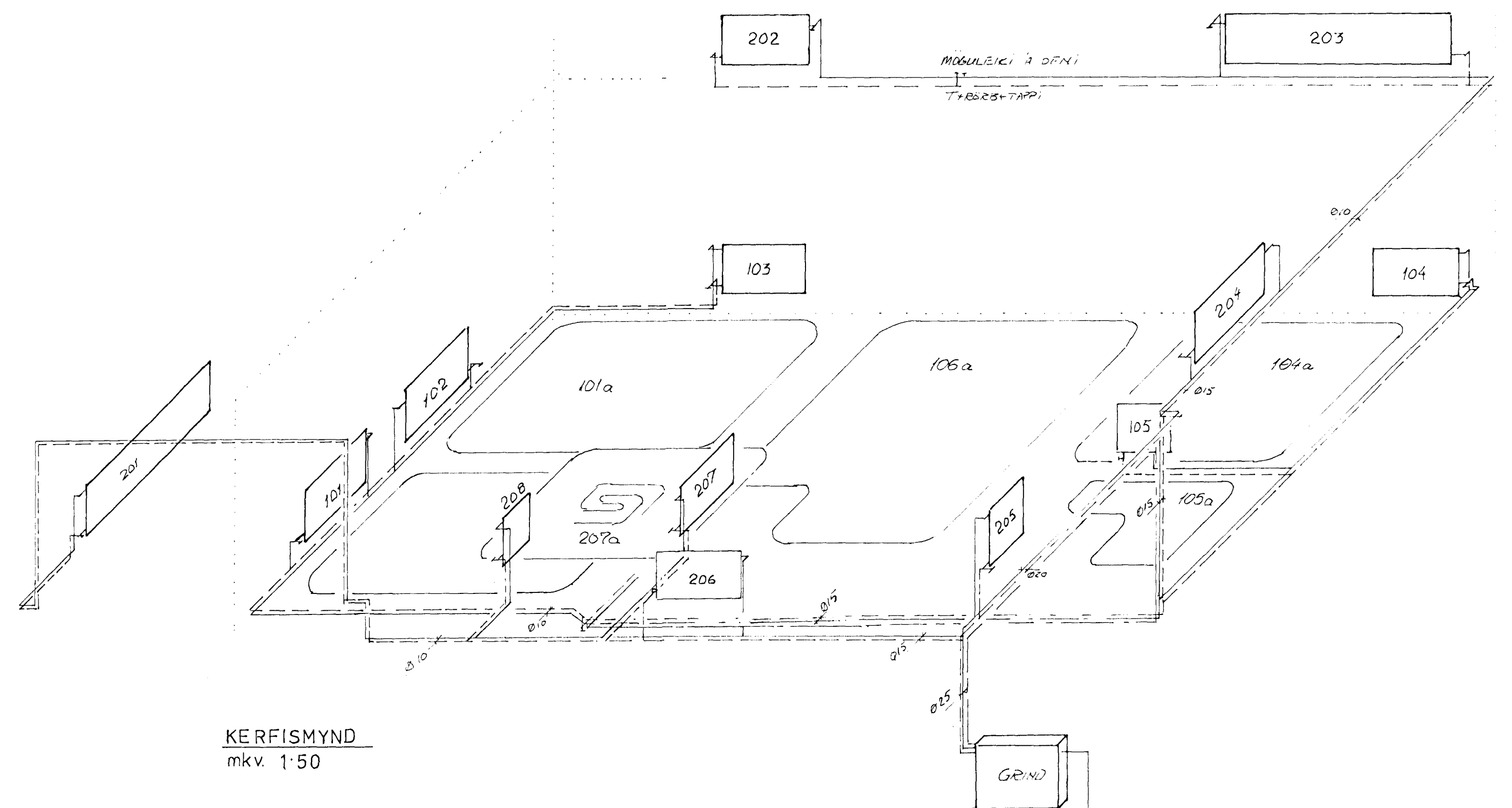
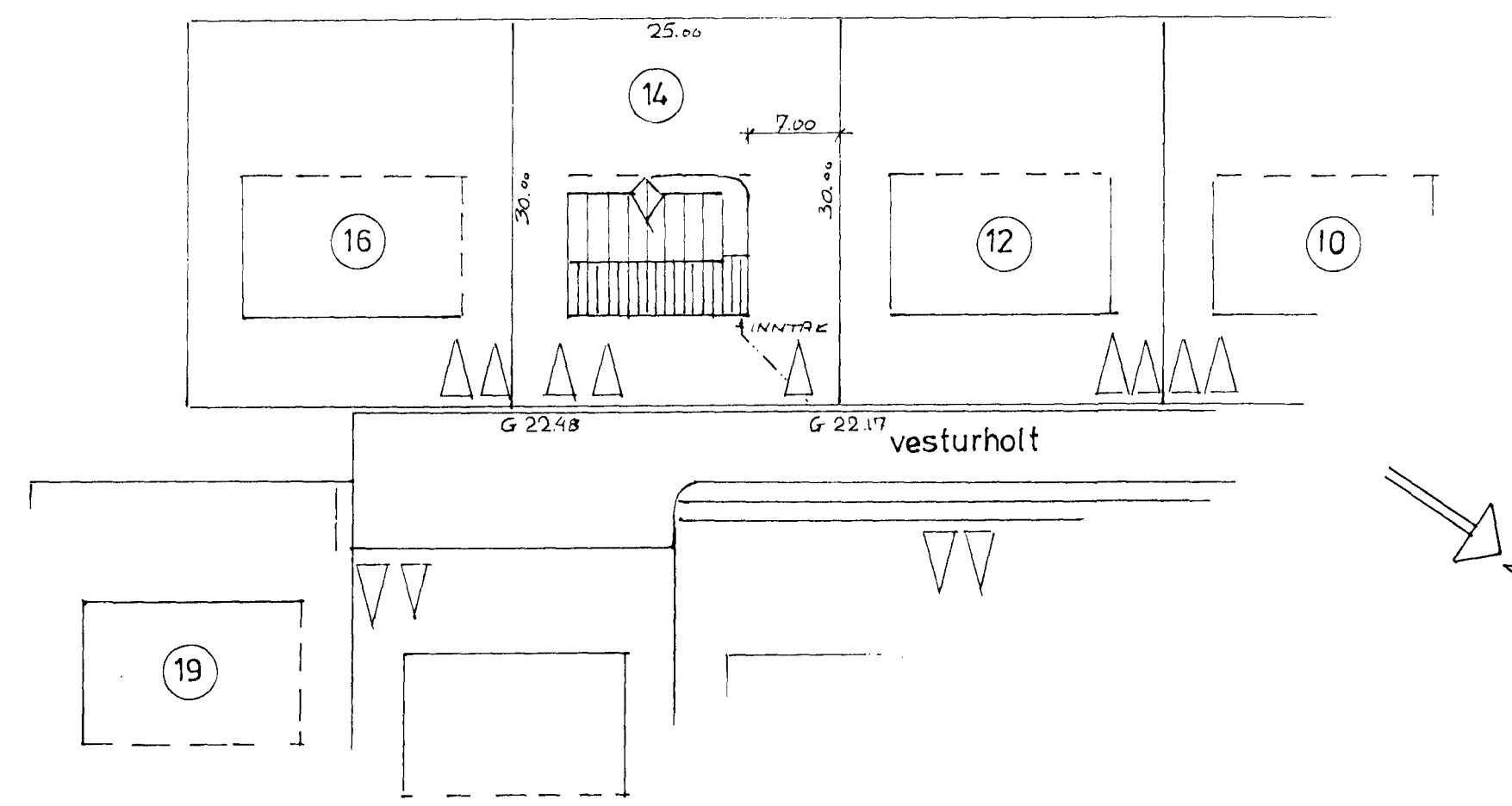

KERFISMYND
mkv. 1:50

Ofnaskrá

$\Delta t = 40^\circ\text{C}$

A B C D

| nr. | Rými | teg. | reikin hitatap wött | staða stöla | Stærðir ofna þykkt mm | hæð mm | lengd mm | afköst | Teg. |
|--------------|-----------------|------------|---------------------|--------------|-----------------------|--------|----------|--------|-------|
| 101 | Herbergi 1 | A | 1050 | AD | 59 | 600 | 1130 | 749 | Retur |
| 101 a | Herbergi 1 og 2 | Geisli | 400 | AB | 0 | 0 | 0 | 1200 | Retur |
| 102 | Herbergi 2 | I | 420 | AD | 59 | 600 | 1130 | 568 | Retur |
| 103 | Hjónaherb. | A | 420 | AB | 59 | 600 | 1130 | 568 | Retur |
| 104 | Hjónaherb. | A | 1030 | CD | 59 | 600 | 1130 | 749 | Retur |
| 104a | Hjónaherb. | Geisli | 300 | AB | 0 | 0 | 0 | 840 | Retur |
| 105 | Baðherbergi | BRT 60-120 | 570 | BD | 59 | 1200 | 600 | 525 | Retur |
| 105a | Baðherbergi | Geisli | 150 | AD | 0 | 0 | 0 | 250 | Retur |
| 106a | Sjónvarph. | Geisli | 1495 | AB | 0 | 0 | 0 | 1560 | Retur |
| 201 | Bílskúr | A | 2200 | AB | 103 | 600 | 2290 | 2292 | Retur |
| 202 | Vinnuherbergi | 2 | 866 | CB | 103 | 600 | 1130 | 909 | Túr |
| 203 | Stofa | B | 2530 | CD | 103 | 600 | 2910 | 2948 | Túr |
| 204 | Stofa | B | 1315 | CD | 59 | 600 | 1290 | 1307 | Retur |
| 205 | Þvottur | A | 380 | CD | 59 | 600 | 640 | 428 | Retur |
| 206 | Eldhús | A | 628 | AD | 59 | 600 | 1130 | 749 | Retur |
| 207 | Anddyri | C | 912 | BC | 103 | 600 | 1130 | 749 | Retur |
| 207a | Anddyri | Geisli | 150 | BC | 0 | 600 | 1130 | 420 | Retur |
| 208 | Salerni | A | 212 | AD | 103 | 600 | 480 | 321 | Retur |
| samtals wött | | | 15.028 | samtals wött | | | 16.811 | | |

Allt efni og öll vinna skal vera í samræmi við gildandi reglugerðir og staðla

Rör í geislahita skal vera úr hitspolnum PEX-plastpörum Ø15mm / Ø20mm

KERFISMYND
Tillaga að stýringu mottu 106a

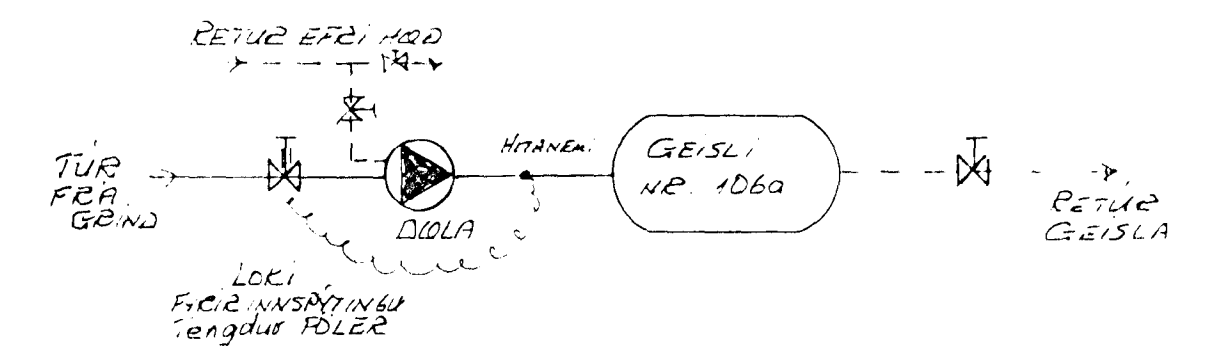

Byggingeignir Hafnarfjarðar
Afgreitt þann
26 NOV. 1996
Sigrún Pórgeyrsson

PÓRGEYR ÞÓRGEYRSSON

| | | | | | | | | |
|------------|---------------|-----------------------|-------------------------|--------|------|-----------------------------|------------|---------------------|
| Dags: | okt. 96 | Höfuð teikn. Yfirlit: | Samþ.: | Skala: | 1:50 | Byggingeignir Hafnarfjarðar | Prj.: | Þorgeir Þorgeirsson |
| Heiti: | Vesturholt 14 | Hafnarf. | Hitakerfi - GRUNNMYNDIR | Nr.: | 1080 | Prj. númer: | 105 | 112 Prj. númer: |
| Fylgiskv.: | | Útreikn.: | | | | Kennitala: | 2602607749 | Netfang: |