

Undirstöður, grunnmynd, 1:100.

Bæjarverkfæðingurinn
& Hafnarfirði

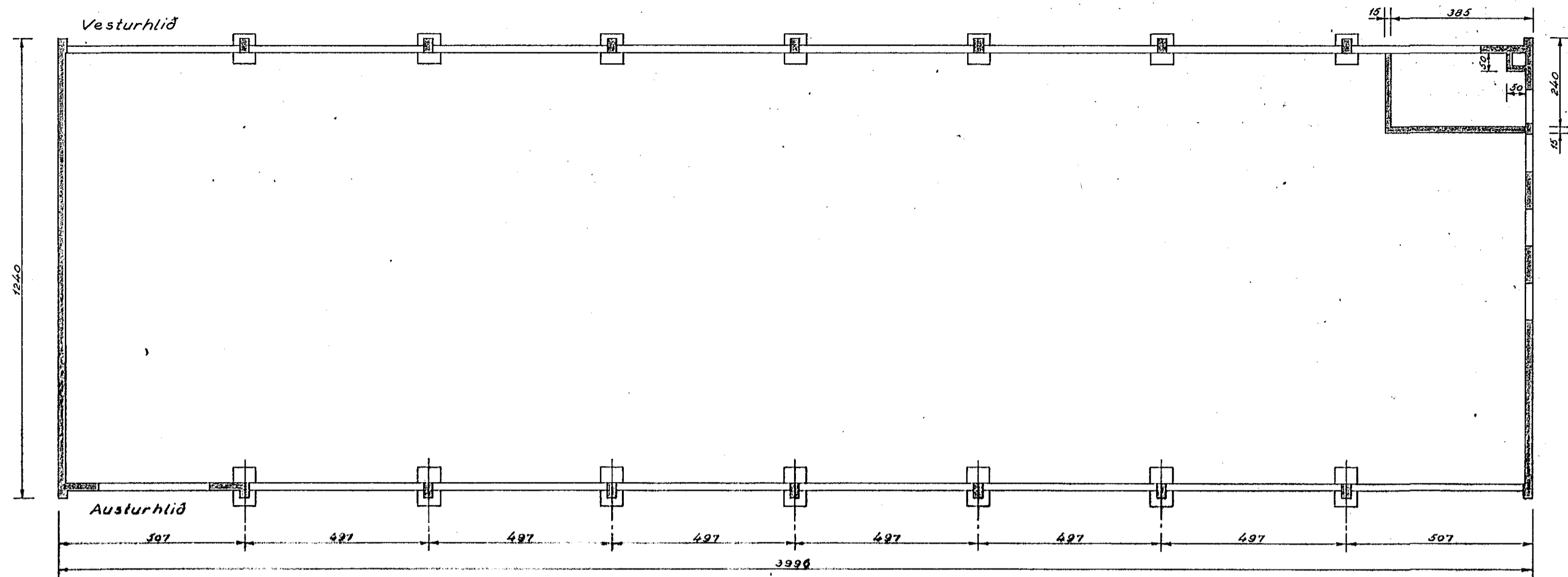

Hornundirstöður,
1:20.

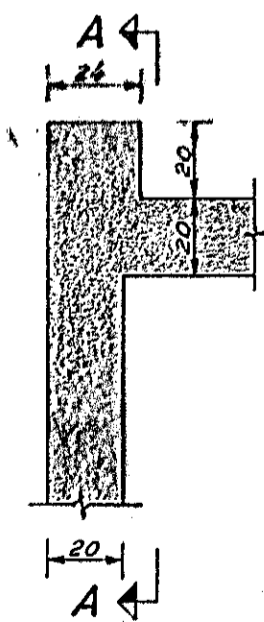

Snið A-A,
1:20.

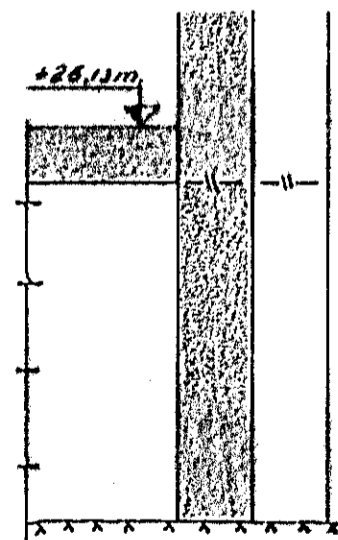

Undirstöður súlna
í vesturhlíð, 1:20.

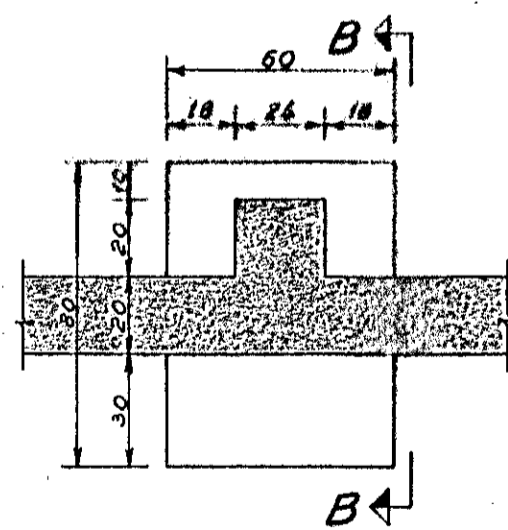

Snið B-B,
1:20.

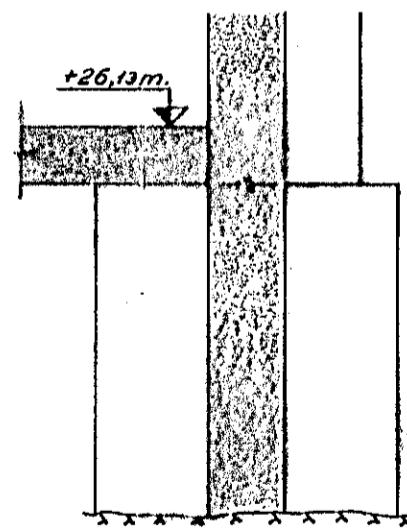

Undirstöður súlna
í austurhlíð, 1:20.

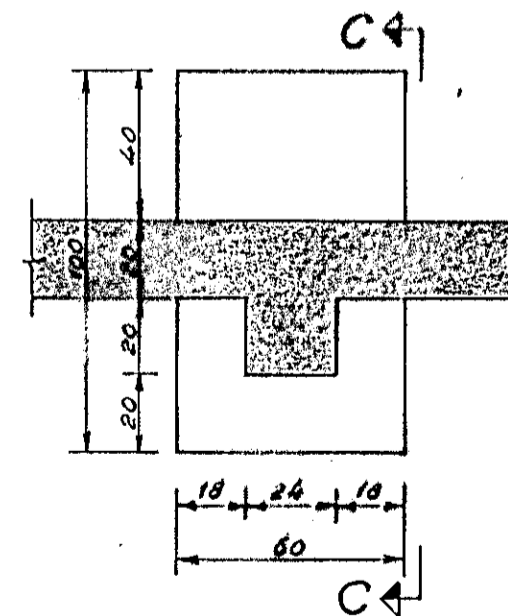

Snið C-C,
1:20.

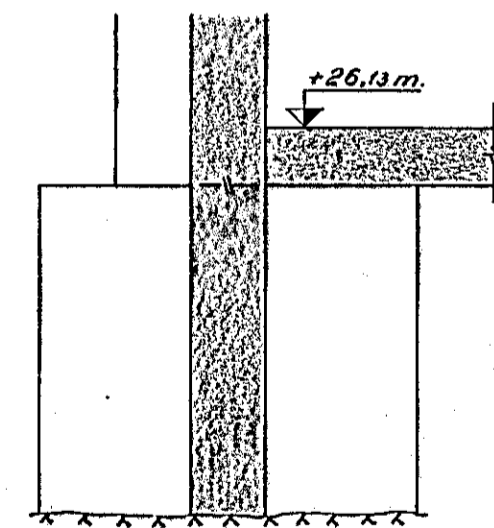

Dalshraun nr. 6, Hafnarfirði.
Undirstöður. - Málauppdráttur.
Reykjavík í júní '63.

Páll Ágústsson Guðmar Baldursson