

FLATJÁRN 8 X 100 X 500
GÖT Ø17mm

LÍMTRÉ 115x500

SÉRMÝND 3.
BITAFESTING
1:10

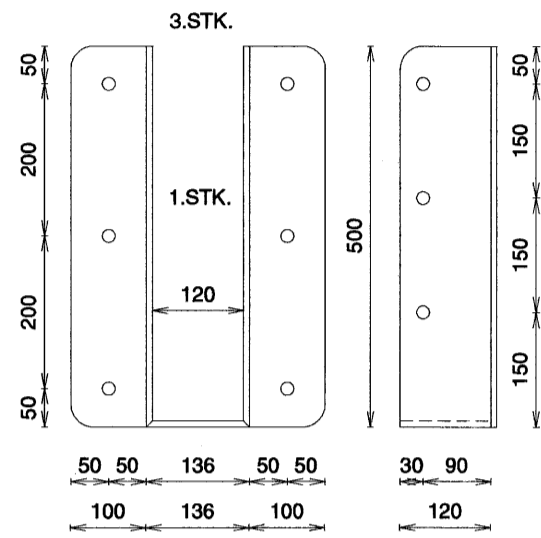

SÉRMÝND 4.
BITAFESTING
1:10

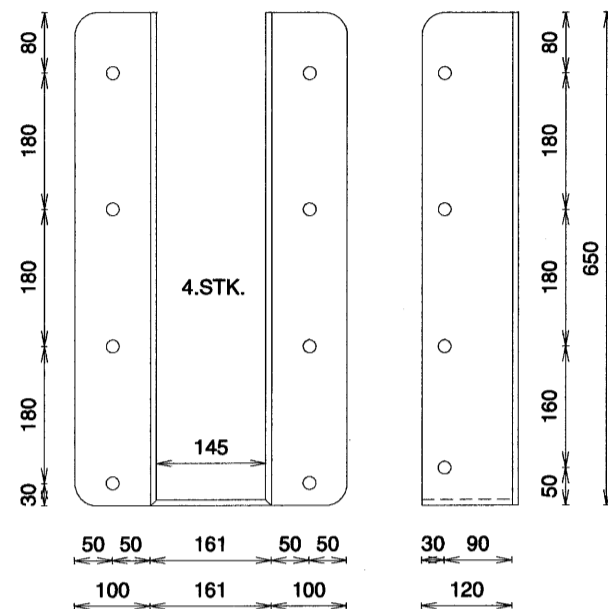

FLATJÁRN 8 X 100 X 650
GÖT Ø17mm

LÍMTRÉ 140x650

50x225
BOLTUÐ Á VEGG
Ø12mm C/C800
GALV. BOLTAR
L=120mm

LOFTUN
LÍMTRÉ/KERTO
51x300
BMF/380 BITASKÓR
EDA SAMBÆRILEGT.
2x6.STK. 40/50 KAMBS. Í BITA
OG SPERRU.

SÉRMÝND 5.
1:10

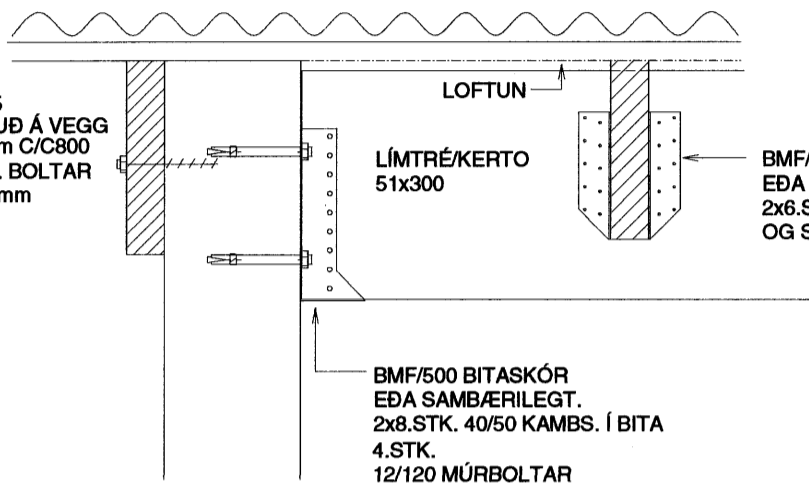

LÍMTRÉ/KERTO 51x300
FLATJÁRN 8x100x300
RAFSUDA
3.STK. 12mm BORDABOLTAR UNDIR RÆR/BOLTAHAUS KOMI 40x40 SKINN
MILLILEGG
SÚLA RHS120x120
RAFSUDA

LÍMTRÉ/KERTO 51x300
FLATJÁRN 8x100x300
RAFSUDA
3.STK. 12mm BORDABOLTAR UNDIR RÆR/BOLTAHAUS KOMI 40x40 SKINN

SÉRMÝND 6.
1:10

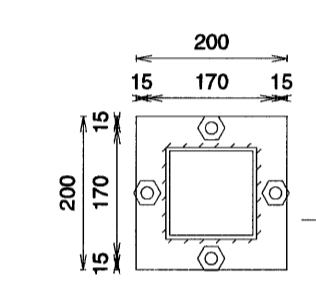

200x200x5 STÁLPLATA
RAF-SOÐIN NEDAN Á RHS-PROFIL
4.STK. 17mm GÖT. FESTIST Í GÓLF
MEÐ 4.STK. 12/120mm MÚRBOLTUM

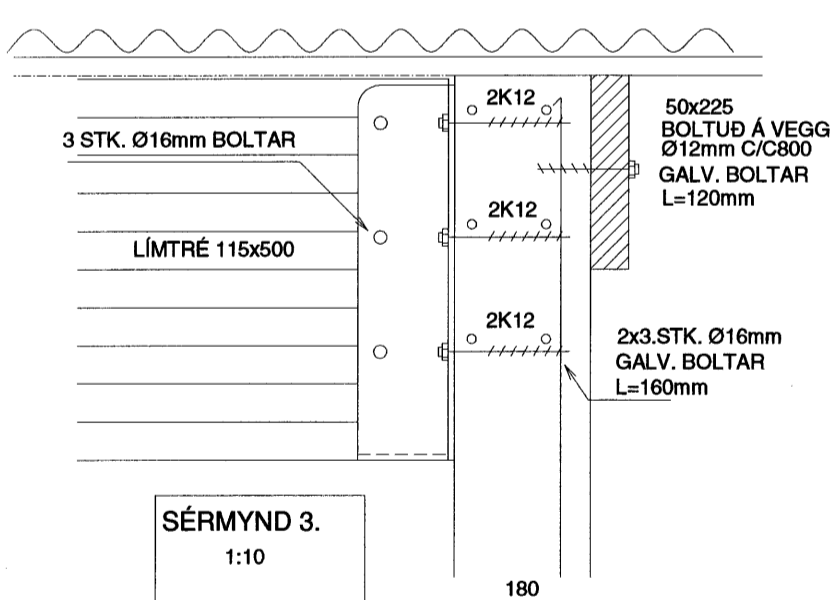
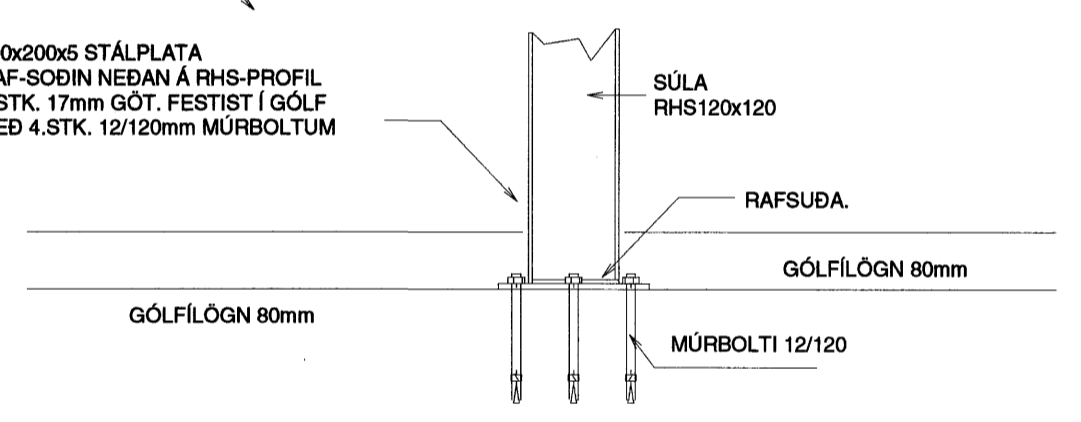

SÉRMÝND 3.
1:10

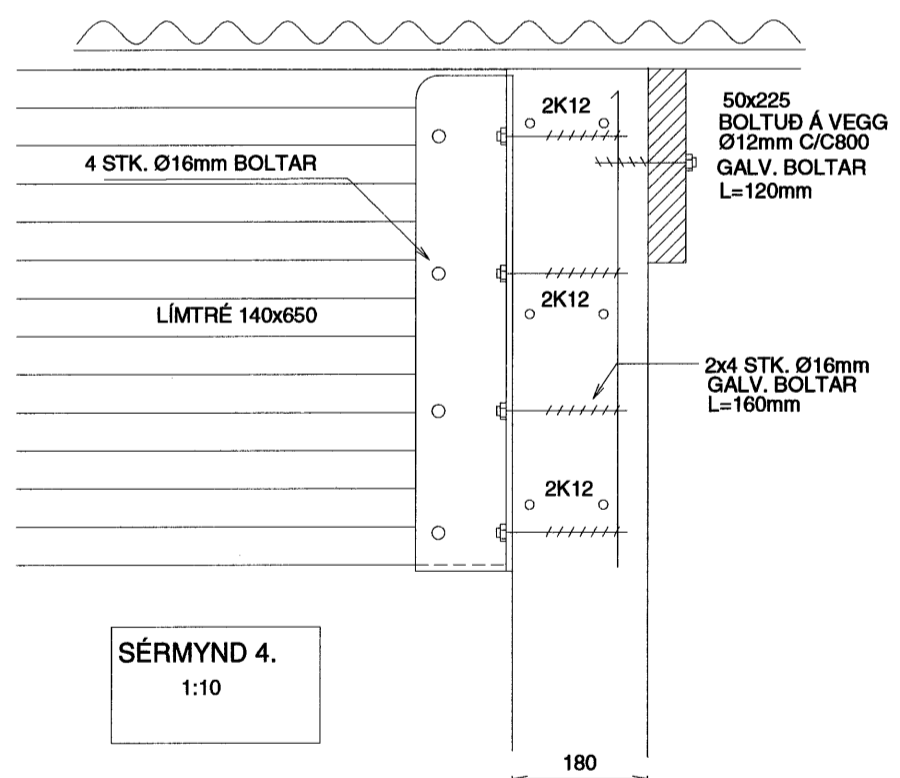

SÉRMÝND 4.
1:10

Byggingatulltrúi Hafnarfjarðar
Afgreitt þann
22 AUG 2007
G.C.

| | |
|--|--|
| BREKKUÁS 29 HAFNARFIRÐI | |
| SÉRMÝNDIR 3 - 4 - 5 - 6 | Mkv. 1:10 |
| | Hannað E.V. |
| | Teiknað E.V. |
| Dags. 5. ÁGÚST. 2007 8 AF 10 | Nr. BREKKUAS29UV Yfirfarið <i>EW</i> |
| ÁRITUN SAMRÆMINGARHÖNNUÐAR <i>Eyþjófur</i> Eyjólfur Valgarðsson Kt:280857-4169 | TR.aust s/f TÆKNIFRÆÐINGARNIR Eyjólfur Valgarðsson Kt:280857-4169 Sigurður Grétarsson Sími: 471-2257 |