

GRUNNMÝND 1. HÆÐ
MKV.: 1:100

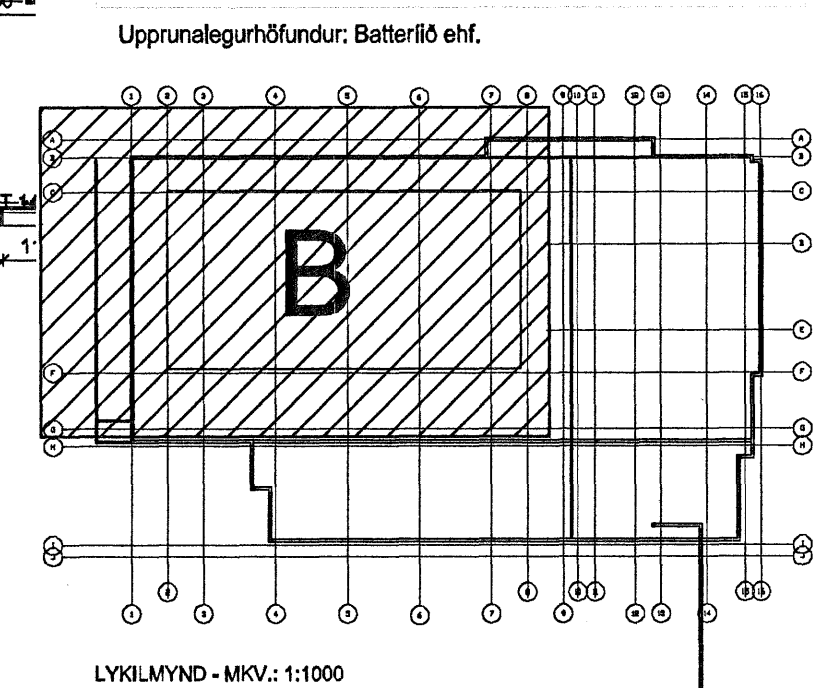

SKÝRINGAR / GÖT:

| GAT NO | BREIDD | HÆÐ | BOTN KÖTI | ATH. |
|---------|--------|--------|-----------|-------------------------------------|
| GAT 149 | 700mm | 7850mm | 22.65 | |
| GAT 150 | 700mm | 7850mm | 22.65 | |
| GAT 151 | 700mm | 7850mm | 22.65 | |
| GAT 152 | 700mm | 7850mm | 22.65 | |
| GAT 153 | 700mm | 7850mm | 22.65 | |
| GAT 154 | 700mm | 7850mm | 22.65 | |
| GAT 155 | 700mm | 7850mm | 22.65 | |
| GAT 156 | 700mm | 7850mm | 22.65 | |
| GAT 157 | 700mm | 7850mm | 22.65 | |
| GAT 158 | 700mm | 7850mm | 22.65 | |
| GAT 159 | 1820mm | 2160mm | 22.50 | |
| GAT 160 | 4720mm | 2010mm | 22.65 | |
| GAT 161 | 4720mm | 2010mm | 22.65 | |
| GAT 162 | 4720mm | 2010mm | 22.65 | |
| GAT 163 | 4720mm | 2010mm | 22.65 | |
| GAT 164 | 4720mm | 2010mm | 22.65 | |
| GAT 165 | 1020mm | 2160mm | 22.50 | |
| GAT 166 | 1670mm | 2160mm | 22.50 | |
| GAT 167 | 2000mm | 2010mm | 22.65 | |
| GAT 168 | 1500mm | 2160mm | 22.50 | |
| GAT 169 | 1020mm | 2160mm | 22.50 | |
| GAT 170 | 1130mm | 830mm | 23.24 | Kassal fyrir elbúttastæði & slöngu. |
| GAT 171 | 730mm | 730mm | 23.29 | Kassal fyrir slöngu. |

Samþykkt bann
25 JAN. 2008
Byggingfulltrúinn í Hafnarfirði
F.h. Sigurbjartur Halldórsson

01.16.01.2007 SL Áhrifendur og steypumál sundlag
Útg. Dags. Teikn. Breyting Samþ. af verkkaupa

FEDGAR ehf.
Byggingaverktakar
Fýskullá 13 • 221 Hafnarfirður
Sími 892 3490 • Fax 565 0483
Netfang fedgareh@simnet.is

Fasteignafélag Hafnarfirðar
ASVELLIR 2 Á VÖLLUM 0617
Lendnúmer: 172880
Stgr. 0440-0020, Mbl. 01

VERKTEIKNINGAR
STEYPUKERNINGAR
GRUNNMÝND 1. HÆÐ - B (29)-B-A04-005
MKV.: 1:100
TEIKNAD: SL
ÓTÓGAFA DAGS: 16.01.2007
STOFN. DAGS: 11.07.2006
ÚTÓGAFA 01

Jón Ólafur Ólafsson FAI
t: 090658-4099

Sigurður Einarsson FAI
t: 110 57 2783

Sigurður Halldórsson FAI
t: 030445-3999

BATTERÍÓ EHF.
t: 521291-1259
Trénuhúsi 1
220 Hafnarfirði

S: 54 54 700 F: 54 54 701
Netfang: bat@batterio.is
Helmsíða: www.erktek.is