

GS1 - 140x500 Mkv 1:20  
Samtals 4 stk

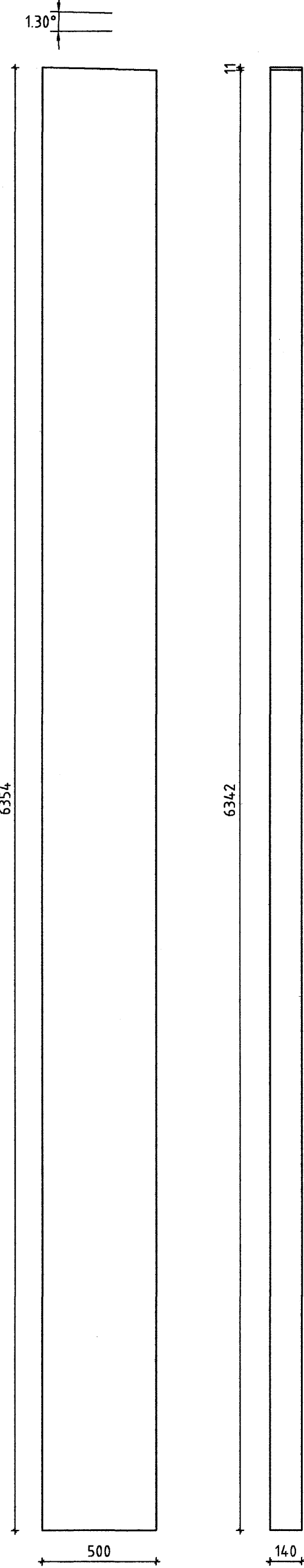

GS2 - 140x333 Mkv 1:20  
Samtals 2 stk + 2 stk spegluð

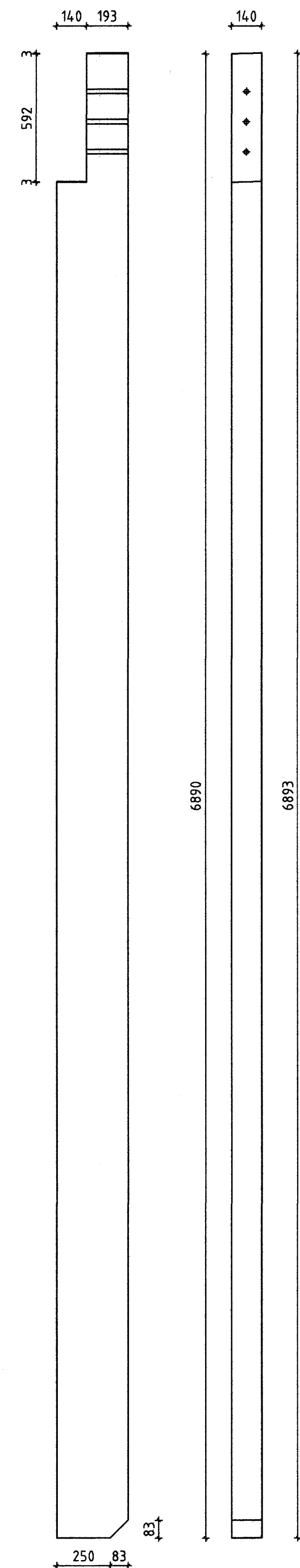

GS3 - 140x333 Mkv 1:20  
Samtals 1 stk + 1 stk spegluð

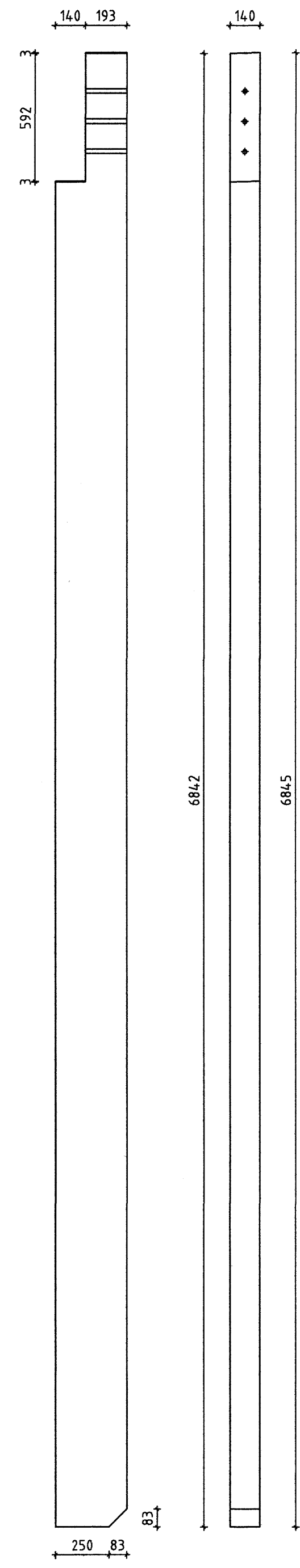

GS4 - 140x333 Mkv 1:20  
Samtals 2 stk + 2 stk spegluð

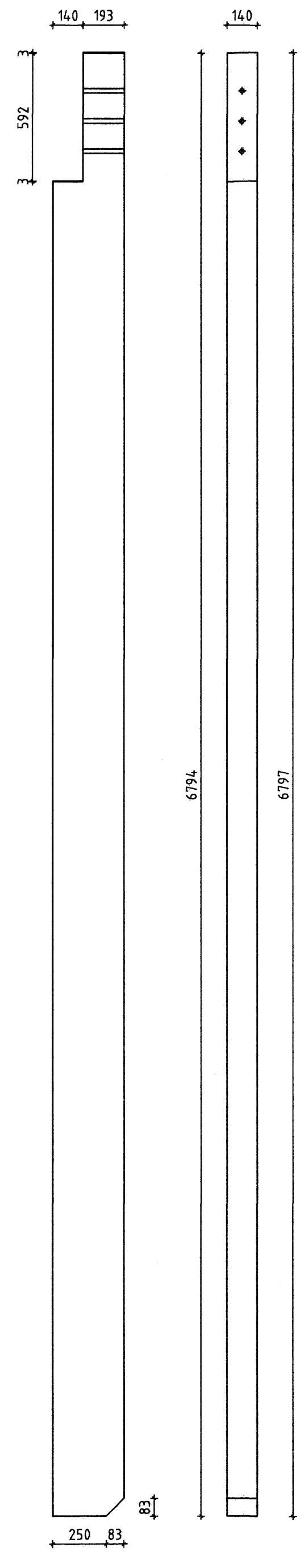

GS5 - 140x333 Mkv 1:20  
Samtals 1 stk + 1 stk spegluð

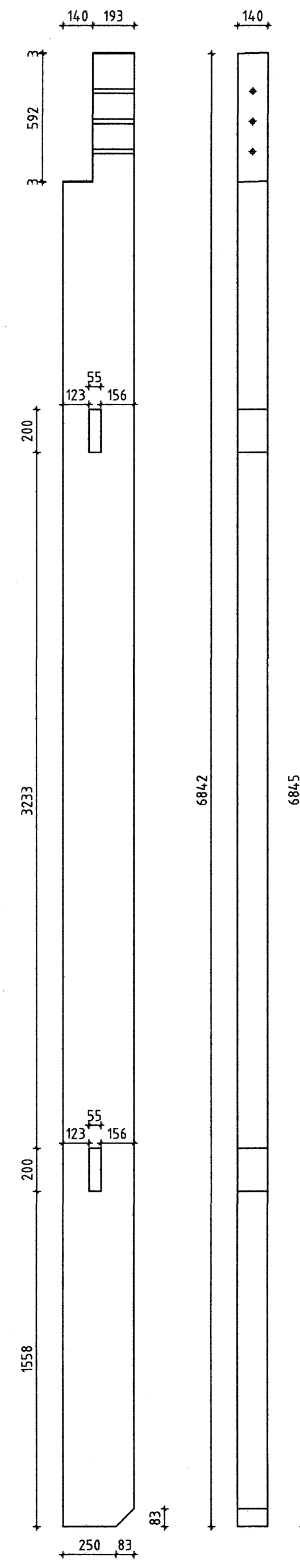

GS6 - 185x500 Mkv 1:20  
Samtals 2 stk

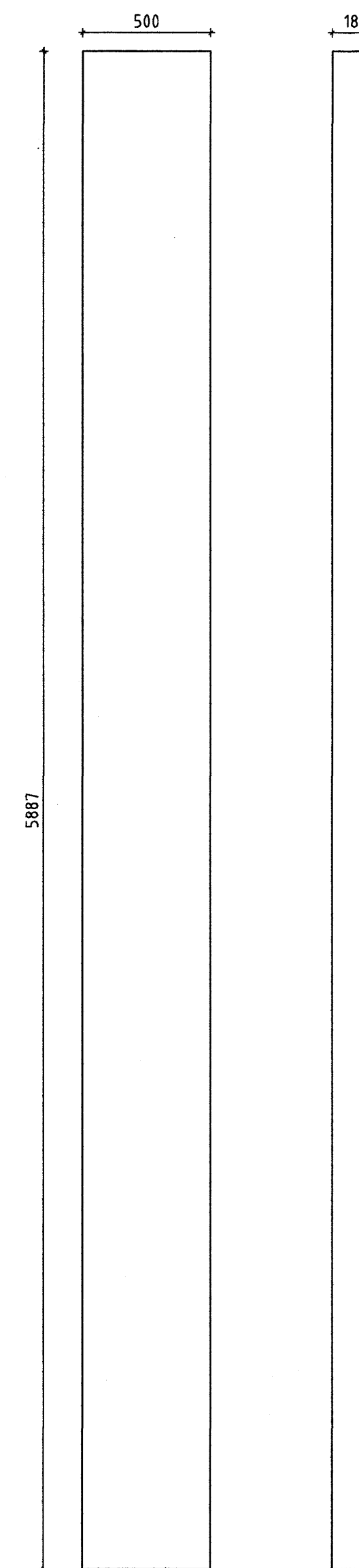

Ø 21 mm göt fyrir snittteina boruð í verksmíðu

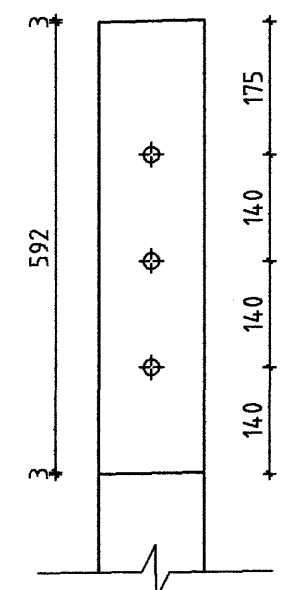

KB1 - 115x367 Mkv 1:20  
Samtals 4 stk

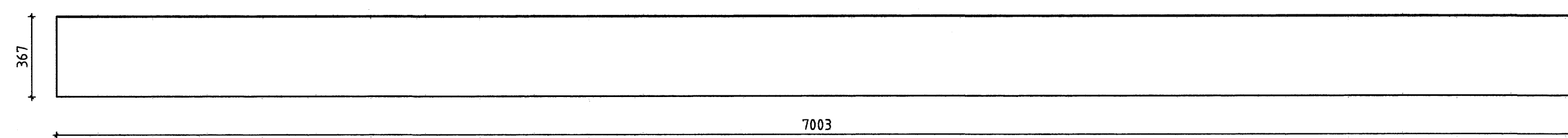

KB1 - 115x367 Mkv 1:20  
Samtals 20 stk

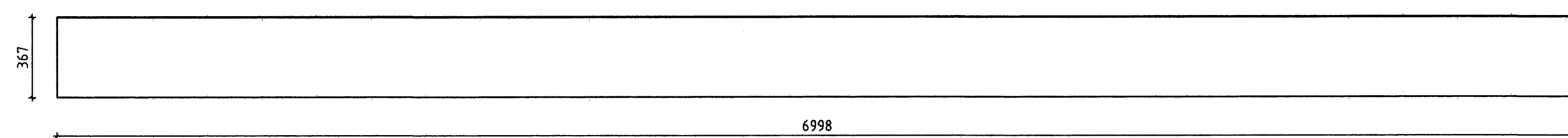

Samþykkt þann  
16 OKT. 2007

Byggingulltrúinn í Hafnarfróði  
F.h. Sigurbjartur Halldórsson

ÖLL AFNOT OG AFRITUN TEKNINGAR AD HLUTA EÐA Í HEILD ER HÁÐ SKRIFLEGU LEYFI LÍMTRÉVÍRNETS EHF.

Númer	Dags.	Skýring breytingar	Br. af
Tæknideild Gylfaftót 9, 112 Reykjavík Sími: 530 6000 Fax: 530 6019		MKV. 1:20 DAGS. 2007.09.18 VERKNR. 2006110006	ÓTGÁFA NR. 302
HEITI VERKS: Selhella 13		TEKNI. TVT REKNI. TVT YFIRF.	NR. TEKNINGAR
HEITI TEKNINGAR Límtré Framleiðsluteikning		HAFNI HÖNNUNAR Bjarni Ingibergsson Byggingatæknifræðingur 030861-2729	DAGS. ÁRTUNAR 16/10 ÁRTUN SAMRÆM.HÖNNUNAR 16/10