

Part Mark Key

1	H37
2	J156
3	J146
4	G1786
5	P192
6	G1788
7	GFA400
8	GFA206
9	GFA108

Secondary Part Schedule

Mark	Part	Thick.	Depth	Lap
04C0511711		0.1200	8 1/2"	
G1786	01G0707016	0.0650	8 1/2"	
G1788	01G0707017	0.0590	8 1/2"	
G1895	017C13007/1	0.1200	8 1/2"	
H37	DH0307217	0.0590	8 1/2"	
J133	005J1010117	0.0590	8 1/2"	
J146	008J0802317	0.0590	8 1/2"	
J156	007J0802317	0.0590	8 1/2"	
J157	009J1010114	0.0820	8 1/2"	
P192	JCP052155	0.0590	8 1/2"	

Framed Opening Locations

Id	Width	Height	Sill Ht.	Frame	To	Dimen.
FO1	3'-7 5/16"	8'-6 3/8"	11'-1 7/8"	BL	Jamb-L	7'-10 1/2"

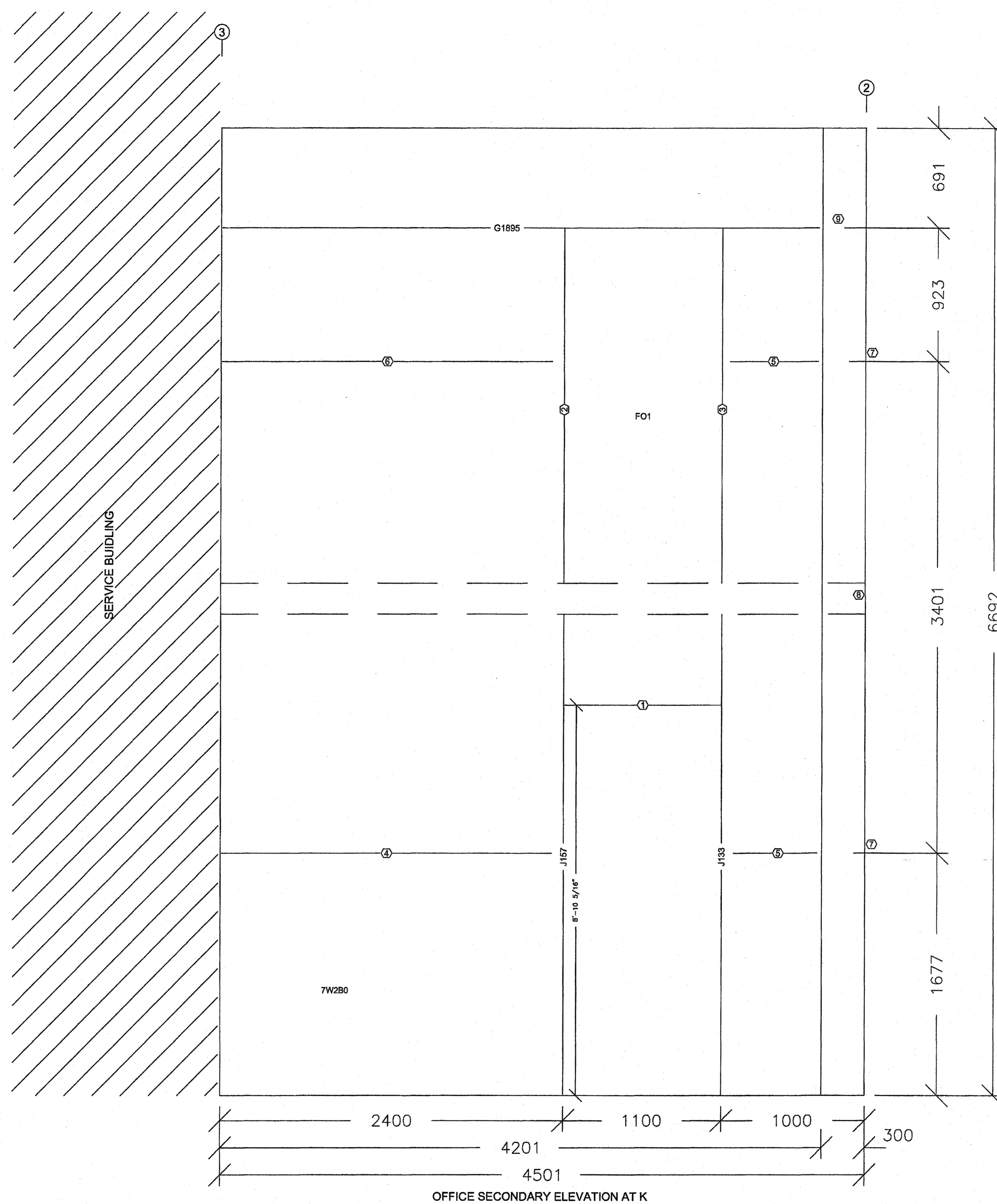

Dimension Key

- UNLESS NOTED, USE 1/2 X 1 1/2 A-325 SNUG TIGHTENED BOLTS FOR GIRT LAP, GIRT TO FRAME, FLANGE BRACE TO FRAME, FLANGE BRACE TO GIRT, JAMB AND HEADER CONNECTIONS.
- WIND AND FLANGE BRACING ARE AN INTEGRAL PART OF THE WALL STRUCTURAL SYSTEM AND SHOULD BE PROPERLY INSTALLED PRIOR TO ERECTION OF WALL AND ROOF SHEETS. REMOVAL OR ALTERATION OF WALL BRACING WITHOUT PRIOR AUTHORIZATION IS PROHIBITED.

THE VP ENGINEER'S SEAL APPLIES ONLY TO THE WORK PRODUCT OF VP AND DESIGN AND PERFORMANCE REQUIREMENTS SPECIFIED BY VP. THE VP ENGINEER'S SEAL DOES NOT APPLY TO THE PERFORMANCE OR DESIGN OF ANY OTHER PRODUCT OR COMPONENT FURNISHED BY VP EXCEPT TO ANY DESIGN OR PERFORMANCE REQUIREMENTS SPECIFIED BY VP.

THIS DRAWING, INCLUDING THE INFORMATION HEREON, REMAINS THE PROPERTY OF VP BUILDINGS. IT IS PROVIDED SOLELY FOR ERECTING THE BUILDING DESCRIBED IN THE APPLICABLE PURCHASE ORDER AND SHALL NOT BE MODIFIED, REPRODUCED OR USED FOR ANY OTHER PURPOSE WITHOUT PRIOR WRITTEN APPROVAL OF VP BUILDINGS.

THE GENERAL CONTRACTOR AND/OR ERECTOR IS SOLELY RESPONSIBLE FOR ACCURATE, GOOD QUALITY WORKMANSHIP IN ERECTING THIS BUILDING IN CONFORMANCE WITH THIS DRAWING, DETAILS REFERENCED IN THIS DRAWING, ALL APPLICABLE VP ERECTION GUIDES, AND INDUSTRY STANDARDS PERTAINING TO PROPER ERECTION, INCLUDING THE CORRECT USE OF TEMPORARY BRACING.

VP Buildings, Inc.
3200 Players Club Circle Memphis TN 38125

REV	DATE	BY	DESCRIPTION

7/27/2007 11:10:28

FOR CONSTRUCTION Norðurhella 2 - 22T Hafnarfjörður

OFFICE SECONDARY ELEVATION AT K

Norðurhella 2 - Hafnarfirði
Útveggur í línu K
Skrifstofuhluti
Bl. nr. 47

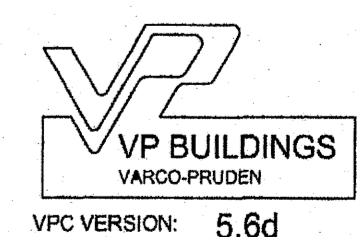

JOBNO	07-4487
DATE	8/14/2007
DRAWN/CHECK	ELM ELM
PAGE	47

VSÓ RÁÐGJÖF
Með áritun á uppdrátt þennan ábyrgist VSÓ Ráðgjöf ehf. kt. 681272-0979, að hönnun sé faglega unnin og í samræmi við lög og reglugerðir um byggingarmál.

Samþykkt þann 26 OCT 2007
BYKT
26 OCT 2007
Byggingufulltrúinn í Hafnarfirði
F. n. Sigurðartur Halldórsson

FILENAME: Copy of Hafnarfjörður 14orig.VPC

..* - C:\PROGRAM FILES\VP BUILDINGS\VP FILES\VP PAGE 1 - 8/20/2007 4:51:22 PM

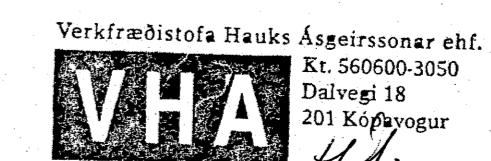

26 OCT 2007
MOTTEKID