

Frame Member Schedule						A325 Bolt Connection & Plate Schedule													
Part	Mem.	Width	Thick.	Webthk	Depth1	Depth2	Approx. Lgth	Detail	Mark No	Id	Qty	Bolt Dia.	Bolt Length	Plate Thick.	Rows Out	Rows In	Tension Bolt	Washer	
CX023	1	203	12.70	4.76	305	1016	4476												
RBX028	2	152	15.88	7.94	762	759	7518			A	12	19	63	19	4	2			
	3	152	15.88	6.35	759	762				B	4	19	51	10	1	1			
	4	152	9.52	4.76	762	406				C	6	19	51	10	1	2			
	5	152	4.76	3.42	406	406				D	4	19	57	10	-	-			
	6	152	4.76	3.42	406	229				E	4	19	38	10	-	-			
RBX029	7	127	3.42	3.42	229	229	3068			F	4	13	38	10	-	-			
	8	127	3.42	3.42	229	229													
RBX030	9	127	4.76	3.42	229	229	5103												
	10	127	4.76	3.42	229	229													
	11	127	4.76	3.42	229	229													
	12	127	4.76	3.42	229	330													
CX022	13	229	9.52	4.18	305	559	8685												
EPX009	14	178	6.35	3.42	250	250	4946	BR25BD											
EPX010	15	203	7.94	4.18	250	250	6009	BR25BD											
EPX011	16	229	7.94	4.18	250	250	6891	BR25BD											
EPX012	17	229	9.52	4.18	250	250	7587	BR25BD											
EPX013	18	229	9.52	4.18	250	250	8050	BR25C7											
BR5006-09	127	4.76	4.76	177.8	177.8														

Frame Clearances
 Horiz. Clearance between members 1 (CX023) and 13 (CX022): 14225
 Vert. Clearance at member 1 (CX023): 4476
 Vert. Clearance at member 13 (CX022): 8219
 Vert. Clearance at member 14 (EPX009): 4925
 Vert. Clearance at member 15 (EPX010): 5986
 Vert. Clearance at member 16 (EPX011): 6864
 Vert. Clearance at member 17 (EPX012): 7560
 Vert. Clearance at member 18 (EPX013): 8024
 Finished Floor Elevation = 100000 (Unless Noted Otherwise)

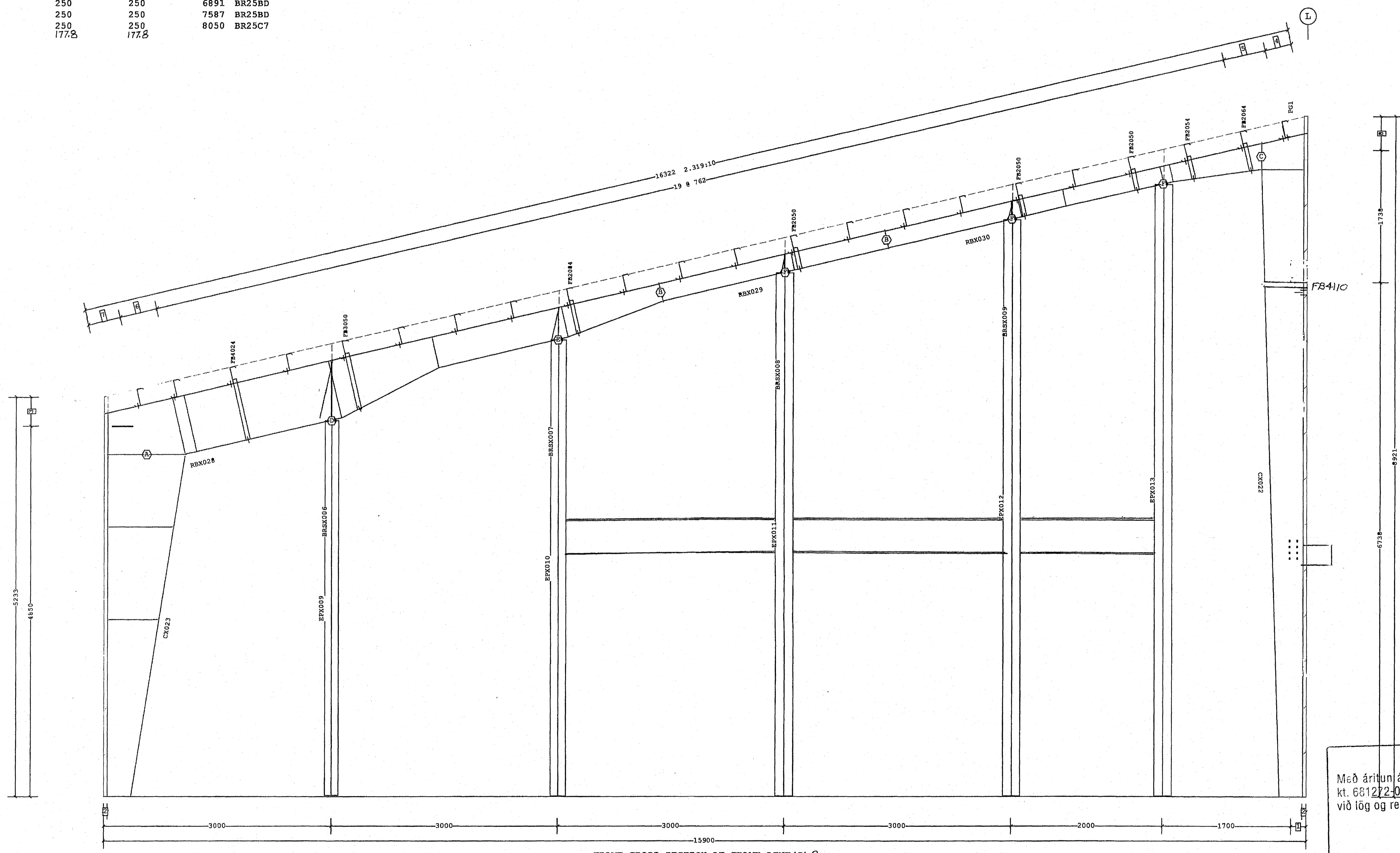

- 8 445
 - 7 438
 - 6 492
 - 5 560
 - 4 354
 - 3 383
 - 2 50
 - 1 200
- Dimension Key

FRAME CROSS SECTION AT FRAME LINE(S) 3

VP Ref: Shape Name = Service Building Wall 2, Frame 13

Samþykkt þann
 23 JAN. 2008
 Byggingfulltrúinn í Hafnarfirði
 K. H. Sigurbjartur Hauksson

VSÓ RÁÐGJÖF
 Með áritun á uppdrátt þennan ábyrgist VSÓ Ráðgjöf ehf. kt. 681272-0979, að hönnun sé faglega unnin og í samræmi við lög og reglugerðir um byggingarmál.
 Dags. _____ Nafn _____ Kennitala _____
 Norðurhella 2 · 221 Hafnarfjörður

FOR CONSTRUCTION

1. USE 1/2 X 1 1/2 A325 SNUG TIGHTENED BOLTS FOR PURLIN TO FRAME, GIRT TO FRAME, AND GIRT TO CLIP CONNECTIONS UNLESS NOTED OTHERWISE.
 2. SLOT REINFORCEMENT PLATES NEED NOT BE LOCATED ON THE SAME SIDE OF THE WEB AS THE HILLSIDE WASHER.

THE VP ENGINEER'S SEAL APPLIES ONLY TO THE WORK PRODUCT OF VP AND DESIGN AND PERFORMANCE REQUIREMENTS SPECIFIED BY VP. THE VP ENGINEER'S SEAL DOES NOT APPLY TO THE PERFORMANCE OR DESIGN OF ANY OTHER PRODUCT OR COMPONENT FURNISHED BY VP EXCEPT TO ANY DESIGN OR PERFORMANCE REQUIREMENTS SPECIFIED BY VP.

THIS DRAWING, INCLUDING THE INFORMATION HEREON, REMAINS THE PROPERTY OF VP BUILDINGS. IT IS PROVIDED SOLELY FOR ERECTING THE BUILDING DESCRIBED IN THE APPLICABLE PURCHASE ORDER AND SHALL NOT BE MODIFIED, REPRODUCED OR USED FOR ANY OTHER PURPOSE WITHOUT PRIOR WRITTEN APPROVAL OF VP BUILDINGS. THE GENERAL CONTRACTOR AND/OR ERECTOR IS SOLELY RESPONSIBLE FOR ACCURATE, GOOD QUALITY WORKMANSHIP IN ERECTING THIS BUILDING IN CONFORMANCE WITH THIS DRAWING, DETAILS REFERENCED IN THIS DRAWING, ALL APPLICABLE VP ERECTION GUIDES, AND INDUSTRY STANDARDS PERTAINING TO PROPER ERECTION, INCLUDING THE CORRECT USE OF TEMPORARY BRACING.

VP Buildings, Inc.
 3200 Players Club Circle Memphis TN 38125

REV	DATE	BY	DESCRIPTION

NTS

8/10/2007 11:10:48

FRAME CROSS SECTION AT FRAME LINE(S) 3
 Norðurhella 2 - Hafnarfirði
 Stálrammi í línu 3
 Verkstæðishluti
 Bl. nr. 20

VP BUILDINGS	VARCO-PRUDEN	VPC VERSION: 6.6d
--------------	--------------	-------------------

JOBNO	07-4487
DATE	08/09/07
DRAWN/CHECK	DJS DJS
PAGE	20

FILENAME: 07-4487EP1.VPC

Verkfæðistofa Hauks Ásgeirssonar ehf.
 Kt. 560600-3050
 Dalveggi 18
 201 Kópavogur

EYKT
 26 OCT 2007
 MOTTEKID