

OFNALISTI KJALLARI

| NR. | NAUÐSYNLEG AFKÖST [W] | GERÐ/HÆÐ [mm] | LENGD [mm] | VALDIR OFNAR AFKÖST [W] VÍÐ $\Delta T=40^{\circ}\text{C}$ | STÚTA-STADSETNING 10 mm | STILLITALA OFNLOKAV GERÐ |
|----------|-----------------------|---------------|------------|---|-------------------------|--------------------------|
| 001 | 250 | (11) / 500 | 400 | 250 | CD | |
| 002 | 1458 | (22) / 500 | 1200 | 1458 | AB | |
| 003 | 1458 | (22) / 500 | 1200 | 1458 | CD | |
| 004 | 1458 | (22) / 500 | 1200 | 1458 | CD | |
| 005 | 10.000 | HITABLÁSARI | | 10.000 | | |
| 006 | 15.000 | HITABLÁSARI | | 15.000 | | |
| SAMTALS: | 29.399 | | | 29.399 | | |

OFNALISTI 1.HÆÐ

| NR. | NAUÐSYNLEG AFKÖST [W] | GERÐ/HÆÐ [mm] | LENGD [mm] | VALDIR OFNAR AFKÖST [W] VÍÐ $\Delta T=40^{\circ}\text{C}$ | STÚTA-STADSETNING 10 mm | STILLITALA OFNLOKAV GERÐ |
|----------|-----------------------|-----------------|------------|---|-------------------------|--------------------------|
| 101 | 1870 | CP / (22) / 280 | 2000 | 1870 | AD | |
| 102 | 1870 | CP / (22) / 280 | 2000 | 1870 | BC | |
| 103 | 1870 | CP / (22) / 280 | 2000 | 1870 | AD | |
| 104 | 1870 | CP / (22) / 280 | 2000 | 1870 | BC | |
| 105 | 1870 | CP / (22) / 280 | 2000 | 1870 | AD | |
| 106 | 1870 | CP / (22) / 280 | 2000 | 1870 | BC | |
| 107 | 1870 | CP / (22) / 280 | 2000 | 1870 | AD | |
| 108 | 1870 | CP / (22) / 280 | 2000 | 1870 | BC | |
| 109 | 1870 | CP / (22) / 280 | 2000 | 1870 | AD | |
| 110 | 1870 | CP / (22) / 280 | 2000 | 1870 | BC | |
| 111 | 1980 | (21) / 500 | 2200 | 1980 | AD | |
| 112 | 1980 | (21) / 500 | 2200 | 1980 | AD | |
| 113 | 1980 | (21) / 500 | 2200 | 1980 | AD | |
| 114 | 1980 | (21) / 500 | 2200 | 1980 | AD | |
| 115 | 1980 | (21) / 500 | 2200 | 1980 | AD | |
| 116 | 1980 | (21) / 500 | 2200 | 1980 | AD | |
| 117 | 1980 | (21) / 500 | 2200 | 1980 | AD | |
| 118 | 1980 | (21) / 500 | 2200 | 1980 | AD | |
| 119 | 1980 | (21) / 500 | 2200 | 1980 | AD | |
| 120 | 1543 | (22) / 500 | 1100 | 1543 | CD | |
| SAMTALS: | 36.083 | | | 36.083 | | |

OFNALISTI 2.HÆÐ

| NR. | NAUÐSYNLEG AFKÖST [W] | GERÐ/HÆÐ [mm] | LENGD [mm] | VALDIR OFNAR AFKÖST [W] VÍÐ $\Delta T=40^{\circ}\text{C}$ | STÚTA-STADSETNING 10 mm | STILLITALA OFNLOKAV GERÐ |
|----------|-----------------------|-----------------|------------|---|-------------------------|--------------------------|
| 201 | 1800 | (21) / 500 | 2000 | 1800 | AD | |
| 202 | 1800 | (21) / 500 | 2000 | 1800 | BC | |
| 203 | 1800 | (21) / 500 | 2000 | 1800 | BC | |
| 204 | 1800 | (21) / 500 | 2000 | 1800 | AD | |
| 205 | 1800 | (21) / 500 | 2000 | 1800 | BC | |
| 206 | 1800 | (21) / 500 | 2000 | 1800 | AD | |
| 207 | 1800 | (21) / 500 | 2000 | 1800 | BC | |
| 208 | 1800 | (21) / 500 | 2000 | 1800 | AD | |
| 209 | 1800 | (21) / 500 | 2000 | 1800 | BC | |
| 210 | 1800 | (21) / 500 | 2000 | 1800 | AD | |
| 211 | 1800 | (21) / 500 | 2000 | 1800 | AD | |
| 212 | 1980 | (21) / 500 | 2200 | 1980 | AD | |
| 213 | 1980 | (21) / 500 | 2200 | 1980 | AD | |
| 214 | 1980 | (21) / 500 | 2200 | 1980 | AD | |
| 215 | 1980 | (21) / 500 | 2200 | 1980 | AD | |
| 216 | 1980 | (21) / 500 | 2200 | 1980 | AD | |
| 217 | 1980 | (21) / 500 | 2200 | 1980 | AD | |
| 218 | 1980 | (21) / 500 | 2200 | 1980 | AD | |
| 219 | 1980 | (21) / 500 | 2200 | 1980 | AD | |
| 220 | 1980 | (21) / 500 | 2200 | 1980 | AD | |
| 221 | 2500 | CP / (22) / 280 | 3000 | 2500 | AD | |
| 222 | 1800 | (21) / 500 | 2000 | 1800 | AD | |
| SAMTALS: | 40.120 | | | 40.120 | | |

OFNALISTI 3.HÆÐ

| NR. | NAUÐSYNLEG AFKÖST [W] | GERÐ/HÆÐ [mm] | LENGD [mm] | VALDIR OFNAR AFKÖST [W] VÍÐ $\Delta T=40^{\circ}\text{C}$ | STÚTA-STADSETNING 10 mm | STILLITALA OFNLOKAV GERÐ |
|----------|-----------------------|---------------|------------|---|-------------------------|--------------------------|
| 301 | 1800 | (21) / 500 | 2000 | 1800 | AD | |
| 302 | 1800 | (21) / 500 | 2000 | 1800 | BC | |
| 303 | 1800 | (21) / 500 | 2000 | 1800 | BC | |
| 304 | 1800 | (21) / 500 | 2000 | 1800 | AD | |
| 305 | 1800 | (21) / 500 | 2000 | 1800 | BC | |
| 306 | 1800 | (21) / 500 | 2000 | 1800 | AD | |
| 307 | 1800 | (21) / 500 | 2000 | 1800 | BC | |
| 308 | 1800 | (21) / 500 | 2000 | 1800 | AD | |
| 309 | 1800 | (21) / 500 | 2000 | 1800 | BC | |
| 310 | 1800 | (21) / 500 | 2000 | 1800 | AD | |
| 311 | 1800 | (21) / 500 | 2000 | 1800 | AD | |
| 312 | 1980 | (21) / 500 | 2200 | 1980 | AD | |
| 313 | 1980 | (21) / 500 | 2200 | 1980 | AD | |
| 314 | 1980 | (21) / 500 | 2200 | 1980 | AD | |
| 315 | 1980 | (21) / 500 | 2200 | 1980 | AD | |
| 316 | 1980 | (21) / 500 | 2200 | 1980 | AD | |
| 317 | 1980 | (21) / 500 | 2200 | 1980 | AD | |
| 318 | 1980 | (21) / 500 | 2200 | 1980 | AD | |
| 319 | 1980 | (21) / 500 | 2200 | 1980 | AD | |
| 320 | 1980 | (21) / 500 | 2200 | 1980 | AD | |
| 321 | 1800 | (21) / 500 | 2000 | 1800 | AD | |
| SAMTALS: | 37.620 | | | 37.620 | | |

OFNATENGINGAR:

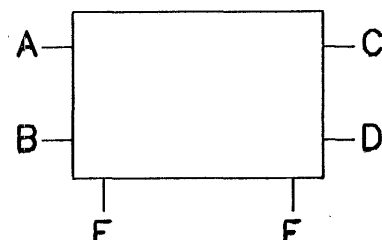

REYKJAVÍKURVEGUR 74

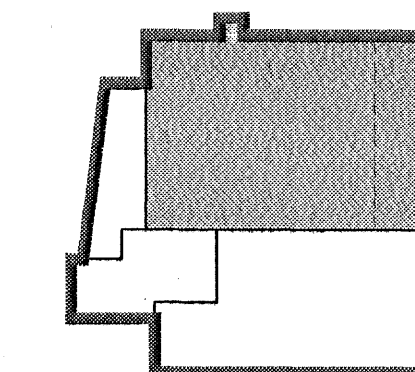

3h
2h
1h
kj

Útg. Daga Skýring Hannað/Yfirfarir

Árnor Þorvaldur
VSB
VERKFRÆÐISTOFA

BÆJARHRAUN 20 · 220 HAFNARFJÖRDUR · KENNIT. 710796-2899
vsb@vsb.is · Sími 565 6600 · Fax 565 6610 · www.vsb.is

Byggingafræðingur
Alfreitt Þann
02. DES. 2005

Árinn séðinnúmer
SVEINN ÁRÍ SVERRISSON Kt: 230855 5609

Verkefni
REYKJAVÍKURVEGUR 74
HAFNARFIRÐI

Verkefni
LAGNIR
OFNALISTI

| Hannað | Teiknað | Yfirfarir | Kvarði | Síða |
|----------|----------|-----------|--------|------|
| KMJ | KMJ/JGR | SÁS | / A1 | - |
| Daga | Verkefni | Tekning | Útgáfa | - |
| 28.11.05 | 03796 | P002 | - | - |

Undirteiknað: 03/10/03/786-Regj.kur.vegur 74/SHmas LA03796 P002.dwg