

NÚMÉR	ÞYKKT mm	NEDRI BRÚN*		EFRI BRÚN*	
		LANGÁTT	SKAMMÁTT	LANGÁTT	SKAMMÁTT
KB-K-01	455				
KB-K-02	455				
KB-K-03	455				
KB-K-04	455				
KB-K-05	455				
KB-K-06	455				
KB-K-07	455				
KB-K-08	455				
KB-K-09	455				
KB-K-10	455				
KB-K-11	455				
KB-K-12	455				
KB-K-13	455				
KB-K-14	455				
KB-K-15	455				
KB-K-16	455				
KB-K-17	455				
KB-K-18	455				
KB-K-19	455				
KB-K-20	455				
KB-K-21	455				
KB-K-22	455				
KB-K-23	455				
KB-K-24	455				
KB-K-25	455				
KB-K-26	455				
KB-K-27	455				
KB-K-28	455				
KB-K-29	455				
KB-K-30	455				
KB-K-31	455				
KB-K-32	455				
KB-K-33	455				
KB-K-34	455				
KB-K-35	455				
KB-K-36	455				
KB-K-37	455				
KB-K-38	455				

NÚMÉR	ÞYKKT mm	NEDRI BRÚN*		EFRI BRÚN*	
		LANGÁTT	SKAMMÁTT	LANGÁTT	SKAMMÁTT
KB-K-39	455				
KB-K-40	455				
KB-K-41	455				
KB-K-42	455				
KB-K-43	455				
KB-K-44	455				
KB-K-45	455				
KB-K-46	455	K16c/c200	K12c/c200	K10c/c200	K10c/c200
KB-K-47	455	K16c/c200	K12c/c200	K10c/c200	K10c/c200
KB-K-48	455	K16c/c200	K12c/c200	K10c/c200	K10c/c200
KB-K-49	455	K16c/c200	K12c/c200	K10c/c200	K10c/c200
KB-K-50	455	K16c/c200	K12c/c200	K10c/c200	K10c/c200
KB-K-51	455	K16c/c200	K12c/c200	K10c/c200	K10c/c200
KB-K-52	455	K16c/c200	K12c/c200	K10c/c200	K10c/c200
KB-K-53	455	K16c/c200	K12c/c200	K10c/c200	K10c/c200
KB-K-54	455	K16c/c200	K12c/c200	K10c/c200	K10c/c200
KB-K-55	455	K16c/c200	K12c/c200	K10c/c200	K10c/c200
KB-K-56	455	K16c/c200	K12c/c200	K10c/c200	K10c/c200
KB-K-57	455	K16c/c200	K12c/c200	K10c/c200	K10c/c200
KB-K-58	455	K16c/c200	K12c/c200	K10c/c200	K10c/c200
KB-K-59	455	K16c/c200	K12c/c200	K10c/c200	K10c/c200
KB-K-60	455	K16c/c200	K12c/c200	K10c/c200	K10c/c200
KB-K-61	455	K16c/c200	K12c/c200	K10c/c200	K10c/c200
KB-K-62	455	K16c/c200	K12c/c200	K10c/c200	K10c/c200
KB-K-63	455	K16c/c200	K12c/c200	K10c/c200	K10c/c200
KB-K-64	455	K16c/c200	K12c/c200	K10c/c200	K10c/c200
KB-K-65	455	K12c/c200	K10c/c200	K10c/c200	K10c/c200
KB-K-66	455	K16c/c200	K12c/c200	K10c/c200	K10c/c200
KB-K-67	455	K16c/c200	K12c/c200	K10c/c200	K10c/c200
KB-K-68	455	K16c/c200	K12c/c200	K10c/c200	K10c/c200
KB-K-69	455	K16c/c200 STANDI 40mm ÚT ÚR HLIÐ 3	K12c/c200	K10c/c200	K10c/c200
KB-K-70	455	K16c/c200 STANDI 40mm ÚT ÚR HLIÐ 3	K12c/c200	K10c/c200	K10c/c200
KB-K-71	455	K16c/c200 STANDI 40mm ÚT ÚR HLIÐ 3	K12c/c200	K10c/c200	K10c/c200
KB-K-72	455	K16c/c200 STANDI 40mm ÚT ÚR HLIÐ 3	K12c/c200	K10c/c200	K10c/c200
KB-K-73	455	K16c/c200 STANDI 40mm ÚT ÚR HLIÐ 3	K12c/c200	K10c/c200	K10c/c200
KB-K-74	455	K16c/c200	K12c/c200	K10c/c200	K10c/c200
KB-K-75	455	K16c/c200	K12c/c200	K10c/c200	K10c/c200

*) MÖSKVI Á BENDINGU ER MEDALFJARL/EGÐ Á MILLI JARNA. MÖSKVA SKAL STILLA AF TIL ÞESS AD JÄRN SKORDI SIG Á MILLI KÚLNA

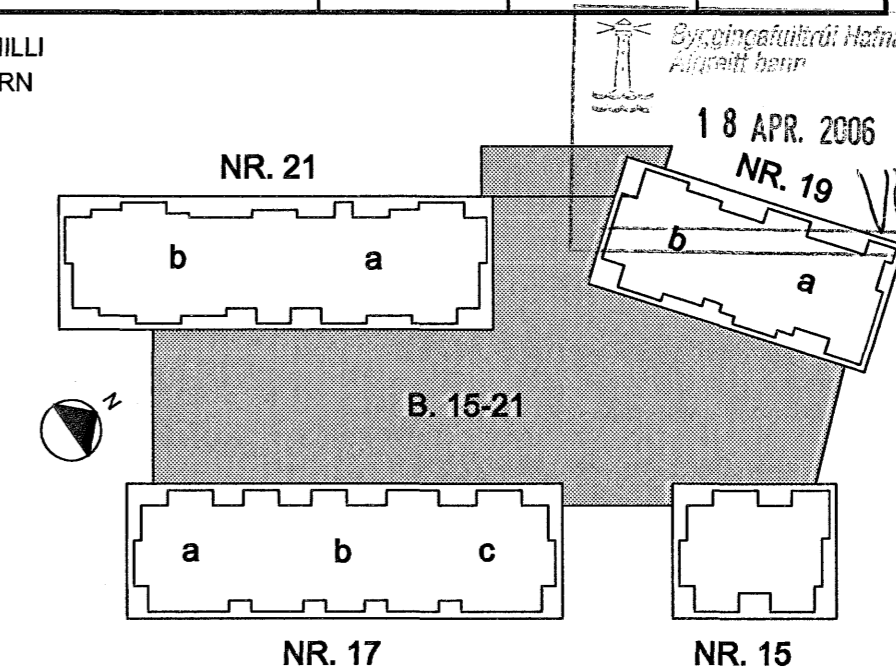

ÁRITUN SAMRÆMINGARHÖNNUNAR
Kl. 110457-2789

SJÁ RAFMAGNSTEIKNINGAR FYRIR INNSTEYPTAR DÓSIR Í PLÖTUM

LYKILMYND FYRIR KÚLUPLÖTUR

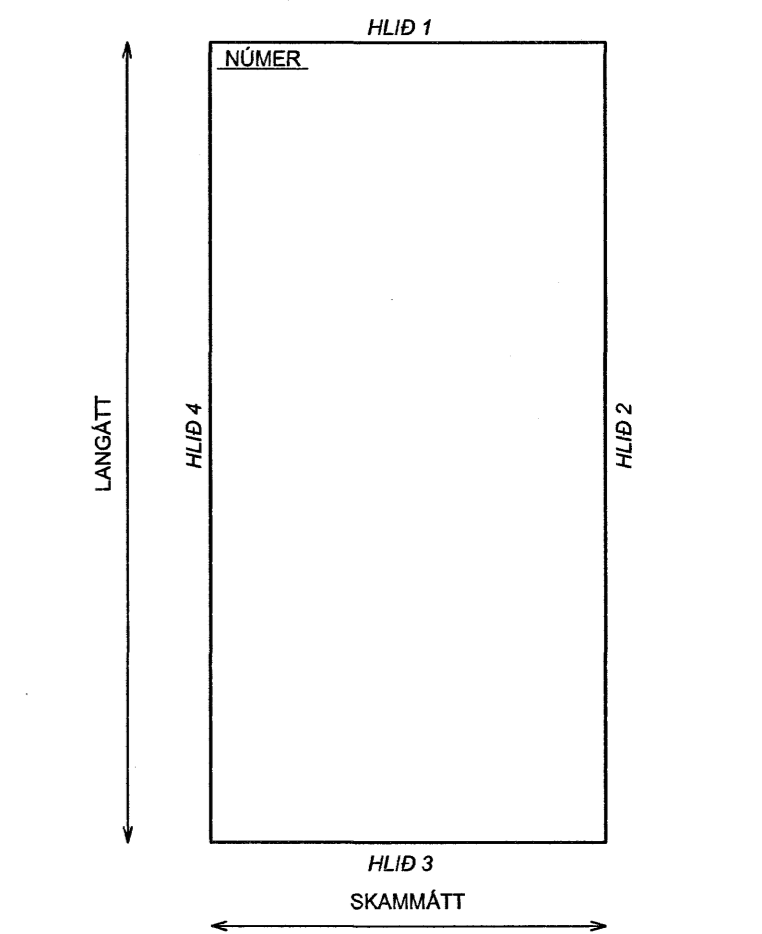

SAMSKEYTI Á KÚLUPLÖTUM Á LANGHLIÐUM:

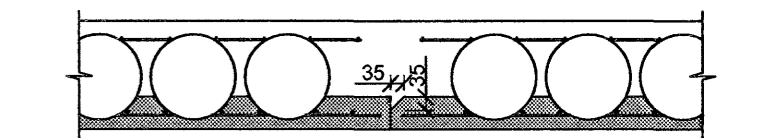

- SKÝRINGAR:**
- F LANGHLIÐ Á KÚLUPLÖTU ÞAR SEM 35X35mm FLEYGUR ER
 - SVÆÐI ÞAR SEM KÚLUM OG JÄRNUM Í EFRI BRÚN SLEPPT
 - SVÆÐI ÞAR SEM KÚLUM ER SLEPPT

STEYPA Í KÚLUPLÖTUR:

- BROTÞOLSFLÖKKUR: C40/50
- SEMENTSMAGN: MINNST 320 kg/m³
- VATNSSEMENTSSTA: < 0,45
- HÁMARKSSTEINASTÆRÐ: 25 mm
- LOFTINNHALD: 5 - 6%
- FJARL STUÐULL LOFTS: < 0,25mm
- LÁGMARKSHULA: 30 mm

TILVÍSANIR:

BR. DAGS. BREYTING REIKN. TEKN.

NORÐURBAKKI 15-21 BÍLAGEYMSLA

BURDARVIRKI
SÉRMYNDIR AF KÚLUPLÖTUM, BENDING KÚLUPLATNA
PLATA YFIR BÍLAGEYMSLU

MKV: 1:50
DAGS: 20.03.2006
HANNAÐTEKNI: HEGG
VERNRN: 05104

YFRARÍÐ: ÞÓ
SAMBYKKT: *[Signature]*
KENNITALA: 130657-4439

TEKNI NR: B(BG)_556

Conís
VERKFRÁÐIÐRÁÐGJÓF
Kennitala: 600105-1400
Lýngilfak: 110 769 0000
Sími: 517-3050
Vefbfang: www.conis.is