

POOL DATA (METRIC)	
PERIMETER	56.04 M
AREA	167.97 SQ. M.
VOLUME	170.85 CU. M.
TURNOVER	1.0 HRS.
FLOW RATE	170.85 CU. M / HR
INLETS	126

POOL DATA (IMPERIAL)	
PERIMETER	183'-10 1/2"
AREA	1,808 SQ. FT.
VOLUME	45,134 GAL.
TURNOVER	1.0 HRS.
FLOW RATE	752 GPM
INLETS	126

TRAINING POOL EQUIPMENT SCHEDULE				
MARK	QTY.	MANUFACTURER	DESCRIPTION	DETAIL
1	56.04m [183'-10 5/16"]	Natare	MS-1000 Stainless Steel Perimeter Gutter System	A-4.2
2	56.04m [183'-10 5/16"]	Natare	1-Bar Perimeter Gutter Grating	B-4.2
3	1	Natare	Supply Converter, 250mm	C-4.2
4	2	Natare	Gutter Collector, 250mm	D-4.2
5	4	Natare	Deck Drain Clean Out	C,D-4.3
6	4	Natare	Deck Drain Out Fall	A-4.3
7	4	Natare	Main Drain, 250mm	B-4.3
8	8	Natare	Recessed Rope Hook	E-4.3
9	1	Natare	Wall Mount Return Box	E-4.1
10	8	Natare	Automatic Surge Control	C-4.4
11	1	Natare	Automatic Water Level Controller	Sheet 8.4
12	5	Natare	S/S Recessed Step	A-4.4

DECK AND ACCESSORY EQUIPMENT SCHEDULE				
MARK	QTY.	MANUFACTURER	DESCRIPTION	DETAIL
20	2	---	S/S grabrail	---
21	---	---	Heavy duty bronze anchor	---
22	---	---	---	---
23	---	---	---	---

* NOT IN CONTRACT, SUPPLIED BY OWNER

PLAN NOTES:

1. CONVERTER / COLLECTOR BOX LOCATIONS ARE APPROXIMATE AND CAN BE ADJUSTED DURING INSTALLATION TO ACCOMMODATE FIELD CONDITIONS.
2. DECK EQUIPMENT IS NOT INCLUDED IN CONTRACT.

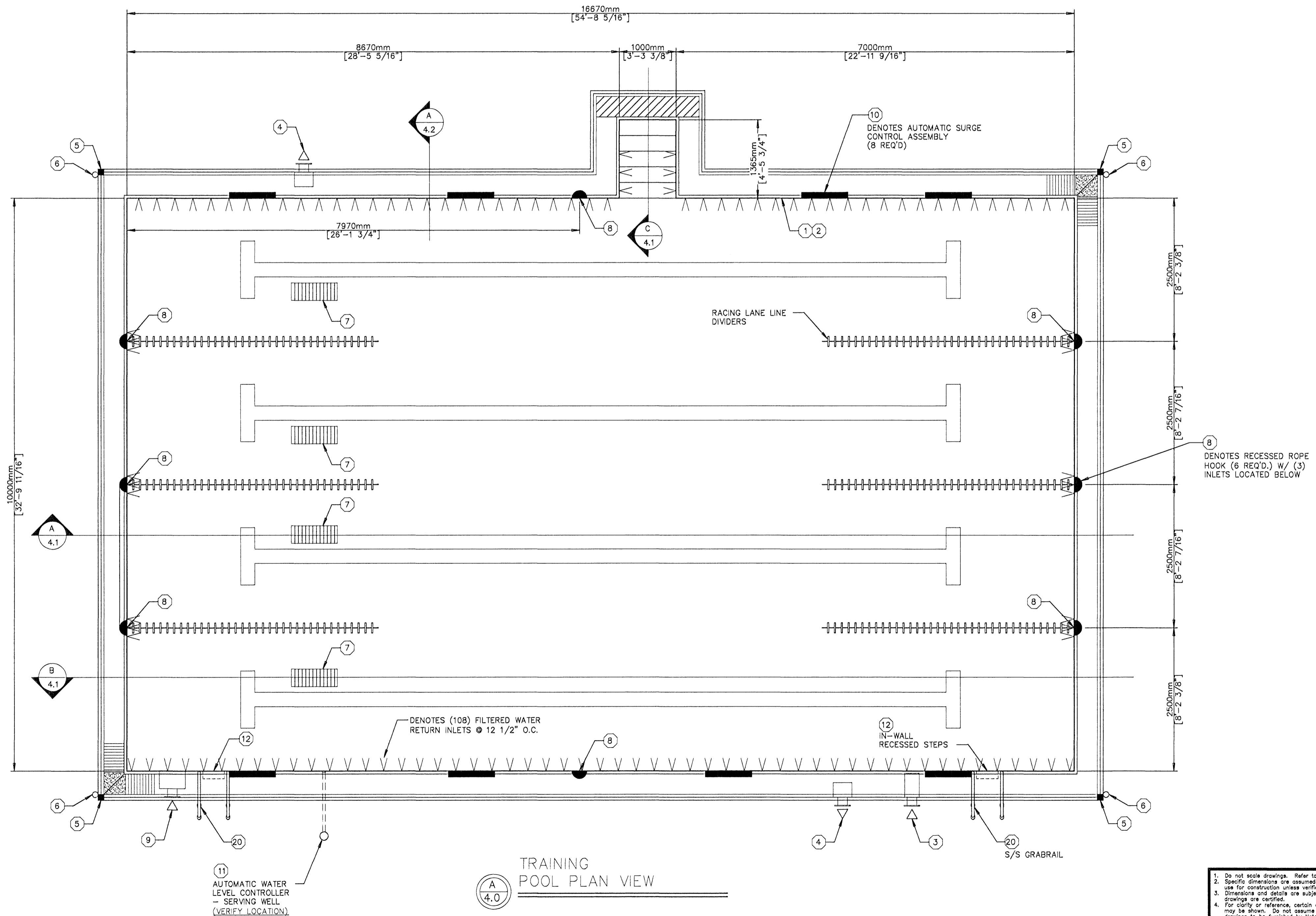

TRAINING POOL PLAN VIEW

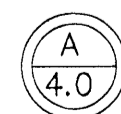

1. Do not scale drawings. Refer to or request specific dimensions.
2. Specific dimensions are assumed to be accurate. However, do not use for construction unless verified and certified.
3. Dimensions and details are subject to change without notice unless drawings are certified.
4. For clarity or reference, certain equipment or areas of construction may be shown. Do not assume all items or work illustrated on these drawings to be furnished by Natare Corporation. Refer to equipment schedule or scope of work for specific details.
5. When related work or equipment is shown, such illustration is for information or clarity only. Always refer to appropriate documents for specific details or instructions.

Sundmidstod

Iceland

Sampykkt þann
07 MAI 2008
Byggingarfulltrúinn í Hafnarfirði
F.h. Hrólfur S. Gunnlaugsson

Kt. 110457-2789

Strendingur ehf.
Fjarbergá 18-19 • 220 Hafnarfjörður
Sími 565 5840 • strendingur@strendingur.is
www.strendingur.is

INSERTED WEIR LOCATIONS 10/2/07

NO.	DESCRIPTION	DATE
REVISIONS		

NATARE
CORPORATION
5805 W. 74th Street
Indianapolis, IN 46278-1788
(317)290-8828
Fax:(317)290-9988

These drawings and the ideas, concepts, illustrations, and written information represented hereby are the property of Natare Corporation and shall not be distributed, copied, reproduced or utilized in any manner except upon the expressed written consent of Natare Corporation. The recipient hereby acknowledges the confidential and proprietary nature of these drawings and acknowledges Natare's proprietary interest therein and agrees not to use these drawings or the ideas and concepts depicted herein except for the fabrication of the articles depicted herein for and on the behalf of Natare Corporation.

© 2007 NATARE CORPORATION

PAGE TITLE:
TRAINING POOL PLAN

DATE: 10/5/07

FILE: Training Pool.dwg

LAYOUT: Training Pool Plan

DRAWN BY: SAL

CHECKED BY: MTW

PROJECT NO.:

SHEET NO.:

4.0