

Byggingarfræðingur  
Alfreður Þór Haldrupsson  
18 FEB 2008

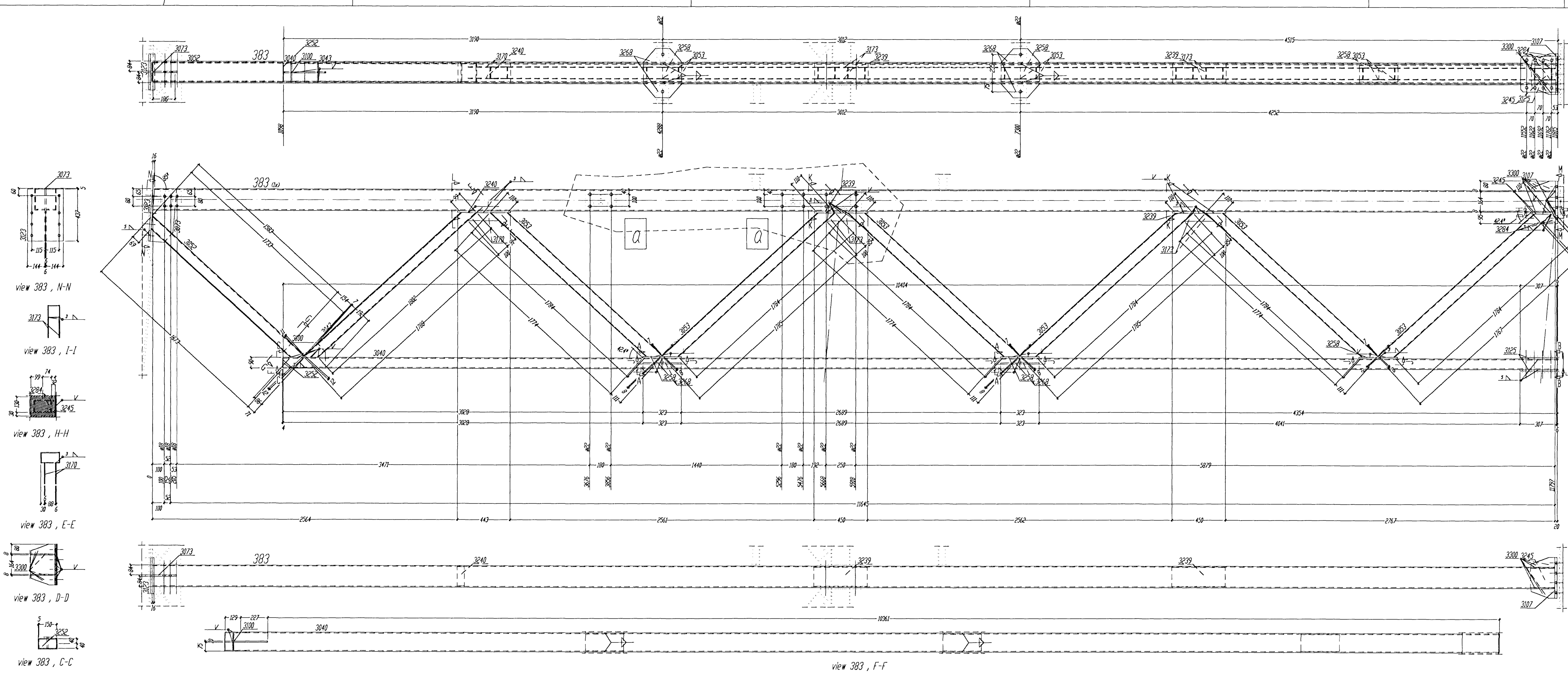

# of all material for 1 Dip. POS. 383 total / X done

no	pos.	designation	qty	prof.	quality	length	weight	mm
1	383	1 M050400471	1753	SE25.AE2	1753	2508		
2	383	1 M050400471	1071	SE25.AE2	1071	2707		
3	383	1 M050400455	1888	SE25.AE2	1888	3843		
4	383	1 M050400455	1744	SE25.AE2	1744	2513		
5	383	6 M050400455	1888	SE25.AE2	1888	2513		
6	383	1 R124458	195	SE25.AE2	195	810		
7	383	1 R124458	255	SE25.AE2	255	610		
8	383	1 R124458	255	SE25.AE2	255	610		
9	383	1 R124458	422	SE25.AE2	422	1044		
10	383	2 R124458	301	SE25.AE2	301	725		
11	383	2 R124458	67	SE25.AE2	67	164		
12	383	4 R124458	67	SE25.AE2	67	164		
13	383	2 R124458	458	SE25.AE2	458	1095		
14	383	1 R124458	443	SE25.AE2	443	834		
15	383	1 R124458	293	SE25.AE2	293	386		
16	383	1 R124458	80	SE25.AE2	80	38		
17	383	3 R124458	323	SE25.AE2	323	1278		
18	383	4 R124458	323	SE25.AE2	323	1278		
19	383	2 R124458	67	SE25.AE2	67	164		
20	383	6 R124458	280	SE25.AE2	280	692		
21	383					10844		

Shipping dimensions 01 x B x L x L2 x L3 x 0835

view 383, M-M  
view 383, J-J  
view 383, B-B  
section 383, K-K  
section 383, L-L  
section 383, G-G  
section 383, A-A

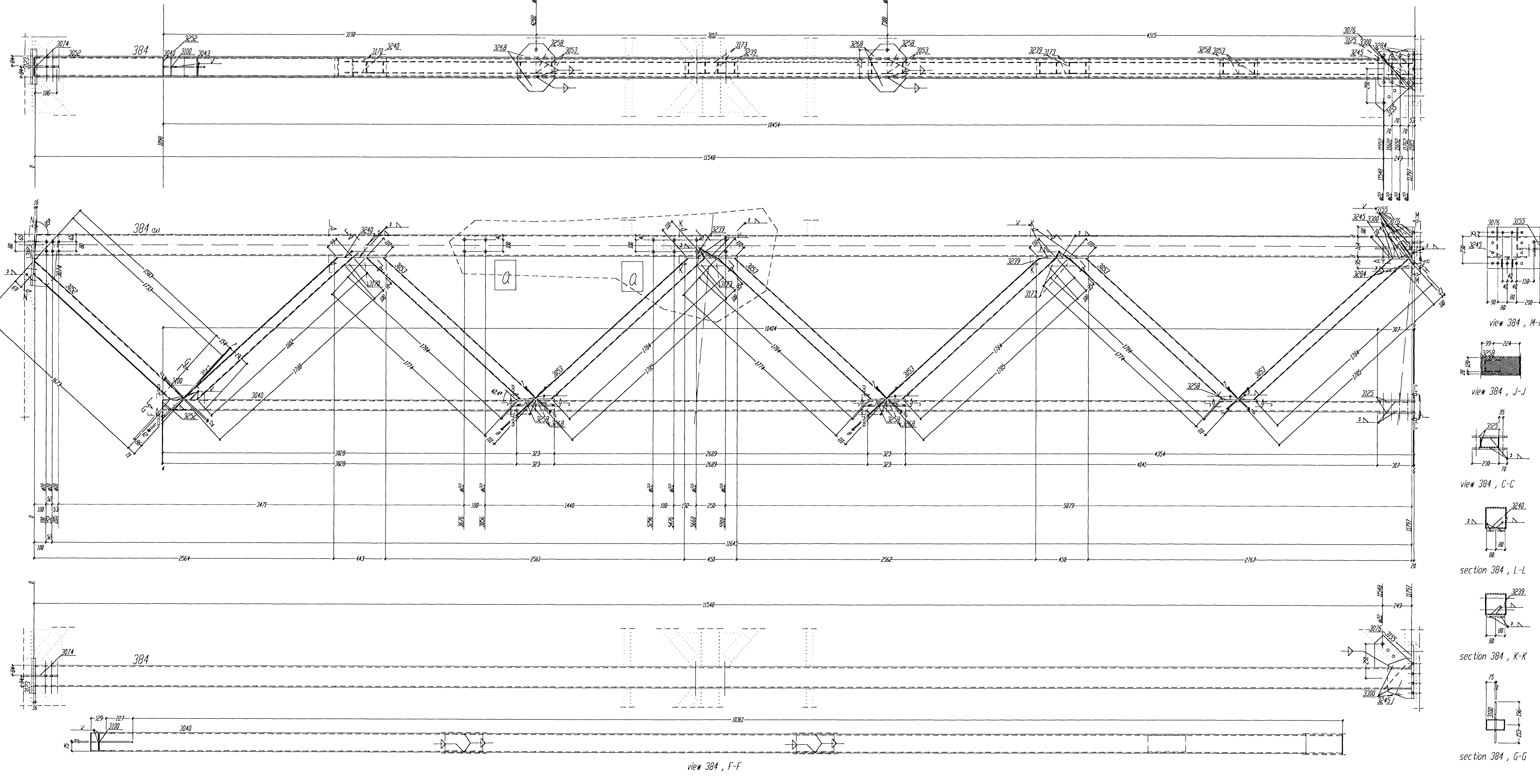

# of all material for 1 Dip. POS. 384 total / X done

no	pos.	designation	qty	prof.	quality	length	weight	mm
1	384	1 M050400471	1753	SE25.AE2	1753	2508		
2	384	1 M050400471	1071	SE25.AE2	1071	2707		
3	384	1 M050400455	1888	SE25.AE2	1888	3843		
4	384	1 M050400455	1744	SE25.AE2	1744	2513		
5	384	6 M050400455	1888	SE25.AE2	1888	2513		
6	384	1 R124458	195	SE25.AE2	195	810		
7	384	1 R124458	255	SE25.AE2	255	610		
8	384	1 R124458	255	SE25.AE2	255	610		
9	384	1 R124458	422	SE25.AE2	422	1044		
10	384	2 R124458	301	SE25.AE2	301	725		
11	384	2 R124458	67	SE25.AE2	67	164		
12	384	4 R124458	67	SE25.AE2	67	164		
13	384	2 R124458	458	SE25.AE2	458	1095		
14	384	1 R124458	443	SE25.AE2	443	834		
15	384	1 R124458	293	SE25.AE2	293	386		
16	384	1 R124458	80	SE25.AE2	80	38		
17	384	3 R124458	323	SE25.AE2	323	1278		
18	384	4 R124458	323	SE25.AE2	323	1278		
19	384	2 R124458	67	SE25.AE2	67	164		
20	384	6 R124458	280	SE25.AE2	280	692		
21	384					10844		

Shipping dimensions 01 x B x L x L2 x L3 x 0835

view 384, M-M  
view 384, J-J  
view 384, N-N  
view 384, C-C  
view 384, I-I  
view 384, H-H  
view 384, E-E  
view 384, D-D  
section 384, B-B  
section 384, A-A  
section 384, L-L  
section 384, K-K  
section 384, G-G

Giftull  
Fyrir hönd Conis ehf, kt. 600105-1400  
staðfestist að teikning þessi hefur verið  
yfirlitinn. Teikningin er í samræmi við  
Íslenska stöðla og reglugerðir. 28/107  
Kennitala

Tolerance for welded constructions  
According to DIN 8570, Pt.1/2/3/4/5/6/7

Welding (V P S) according to  
DIN-EN 288 - 2

All unmarked welds to be fillet  
continuous a=4mm thick,  
not greater than 0.7 d  
of the thinner element

The material for cap plates 120 mm thick  
to be examined for laminations

Required torques/prestressing forces and forced  
tension angles according to DIN 18800 Pt. 7, US83

Welding	Pre-stressing	Force	Angle	Remarks
1	1	1	1	
2	2	2	2	
3	3	3	3	
4	4	4	4	
5	5	5	5	
6	6	6	6	
7	7	7	7	
8	8	8	8	
9	9	9	9	
10	10	10	10	
11	11	11	11	
12	12	12	12	
13	13	13	13	
14	14	14	14	
15	15	15	15	
16	16	16	16	
17	17	17	17	
18	18	18	18	
19	19	19	19	
20	20	20	20	
21	21	21	21	

BIURO INZYNIERSKIE  
Marek i Janina MUCHA  
Osiny, ul. Opolska 30a, 46-070 Komprachcice tel:077-46 46 757

DATE	NO	SIGNATURE	SCALE
2008.02.18	1	MUCHA	

Pos.383-384  
TJARNARVELLIR 11  
Steel- Storage house  
DRAWING NO. DRG 220 a